

### PARTS LIST

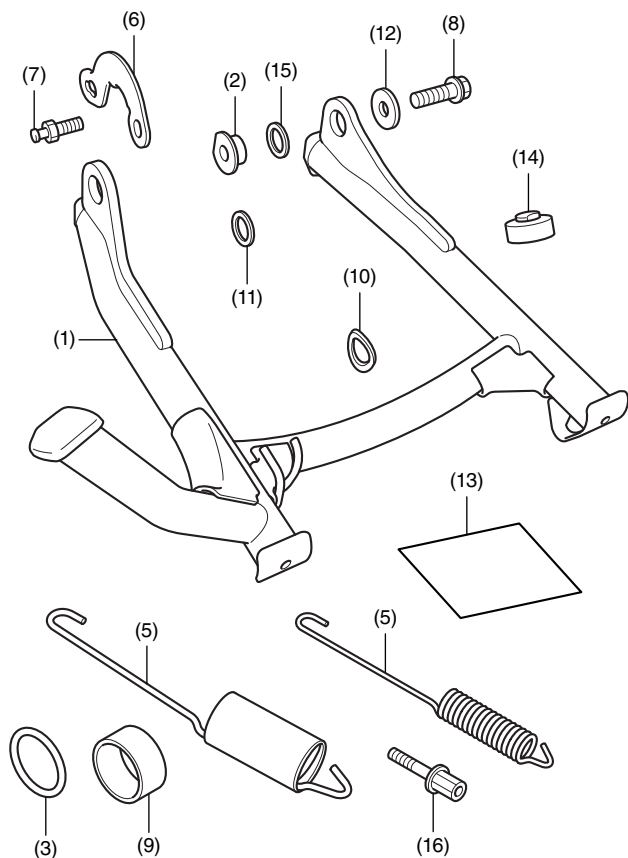

No.	Description	Qty
(1)	Centerstand	1
(2)	Collar	1
(3)	Exhaust pipe gasket	2
(4)	Spring (with rubber)	1
(5)	Spring	1
(6)	Plate	1
(7)	Spring hook	1
(8)	10 mm flange bolt (left hand thread)	1
(9)	Muffler packing	2
(10)	Spring washer	1
(11)	Washer (White)	1
(12)	Washer (Black)	1
(13)	Installation Instruction URL	1
(14)	Cushion	1
(15)	Rubber washer	1
(16)	10 mm special bolt	1

### TOOLS AND SUPPLIES REQUIRED

- Socket (12 and 14 mm)
- Ratchet
- Spring tool
- Grease
- Dish soap solution  
(Water:Dish soap / 100:1)
- Shop towel
- Torque wrench

### TORQUE CHART

Tighten all screws, bolts, and nuts to their specified torque values. Refer to the Service Manual for the torque values of the removed parts.

Item	N-m	kgf-m	lbf-ft
Spring hook	22	2.2	16
10 mm flange bolt	54	5.5	39.9
10 mm special bolt	54	5.5	39.9

### INSTALLATION

#### ▲ CAUTION

- To prevent burns, allow the engine, exhaust system, radiator, etc., to cool before installing the accessory.

#### NOTE:

- Be extremely careful when installing the springs as the combined tension of the springs is very strong.
- Keep the motorcycle on its side stand when installing the main stand.
- The spring installation should be performed by two people. While one person holds the motorcycle, the other person installs the spring.

1. Remove the indicated clips.

<Left side>

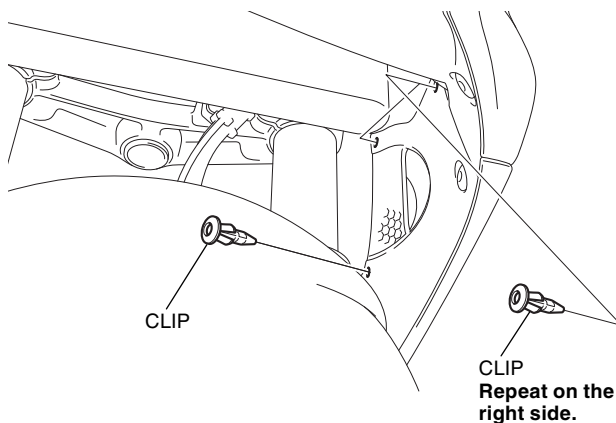

2. Remove the bolt and washer as shown.

- Repeat on the right side.

<Left side>

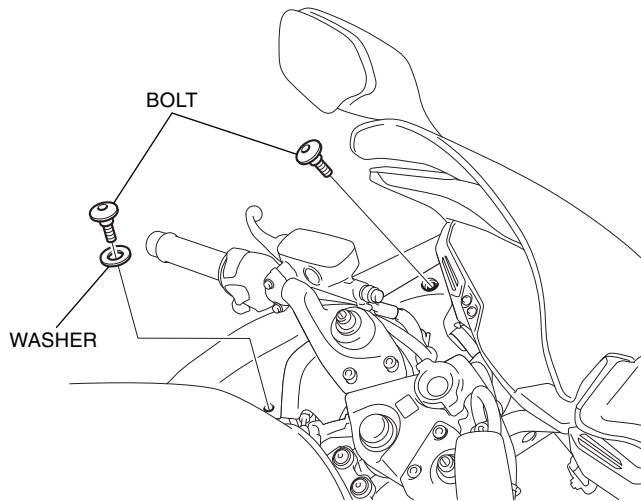

3. Remove the clips as shown.

<Under side>

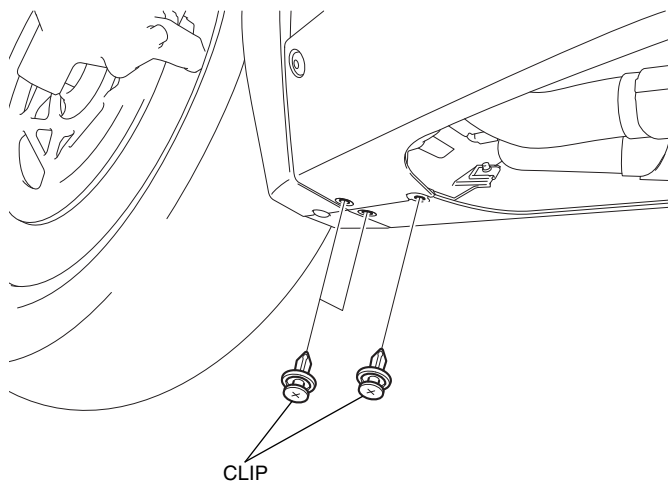

4. Remove the left under cowl as shown.

<Left side>

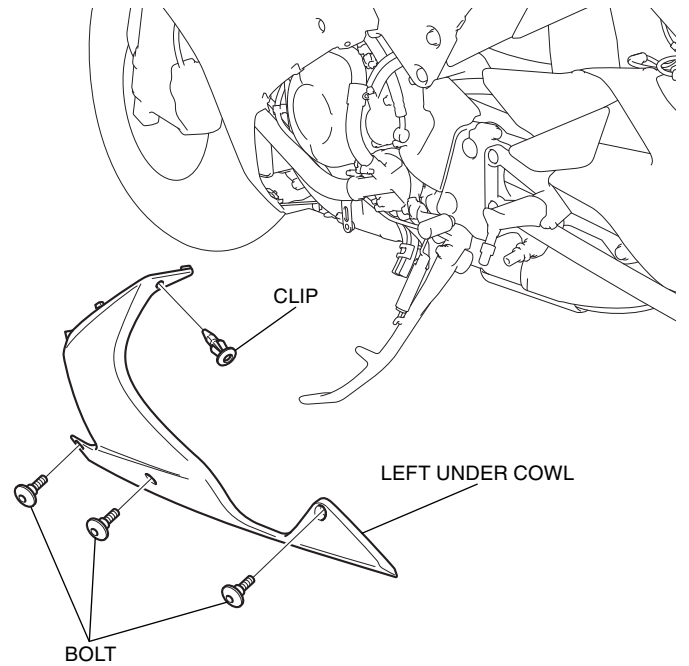

5. Remove the clip and bolt as shown.

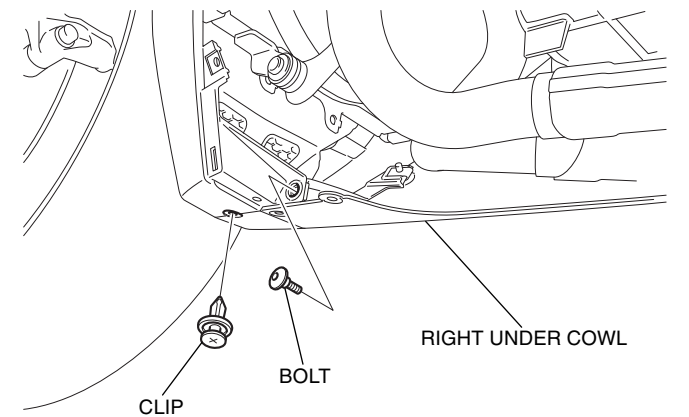

6. Remove the clips and bolts as shown.

- Repeat on the right side.

<Left side>

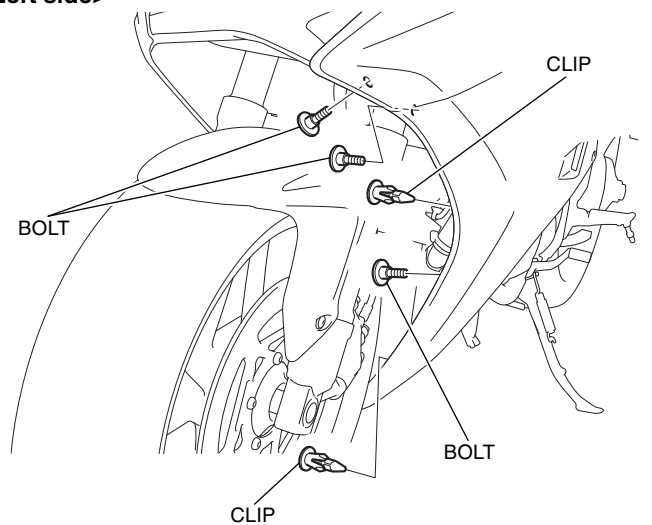

7. Remove the radiator grille as shown.

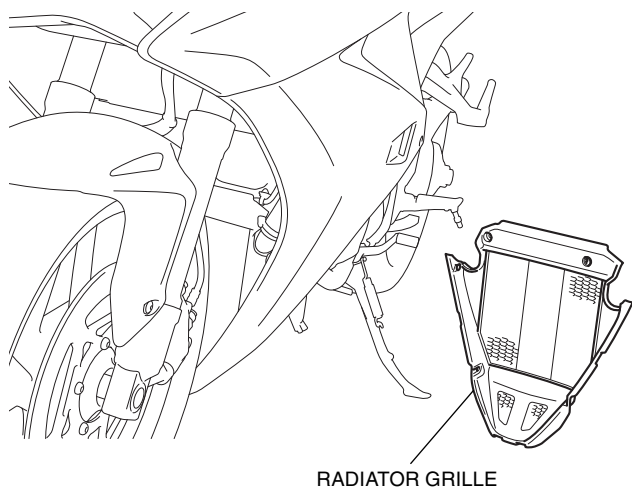

8. Remove the left inner lower cowl and left middle cowl as shown.

<Left side>

LEFT INNER LOWER COWL

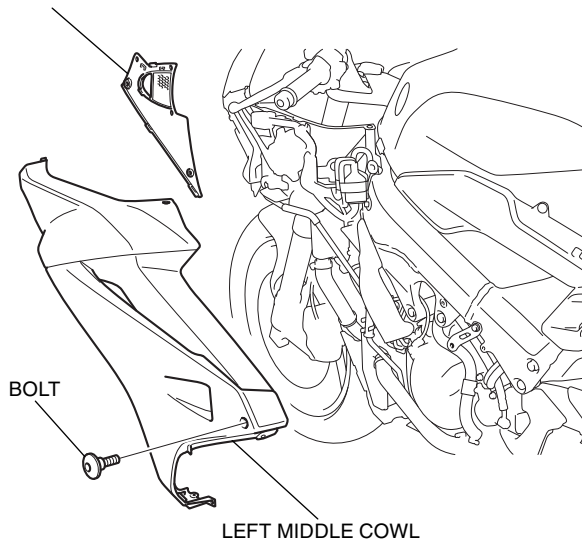

9. Remove the left inner upper cowl as shown.

LEFT INNER UPPER COWL

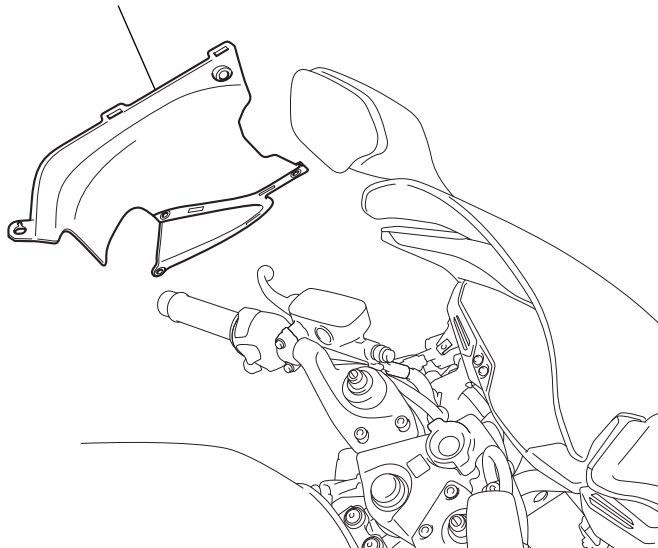

10. Remove the right under cowl as shown.

<Right side>

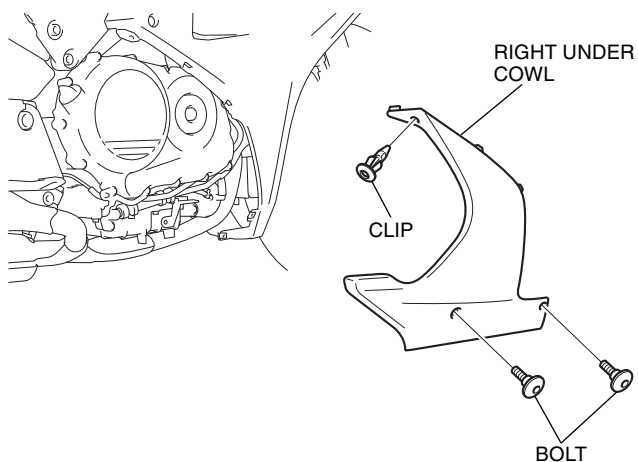

11. Remove the right inner lower cowl and right middle cowl in the same manner.

12. Remove the bolt and clip as shown.

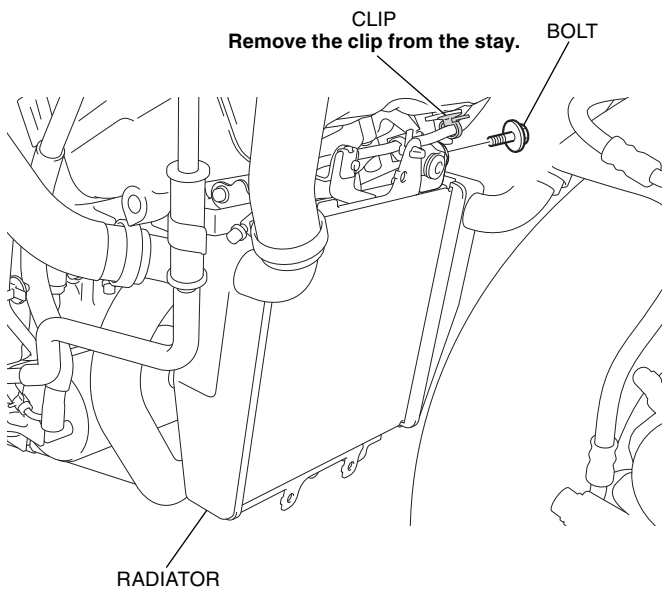

13. Remove the bolt as shown.

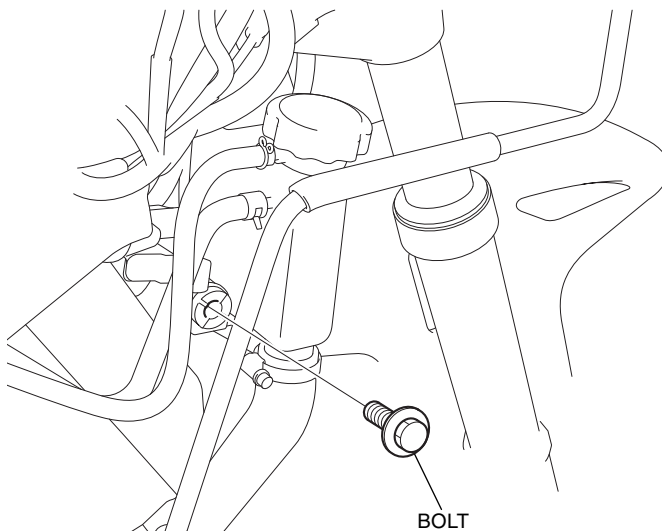

14. Remove the bolt as shown.

<Left side>

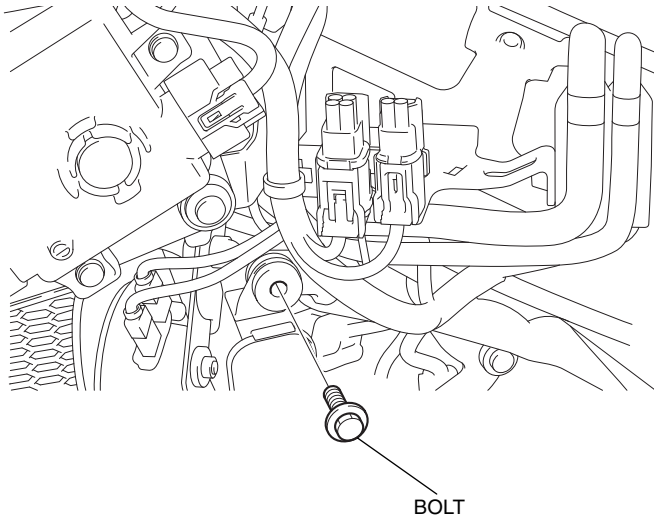

15. Remove the bolts and clip as shown.

CLIP  
Remove the clip from the stay.

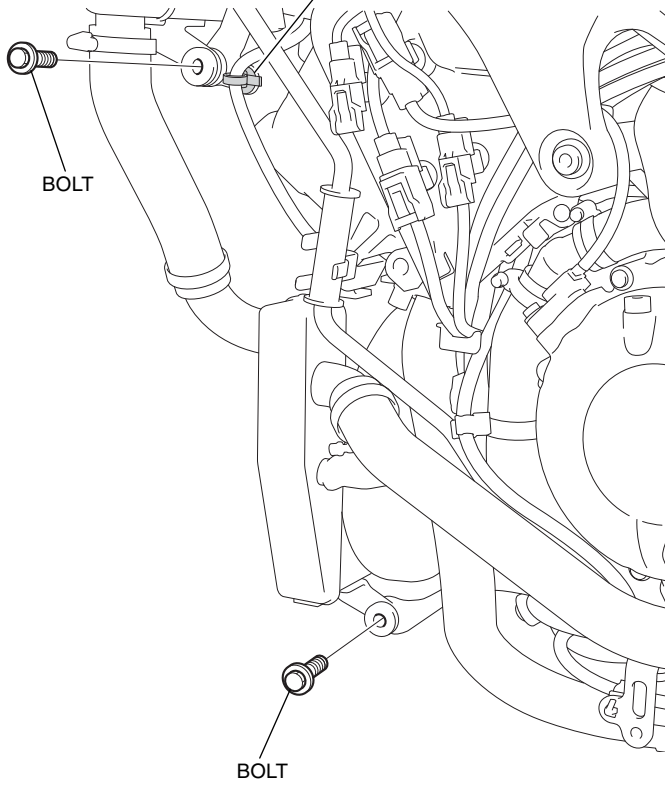

16. Move the rubber and remove the dummy connector as shown.

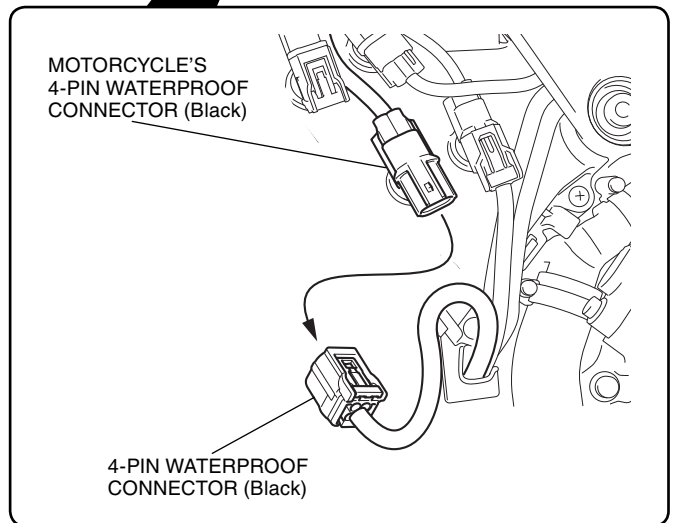
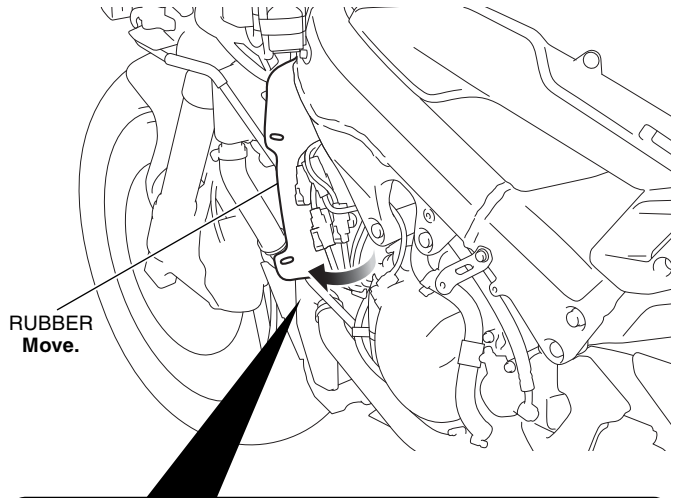

17. Remove the bolt, washer, and collar as shown.

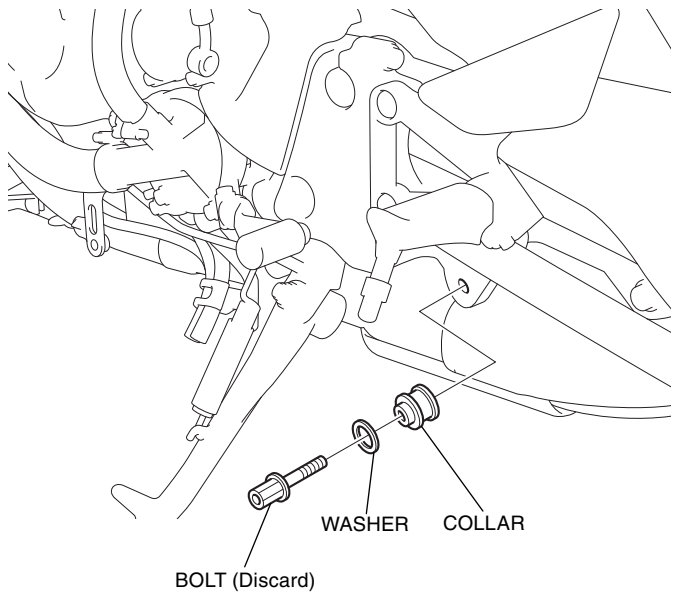

18. Apply a dish soap solution to the position shown.

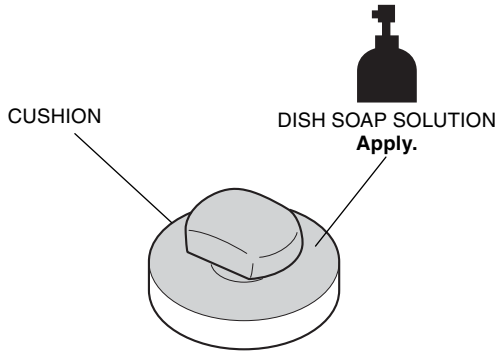

19. Install the cushion in the position shown.

<Right side>

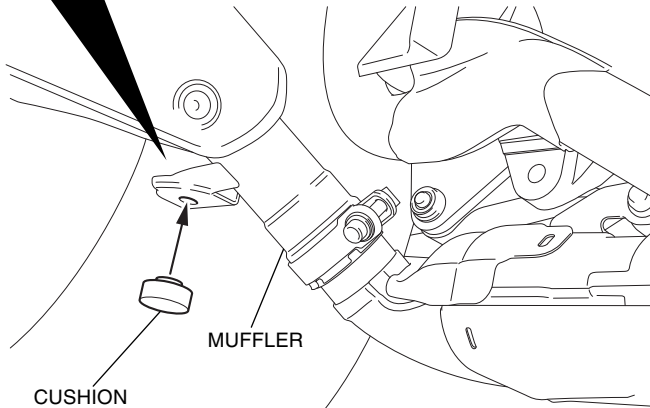
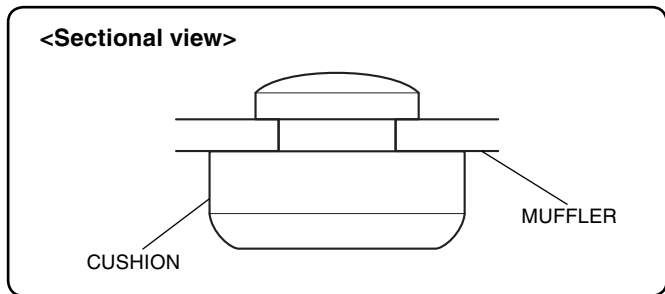

20. Remove the radiator from the boss and remove the nuts as shown.

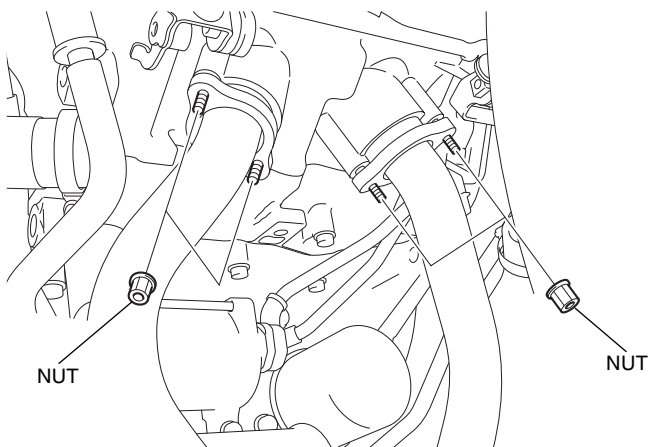

21. Remove the bolt and nut as shown.

<Left side>

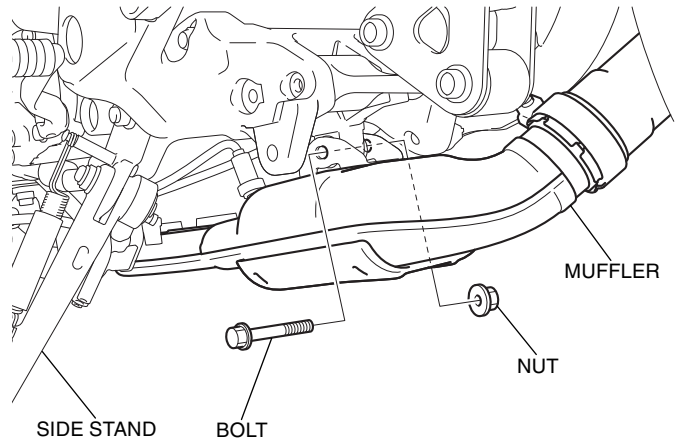

22. Remove the bolt as shown.

<Right side>

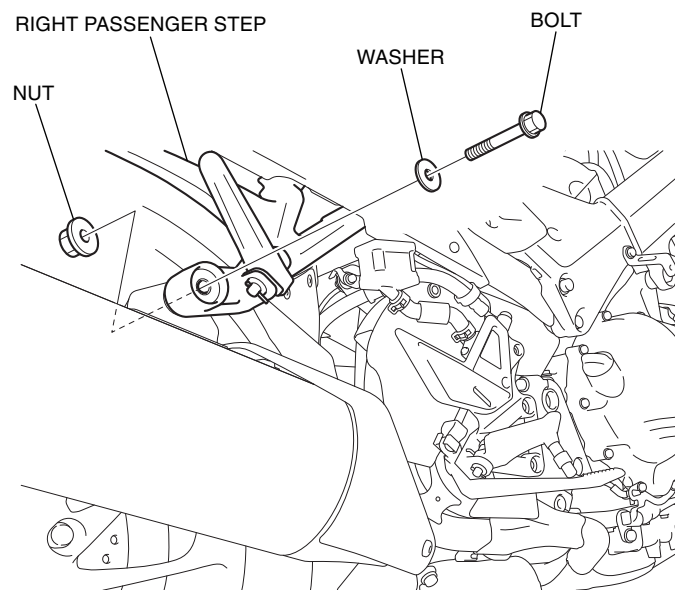

23. Remove the bolts and collar as shown.

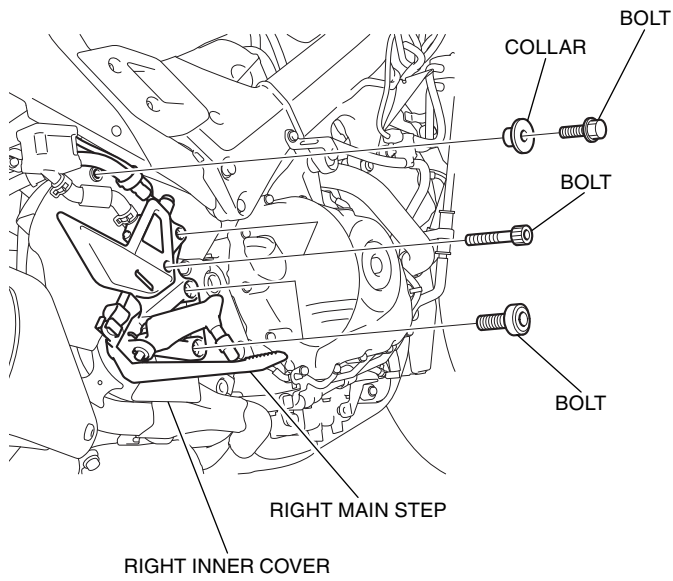

24. Remove the right inner cover as shown.

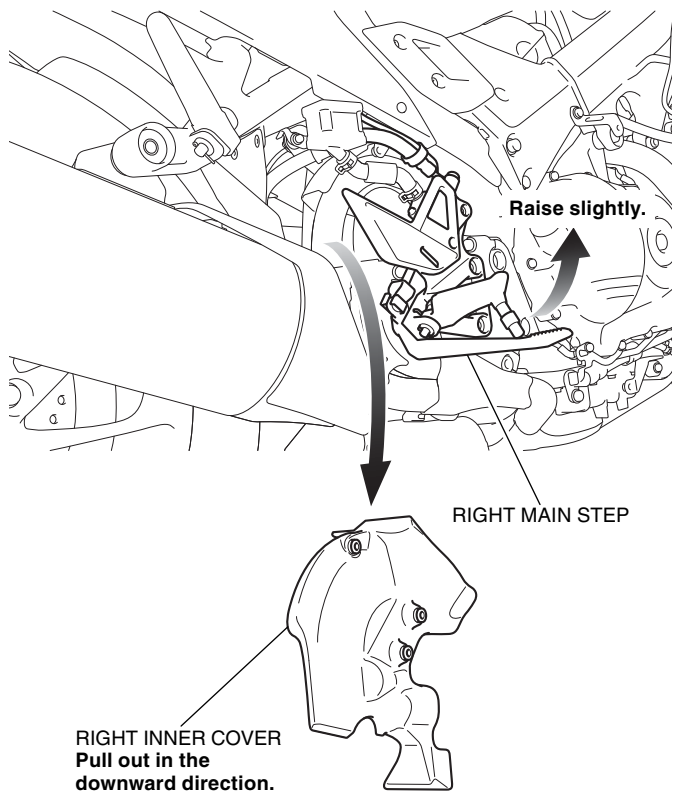

25. Loosen the indicated bolts.

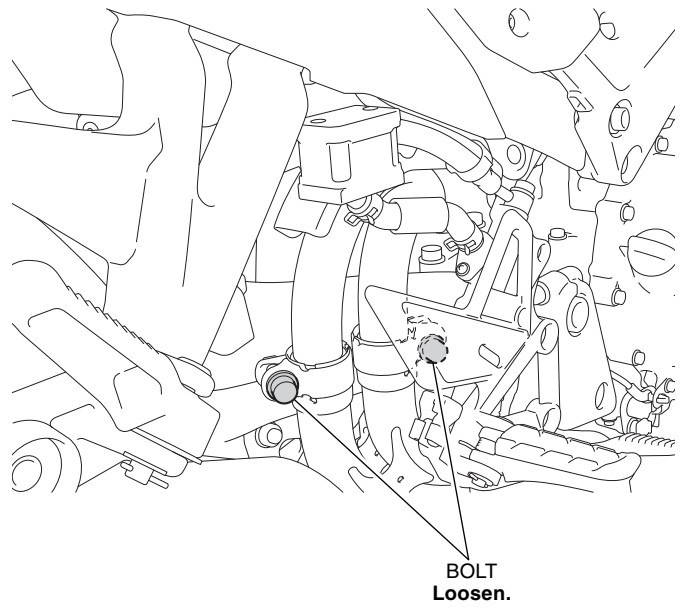

26. Remove the bolts as shown.

<Left side>

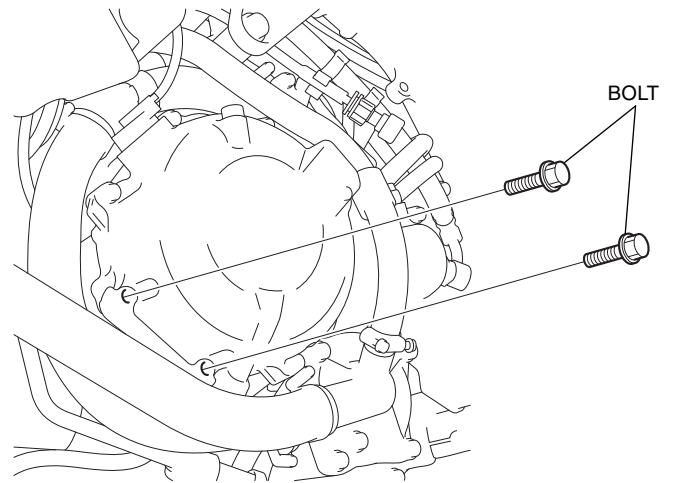

27. Lower the muffler as shown.

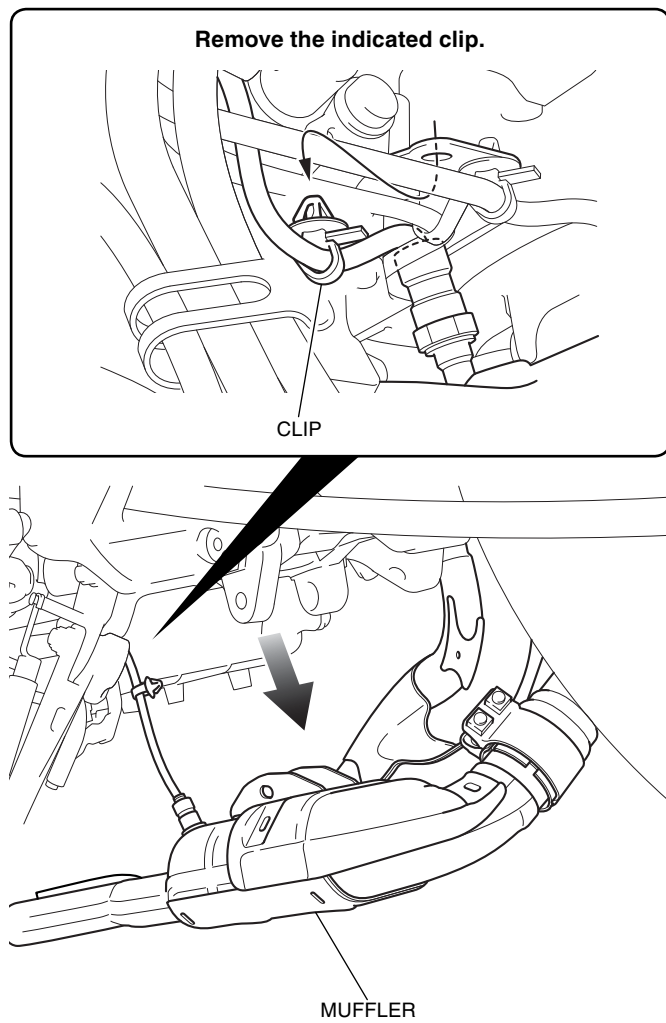

28. Apply grease to the position shown.

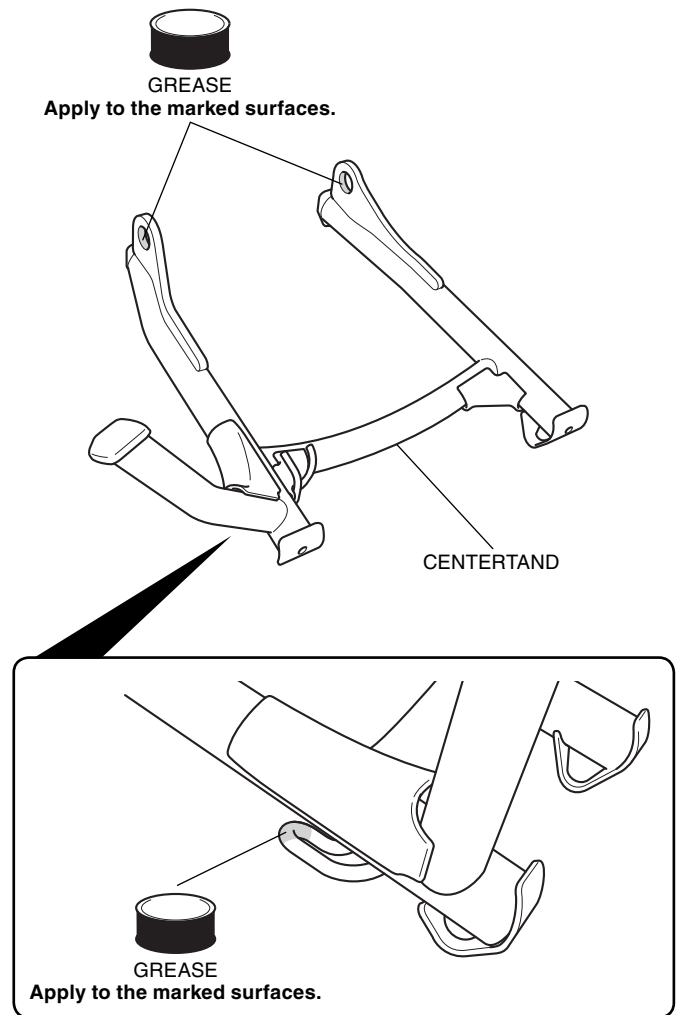

29. Install the centerstand from under the muffler as shown.

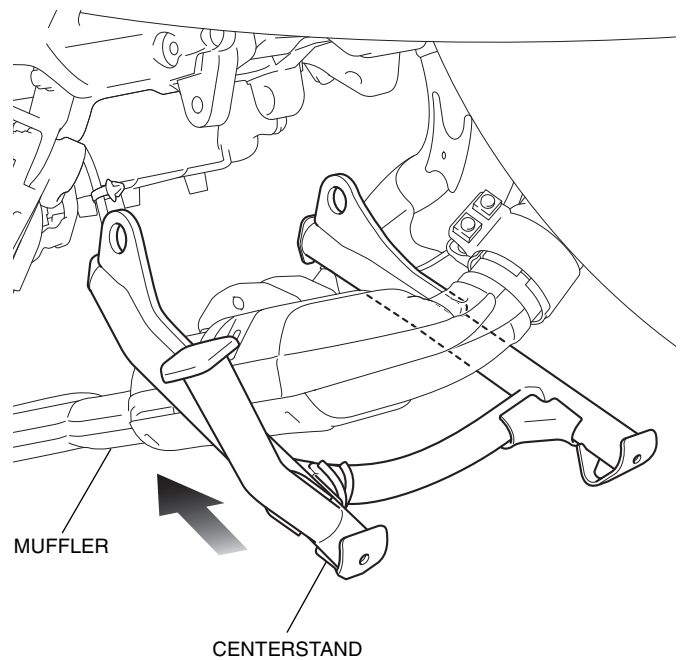

30. Install the centerstand as shown.

<Left side>

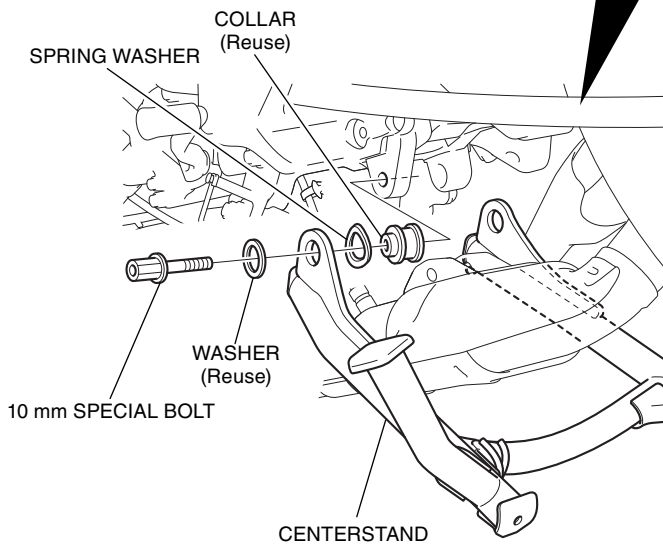
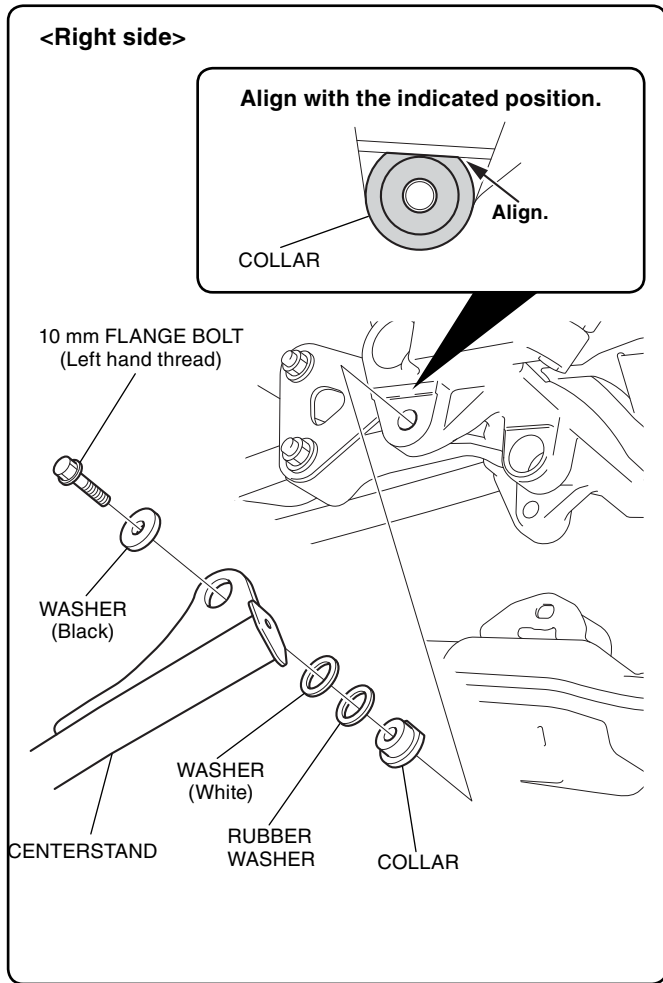

31. Install the muffler, right inner cover, right main step, and sensor stay in the reverse order of removal.

- Always replace with a new gasket.

32. Install the spring hook as shown.

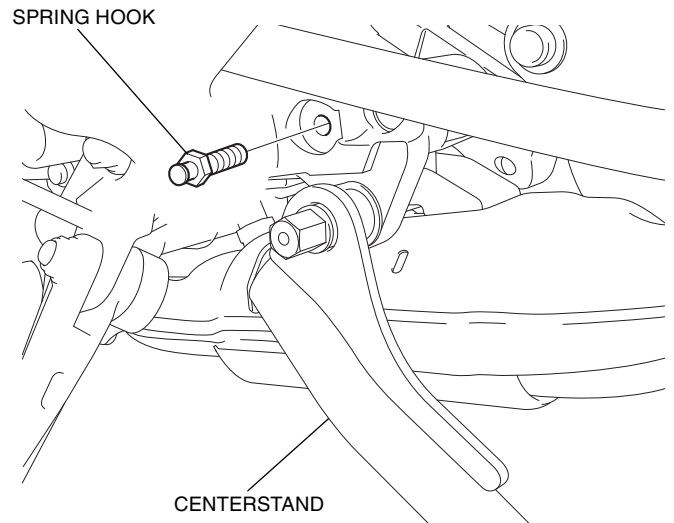

33. Apply grease to the position shown.

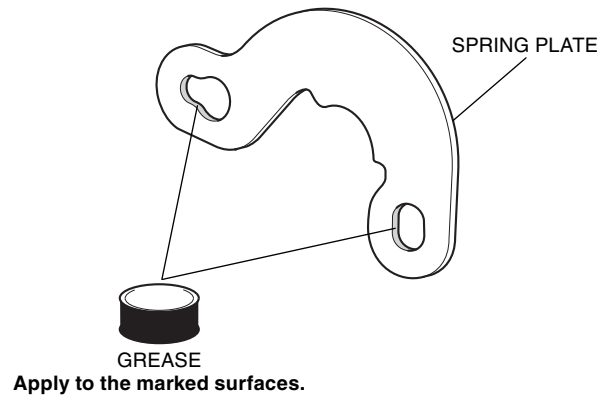

34. Install the spring plate as shown.

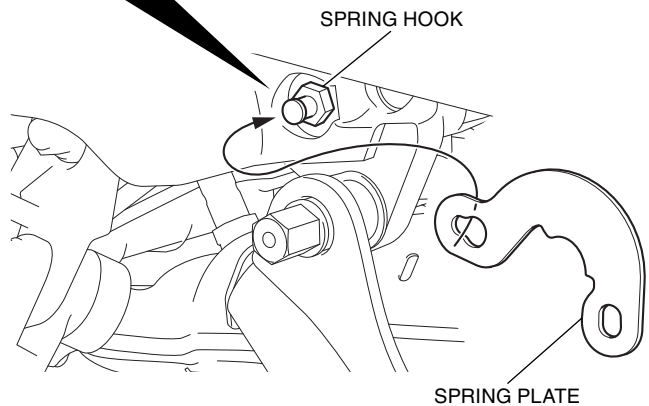
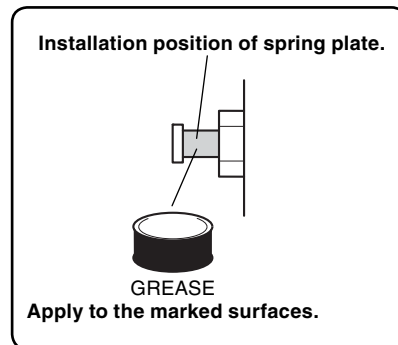



35. Slide the spring into the spring (with rubber).

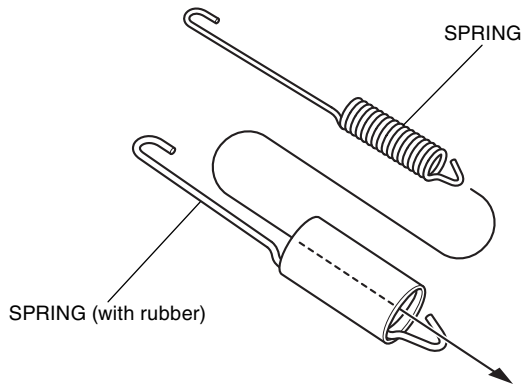

36. Install the assembled spring as shown.

- **First install the spring hook, then install the spring on the main stand.**
- **The spring installation should be performed by two people. While one person holds the motorcycle, the other person installs the spring.**

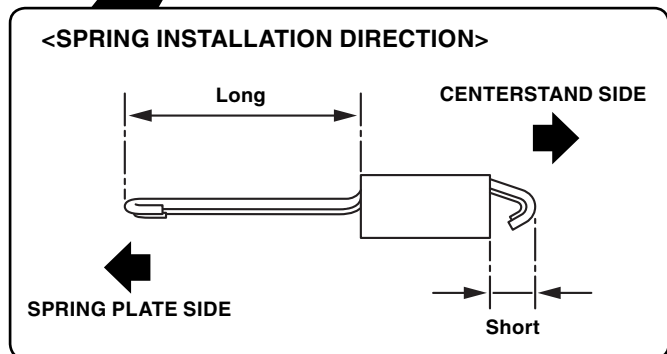
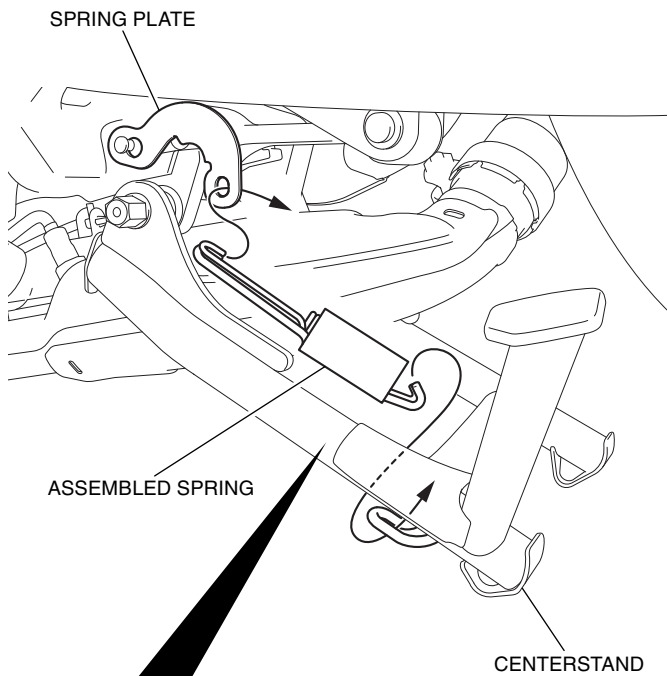

37. Install the removed parts in the reverse order of removal.

- **Confirm that wires are pinched or pulled tight.**