

HONDA

INSTALLATION INSTRUCTIONS

Accessory

GRIP HEATER
P/N 08T72-MJP-G50

Application

CRF1000/A/D

Publication No.

MII

Issue Date

May 2016

PARTS LIST

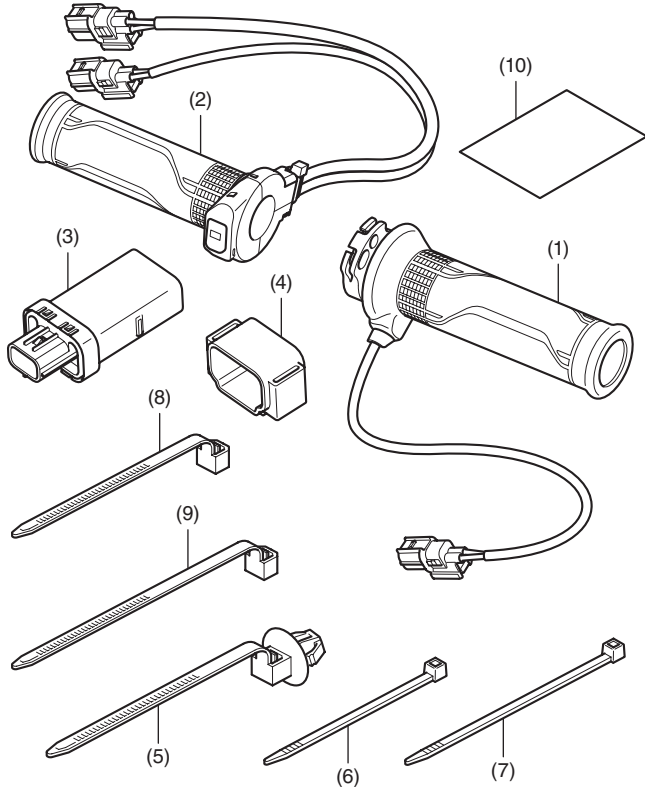

No.	Description	Qty
(1)	Right grip heater	1
(2)	Left grip heater	1
(3)	Heater controller	1
(4)	Suspension	1
(5)	Clip band (Not used.)	6
(6)	Wire tie (narrow/short)	6
(7)	Wire tie (narrow/long) (Not used.)	6
(8)	Wire tie (wide/short) (Not used.)	6
(9)	Wire tie (wide/long) (Not used.)	3
(10)	URL paper	1

GRIP HEATER ATTACHMENT Sold separately

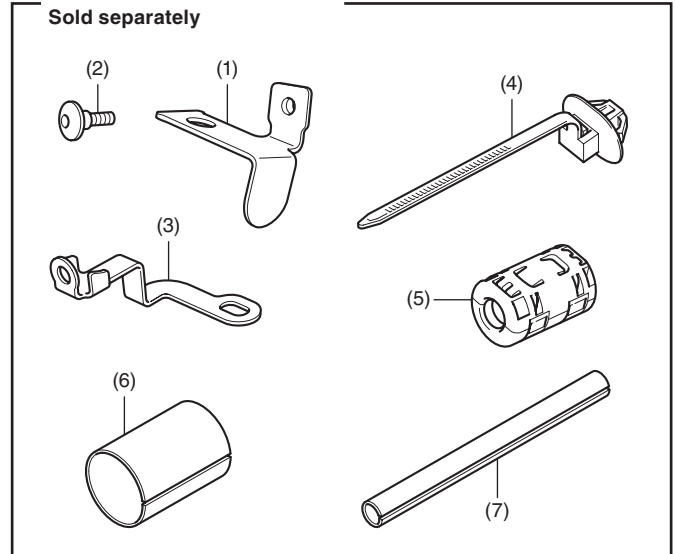

No.	Description	Qty
(1)	Heater controller stay	1
(2)	5 mm screw	1
(3)	Clamp	1
(4)	Clip band	2
(5)	Noise filter	1
(6)	Slit tube (wide)	1
(7)	Slit tube (narrow)	1

TOOLS AND SUPPLIES REQUIRED

Hex wrench (5 mm)

Flat-tip screwdriver

Nippers

Marker

Scale

Electrical tape (Heat resistance temperature is 80°C and more)

Honda Bond A

Thread lock

Scissors

Grease

Isopropyl alcohol

Shop towel

Torque wrench

TORQUE CHART

Tighten all screws, bolts, and nuts to their specified torque values. Refer to the Service Manual for the torque values of the removed parts.

Item	N-m	kgf-m	lbf-ft
5 mm screw	4.2	0.4	3.1

INSTALLATION

▲ CAUTION

- To prevent burns, allow the engine, exhaust system, radiator, etc., to cool before installing the accessory.

NOTE:

- Disconnect the throttle cable from the right grip as instructed in the motorcycle's Service Manual.
- For secure adhesion of the grip heaters use the recommended adhesive agent (Honda Bond A) or equivalent.
- Be sure to open and close the throttle to check for smooth operation after installation of the right grip heater.
- Disconnect the negative (-) cable from the battery before installing this accessory.
- The memories of the clock will be erased when you disconnect the battery. Reset the memories after reconnecting the battery.
- Reinstall the removed parts on the motorcycle and make sure that the wires and harnesses are not pinched.
- Trim the excess ends off the wire ties after attaching them to the wire harnesses. Do not allow the cut part of the wire tie to interfere with another harness or brake hose.
- After handle grip heater installation, check the lights (e.g. right / left turn signal lights and brake lights) for proper operation.

1. Remove the main seat as shown.

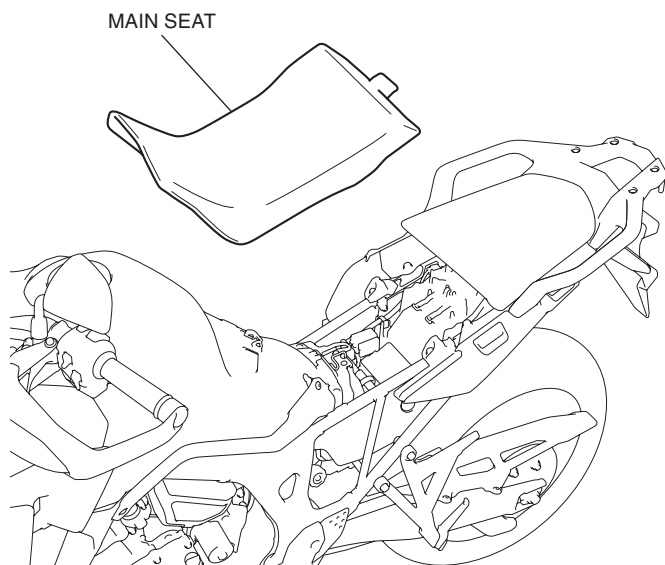

2. Remove the tool box, open the battery box and disconnect the negative (-) terminal of the battery.

<Left side>

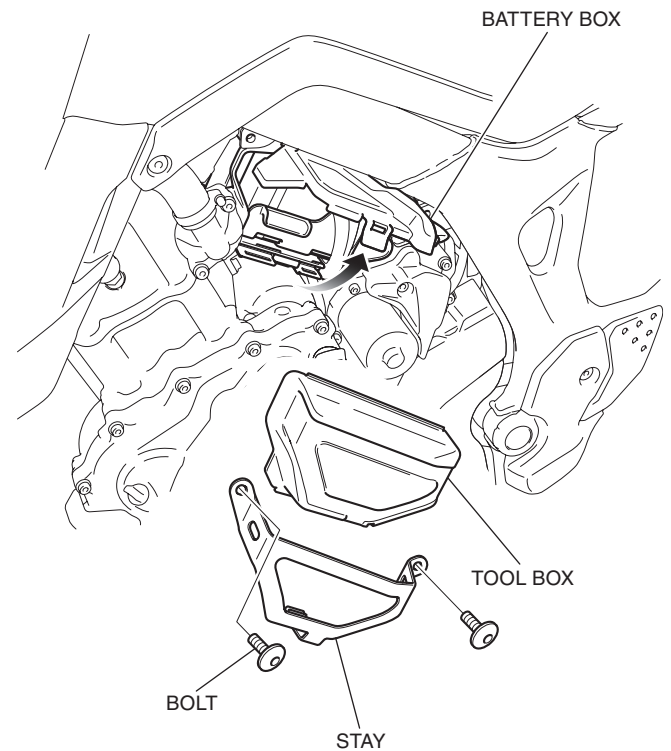

3. Remove the screws and clips as shown.

- Repeat on the right side.

<Left side>

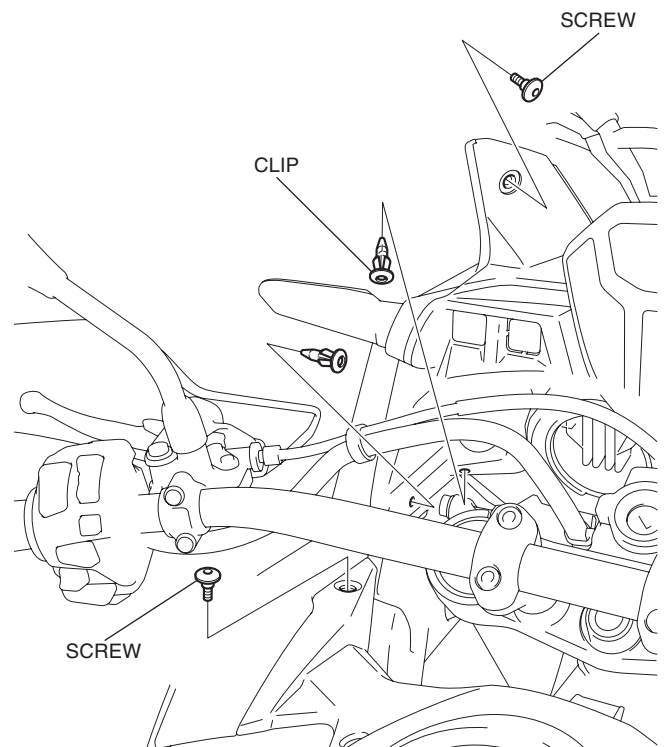

4. Remove the left tank side cover as shown.

<Left side>

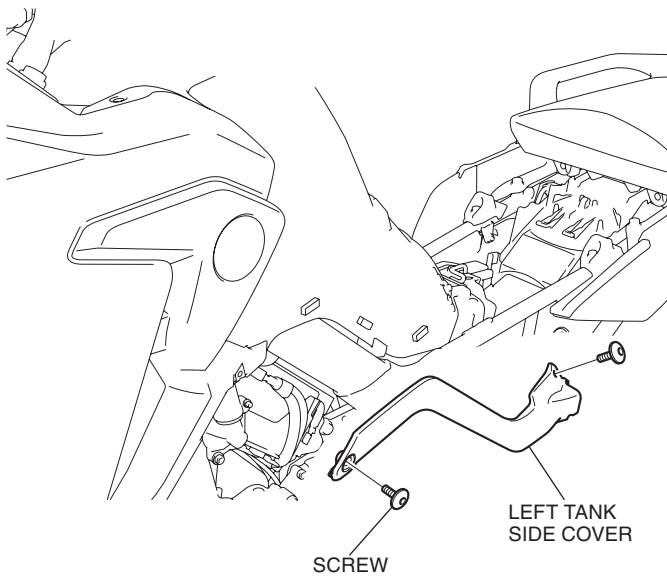

5. Remove the front spoiler as shown.

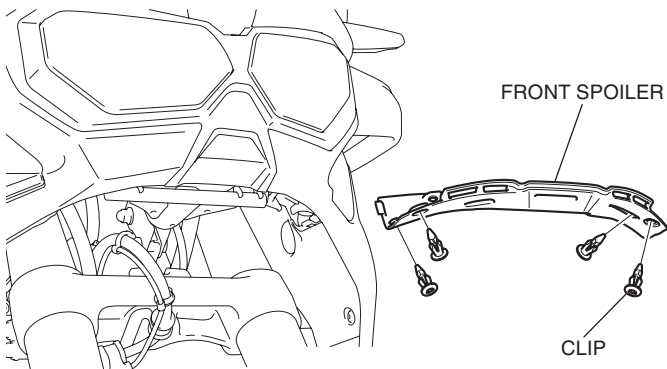

6. Remove the clips as shown.

- Repeat on the right side.

<Left side>

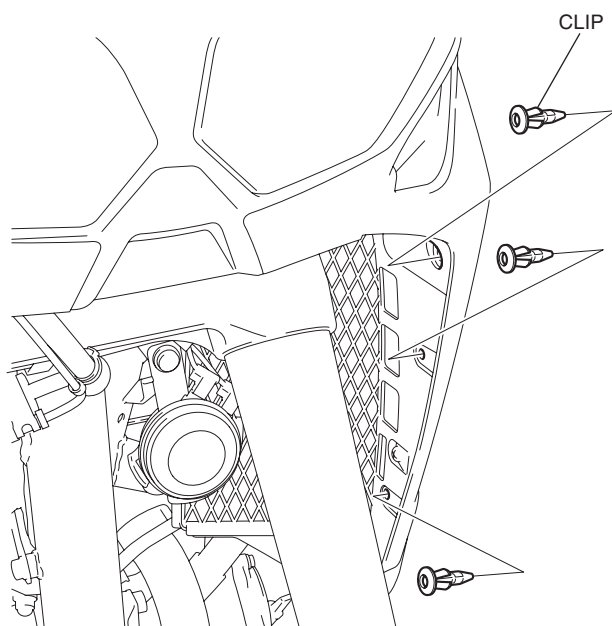

7. Remove the left middle cowl as shown.

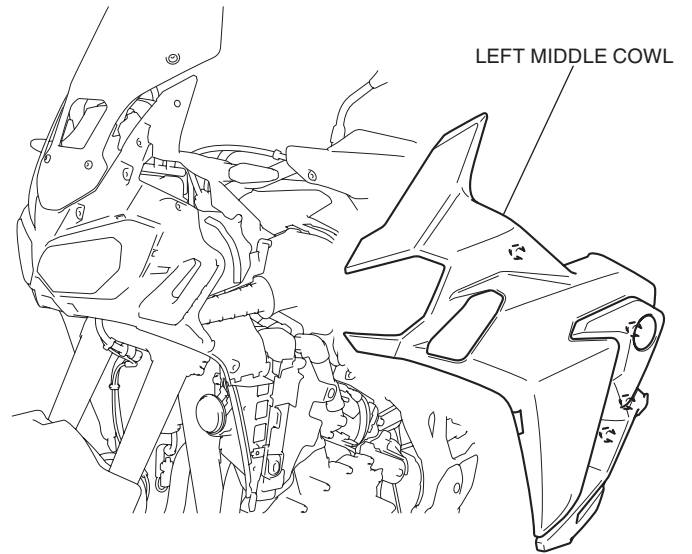

8. Remove the right tank side cover and right middle cowl in the same manner.

9. Remove the tank front cover as shown.

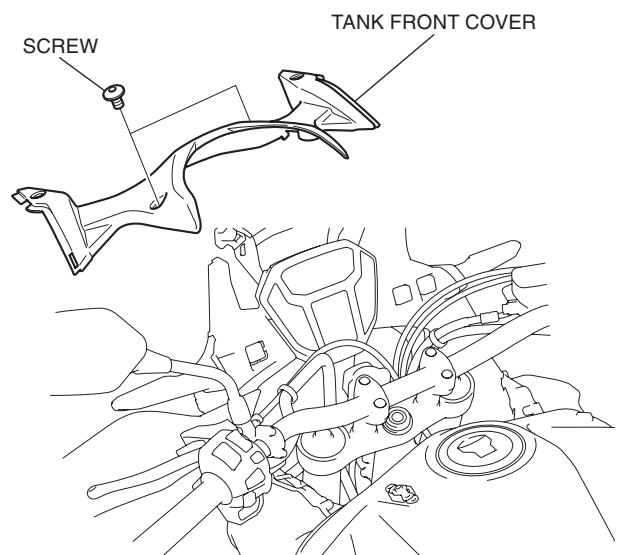

10. Remove the screw and clip as shown.

- Repeat on the right side.

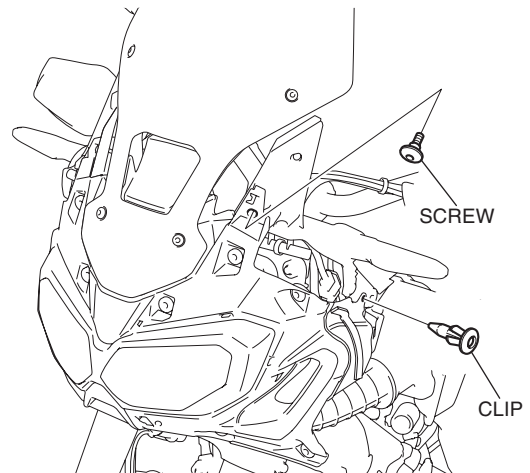

11. Remove the left inner panel cover as shown.

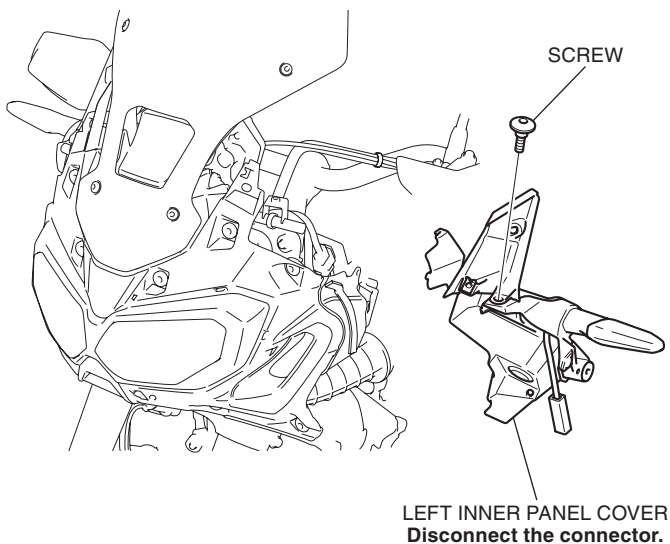

12. Remove the left inner cover as shown.

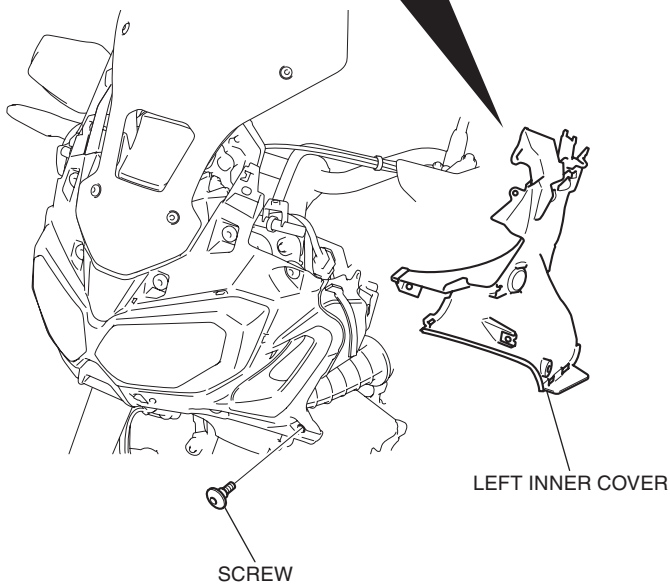
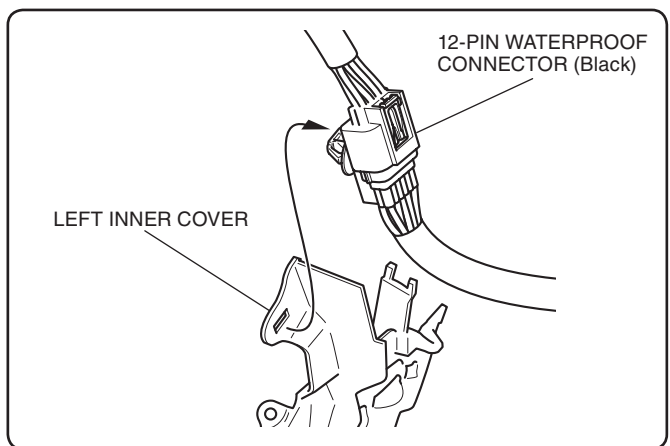

13. Remove the right inner panel cover in the same manner.

14. Remove the right inner cover as shown.

<Right side>

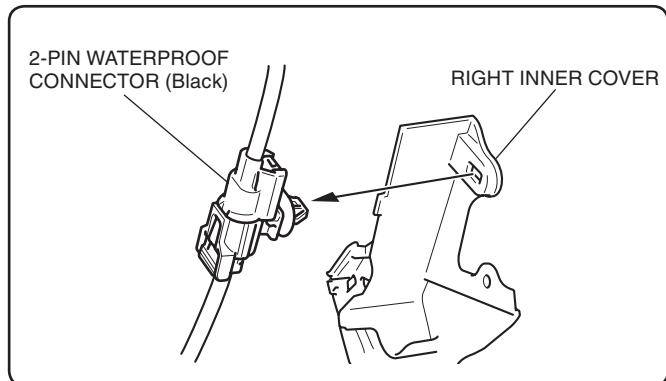

RIGHT INNER COVER

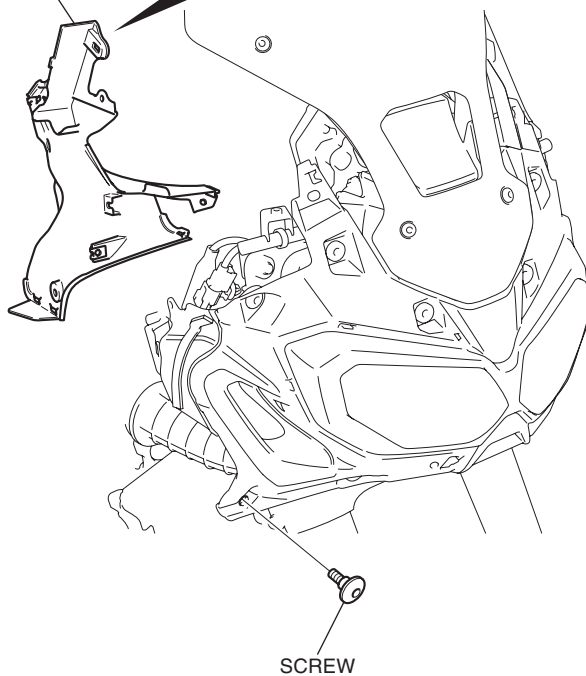

15. Remove the bolt as shown.

<Left side>

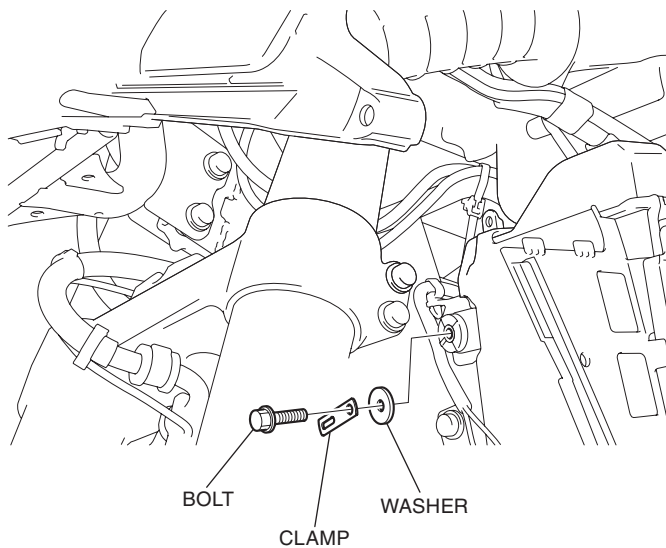

16. Remove the parts as shown.

<Left side>

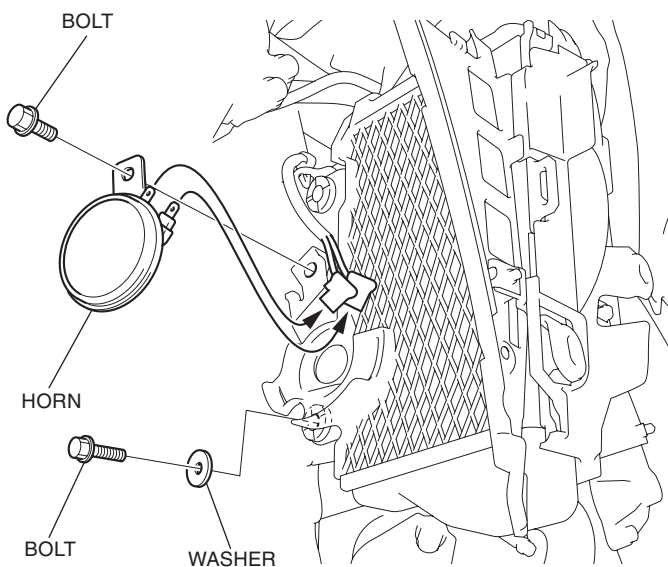

17. Remove the pillion seat as shown.

FLANGE COLLAR

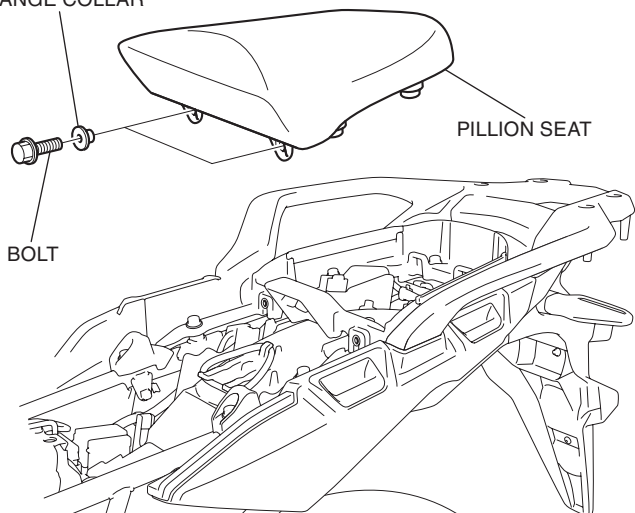

18. Remove the left side cover as shown.

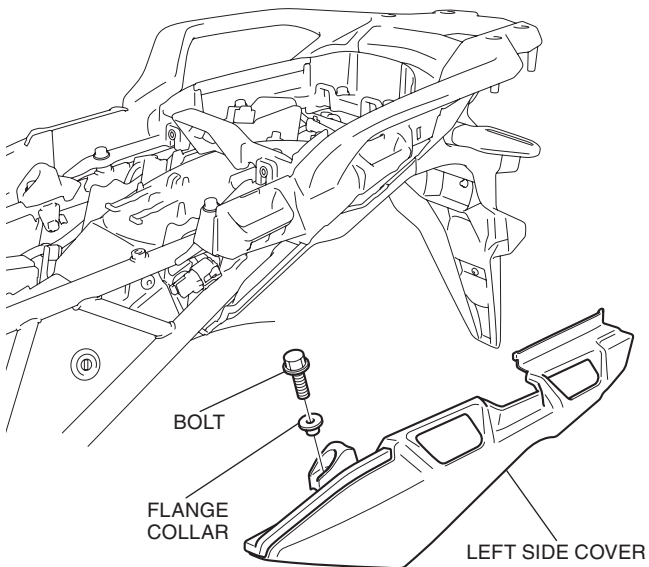

19. Remove the parts as shown.

• Repeat on the right side.

<Left side> CRF1000A/D

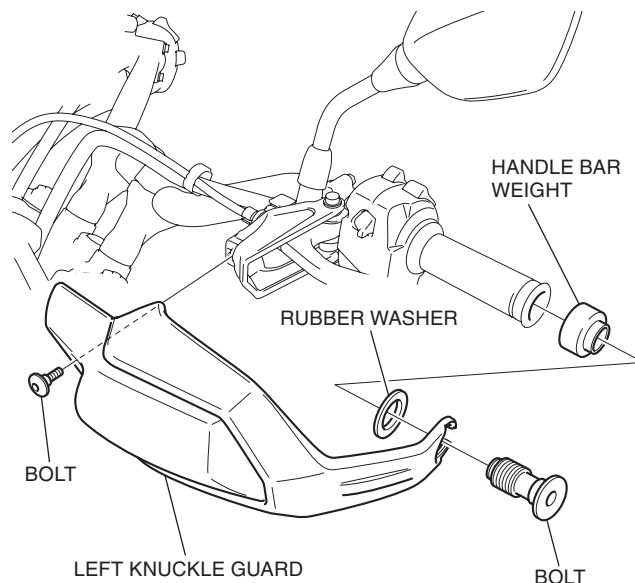

<Left side> CRF1000

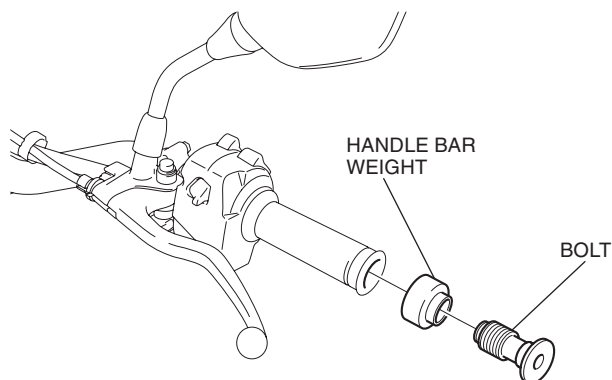

20. Remove the left grip as shown.

<Left side>

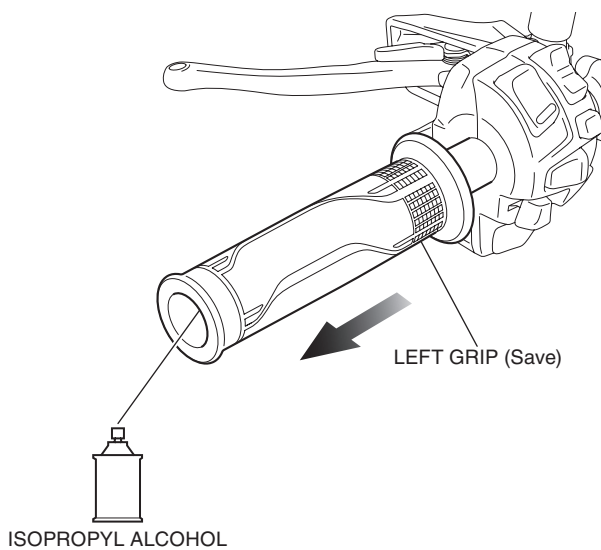

21. Using a isopropyl alcohol, remove all traces of adhesive from the left handlebar.

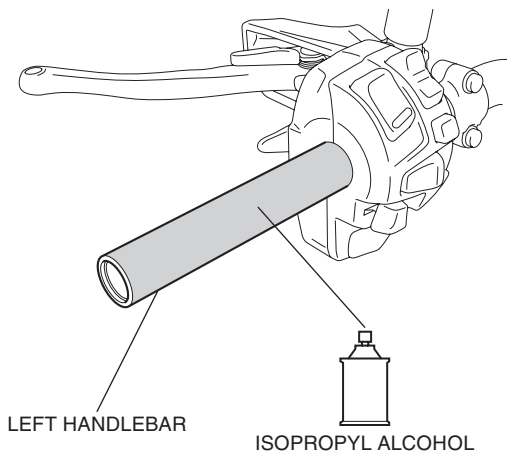

22. Mark the left grip heater harness in the position shown.

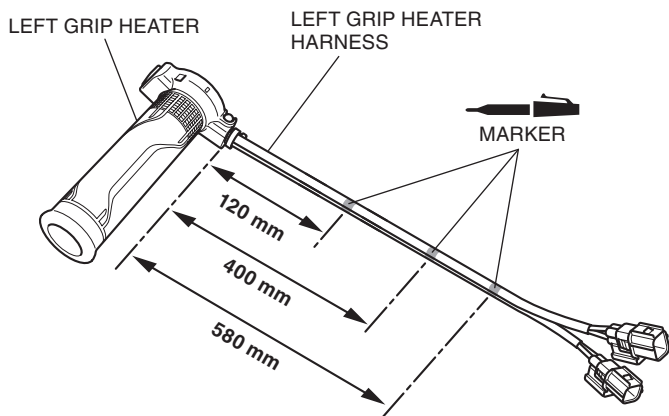

23. Apply the Honda bond A to the left handlebar as shown.

- **Apply evenly to the whole circumferential surface of the left handlebar.**
- **Perform the next step 5 minutes after application.**

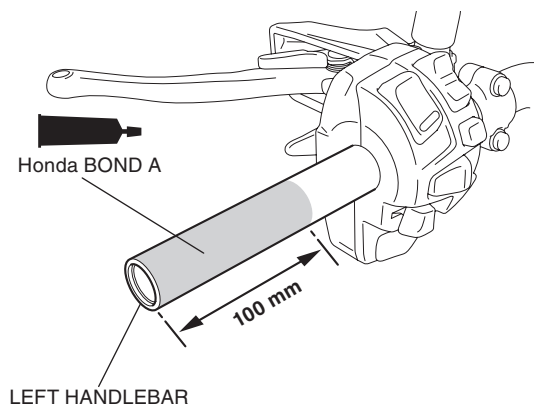

24. Spray isopropyl alcohol over the inside of the grip heater and outside of the left handlebar.

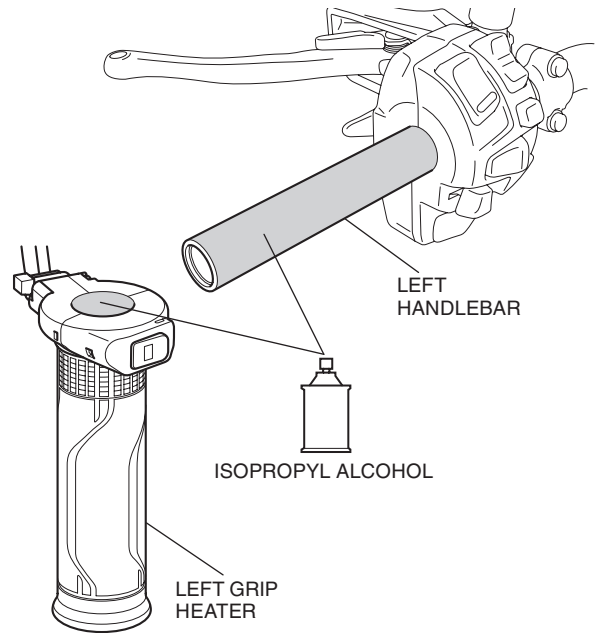

25. Slide the left grip heater onto the left handlebar as indicated.

- Use an assistant to steady the motorcycle while installing the grips.
- Wipe up excess adhesive at once.

NOTICE

- Do not tap on the grip end with a hammer and do not twist the grip to install the grip heater onto the handlebar, as it can damage the element.

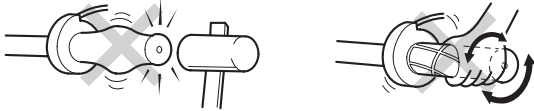

- Avoid putting pressure on the switch part when inserting the left grip heater. There is a possibility that the switch part will break. Also, install so that there is no gap with the switch holder.



- If the grip gets stuck halfway during installation, apply isopropyl alcohol to the gap between the grip heater. Do not try to remove the grip heater using force or a screwdriver, etc. Damage to the grip heater wire can result.
- Do not touch the left handlebar and turn on the heater switch at least one hour after attachment.

Insert until there is contact with the switch holder, then align the indicated position.

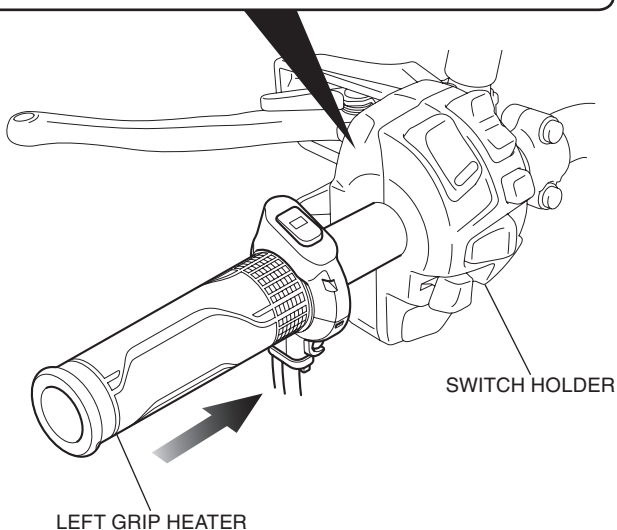
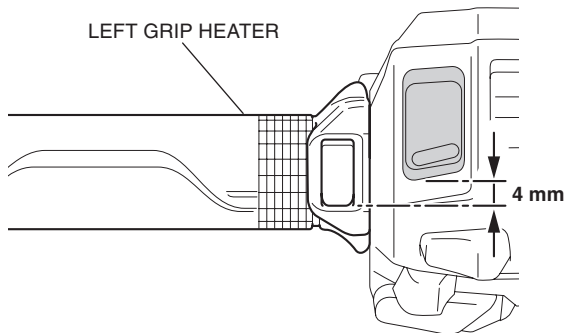

26. Route the left grip heater harness as shown.
<Left side>

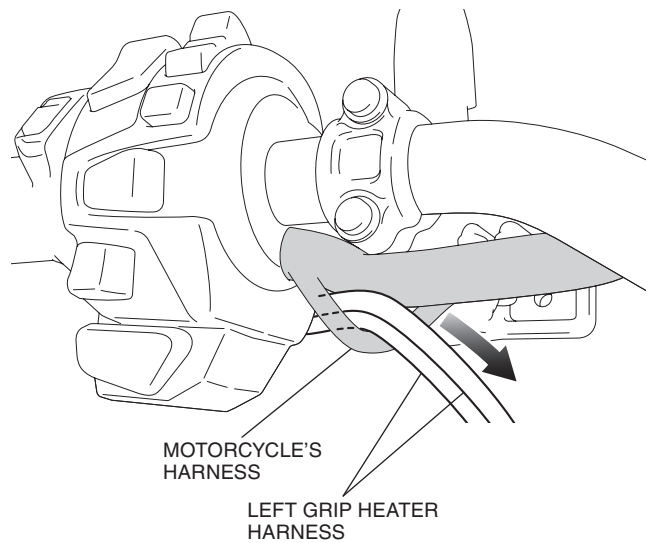

27. Route the left grip heater harness as shown.
<Left side>

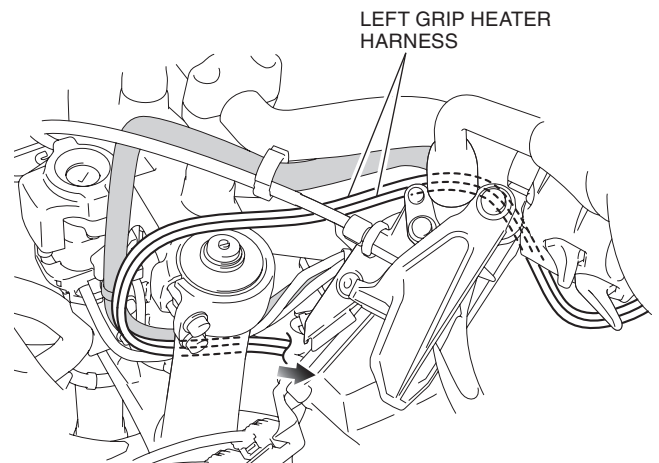

28. Secure the left grip heater harness using the wire tie as shown.

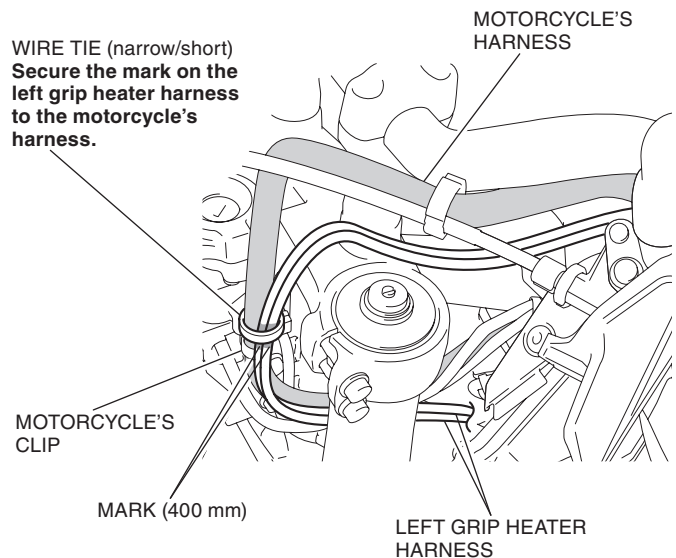

29. Secure the left grip heater harness using the wire tie as shown.

WIRE TIE (narrow/short)
Secure the left grip heater harness and cable to the motorcycle's harness.

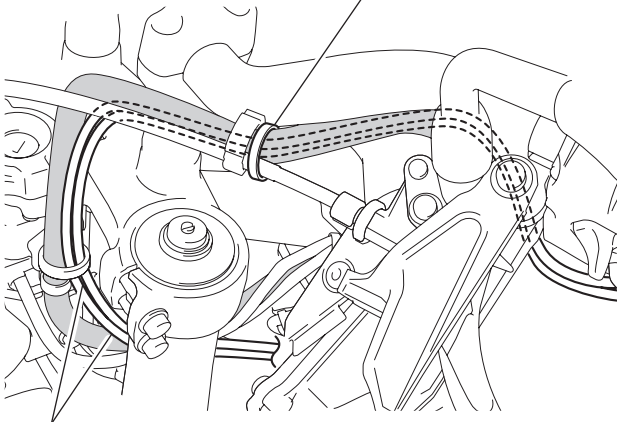

LEFT GRIP HEATER HARNESS

30. Secure the left grip heater harness using the wire tie as shown.

<Left side>

MOTORCYCLE'S HARNESS

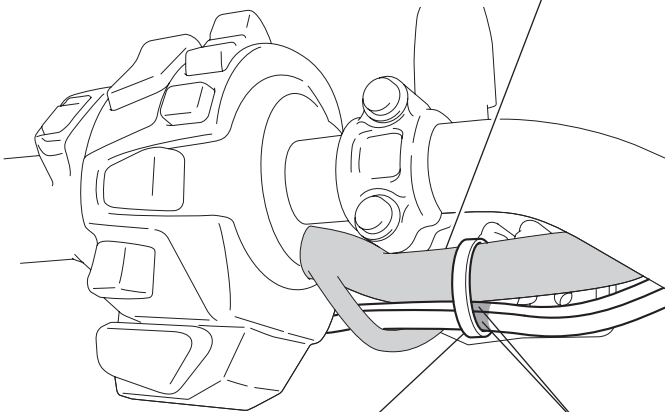

WIRE TIE (narrow/short)
Secure the mark on the left grip heater harness to the motorcycle's harness.

MARK (120 mm)

31. Remove the drain tube as shown.

<Left side>

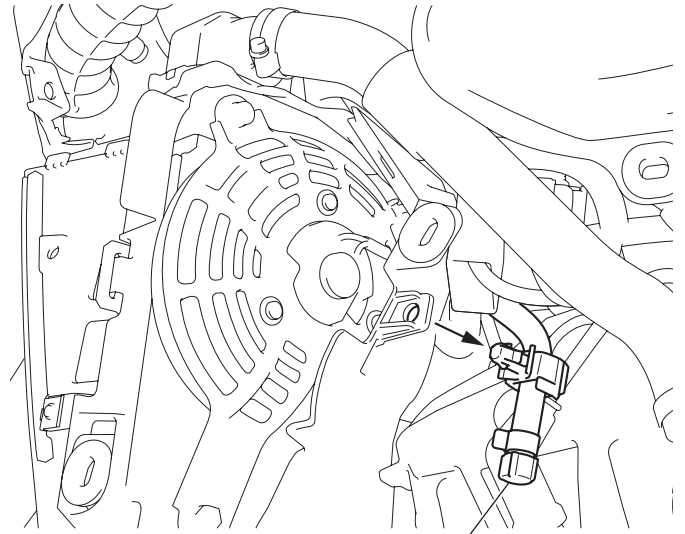

DRAIN TUBE

32. Remove the clip as shown.

CLIP

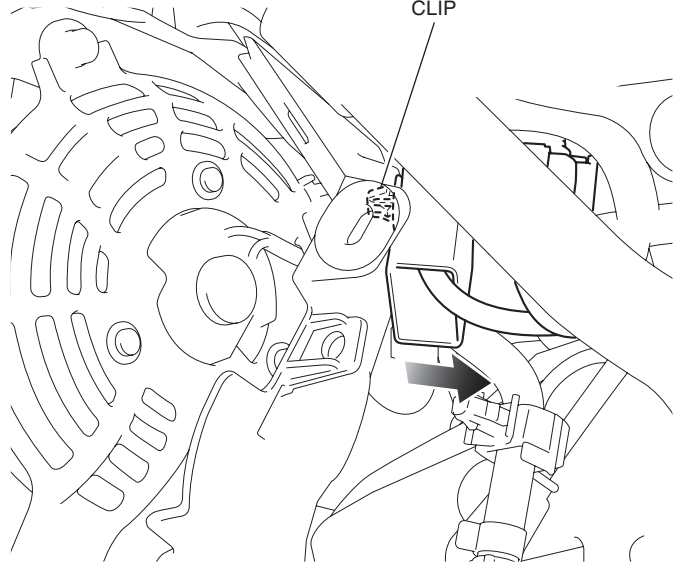

33. Remove the connectors from the stay as shown.

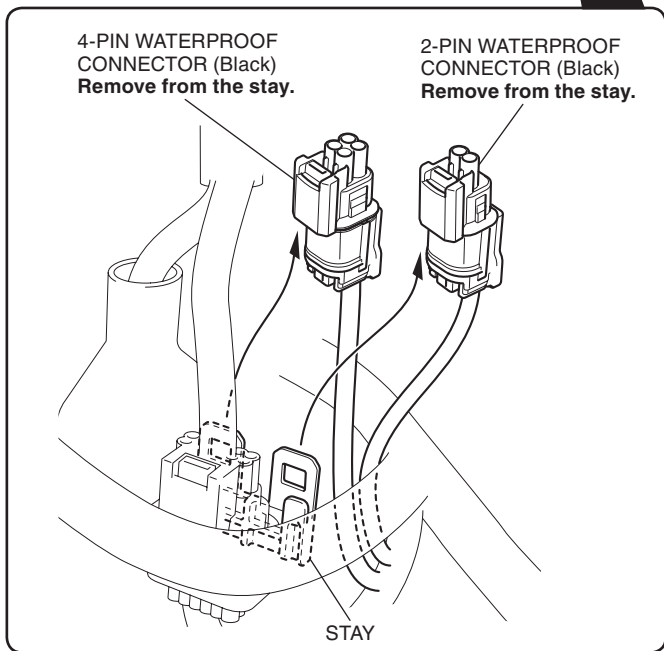
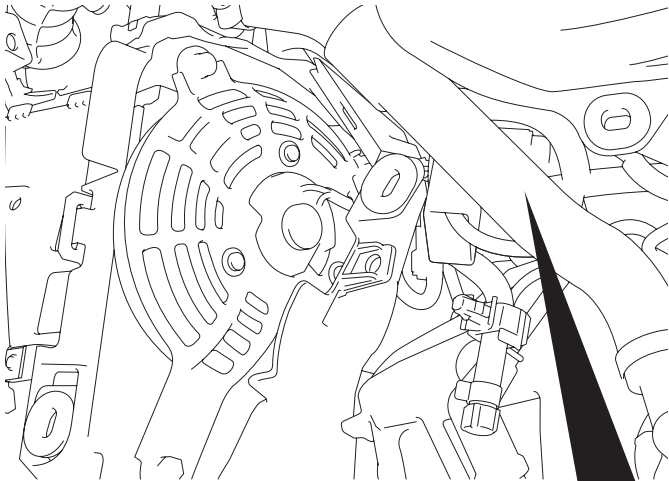

34. Remove the dummy connectors as shown.

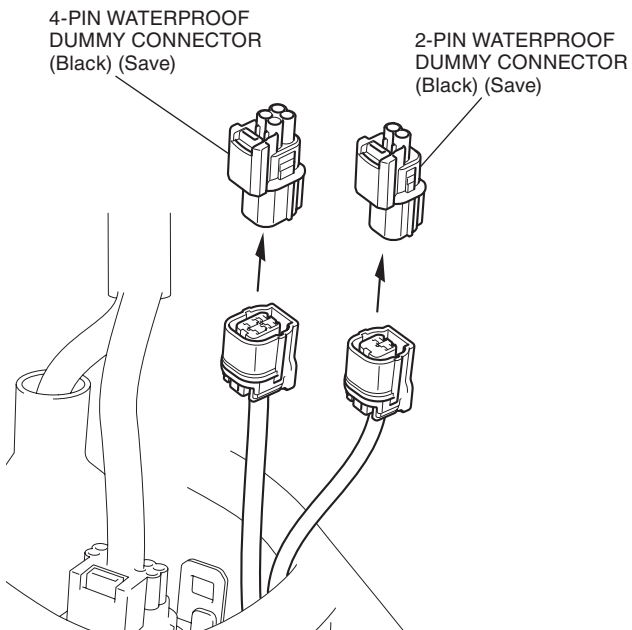

35. Route the left grip heater harness as shown.

<Left side>

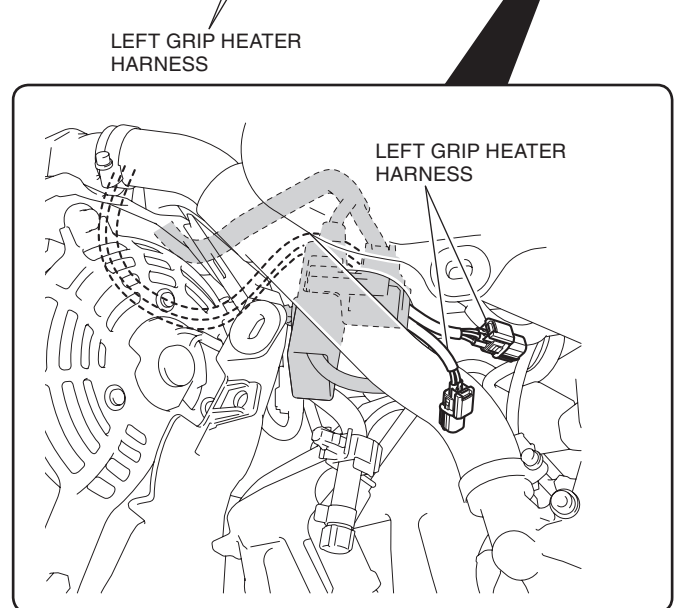
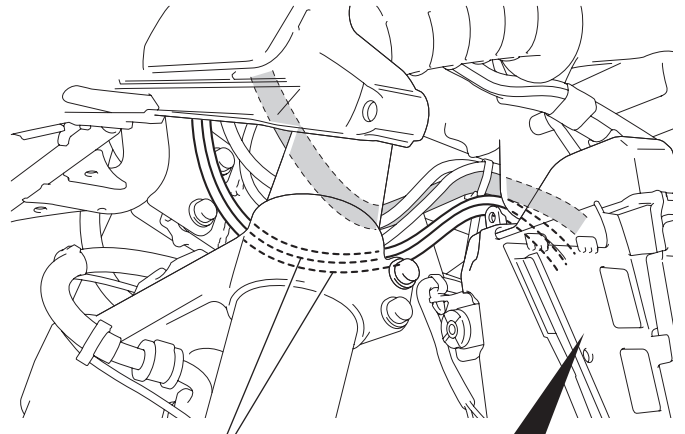

36. Connect the left grip heater harness as shown.

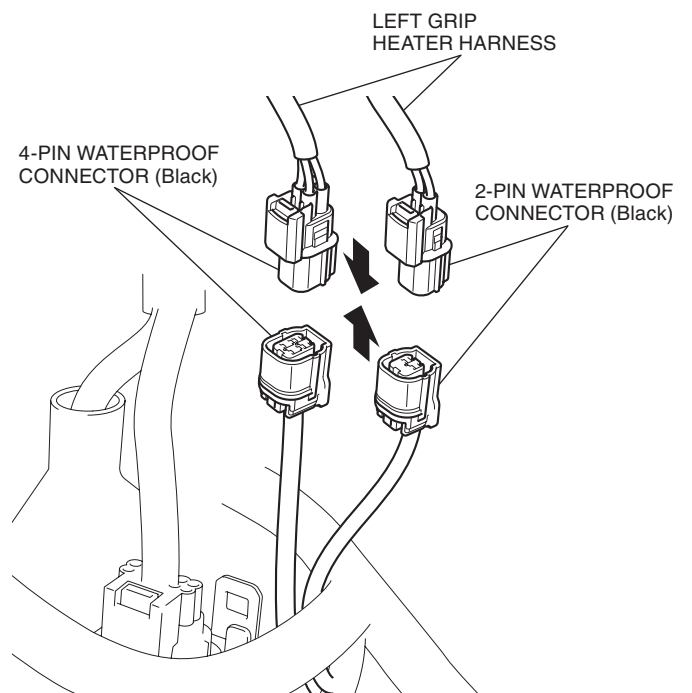

37. Secure the left grip heater harness to the stay.

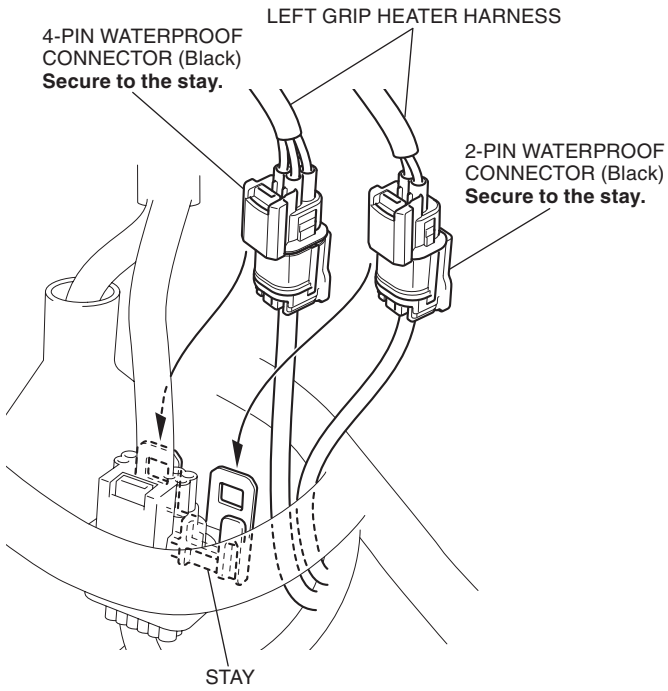

38. Secure the left grip heater harness with the wire tie as shown.

- Secure the left grip heater harness to the underside of the motorcycle's harness.

<Left side>

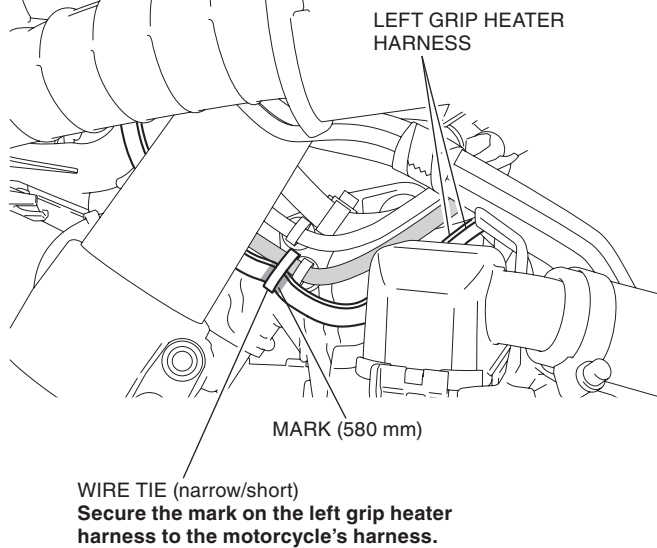

39. Secure the left grip heater harness with the wire tie as shown.

- Secure the left grip heater harness to the underside of the motorcycle's harness.

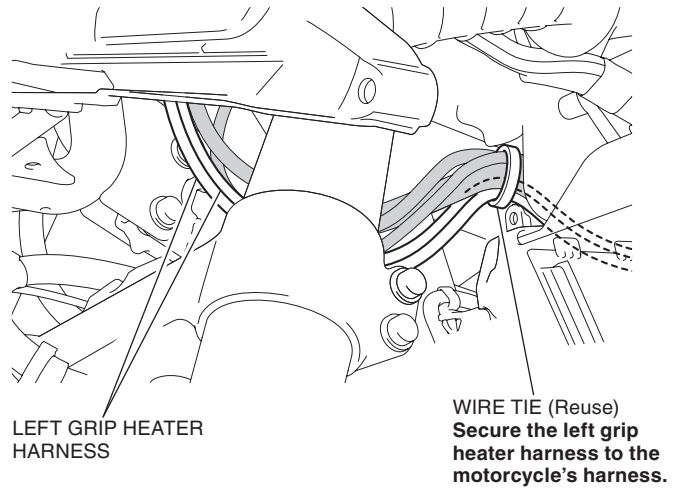

40. Remove the screws from the motorcycle as shown.

<Right side>

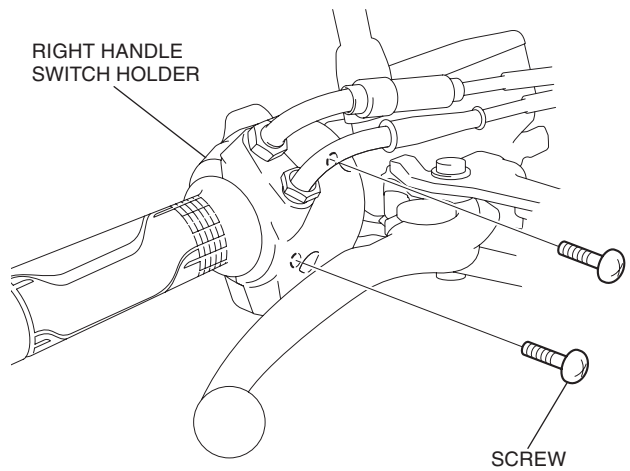

41. Remove the right grip as shown.

NOTE

Disconnect the throttle cable from the right grip as instructed in the motorcycle's Service Manual. Do not try to disconnect the cable with force using the pliers, etc. Refer to the motorcycle's Service Manual.

<Right side>

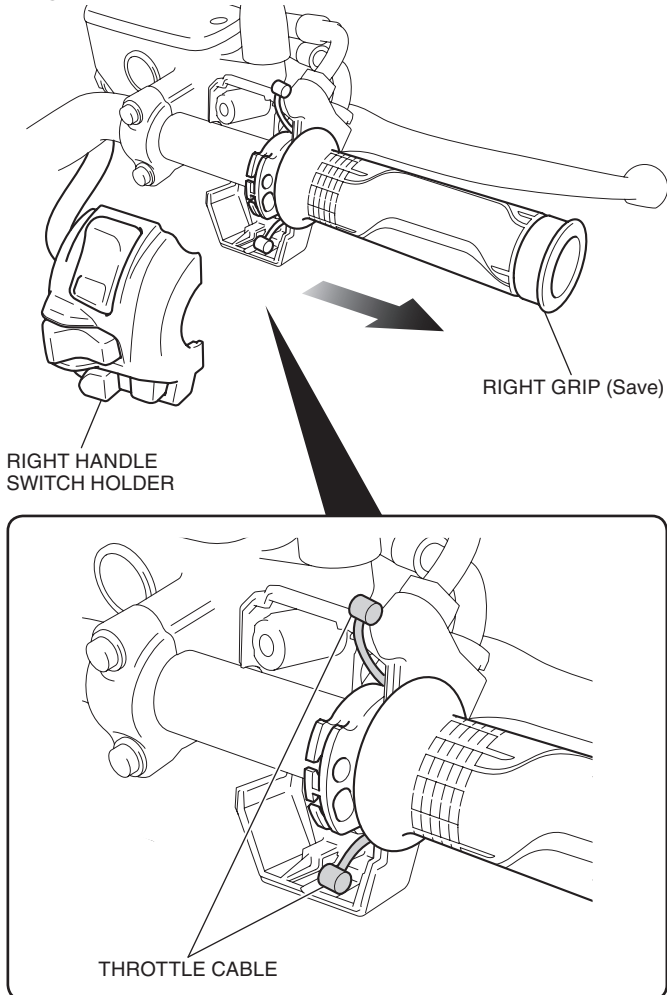

42. Mark the right grip heater harness in the position shown.

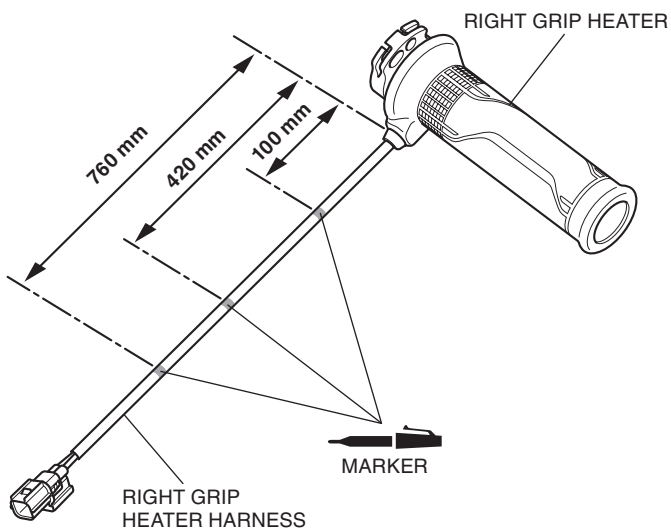

43. Install the clip bands on the marked position as shown.

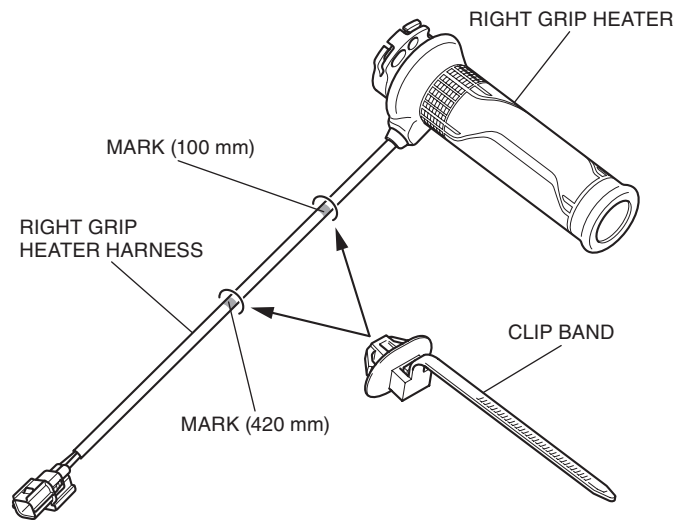

44. Apply grease to the [] parts of the throttle cables and inner grip as shown.

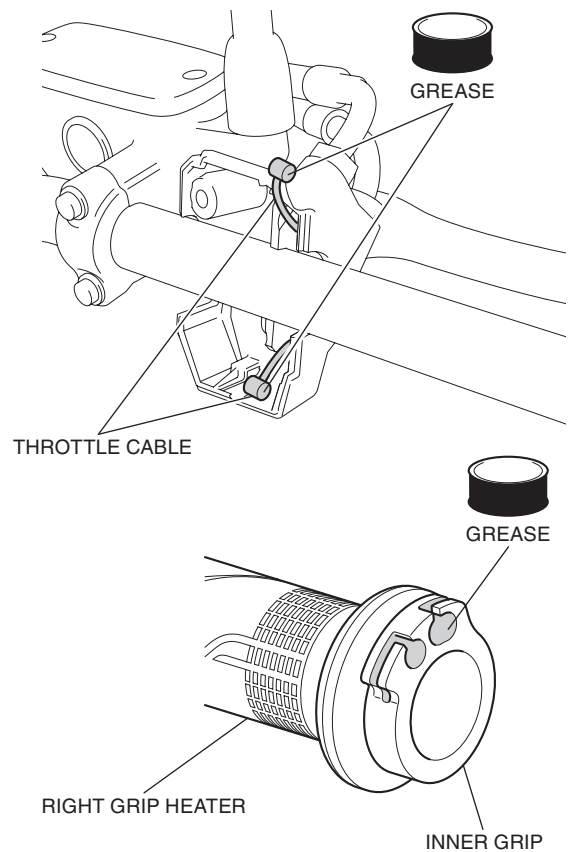

45. Install the right grip heater and right handle switch holder in the reverse order of removal.

- **After installation, refer to the Service Manual and adjust the throttle freeplay.**

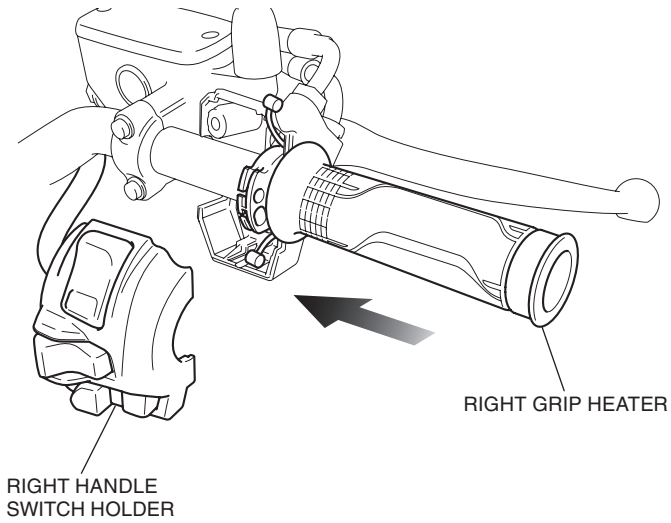

46. Twist the throttle grip as shown.

- **Check for smooth opening of the throttle and that it automatically snaps closed from any opening, in all steering positions.**

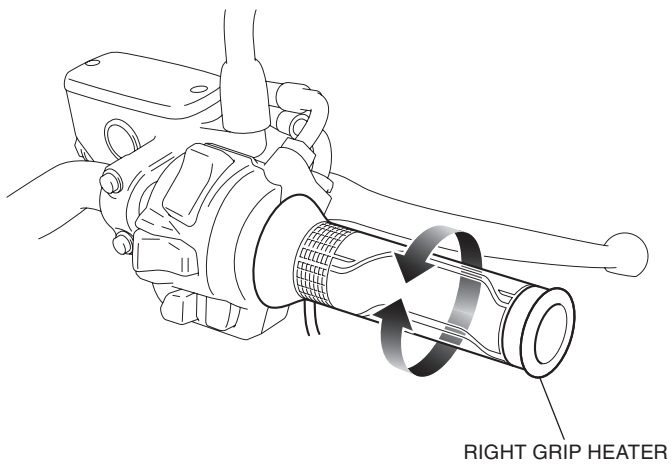

47. Remove the bolt as shown.

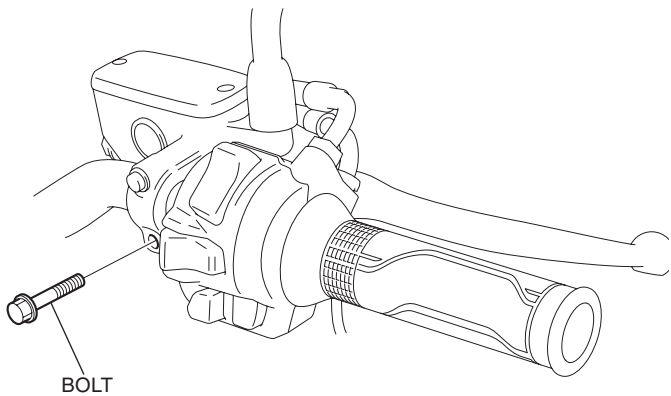

48. Install the clamp as shown.

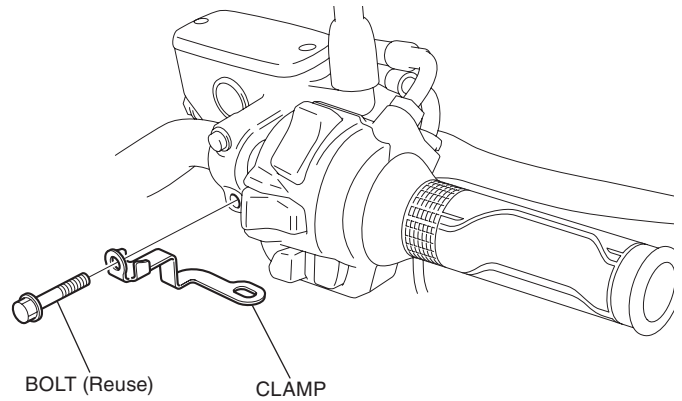

49. Secure the right grip heater harness as shown.

- **Open and close the throttle and confirm that there is no tightness of the grip heater harness.**

<Right side>

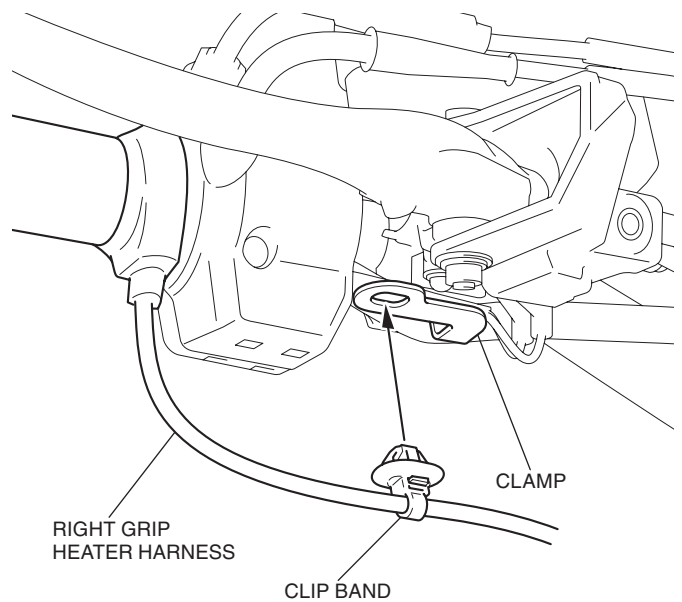

50. Route the right grip heater harness as shown and secure the harness.

<Right side>

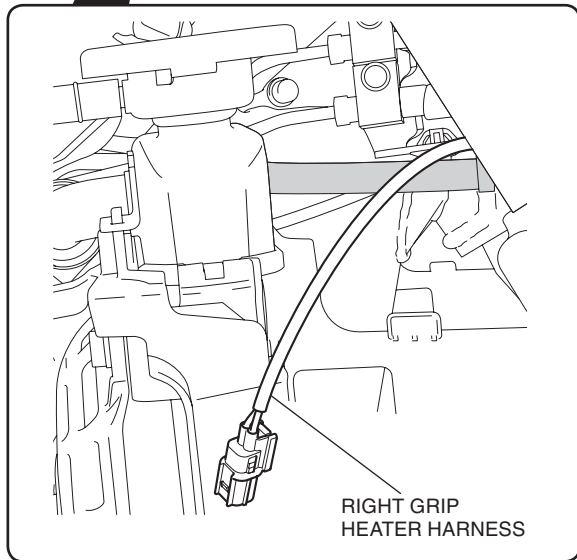
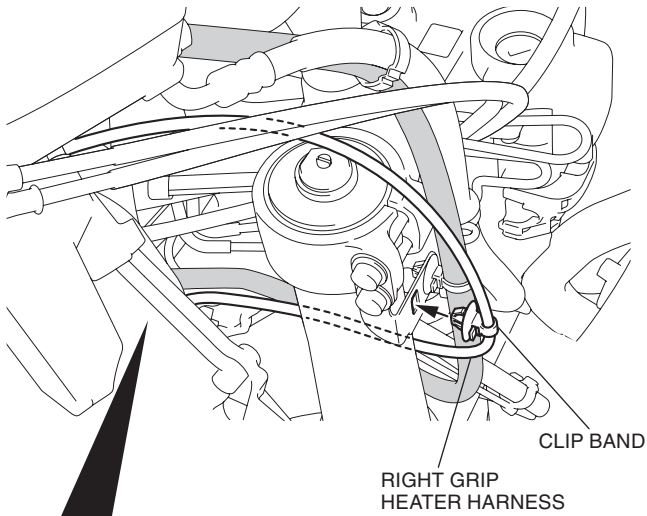

51. Secure the right grip heater harness with the clamp as shown.

CLAMP (Reuse)
Secure the right grip heater harness, brake hose and motorcycle's harness.

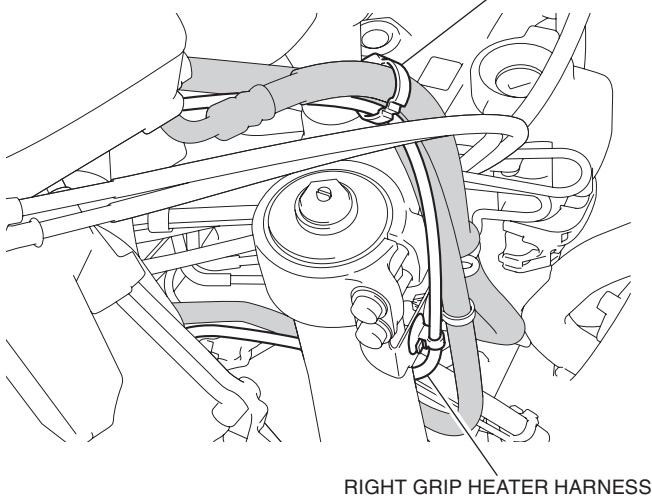

52. Remove the hose and connectors as shown.

<Right side>

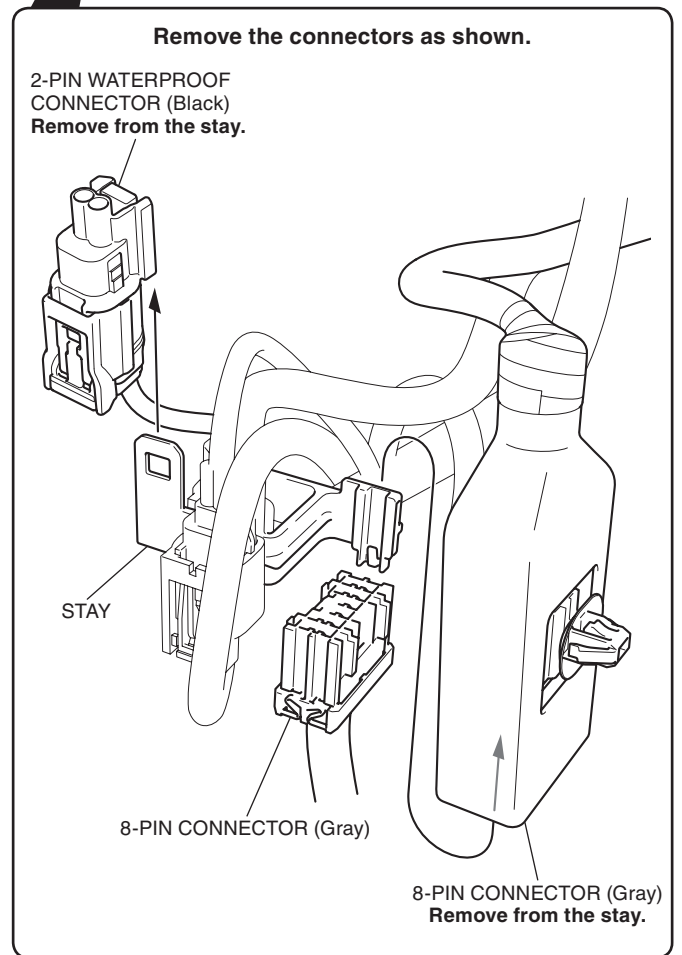
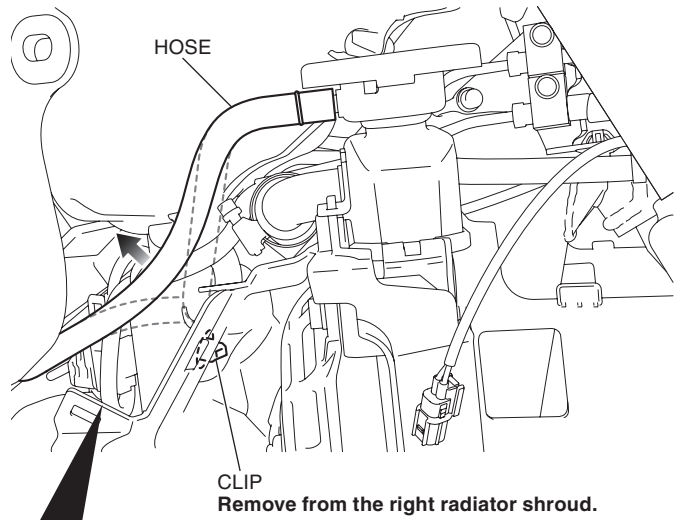

53. Remove the tape from the motorcycle's harness as shown.

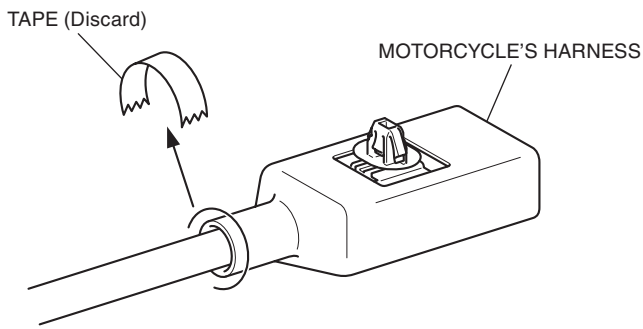

54. Work on the motorcycle's harness to the dimension shown.

- **Be careful not to cut the codes.**

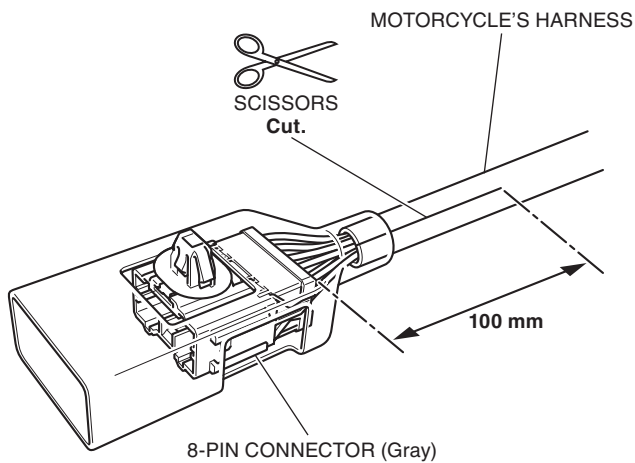

55. Take out the code as shown and attach electrical tape at the indicated position.

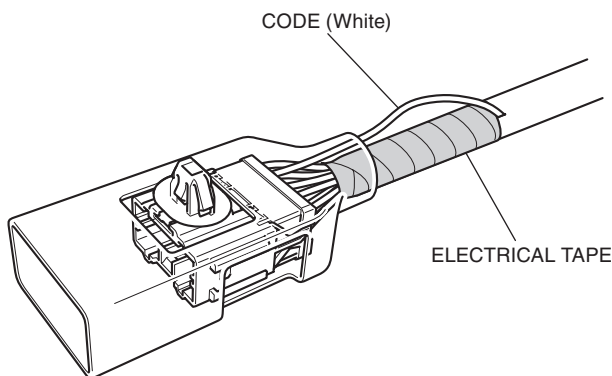

56. Wind the slit tube as shown.

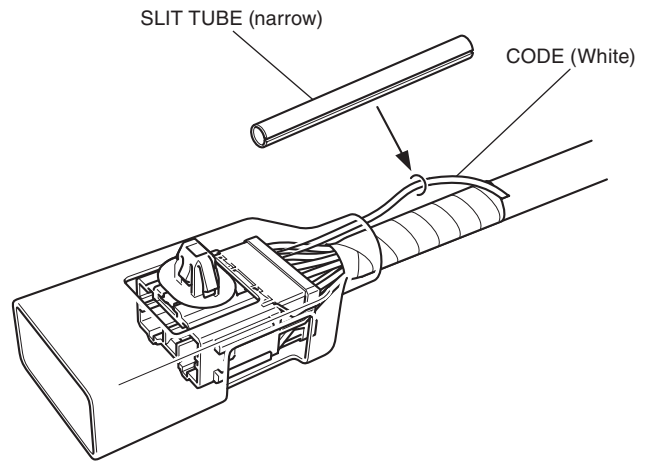

57. Install the noise filter as shown.

- **Check that the slit tube is not caught.**
- **Check that the noise filter rotates properly.**

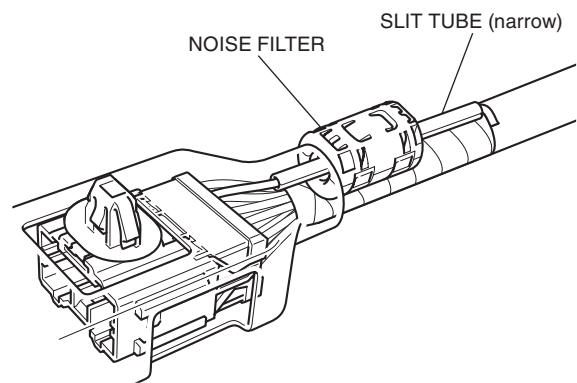

58. Wind the slit tube as shown.

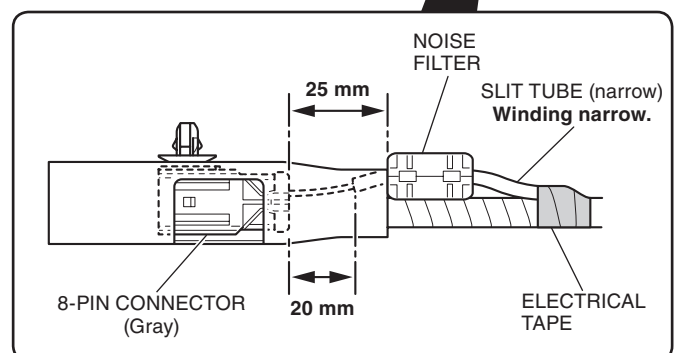
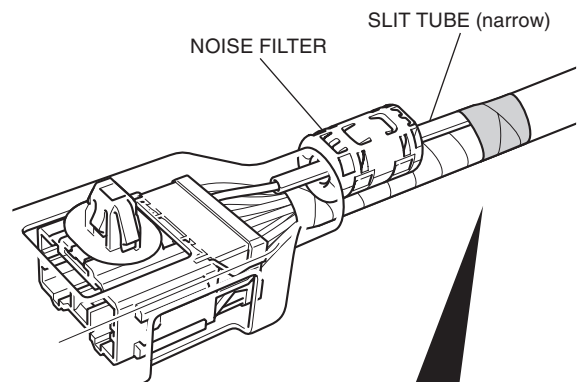

59. Fit the slit tube over the noise filter as shown.

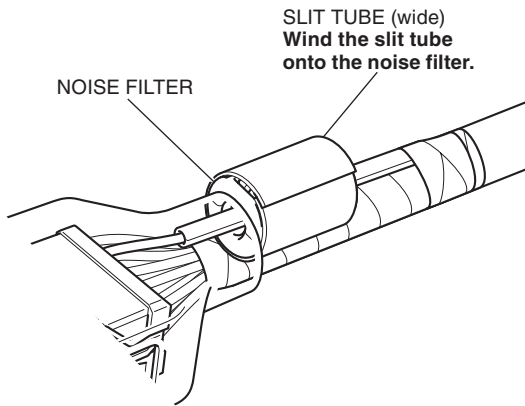

60. Secure the noise filter with electrical tape as shown.

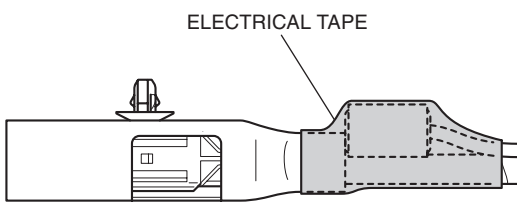

Secure the noise filter to the clip side as shown.

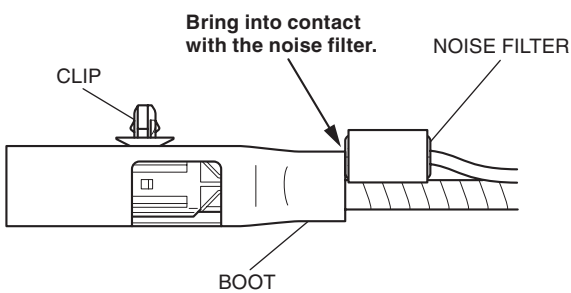

61. Install the 8-pin connector in the reverse order of removal and to make sure that from the end of the 8-pin connector is within 40mm.

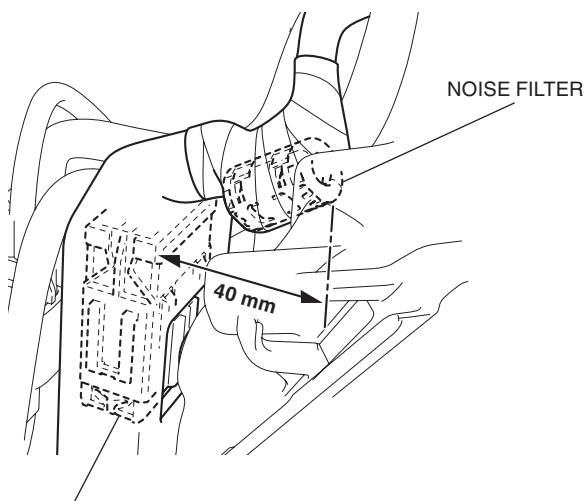

62. Remove the dummy connector as shown.

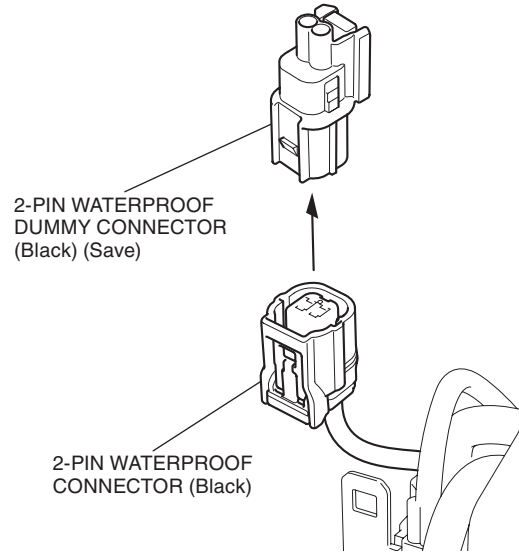

63. Route the right grip heater harness as shown.

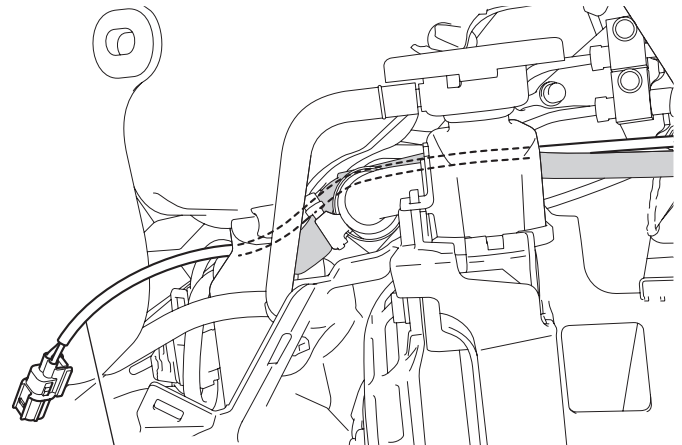

64. Connect the right grip heater harness as shown.

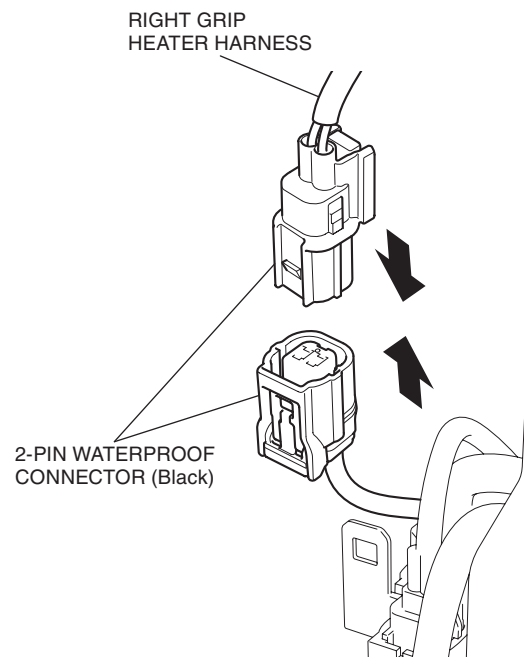

65. Secure the right grip heater harness as shown.

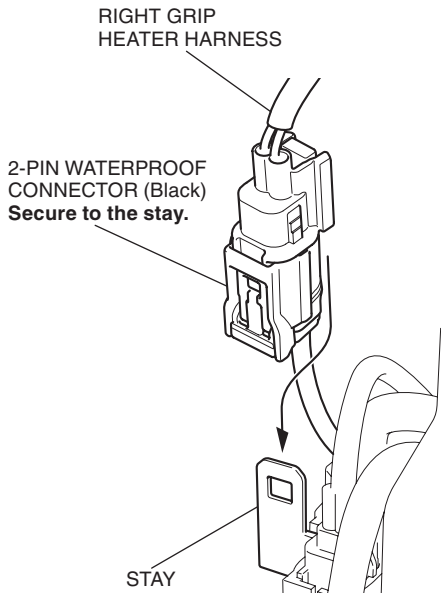

66. Secure the right grip heater harness with the wire tie as shown.

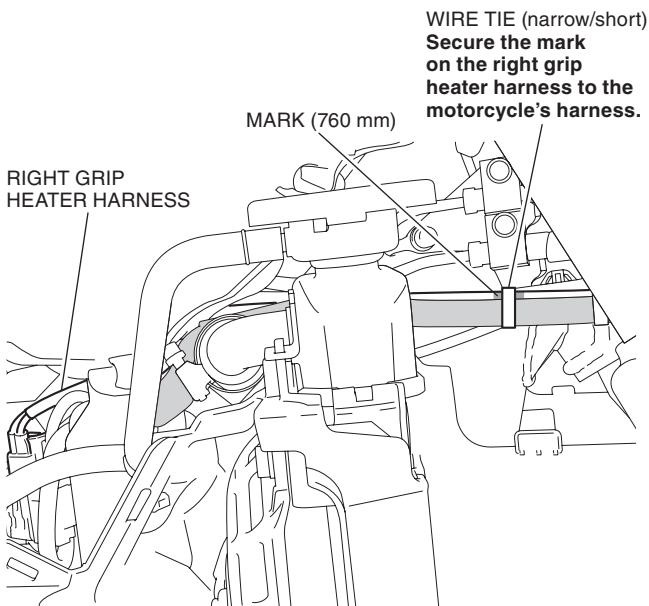

67. Check each harness for sufficient play.

- Move the handlebar right and left and check that the harnesses are not pinched by neighboring components and that they are not pulled taut.

68. Install the suspension as shown.

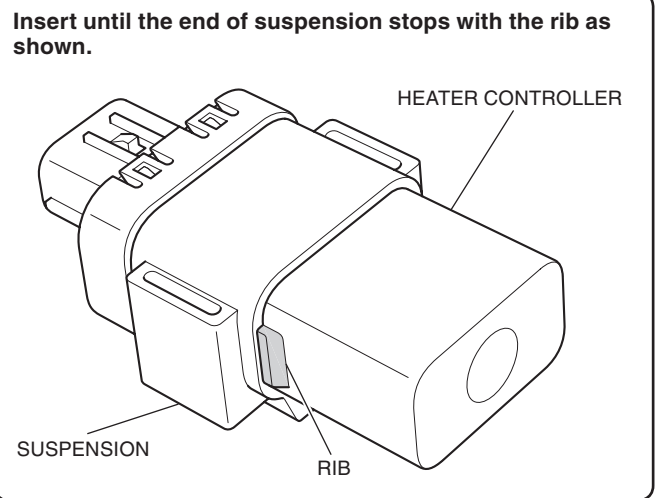
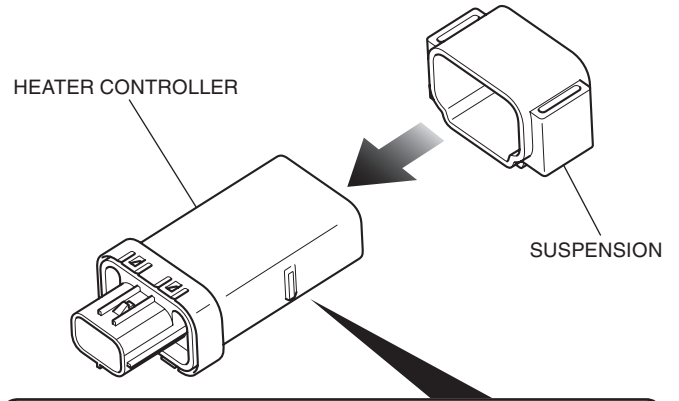

69. Install the heater controller stay as shown.

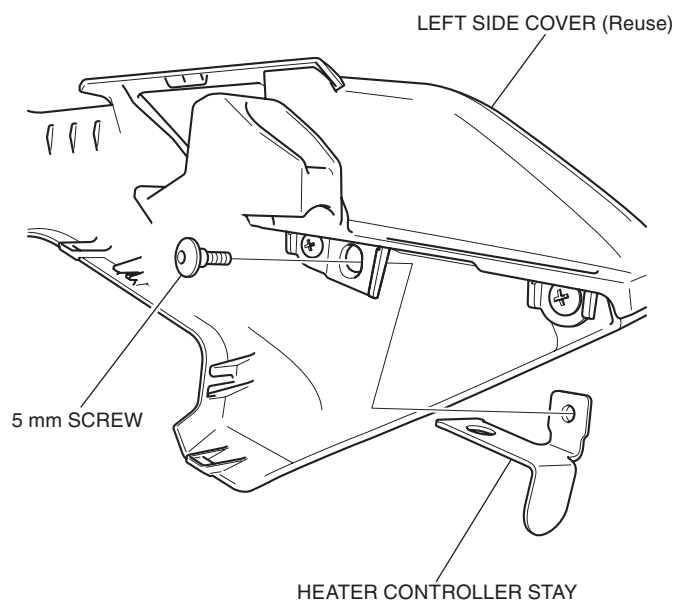

70. Install the heater controller as shown.

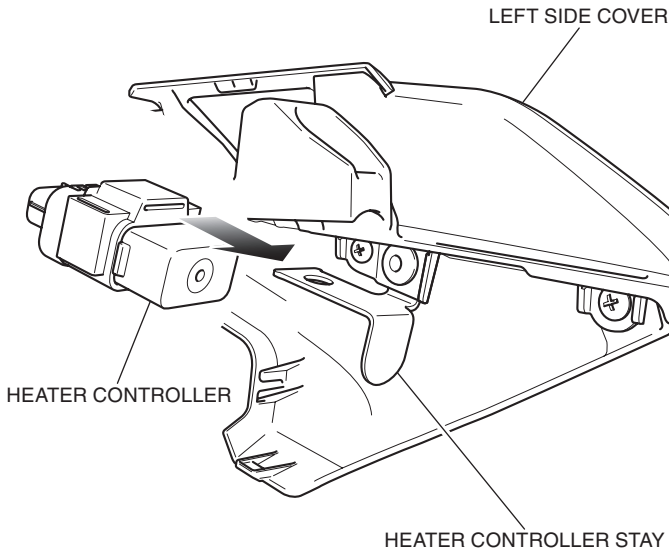

71. Remove the dummy connector as shown.

<Left side>

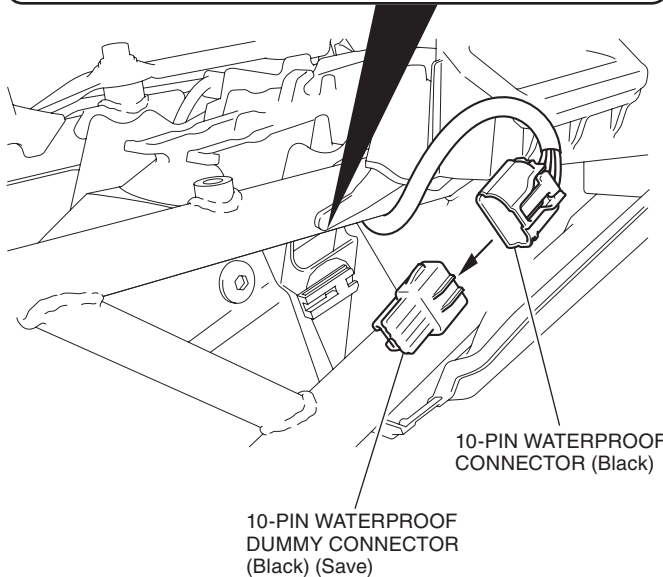
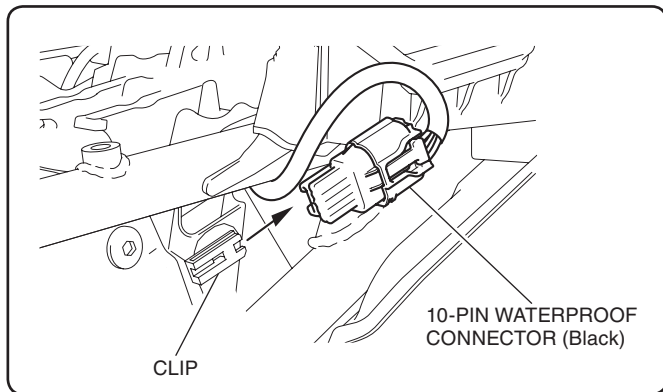

72. Connect the heater controller as shown, and install the left side cover in the reverse order of removal.

- Confirm that any wire harness is not caught or too tight.

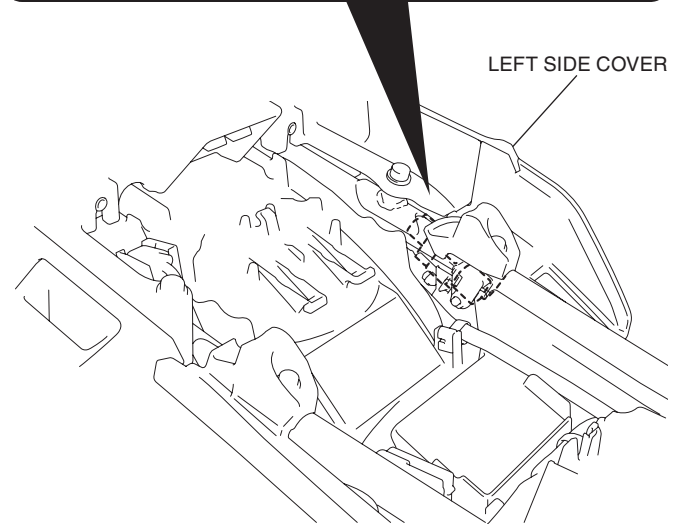
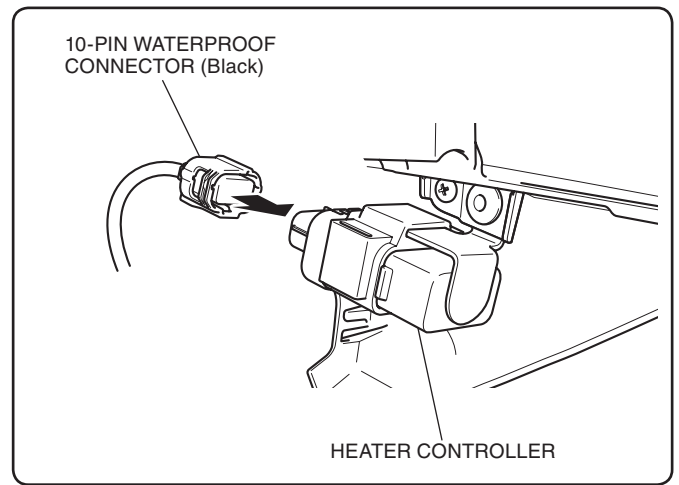

73. Reinstall the parts as shown.

- **Clean up with isopropyl alcohol before applying thread lock.**
- **Be sure to apply to the threads of the bolt.**
- **Repeat on the right side.**

<Left side> CRF1000A/D

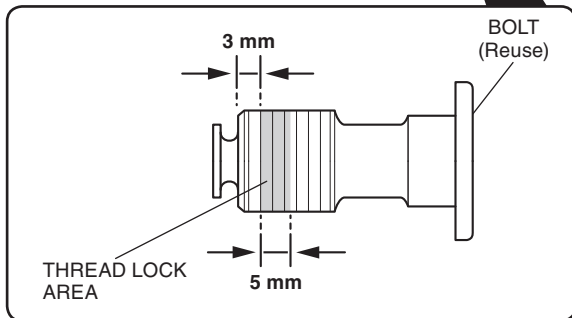
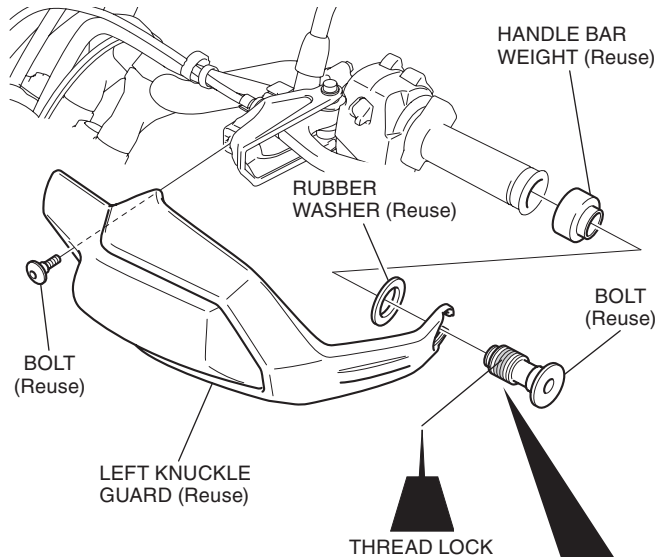

<Left side> CRF1000

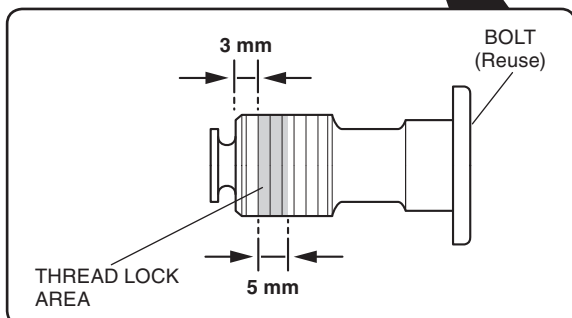
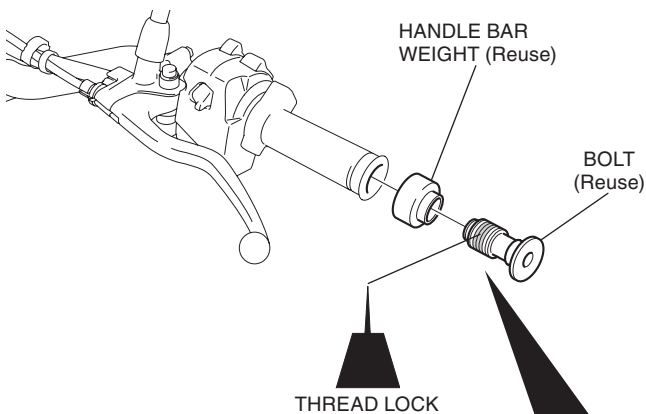

74. Install the motorcycle's parts in the reverse order of removal.

- **Confirm that any wire harness is not caught or too tight.**

75. Check the grip heater, throttle, headlight and the other lights for proper operation.







- **Perform the operation check at least one hour after attaching the left grip heater. Do not set the heater level at more than 3.**
- **Make sure to turn off the heater switch after the operation check.**

Please Convey The Following Information To The Customer Before Delivery.

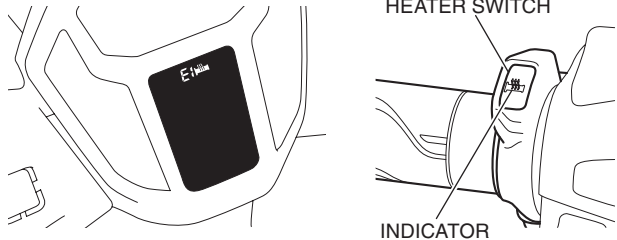
- **Please set the heater level at less than 2 one week after attachment.**

DEALER TROUBLESHOOTING

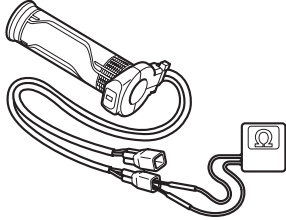
- Stop the engine and turn the main switch OFF when you check the parts and circuits other than those of the grip heaters.

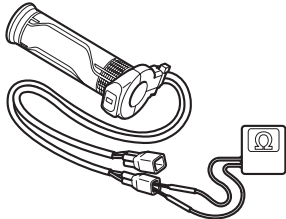
Symptom	Check
<p>“E1,” “E2” or “E3” status display and grip heater status icon blink alternately, and also heater switch indicator blinks.</p>  <p>HEATER SWITCH</p> <p>INDICATOR</p>	<p>Check for loose or poor contact connectors. Refer to the SYSTEM DIAGRAM of this manual and check for fuse blown.</p>
 <p>Blink.</p>  <p>Blink once.</p>	<p>Check for E1 status (Low battery voltage) :</p> <ol style="list-style-type: none"> 1. Check the battery voltage.
 <p>Blink.</p>  <p>Blink twice.</p>	<p>Check for E2 status (Short circuit) :</p> <ol style="list-style-type: none"> 1. Grip heater inspection. Check for resistance between the terminals. Standard : <Right> 8.2 ohms +/- 10% <Left> 8.2 ohms +/- 10%  <ol style="list-style-type: none"> 2. Refer to the SYSTEM DIAGRAM of this manual and check for a short circuit in the grip heater related wires. 3. If no abnormality is found after the above checks 1 and 2, but the grip heater still does not operate properly, replace the grip heater (heater controller) with a new one.
 <p>Blink.</p>  <p>Blink 3 times.</p>	<p>Check for E3 status (Faulty grip heater switch) :</p> <ol style="list-style-type: none"> 1. Replace the grip heater (heater switch) with a new one. It is hard to check the switch with ordinary inspection methods (for continuity, voltage, etc.,) because it contains an integrated circuit. <p>Check for E3 status (Open circuit) :</p> <ol style="list-style-type: none"> 1. Grip heater inspection. Check for resistance between the terminals. Standard : <Right> 8.2 ohms +/- 10% <Left> 8.2 ohms +/- 10%  <ol style="list-style-type: none"> 2. Refer to the SYSTEM DIAGRAM of this manual and check for an open circuit in the grip heater related wires. 3. If no abnormality is found after the above checks 1 and 2, but the grip heater still does not operate properly, replace the grip heater (heater controller) with a new one.

SYSTEM DIAGRAM

