



INSTALLATION INSTRUCTIONS

Accessory

REAR TIRE HUGGER
P/N 08F63-MGE-101

Application

VFR1200F

Publications No.

MII 13068

Issue Date

March 2010

Honda Dealer: Please give a copy of these instructions to your customer.

PARTS LIST

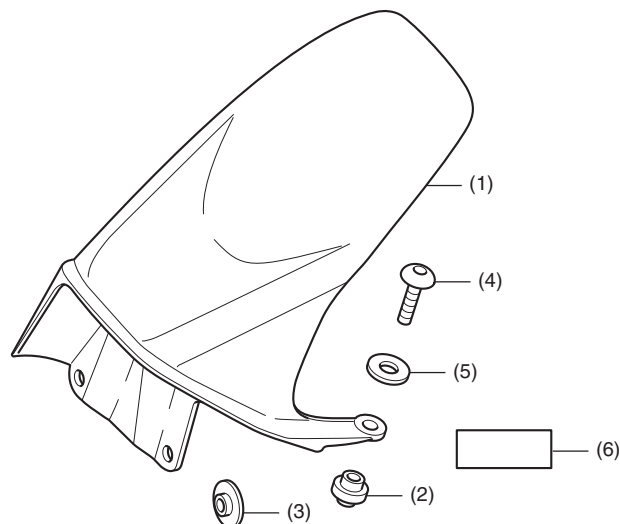

No.	Description	Qty
(1)	Hugger	1
(2)	Collar	1
(3)	Flange collar	2
(4)	6 mm bolt	3
(5)	Washer	1
(6)	Protection tape	1

TOOLS REQUIRED

Hex wrench (4 mm)	Thread lock
Marker	Ruler
Isopropyl alcohol	Shop towel
Torque wrench	

TORQUE CHART

Tighten all screws, bolts, and nuts to their specified torque values. Refer to the Service Manual for the torque values of the removed parts.

Item	N-m	kgf-m	lbf-ft
6 mm bolt	10	1.0	7

USE AND CARE INFORMATION

- Check the accessory mounts frequently and retighten if necessary.

INSTALLATION

CAUTION:

- To prevent burns, allow the engine, exhaust system, etc., to cool before installing the accessory.
- Refer to the Service Manual for the motorcycle, remove the Rear wheel.
 - Support the motorcycle securely and raise the rear wheel off the ground using a center stand (sold separately) or hoist.**

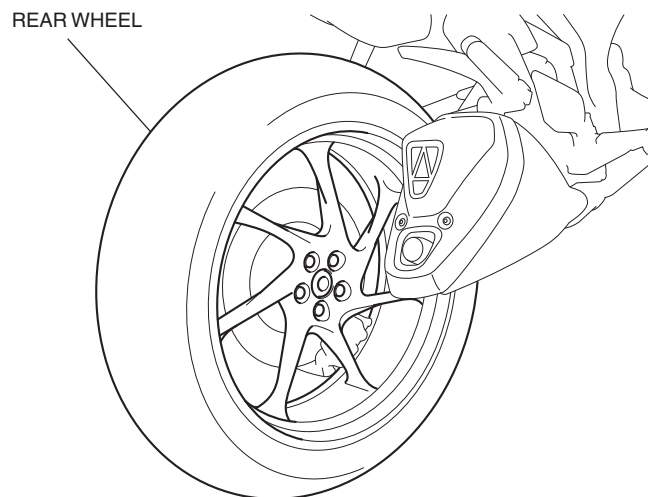

2. Remove the bolt and clips as shown.

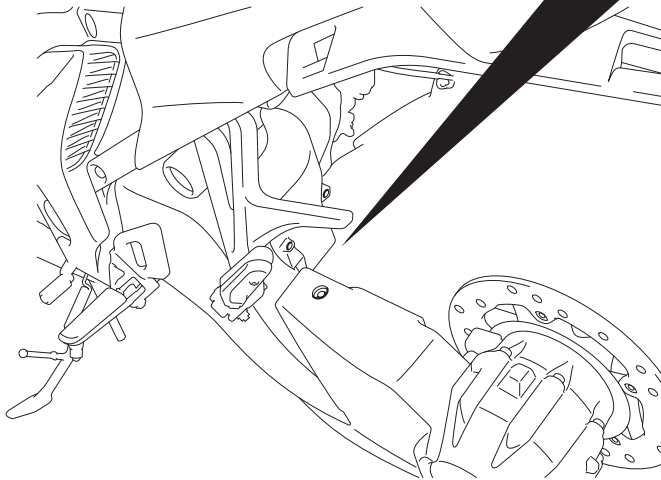
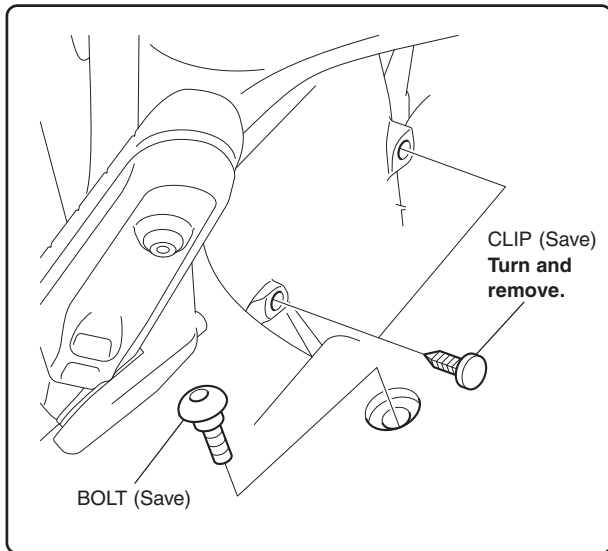

3. Clean the surface of the area shown using isopropyl alcohol.



ISOPROPYL ALCOHOL

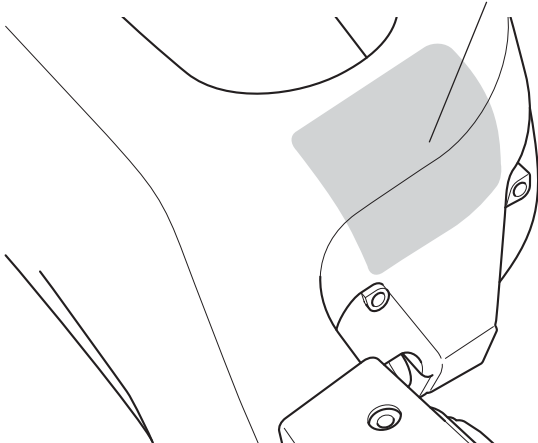

4. Place the hugger as shown.

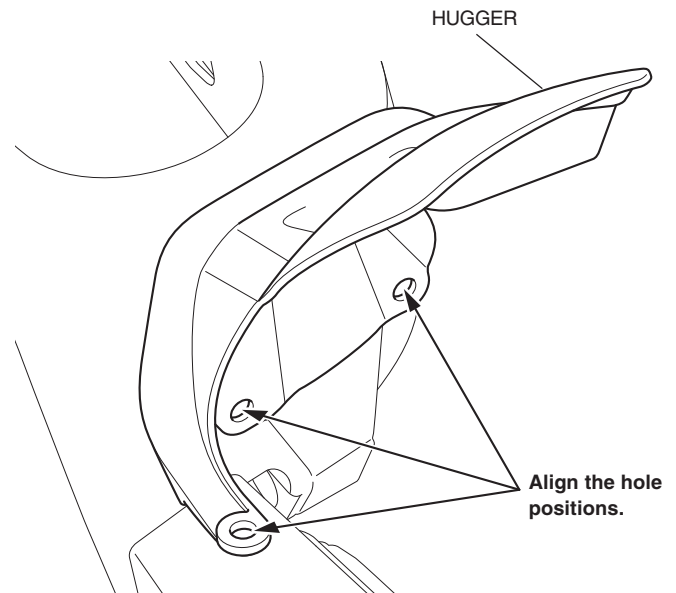

5. Mark the swingarm as shown in the figure.

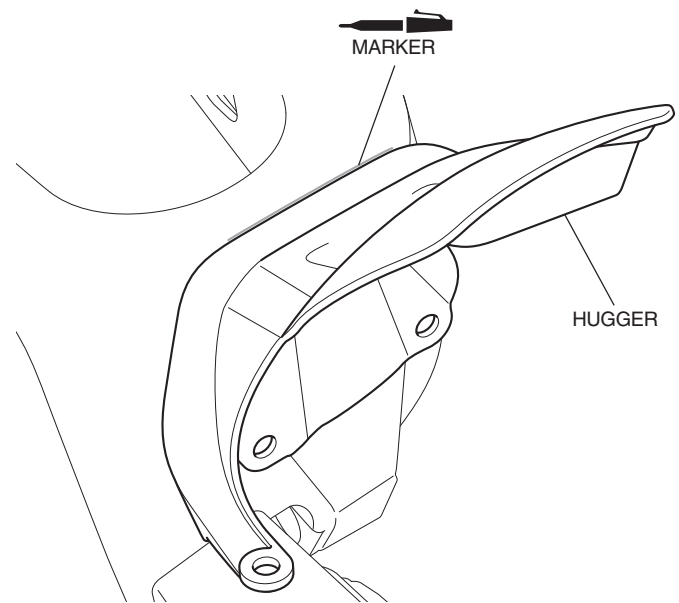

6. Remove the hugger and attach the protection tape to the swingarm according to the dimensions shown.

- **Attach the tape centered between the left and right hole.**

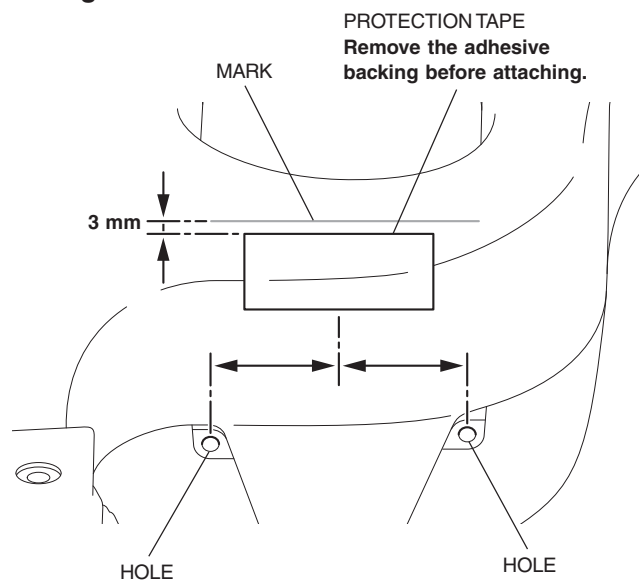

7. Install the collar as shown.

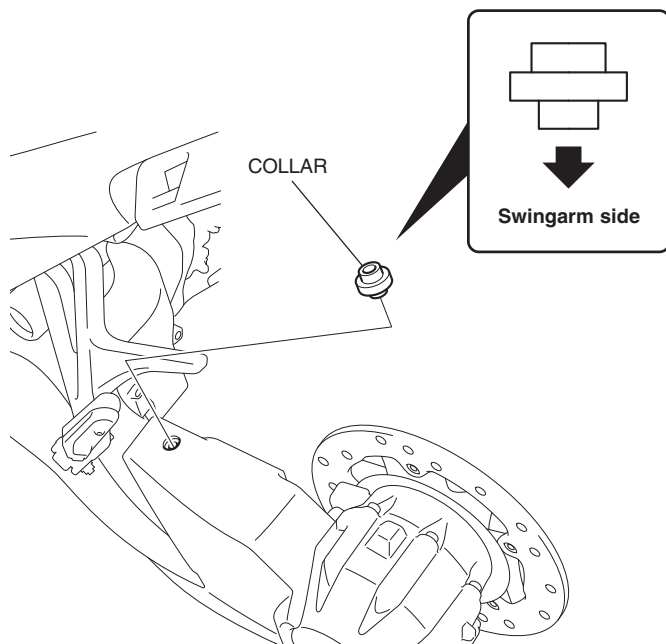

8. Install the hugger as shown.

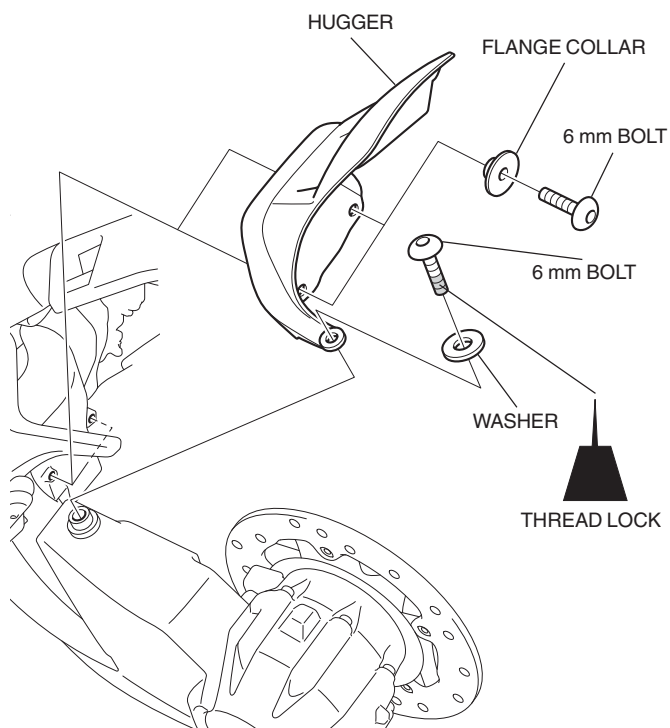

9. Install the rear wheel in the reverse order of removal.