

# HONDA

## INSTALLATION INSTRUCTIONS

Accessory  
**JUNCTION LEAD HEADSET**  
 P/N 08B70-MJG-670

Application  
**GL1800B**

Publication No.  
**MII 14360**  
 Issue Date  
**December 2012**

### PARTS LIST

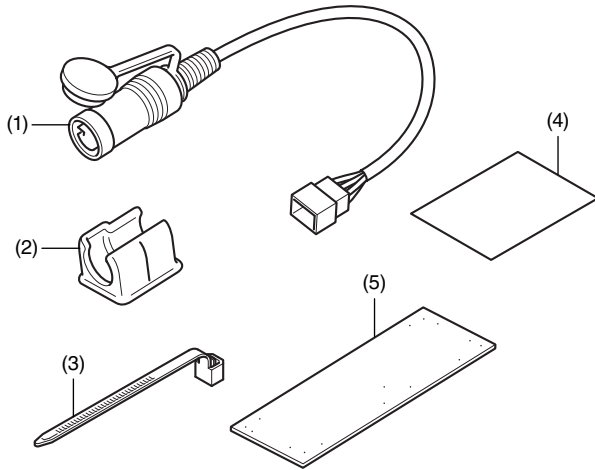

No.	Description	Qty
(1)	Junction lead headset	1
(2)	Connector holder	1
(3)	Wire tie	1
(4)	Inatallation Instruction URL	1
(5)	Cushion tape	1

### SUPPLIES REQUIRED

Marker  
 Ruler  
 Scissors  
 Isopropyl alcohol  
 Shop towel

### TORQUE CHART

Refer to the Service Manual for the torque values of the removed parts.

### INSTALLATION

#### NOTE:

- Heat the bonding surfaces with a hair dryer if the ambient air temperature is below 70°F (21°C).
- The adhesive reaches full strength in 72 hours. Wait at least 24 hours before riding your motorcycle.
- Disconnect the negative (-) cable from the battery before installing this accessory.
- After turning the ignition switch OFF, wait more than 10 seconds and then remove the negative cable of the battery.
- The memories of the tripmeter and clock will be erased when you disconnect the battery. Reset the clock after reconnecting the battery.
- Reinstall the removed parts on the motorcycle and make sure that the wires and harnesses are not pinched.

1. Remove the motorcycle's parts as shown.

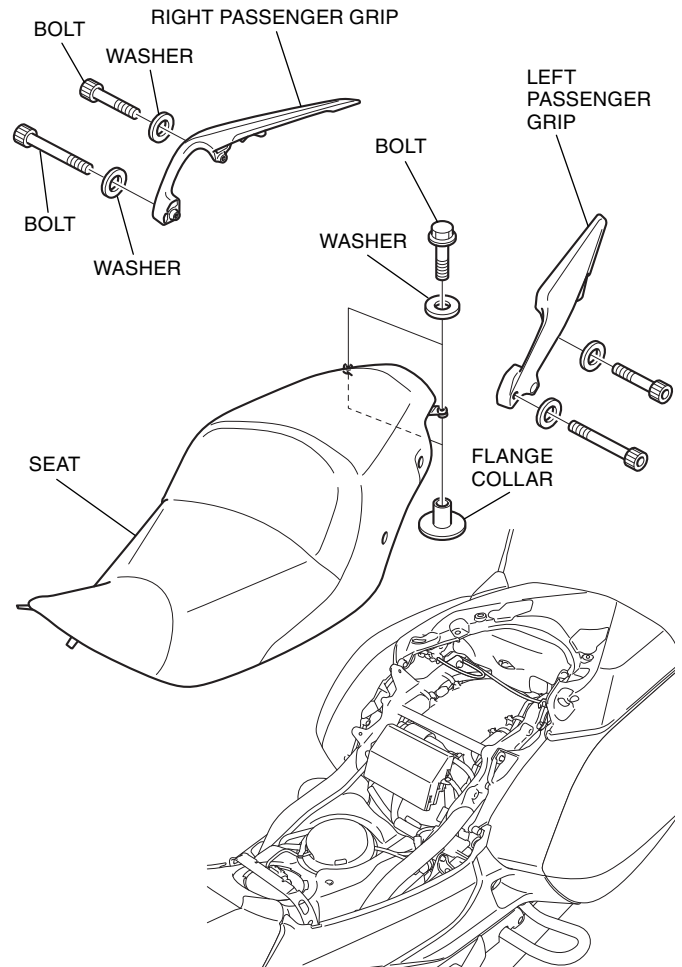

2. Remove the antenna as shown.

<Rear side>

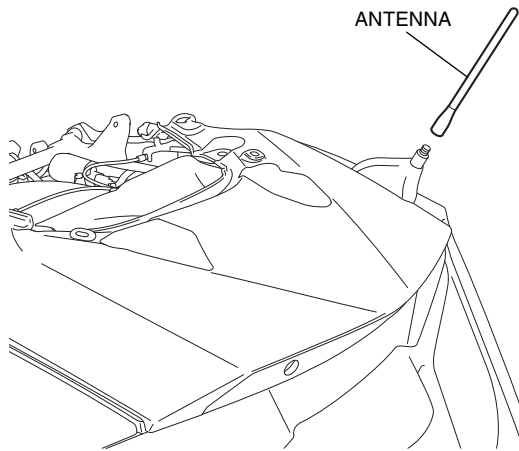

3. Remove the motorcycle's parts as shown.

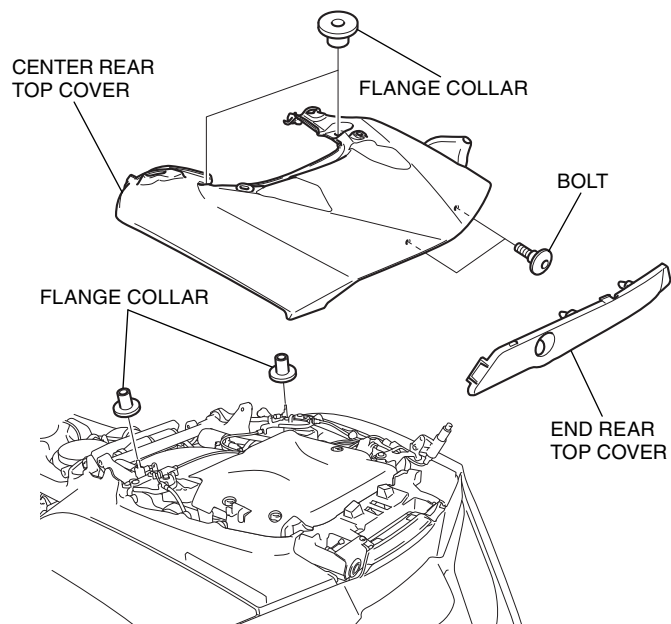

4. Open the left saddlebag lid as shown.

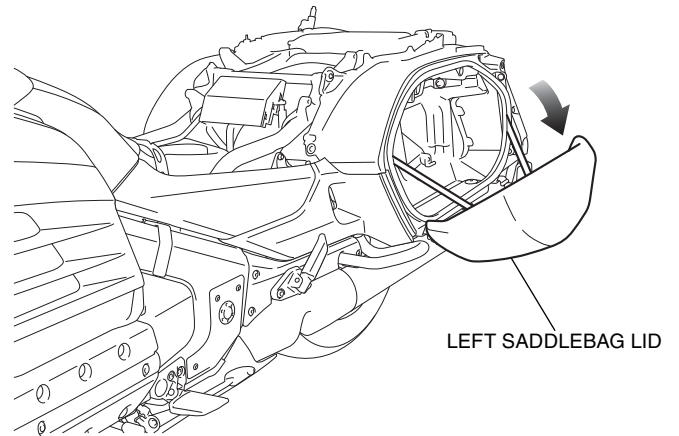

5. Remove the left side cover, and disconnect the negative (-) cable from the battery.

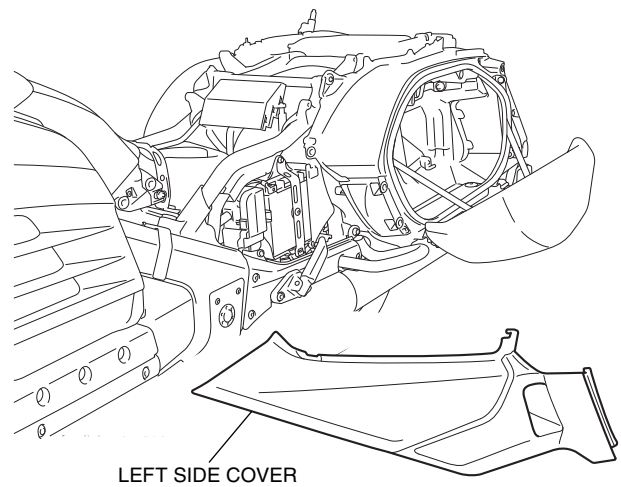

6. Attach the connector holder according to the dimension shown.

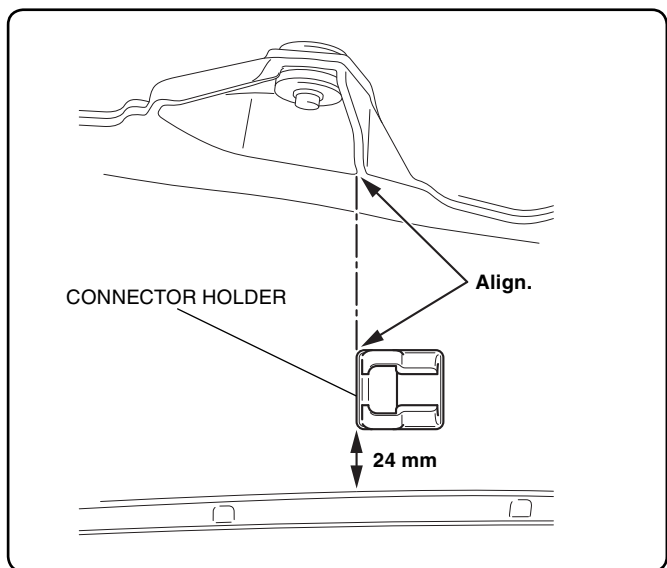

<Left side>

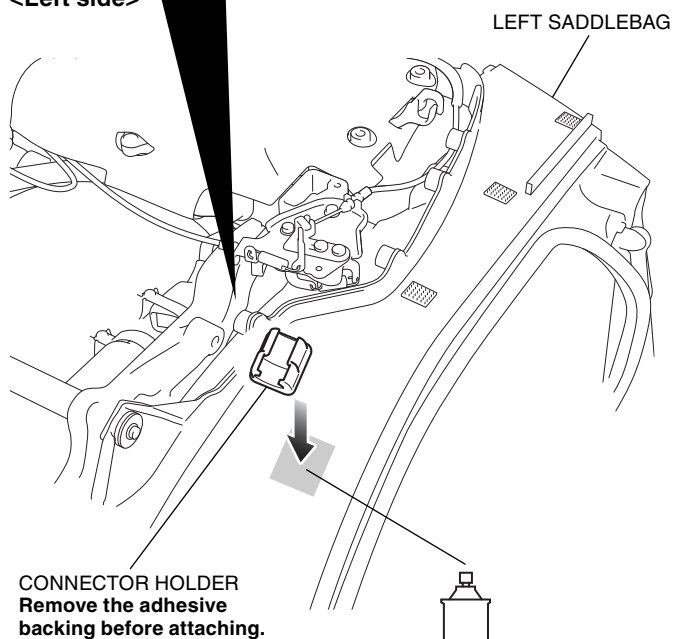

ISOPROPYL ALCOHOL  
Thoroughly clean the area where the connector holder will be attached.

7. Mark the junction lead headset in the position shown.

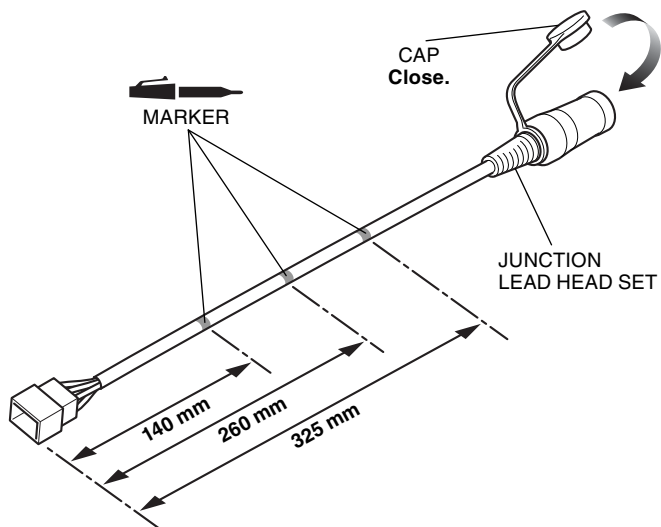

8. Cut the cushion tape to the dimension as shown.

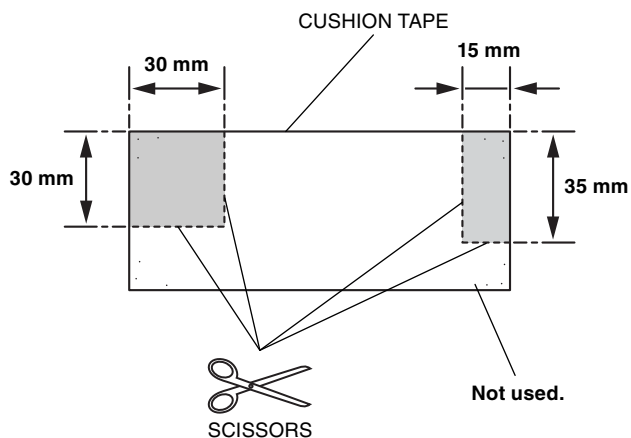

9. Secure the junction lead harness as shown.

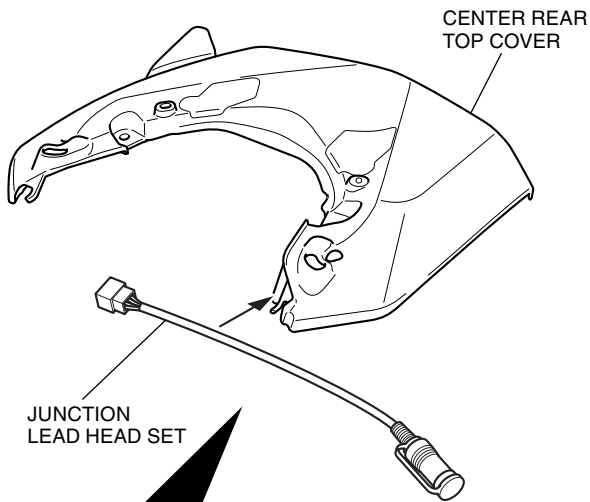

**Attach the cushion tape without it sticking out.**

CUT PIECE OF CUSHION TAPE (15 mm x 35 mm)  
**Clean the attachment surface thoroughly with isopropyl alcohol and attach after removing the adhesive backing.**

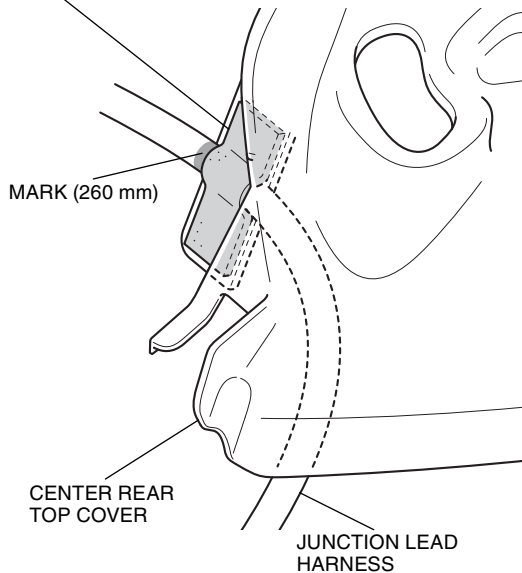

10. Secure the junction lead harness as shown.

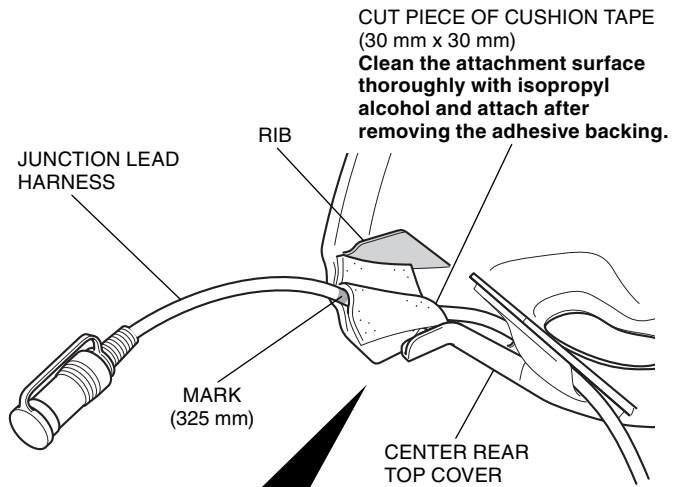

**Attach the cushion tape without it sticking out.**

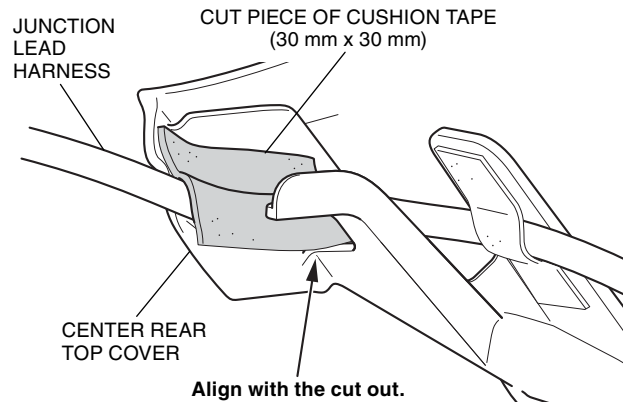

11. Install the center rear top cover in the reverse order of removal.

- **Confirm that any wire harness is not caught or too tight.**

12. Route the junction lead headset as shown.

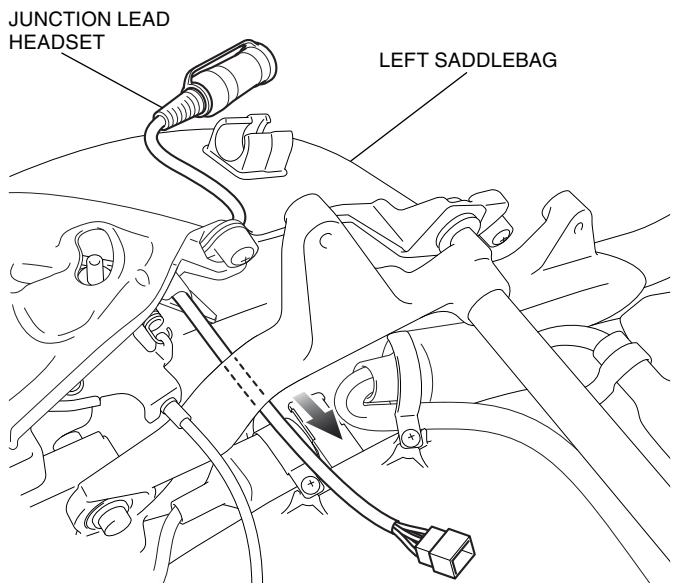

13. Connect the junction lead headset as shown.

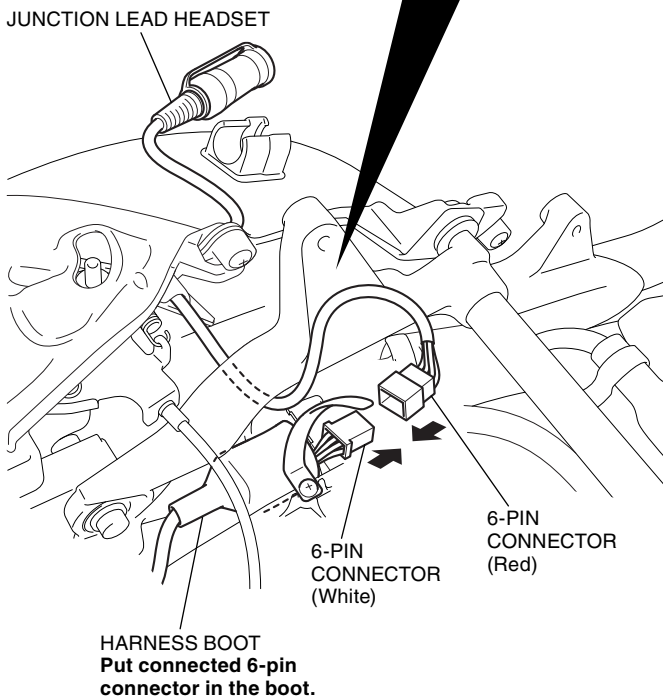
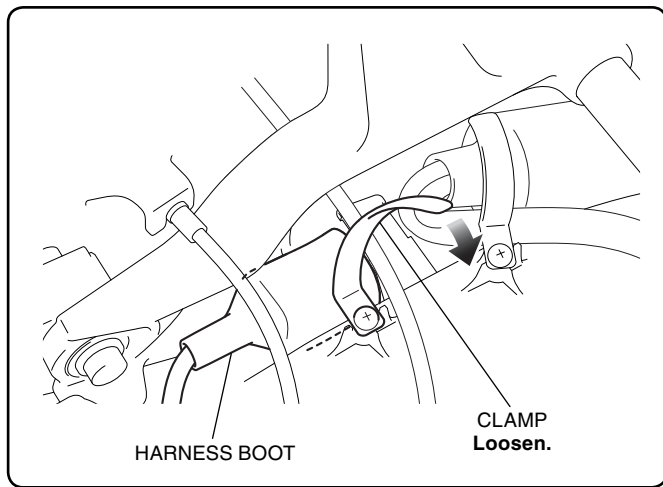

14. Secure the junction lead headset with the wire tie as shown.

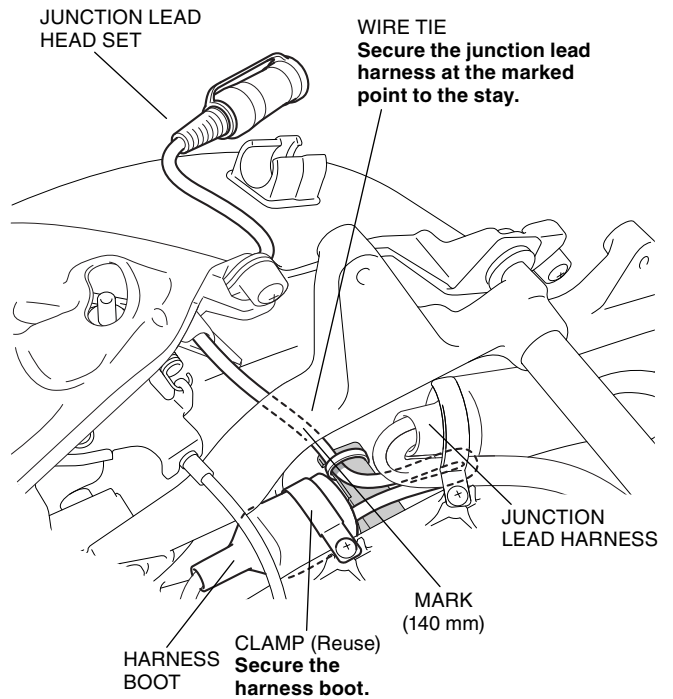

15. Install the motorcycle's parts in the reverse order of removal.

- Confirm that any wire harness is not caught or too tight.

16. Secure the junction lead head set to the connector holder as shown.

<Left side>

