

Accessory	Application	Publication No.
REAR CARRIER P/N 08L70-MGC-AA0	CB1100CA/NA	MII 16394
		Issue Date
		August 2017

Honda Dealer: Please give a copy of these instructions to your customer.

PARTS LIST

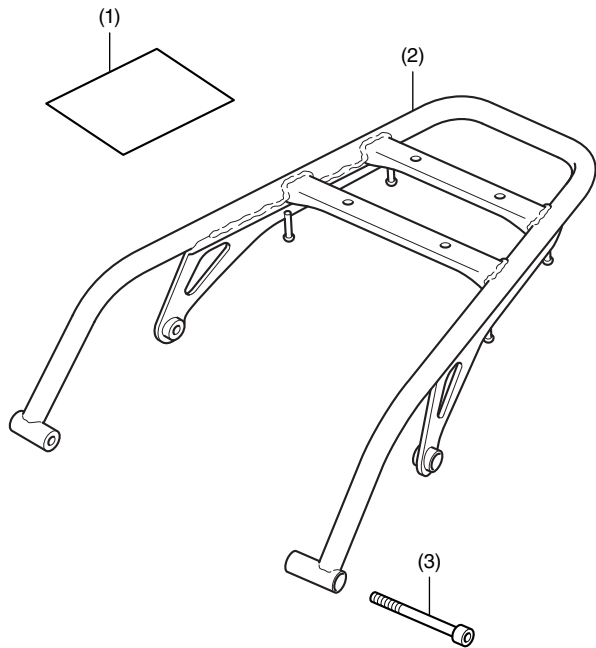

No.	Description	Qty
(1)	Installation Instruction URL	1
(2)	Rear carrier	1
(3)	8 mm socket bolt	4

TOOLS REQUIRED

Hex wrench (8 mm)
Torque wrench

TORQUE CHART

Tighten all screws, bolts, and nuts to their specified torque values. Refer to the Service Manual for the torque values of the removed parts.

Item	N-m	kgf-m	lbf-ft
8 mm socket bolt	40	4.1	30

MAXIMUM LOADING CAPACITY

- The weight of the cargo must not exceed the following maximum loading capacity:

Maximum Loading Capacity	
Rear carrier	8.0 kg (17.6 lb)

INSTALLATION

▲ CAUTION

- To prevent burns, allow the engine, exhaust system, radiator, etc., to cool before installing the accessory.

- Remove the motorcycle's parts as shown.
 - Repeat on the right side.

<Left side>

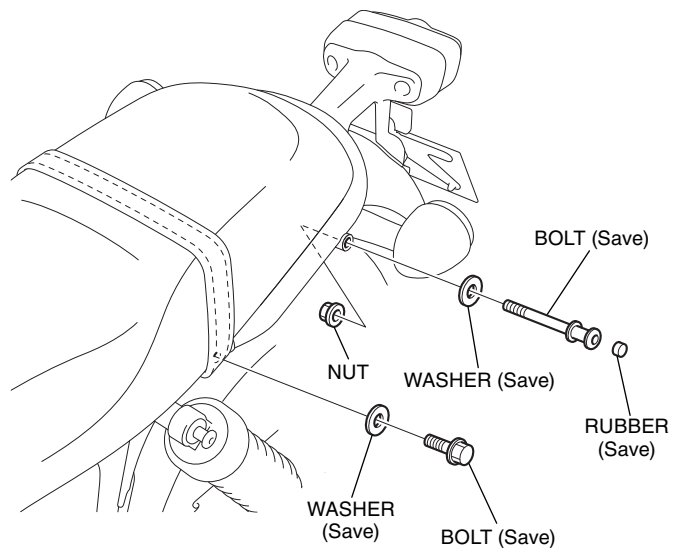

- Install the rear carrier as shown.
 - Repeat on the right side.

