

Honda Dealer: Please give a copy of these instructions to your customer.

PARTS LIST

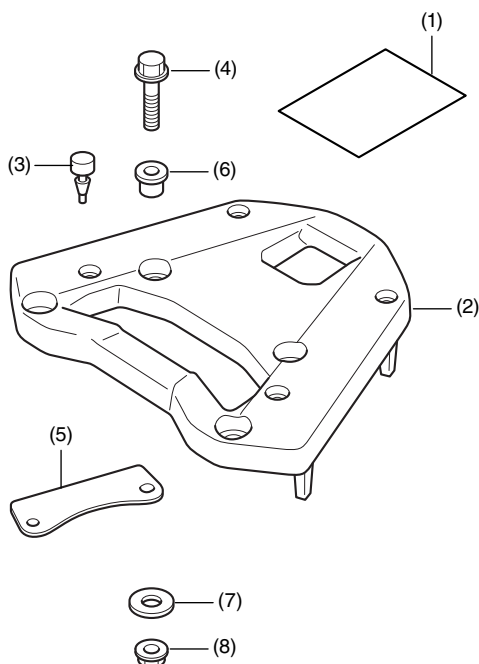

No.	Description	Qty
(1)	Installation instruction URL	1
(2)	Mount base	1
(3)	Cushion	4
(4)	8 mm flange bolt	4
(5)	Plate	2
(6)	Flange collar	8
(7)	Washer	4
(8)	8 mm flange nut	4

TOOLS REQUIRED

Socket (12 mm)

Ratchet

Box-end wrench (12 mm)

Torque wrench

TORQUE CHART

Tighten all screws, bolts, and nuts to their specified torque values. Refer to the Service Manual for the torque values of the removed parts.

Item	N·m	kgf·m	lbf·ft
8 mm flange nut	27	2.8	20

MAXIMUM LOADING CAPACITY

- The weight of the cargo must not exceed the following maximum loading capacity:

Maximum Loading Capacity	
Top Case Mount	9.0 kg (19.8 lb)

INSTALLATION

- Install the flange collars as shown.

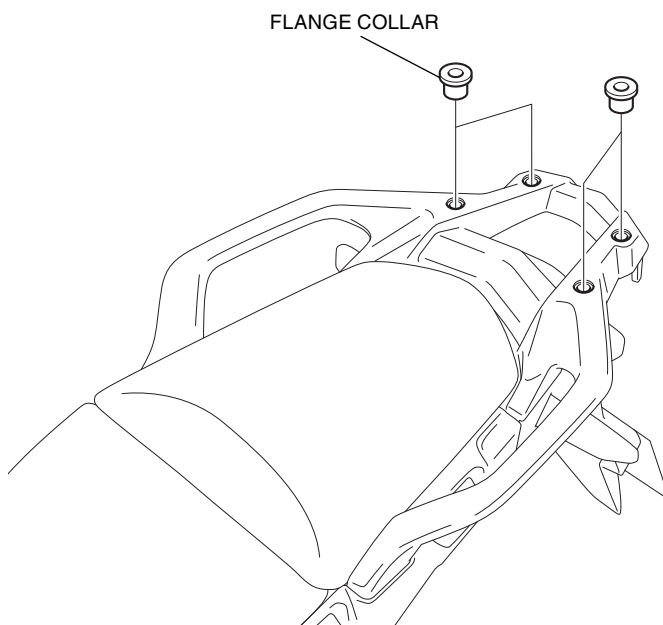

- Install the cushions on the mount base as shown.

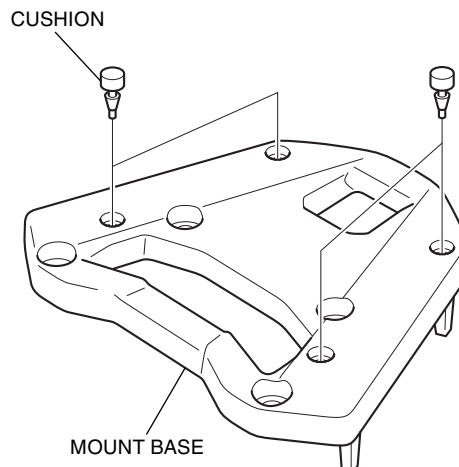

3. Install the flange collars on the mount base as shown.

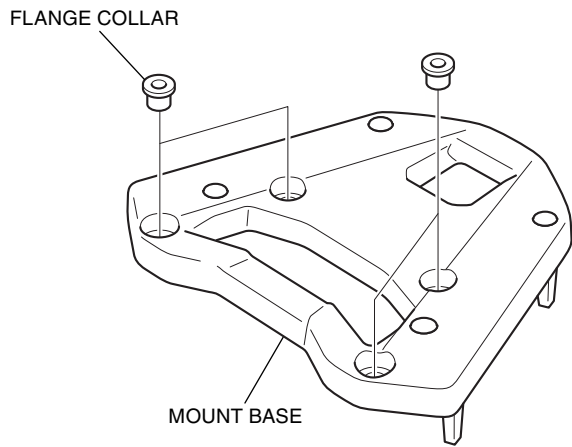

4. Install the mount base and plates as shown.

