



# INSTALLATION INSTRUCTIONS

Accessory  
**TANK BAG**  
P/N 08L56-MGE-100

Application  
**VFR1200F/FD**

Publications No.  
**MII 13236**  
Issue Date  
**April 2010**

**Honda Dealer: Please give a copy of these instructions to your customer.**

## PARTS LIST

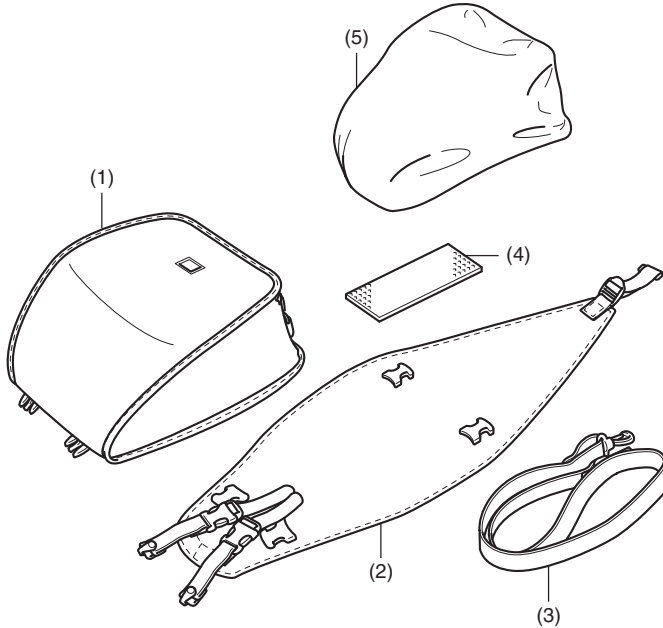

No.	Description	Qty
(1)	Tank bag	1
(2)	Tank bag base	1
(3)	Carry strap	1
(4)	Hook and loop tape	1
(5)	Rain cover	1

## SUPPLIES REQUIRED

Ruler  
Isopropyl alcohol  
Shop towel

## USE AND CARE INFORMATION

- The weight of the cargo must not exceed the following maximum weight capacity:

Maximum Weight Capacity	
Tank bag	6.6 lbs (3.0 kg)

- Before installation, remove all dust, sand, etc., from fuel tank and tank bag, as otherwise the fuel tank may be scratched.
- Confirm the tank bag is securely installed before riding.
- Do not place valuables or easily breakable items in this accessory. Do not leave the motorcycle with objects remaining in this accessory.
- Tighten the fasteners securely.
- This product is not completely waterproof. Water may enter the bag when the motorcycle is being washed or during heavy rain.
- Check the accessory mounts frequently and retighten if necessary.

## INSTALLATION

- Use the ignition key to unlock the seat. Remove the seat as shown.

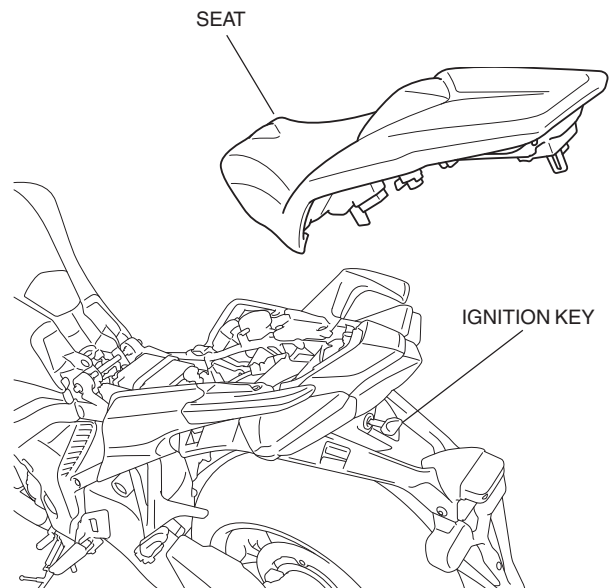

2. Attach the hook and loop tape in the position shown.

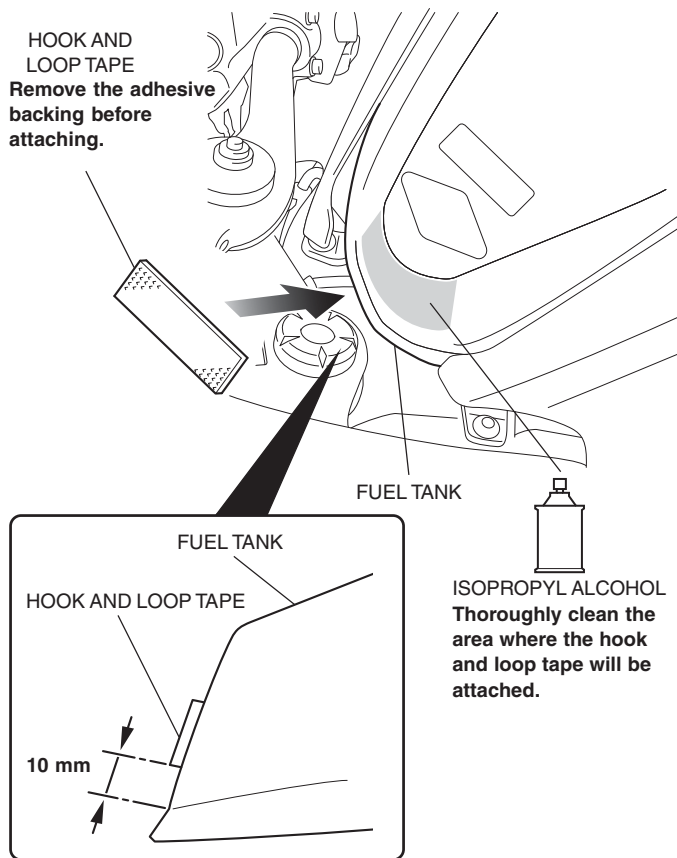

3. Remove the tank belt B from the tankbag base as shown.

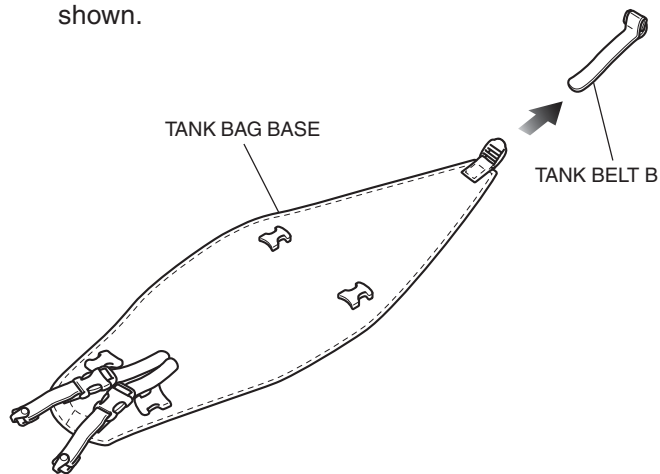

4. Install the tank bag base as shown.

- To prevent scratches, install the tank bag after wiping clean the top of the tank.

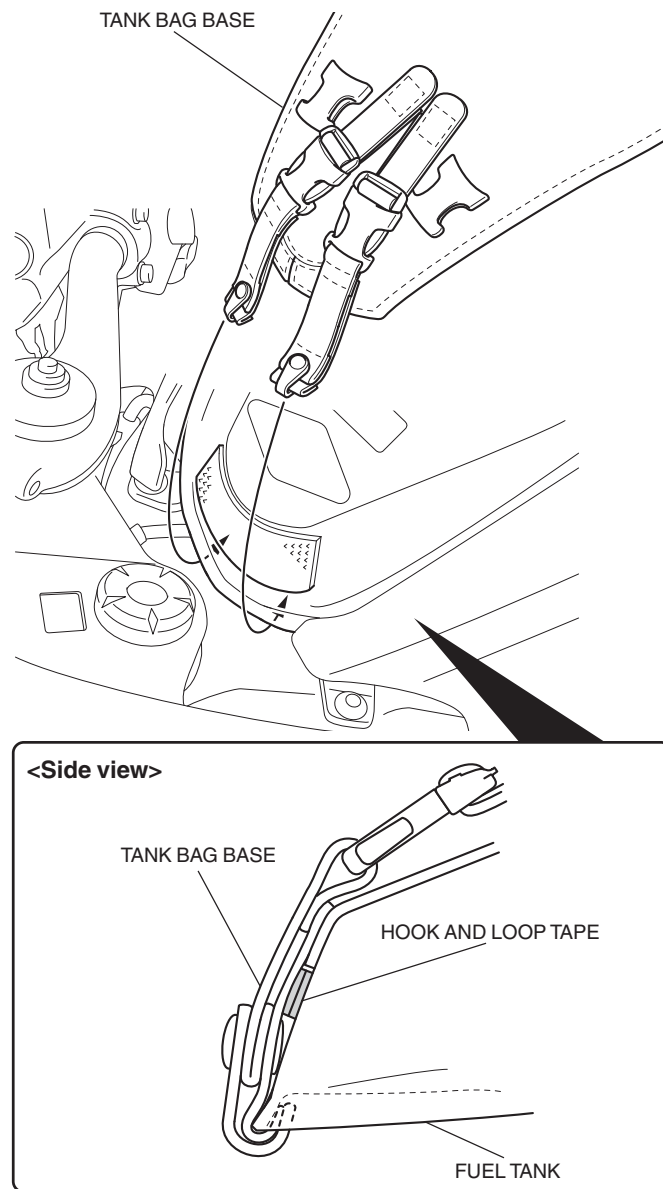

5. Pass the tank belt B under the frame as shown.

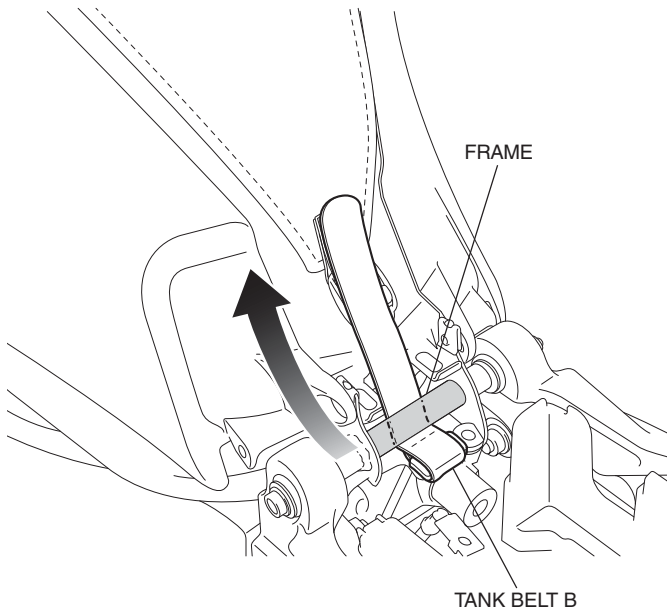

6. Loop tank belt B through the buckle as shown.

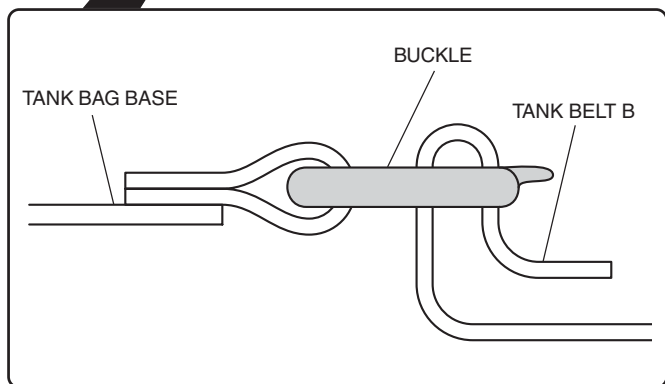
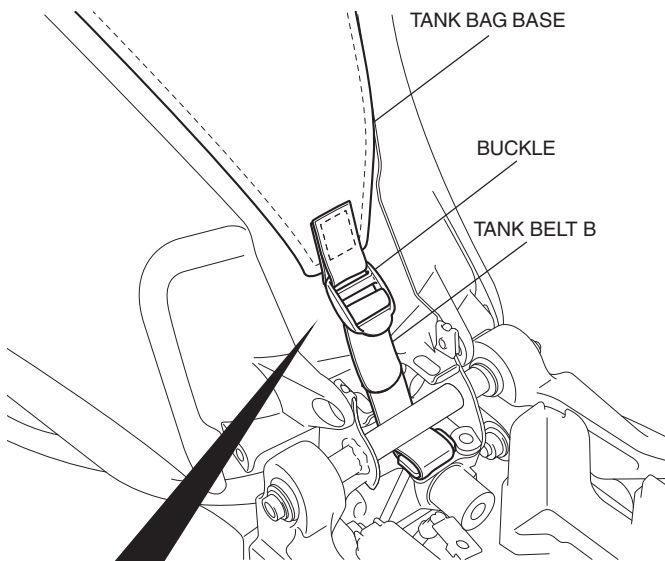

7. Adjust the tank belt length at front and rear and secure the belts.

<Front>

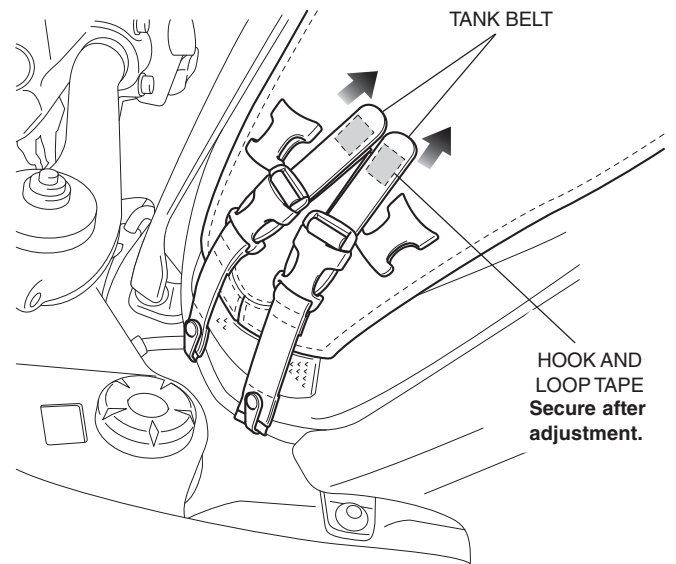

<Rear>

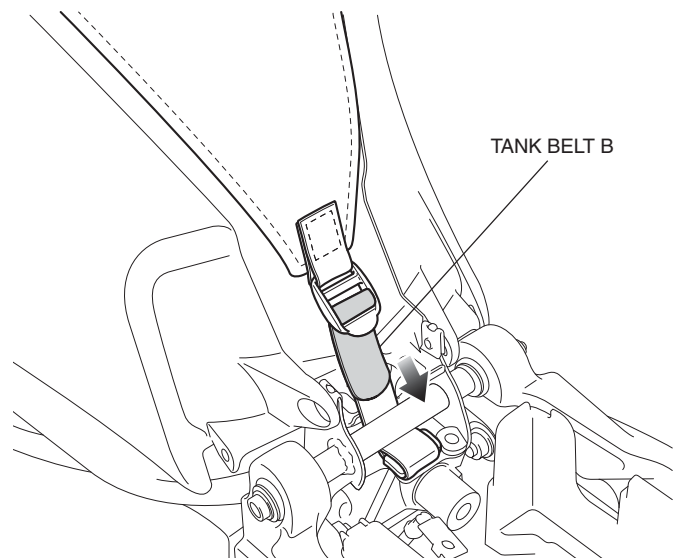

## HOW TO INSTALL THE TANK BAG

1. Clip the tank bag to the front buckles on the tank bag base as shown.

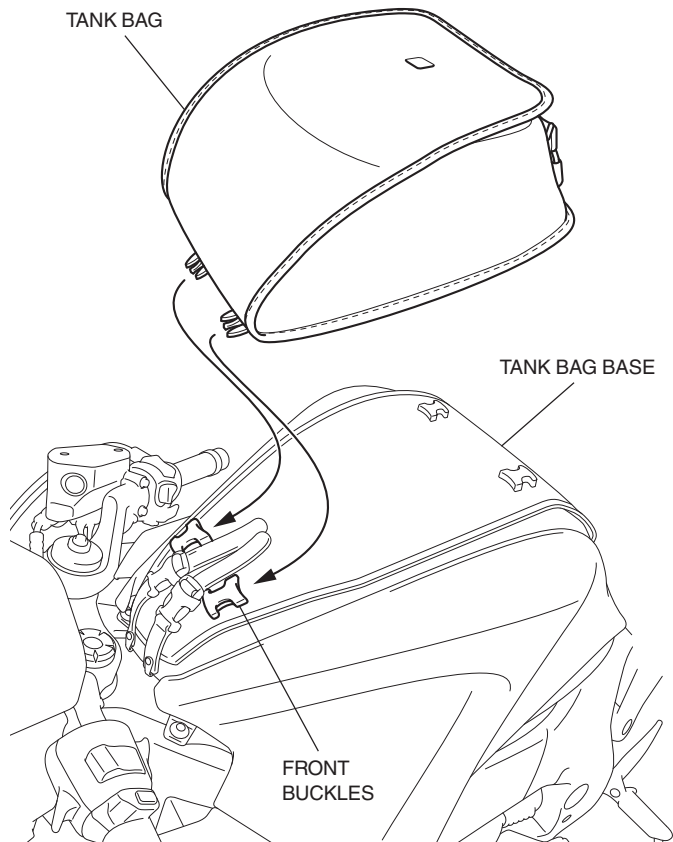

2. Connect the rear buckles as shown.

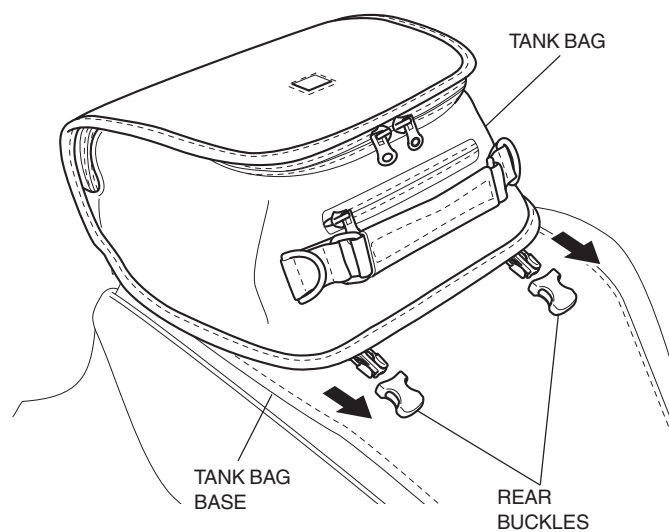

## HOW TO REMOVE THE TANK BAG

1. Remove the tank bag in the reverse order of installation.

## HOW TO USE THE RAIN COVER

1. Pass the front buckles through the openings of the rain cover as shown.

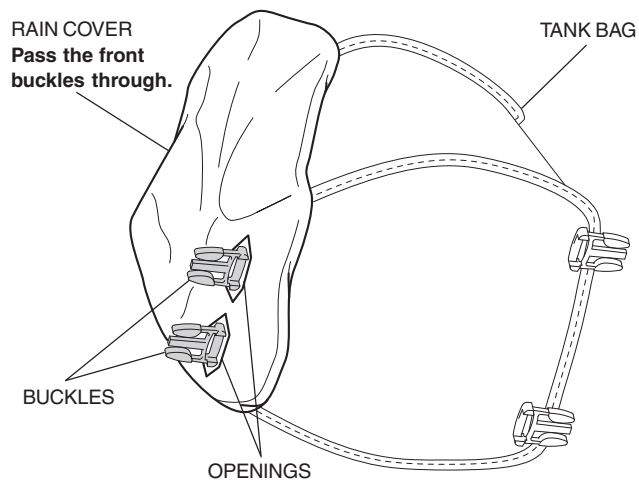

2. Put the rain cover over the tank bag as shown.

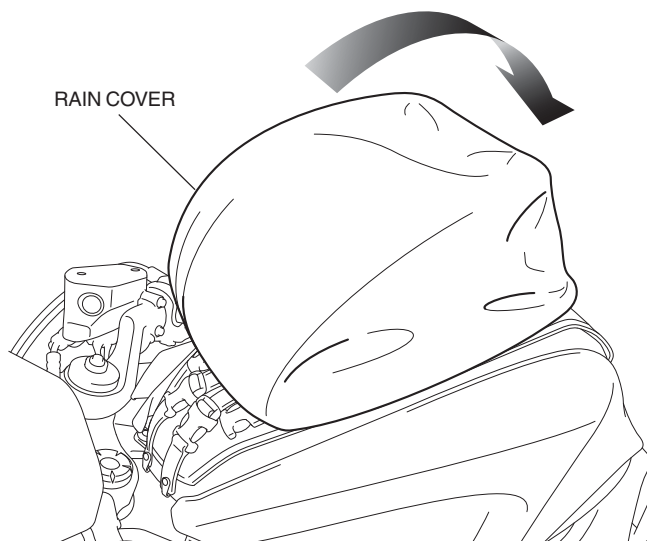

## HOW TO USE THE CARRY STRAP

1. Install the carry strap as shown.

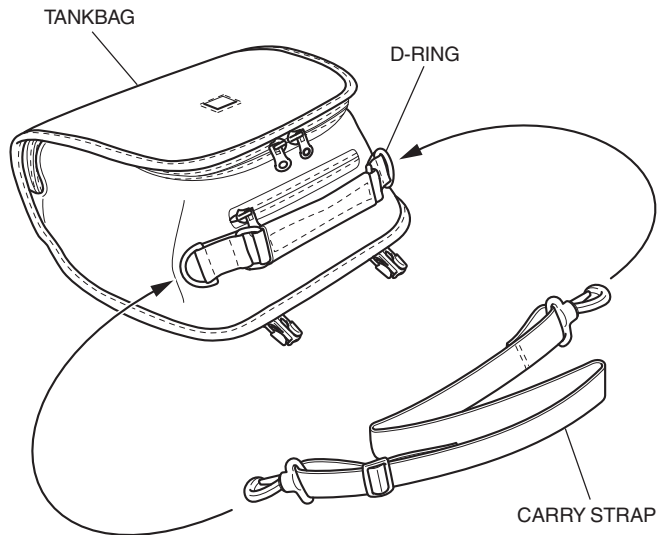

## PROCEDURE WHEN REFUELING

1. Disengage the buckles as shown and turn up the tank bag base.
  - **Always wipe off any spilled gasoline from the tank before reconnecting the tank bag base.**

