

HONDA

INSTALLATION INSTRUCTIONS

Accessory
DCT SHIFT PEDAL ASSEMBLY
P/N 08U70-MJP-A80

Application
CRF1000LD

Publication No.
MII 15641
Revised Date
May 10, 2016

Honda Dealer: Please give a copy of these instructions to your customer.

PARTS LIST

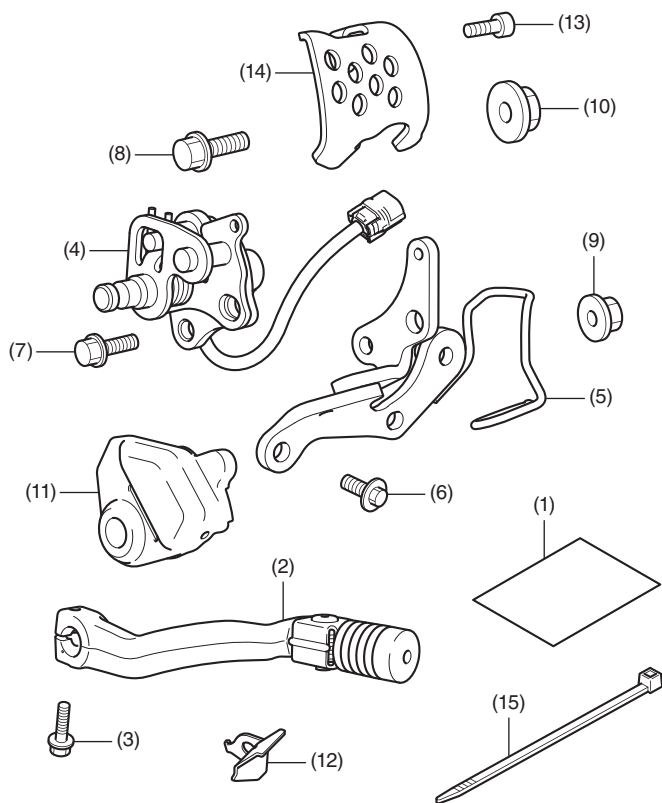

No.	Description	Qty
(1)	Installation Instruction URL	1
(2)	Shift pedal	1
(3)	6 mm flange bolt	1
(4)	Shift switch	1
(5)	Shift switch bracket	1
(6)	8 mm SH flange bolt	2
(7)	8 mm flange bolt	1
(8)	10 mm flange bolt	1
(9)	8 mm flange nut	1
(10)	10 mm flange nut	1
(11)	Shift switch cover	1
(12)	Harness stay	1
(13)	6 mm socket bolt	1
(14)	Shift switch guard	1
(15)	Wire tie	7

TOOLS AND SUPPLY REQUIRED

Socket (10, 12 and 14 mm)
Ratchet
Box-end wrench (12 and 14 mm)
Open-end wrench (12 and 14 mm)
Hex wrench (5 mm)
Side cutters
Marker
Ruler
Torque wrench

TORQUE CHART

Tighten all screws, bolts, and nuts to their specified torque values. Refer to the Service Manual for the torque values of the removed parts.

Item	N·m	kgf·m	lbf·ft
6 mm socket bolt	10	1.0	7
6 mm flange bolt	10	1.0	7
8 mm SH flange bolt	22	2.2	16
8 mm flange nut	27	2.8	20
10 mm flange nut	39	4.0	29

INSTALLATION

▲ CAUTION

- To prevent burns, allow the engine, exhaust system, radiator, etc., to cool before installing the accessory.

NOTE:

- Do not disassemble the shift switch.
- Disconnect the negative (-) cable from the battery before installing this accessory.
- The clock will be erased when you disconnect the battery. Reset the clock after reconnecting the battery.
- Trim the excess ends off the wire ties after attaching them to the wire harnesses. Do not allow the cut part of the wire tie to interfere with another harness or brake hose.
- Reinstall the removed parts on the motorcycle and make sure the wires and harnesses are not pinched.
- Registration is necessary after installing this accessory.

1. Remove the tool box stay and tool box. Open the battery box and disconnect the negative (-) terminal of the battery.

<Left side>

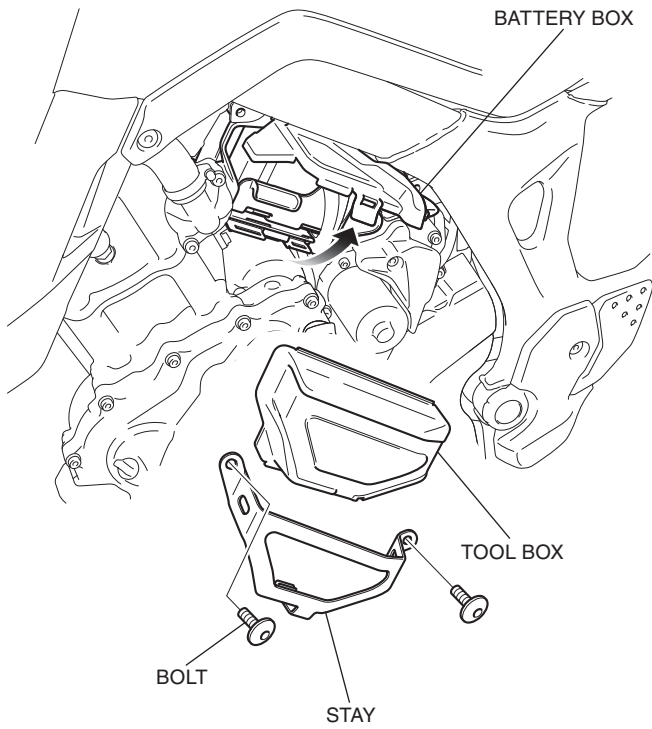

2. Remove the cover as shown.

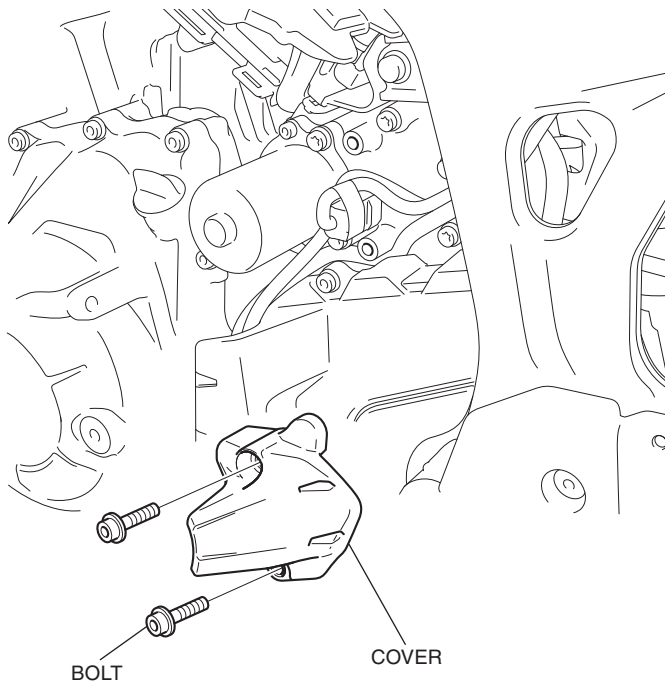

3. Remove the bolts, washer, and collar as shown.

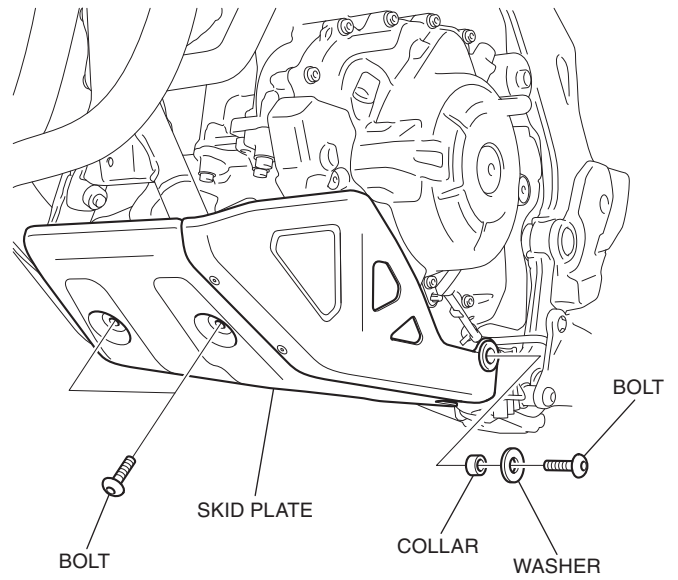

4. Remove the skid plate as shown.

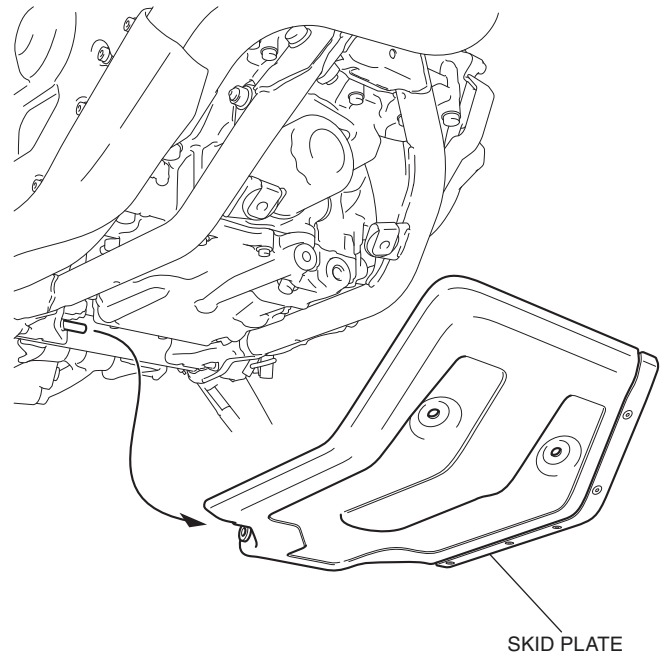

5. Remove the bracket as shown.

<Left side>

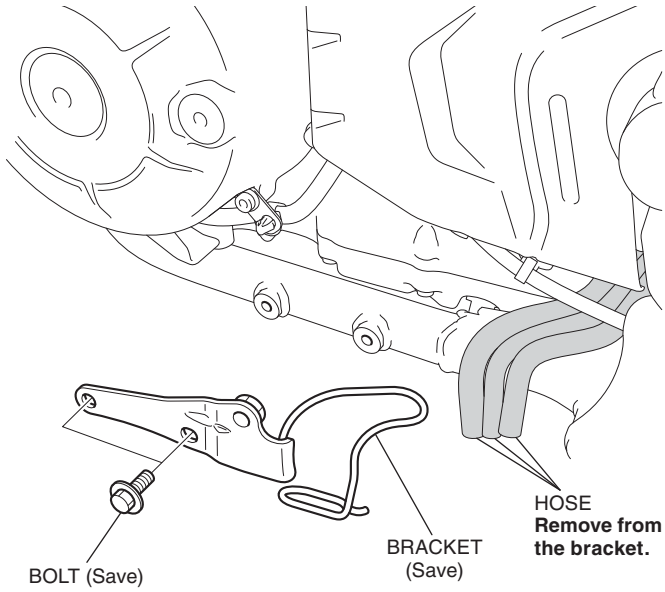

6. Remove the clamp as shown.

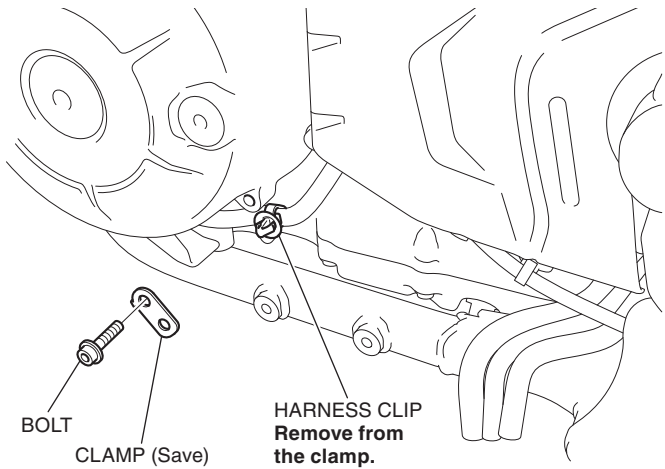

7. Remove the harness clip as shown.

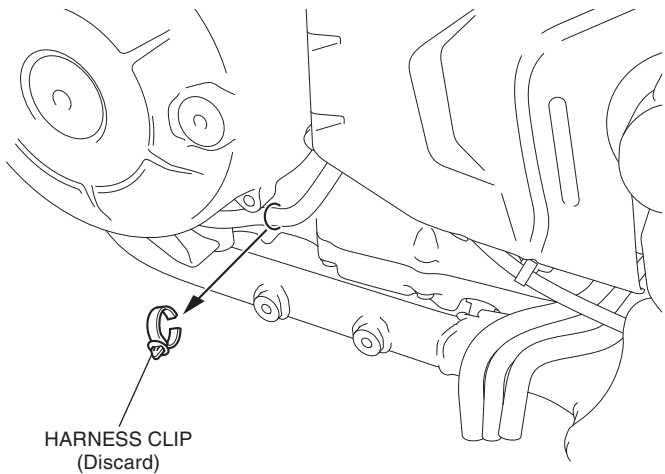

8. Install the harness stay as shown.

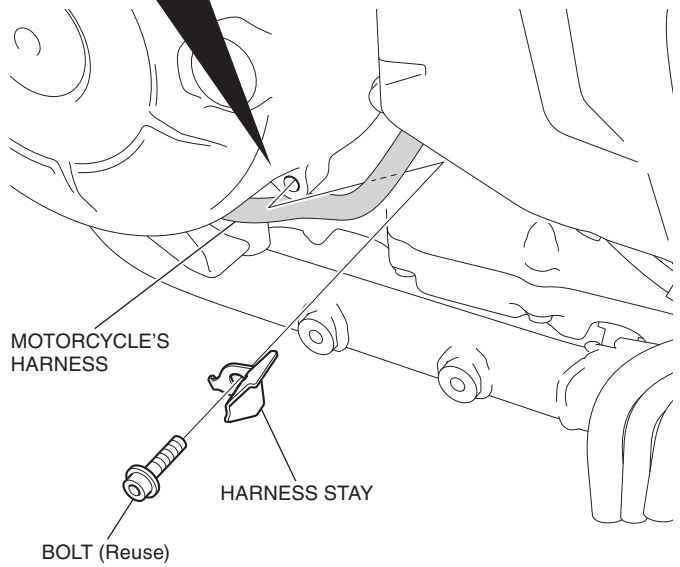
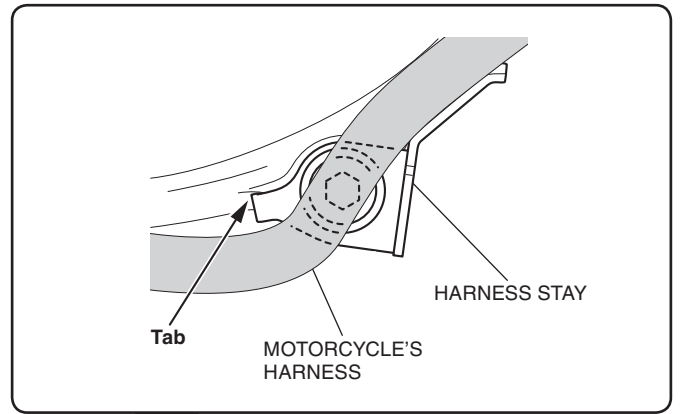

9. Secure the motorcycle's harness as shown.

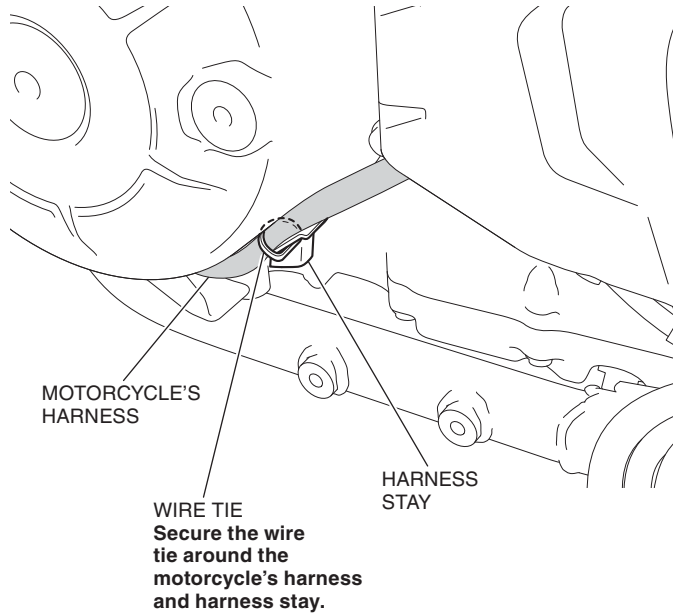

10. Mark the shift switch harness in the position shown.

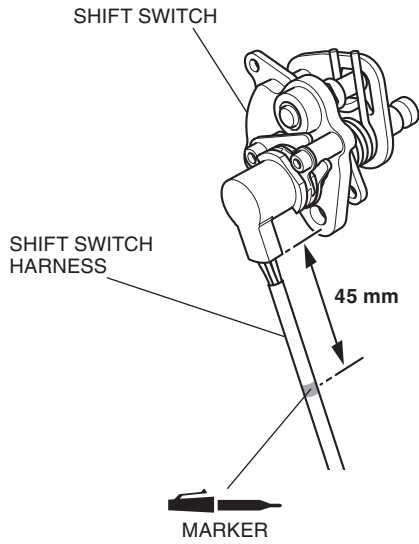

11. Loosely install the shift switch bracket to the shift switch as shown.

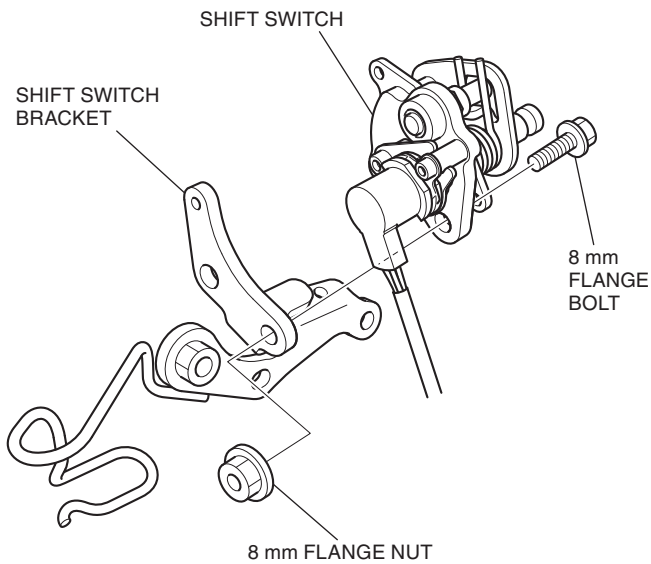

12. Loosely install the shift switch guard to the assembled shift switch as shown.

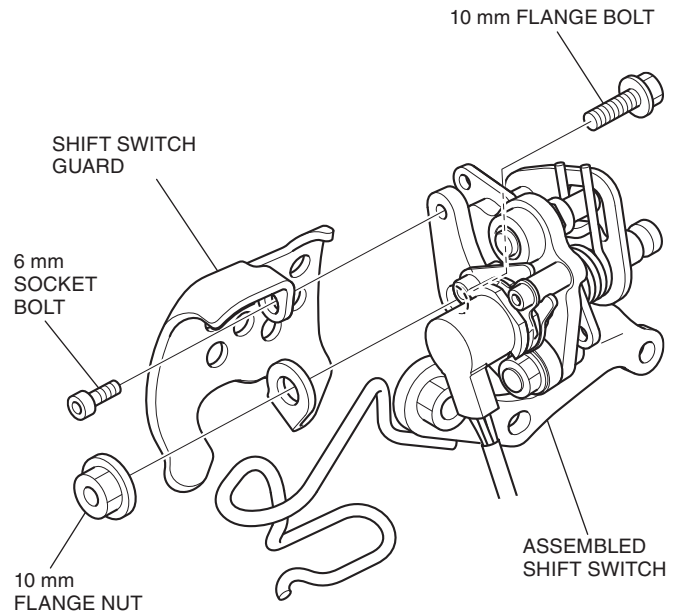

13. Install the shift switch cover on the assembled shift switch as shown.

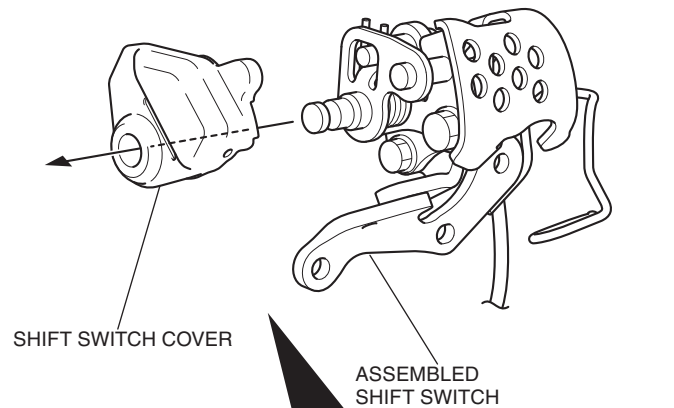

Position the  area of shift switch cover on the shift switch as shown.

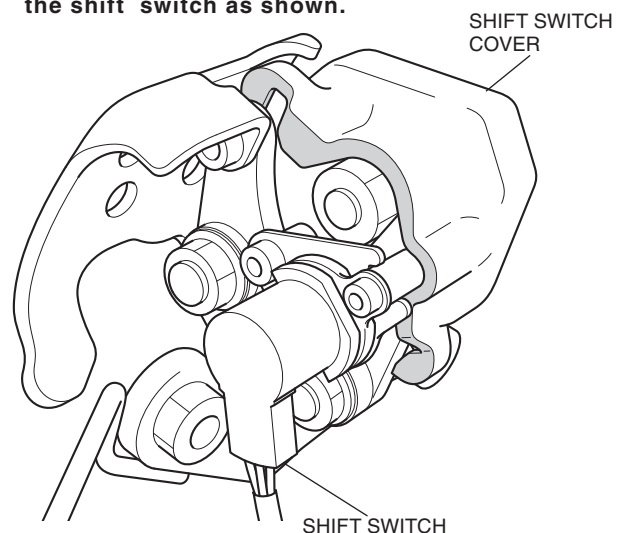

14. Tighten the loosely installed parts securely.

15. Install the shift pedal as shown.

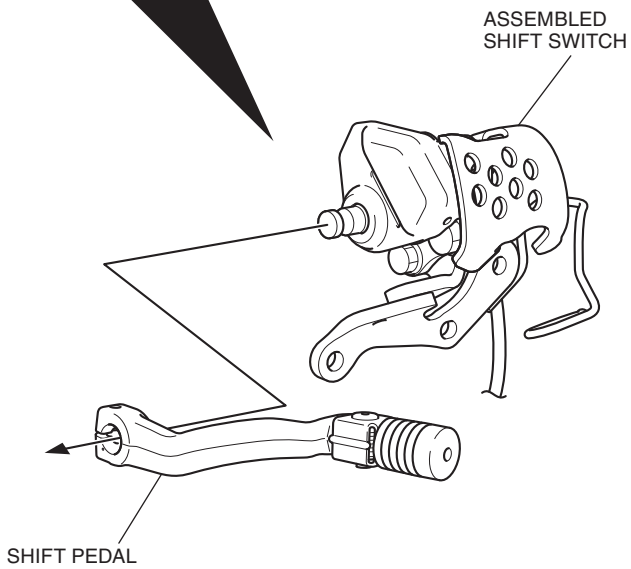
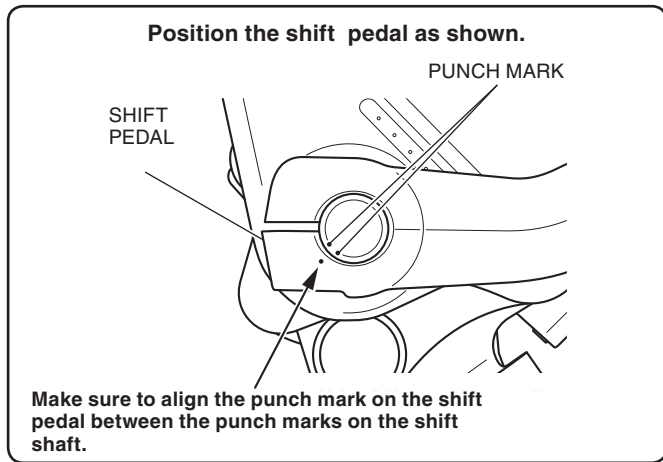

16. Install the 6 mm flange bolt as shown.

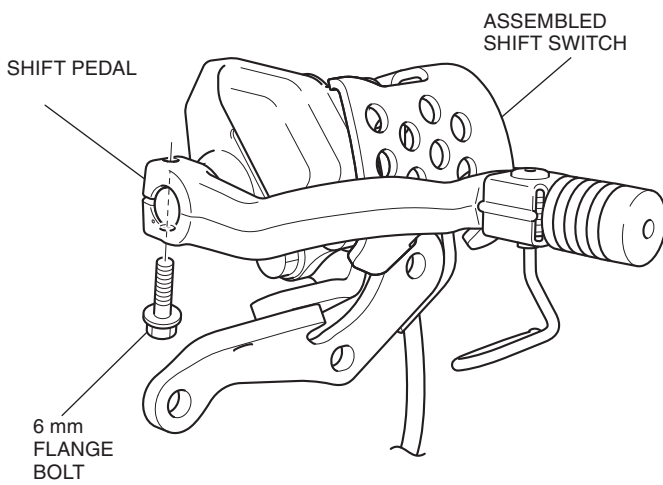

17. Install the assembled shift switch as shown.

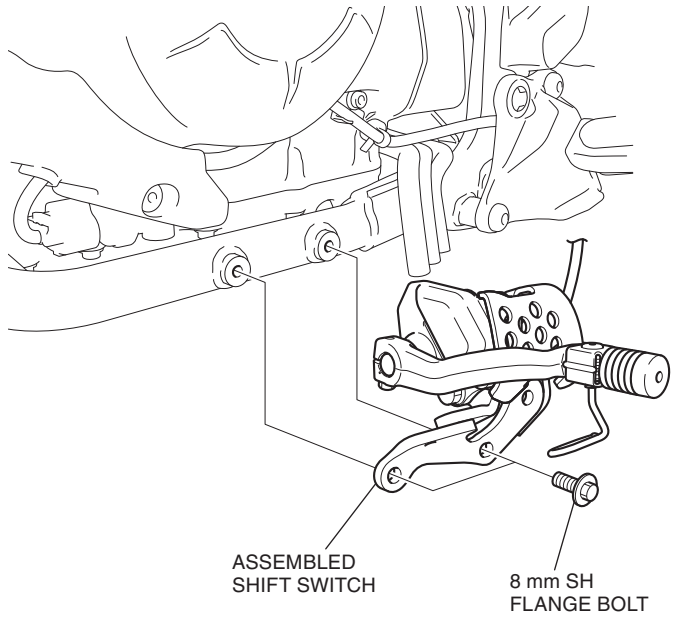

18. Route the hoses as shown.

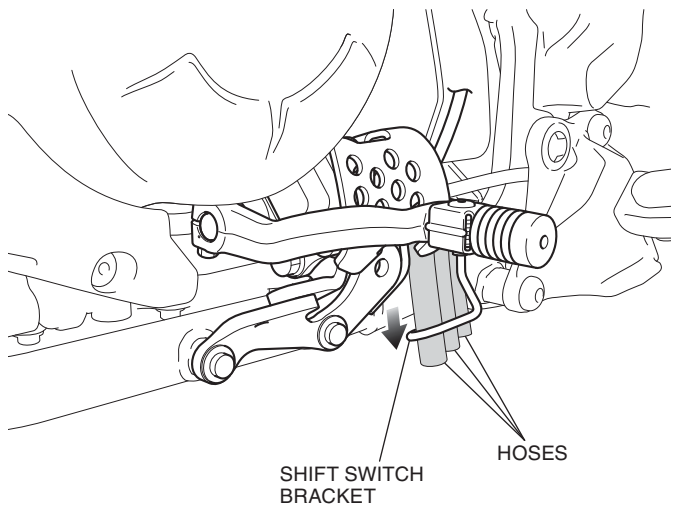

19. Remove the connectors as shown.

<Left side>

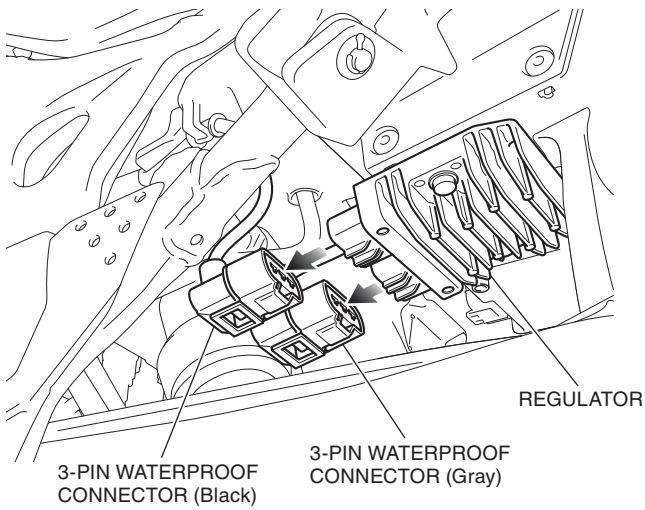

20. Remove the regulator as shown.

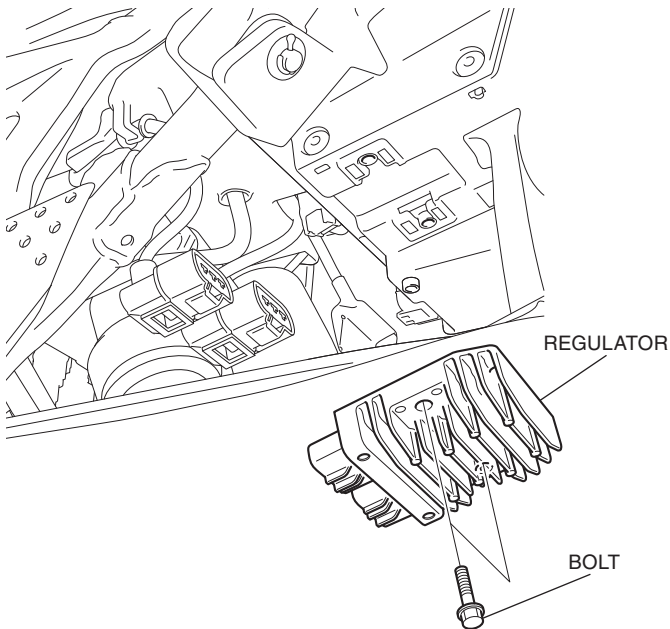

21. Remove the dummy connector as shown.

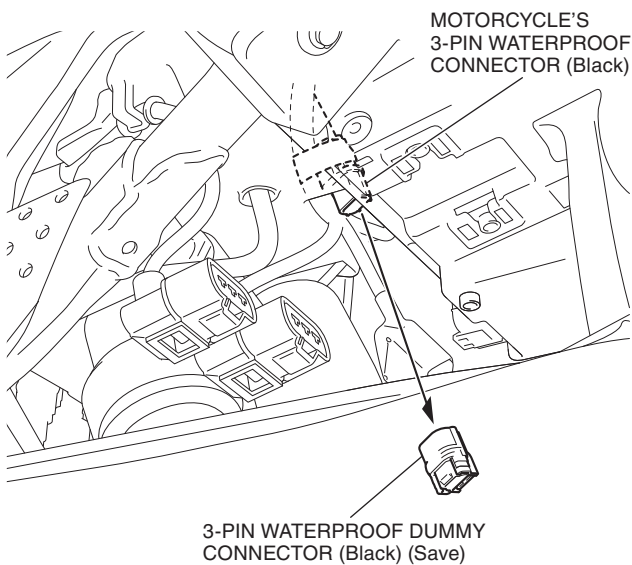

22. Route the shift switch harness as shown.

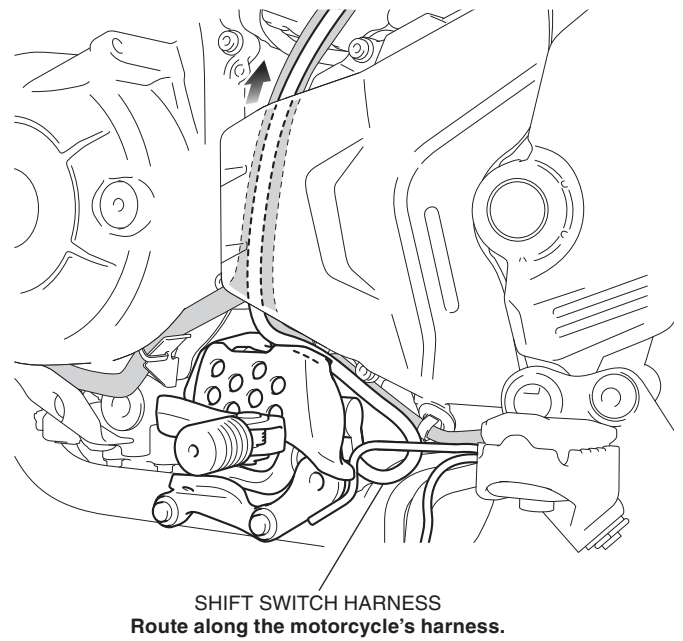

23. Secure the shift switch harness with the wire tie as shown.

- Make sure the wire tie is positioned against the motorcycle's clip when securing it.

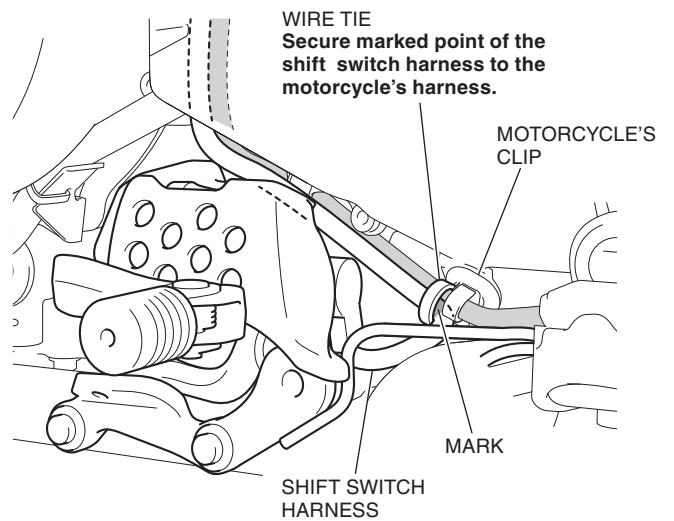

24. Route the shift switch harness as shown.

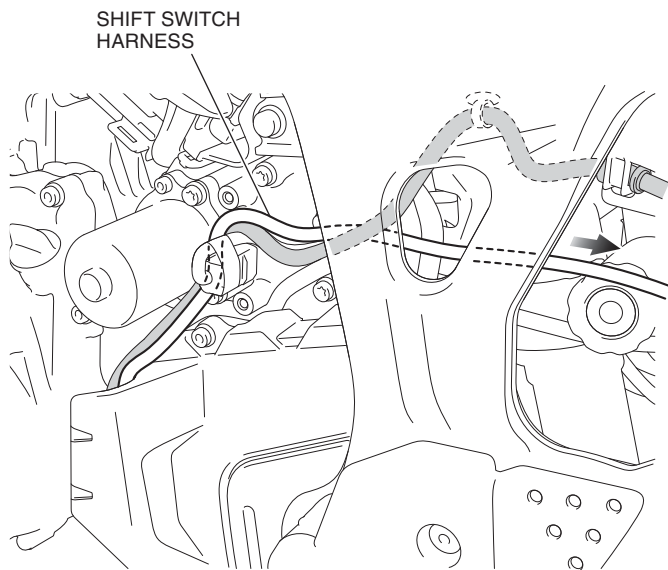

25. Route the shift switch harness as shown.

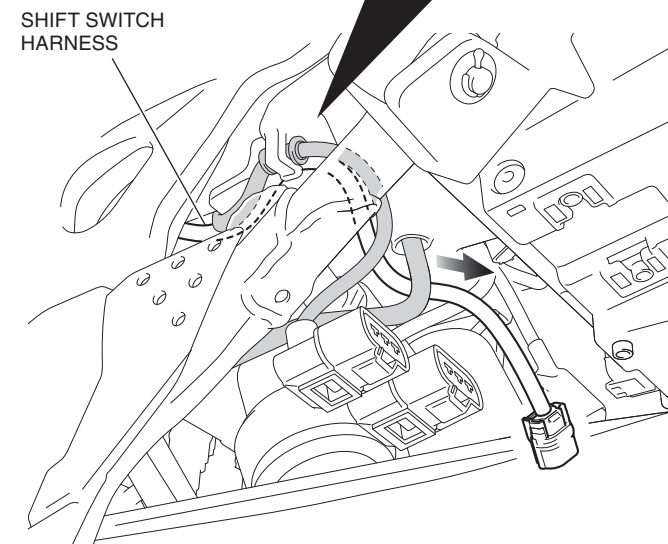
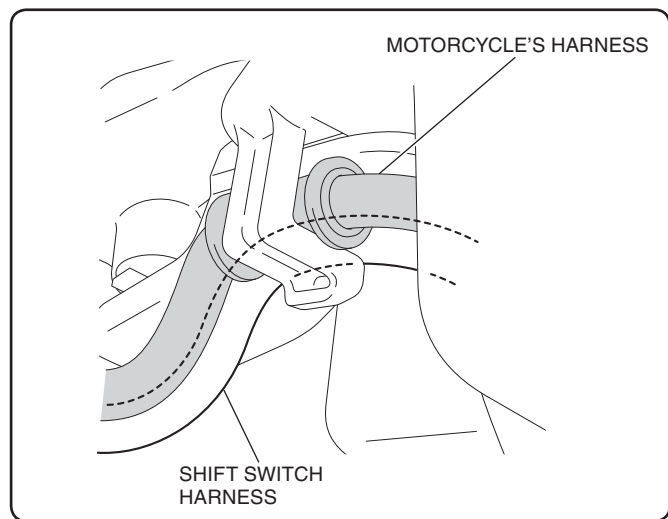

26. Connect the shift switch harness as shown.

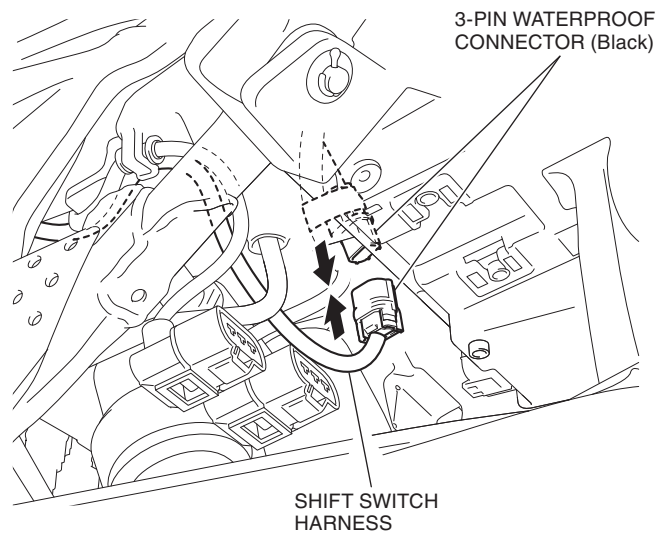

27. Install the regulator in reverse order of removal and connect the connectors.

28. Loosely secure the shift switch harness to the motorcycle's harness with the wire tie in the position shown.

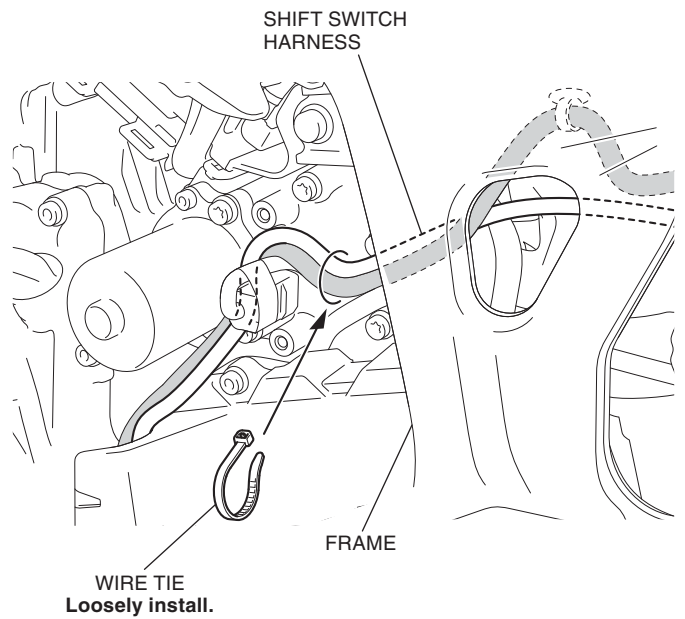

29. Secure the shift switch harness with the wire ties as shown.

WIRE TIE
Secure the shift switch harness to the motorcycle's harness.

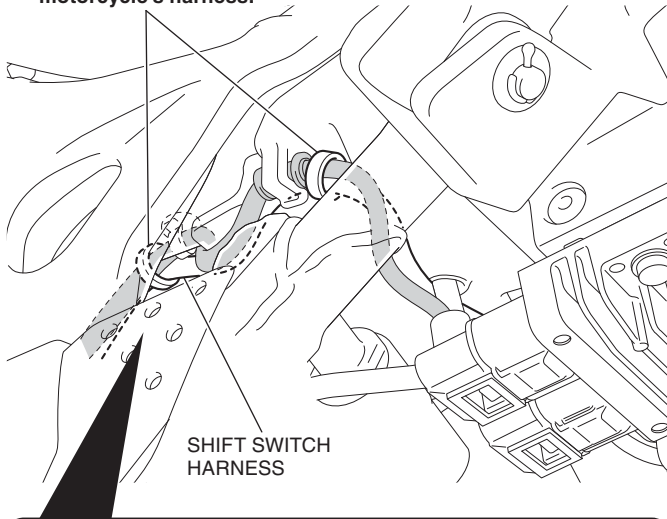

Move the loosely secured wire tie to the position shown.

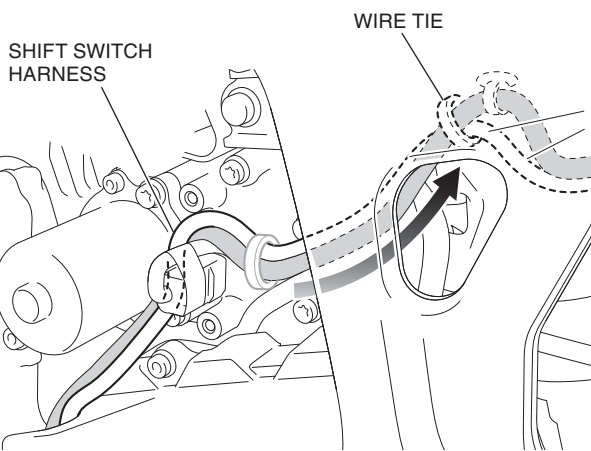

30. Secure the shift switch harness with the wire ties as shown.

WIRE TIE
Secure the shift switch harness to the motorcycle's harness.

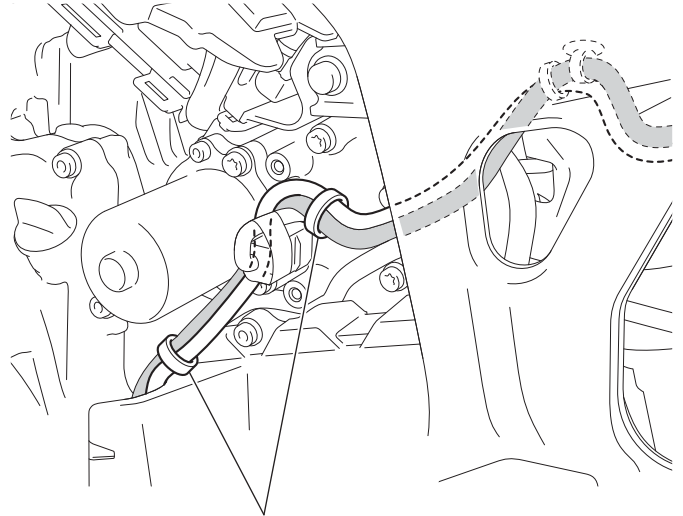

31. Secure the shift switch harness with the wire tie as shown.

WIRE TIE
Secure the shift switch harness to the motorcycle's harness.

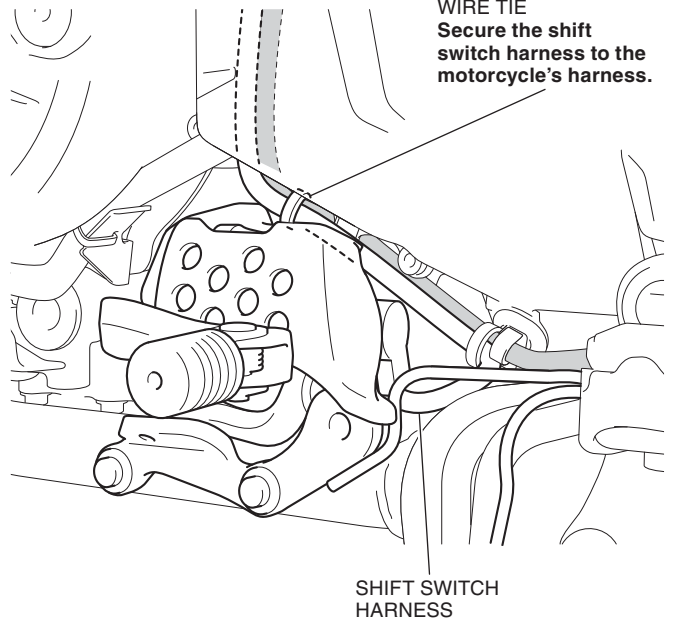

32. Install the motorcycle's parts in reverse order of the removal.

- **Confirm that no wire harness is caught or too tight.**

33. Check the headlight and other lights for proper operation.

34. Follow the registration procedure carefully to register this accessory to the motorcycle.

REGISTRATION

- Registration is necessary after installing this accessory.
- Turn the ignition switch to ON. The S gear shift indicator, level indicator and D gear shift indicator blink at the same time after 2 seconds.
 - Do not start the engine at this time.**
 - Check that the transmission is in neutral.**

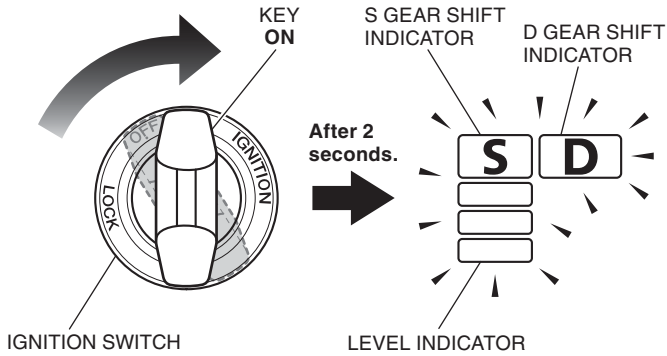

- Operate the shift pedal as shown.

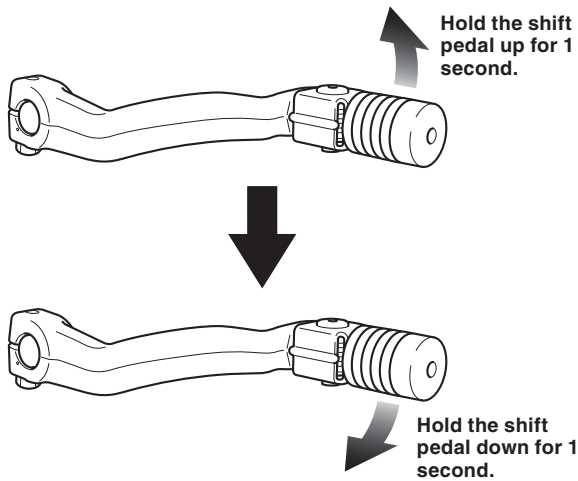

- The S gear shift indicator, level indicator and D gear shift indicator blink alternately after the registration has been completed successfully.

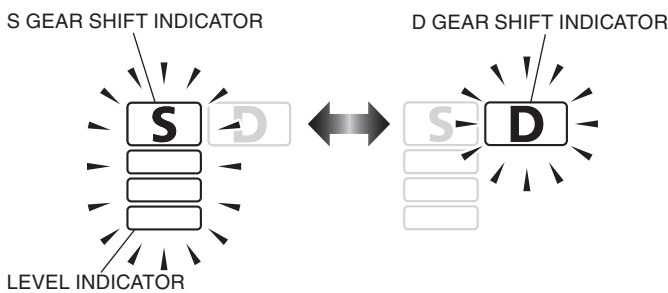

<If the gear shift indicator goes off>

- Registration has not been completed successfully. Turn the ignition switch to OFF and perform the registration procedure from step 1.**
- Turn the ignition switch to OFF.

DEREGISTRATION

- Deregistration is necessary after removing this accessory.
- Remove this accessory.
 - Turn the ignition switch to ON while pressing the shift up switch and shift down switch simultaneously as shown. Continue to hold the shift switches.
 - Do not start the engine at this time.**
 - Check that the transmission is in neutral.**

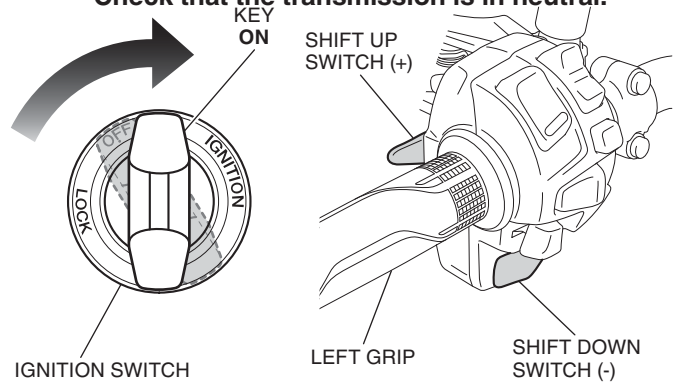

- While still holding the shift switches, the S gear shift indicator, level indicator and D gear shift indicator blink at the same time.

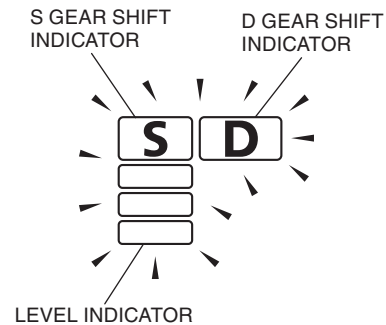

- The S gear shift indicator, level indicator and D gear shift indicator blink alternately 5 seconds after deregistration is completed successfully. The shift switches can be released at this time.

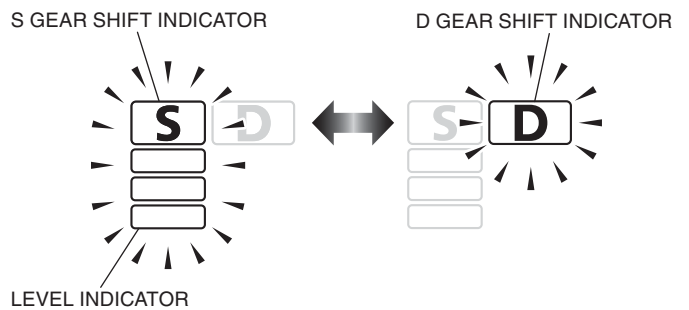

<If the gear shift indicator goes off>

- Deregistration has not been completed successfully. Turn the ignition switch to OFF and perform the deregistration procedure from step 2.**
- Turn the ignition switch to OFF.