

HONDA

INSTALLATION INSTRUCTIONS

Accessory
LIGHT BAR
 P/N 08P71-MGH-J20

Application
VFR1200X/XD

Publication No.
MII 15640
 Issue Date
April 2016

Honda Dealer: Please give a copy of these instructions to your customer.

PARTS LIST

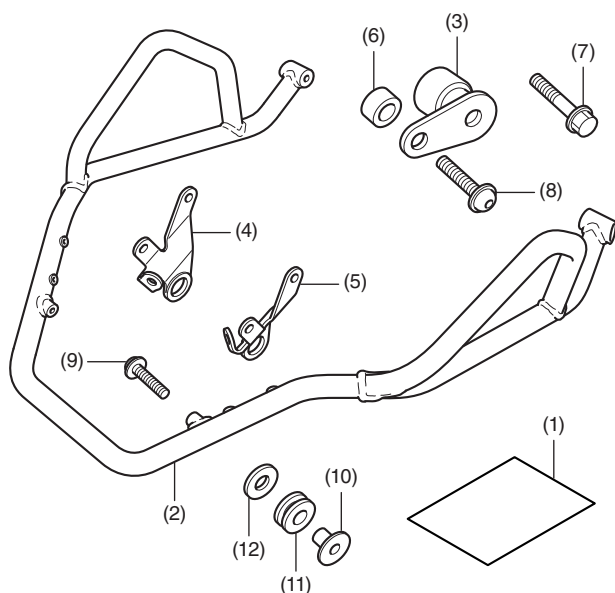

No.	Description	Qty
(1)	Installation Instruction URL	1
(2)	Light bar	1
(3)	Light bar bracket	2
(4)	Right light bar stay	1
(5)	Left light bar stay	1
(6)	Collar	2
(7)	8 mm flange bolt	2
(8)	8 mm socket bolt	2
(9)	6 mm socket bolt	2
(10)	Flange collar	2
(11)	Grommet	2
(12)	Washer	2

TOOLS AND SUPPLIES REQUIRED

Socket (12 mm)
 Ratchet
 Hex wrench (4 and 5 mm)
 Tape
 Shop towel
 Torque wrench

TORQUE CHART

Tighten all screws, bolts, and nuts to their specified torque values. Refer to the Service Manual for the torque values of the removed parts.

Item	N-m	kgf-m	lbf-ft
6 mm socket screw	9	0.9	6.6
8 mm socket screw	22	2.2	16
8 mm flange bolt	27	2.8	20

INSTALLATION

▲ CAUTION

- To prevent burns, allow the engine, exhaust system, radiator, etc., to cool before installing the accessory.

NOTE:

- Disconnect the negative (-) cable from the battery before installing this accessory.
- The clock will be erased when you disconnect the battery. Reset the clock after reconnecting the battery.
- Reinstall the removed parts on the motorcycle and make sure that the wires and harnesses are not pinched.

- Remove the seat, and disconnect the negative (-) cable from the battery.

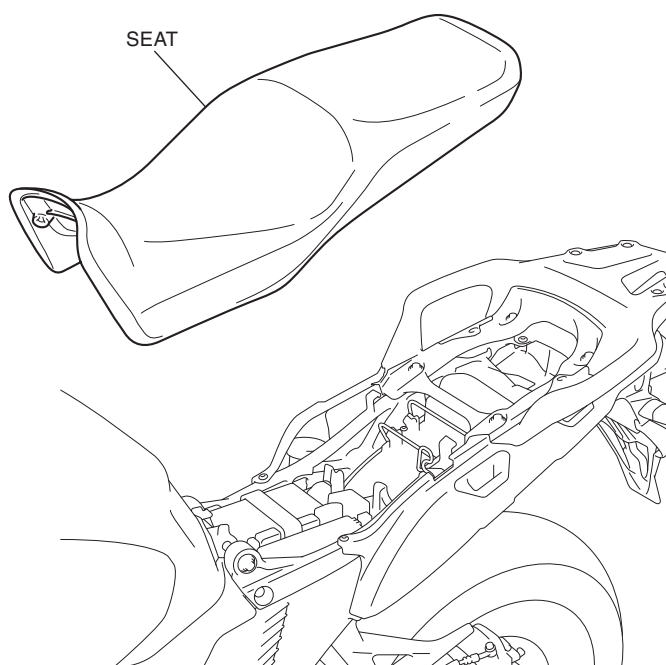

2. Remove the clips as shown.

<Left side>

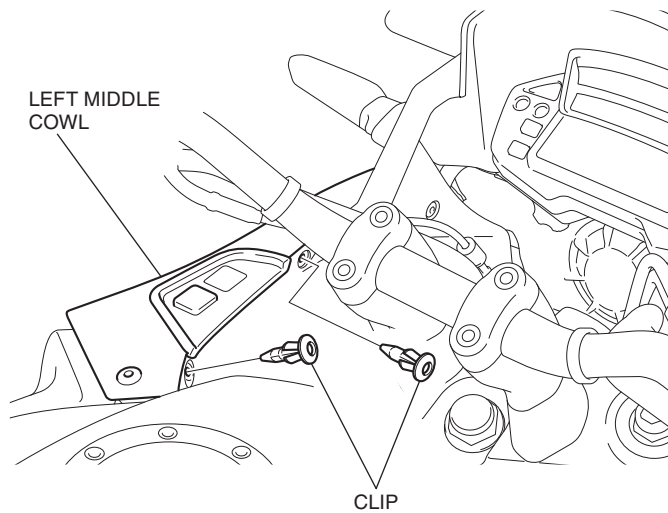

3. Remove the clips as shown.

<Left side>

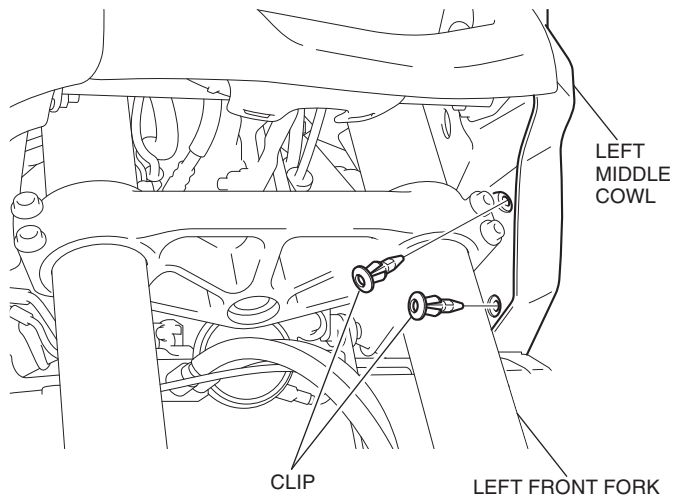

4. Remove the bolts as shown.

<Left side>

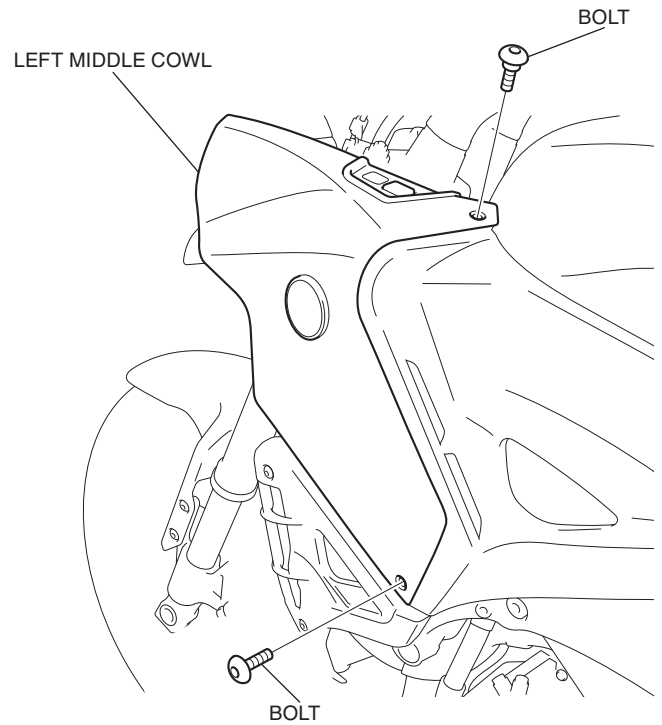

5. Remove the left middle cowl as shown.

- **Make sure that the 2-pin waterproof connector is disconnected before removing the left middle cowl.**

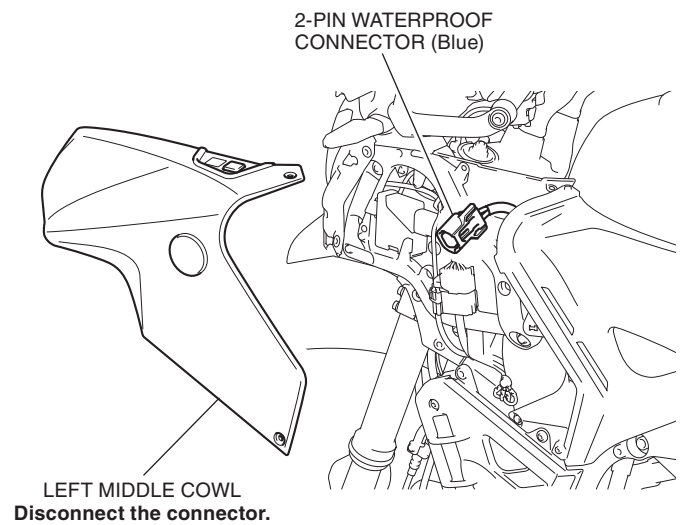

6. Remove the right middle cowl in the same manner.

7. Install the light bar bracket as shown.

- Repeat on the right side.

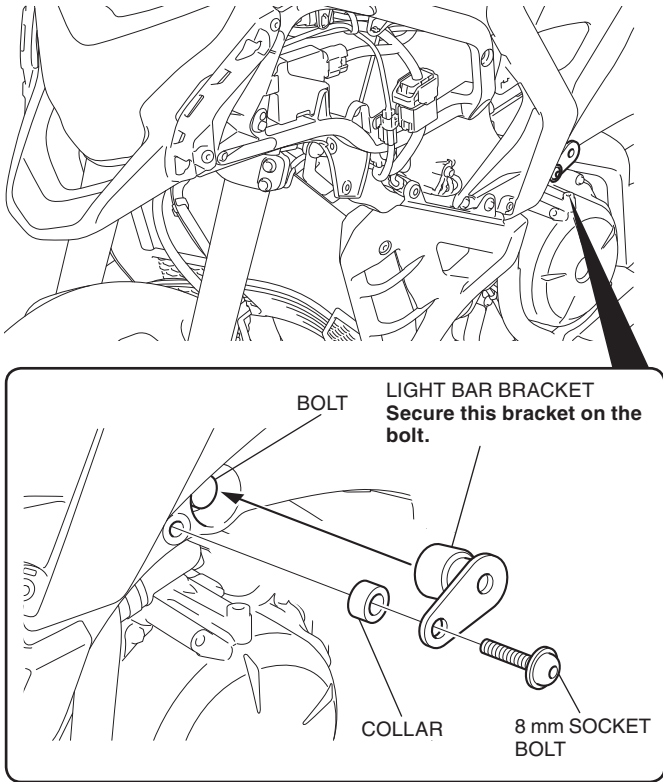

8. Attach the flange collar after attaching the grommet to the left light bar stay.

- Repeat on the right side.

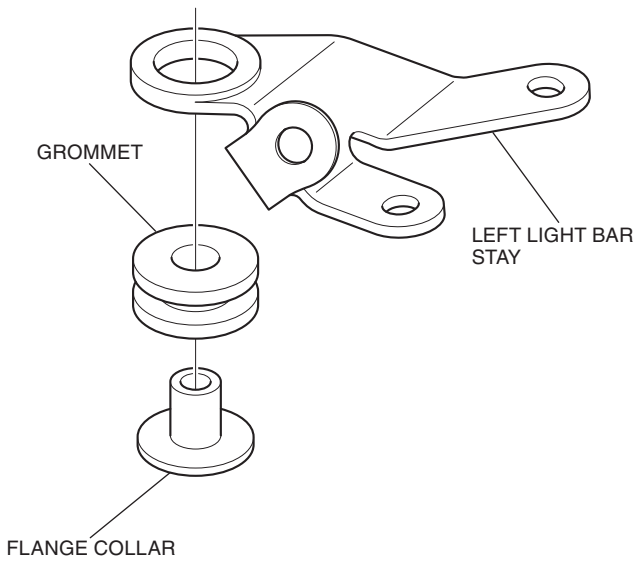

9. Remove the upper cowl stay as shown.

- Perform this work with two people, where one supports the upper cowl, and the other one removes the upper cowl stay.

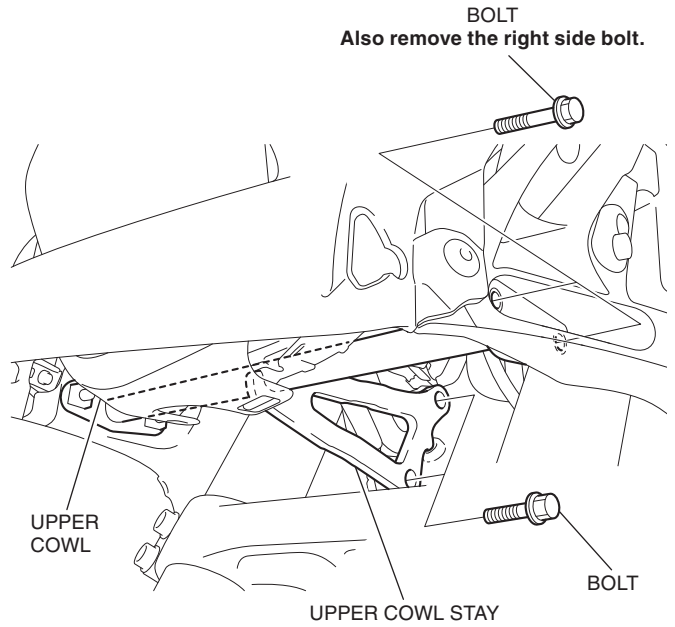

10. Replace the collars as shown.

- Repeat on the right side.

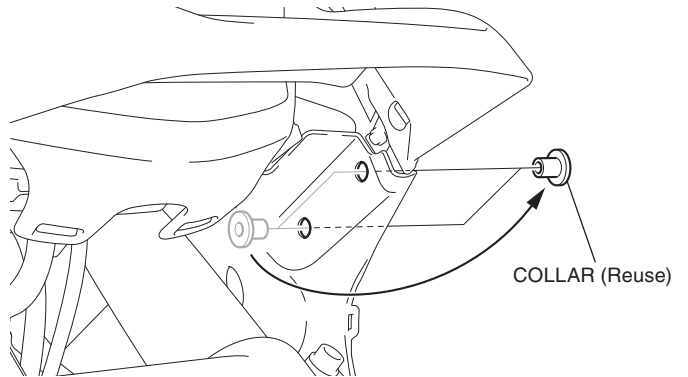

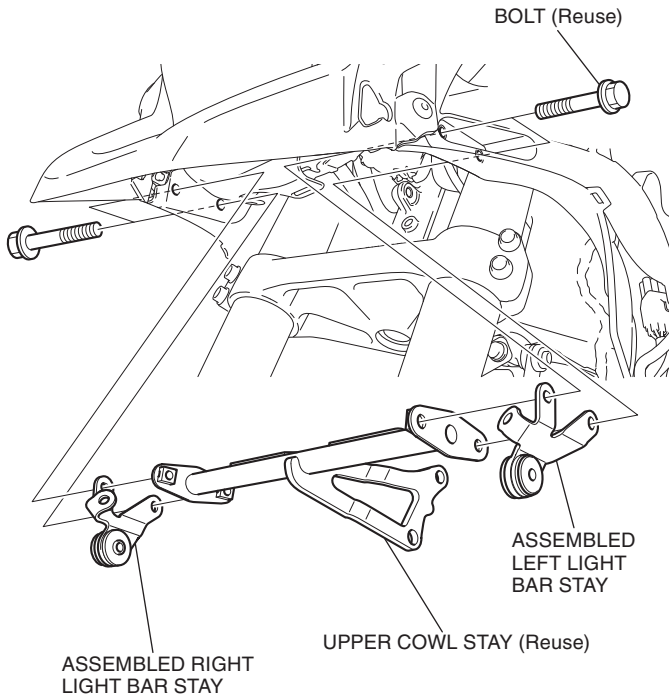

11. Loosely install the light bar stay and upper cowl stay as shown.

- Perform this work with two people, where one supports the upper cowl, and the other one installs the light bar stay and the upper cowl stay.

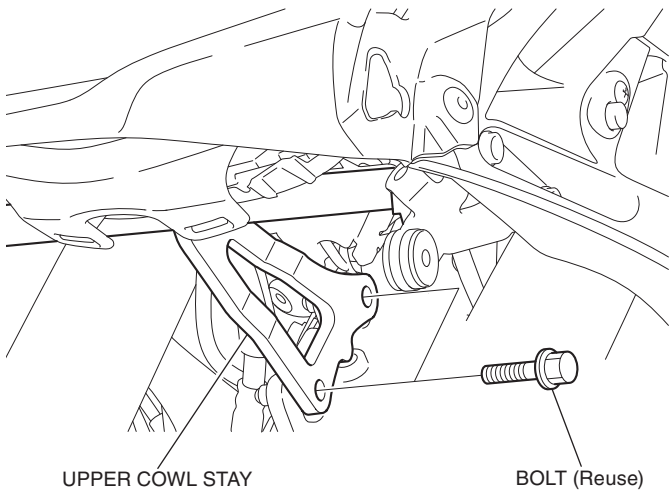

12. Loosely install the bolts as shown.



13. Protect the  area as shown with a shop towel or tape.

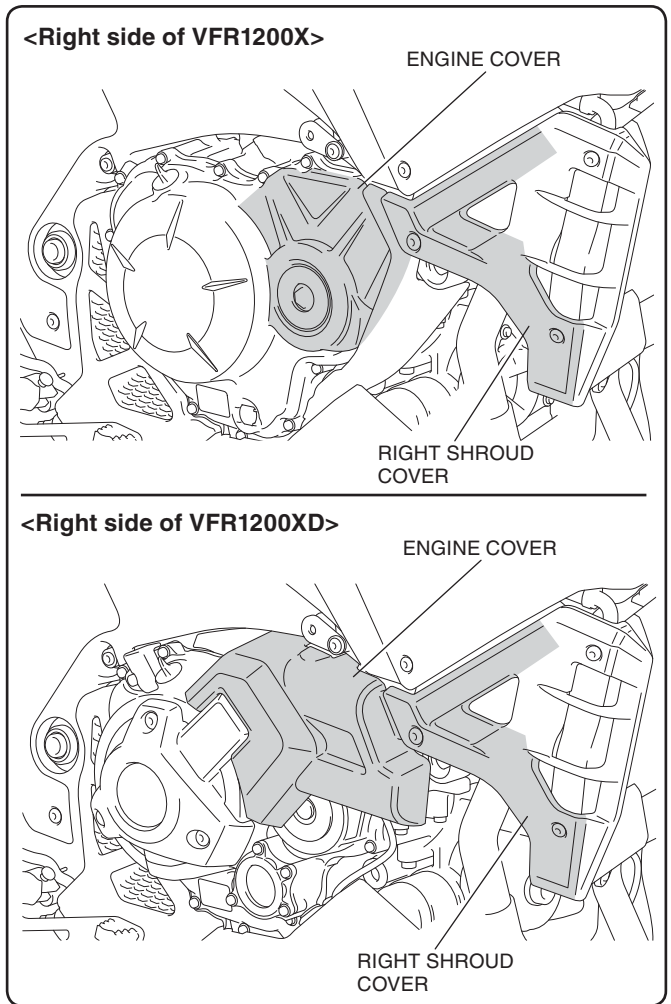

<Left side>

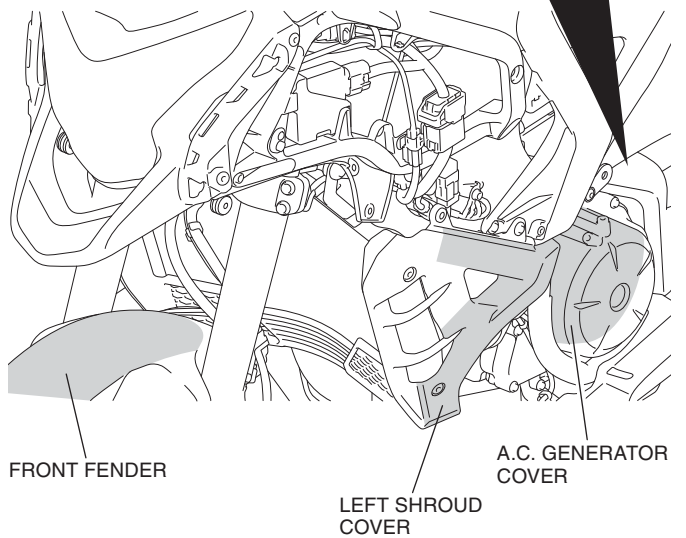

14. Insert the light bar from the front of motorcycle as shown.

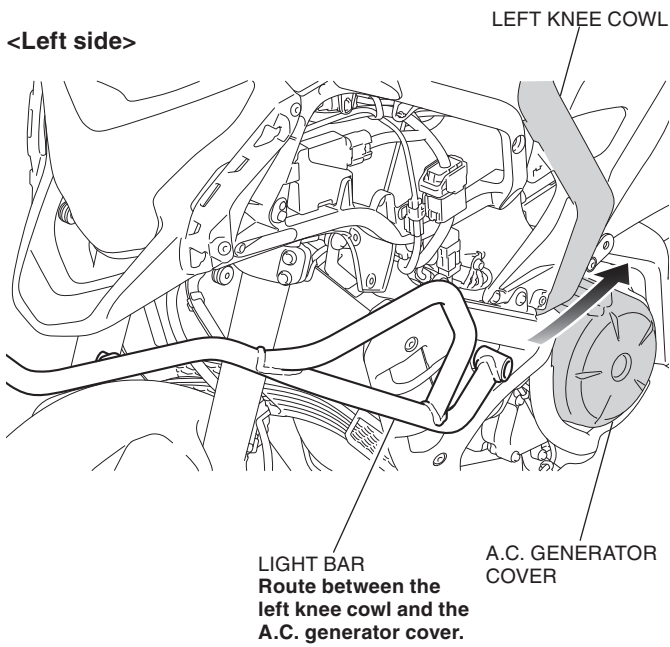
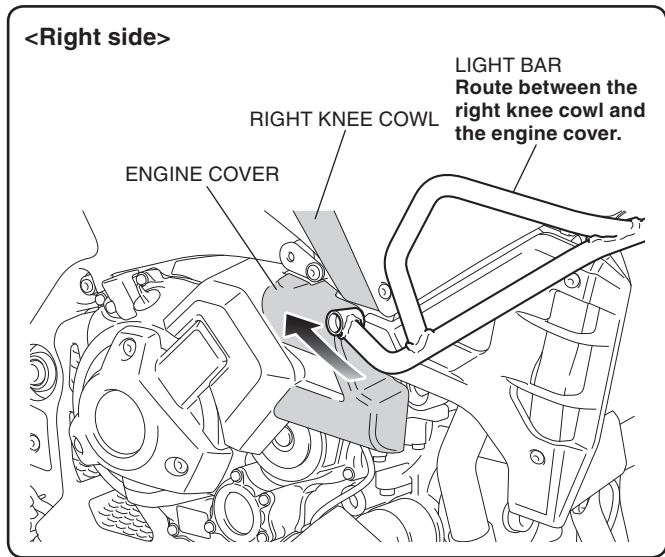

15. Install the light bar as shown.

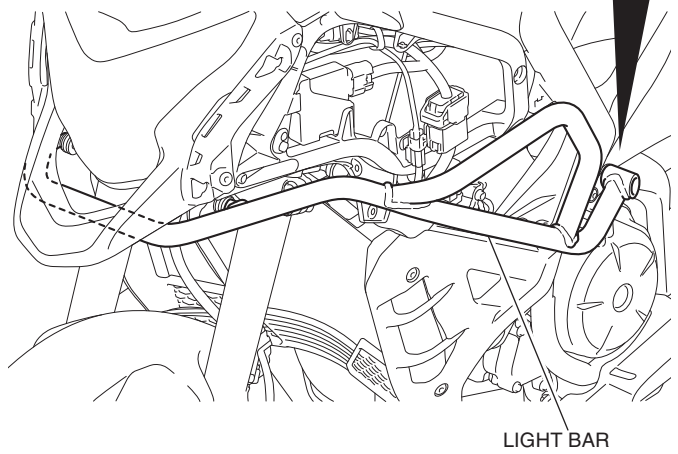
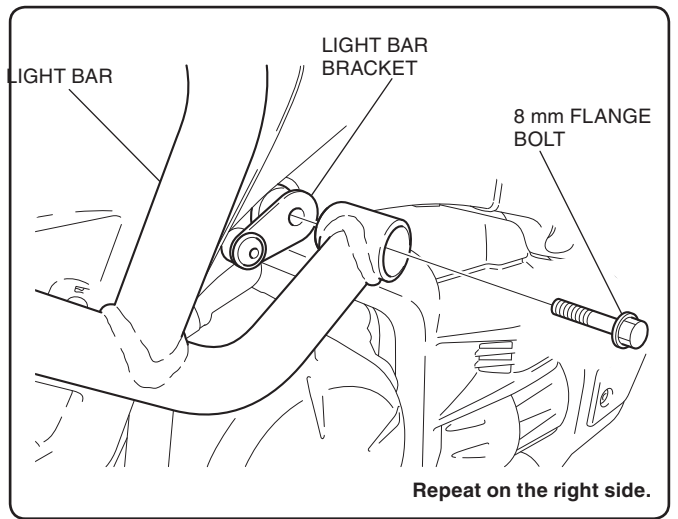

16. Install the light bar as shown.

- Repeat on the right side.

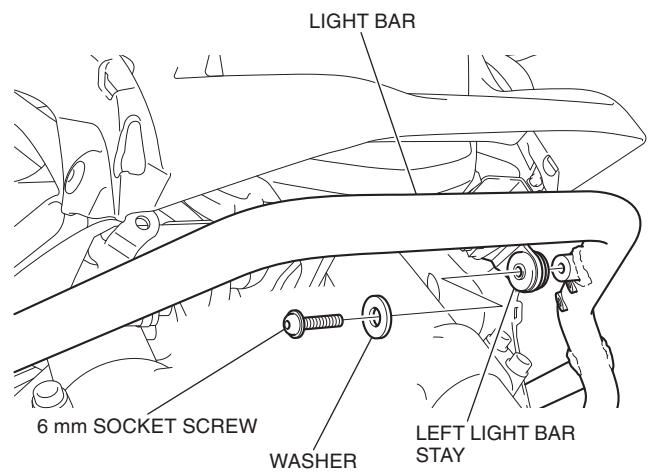

17. Tighten the indicated bolts securely.

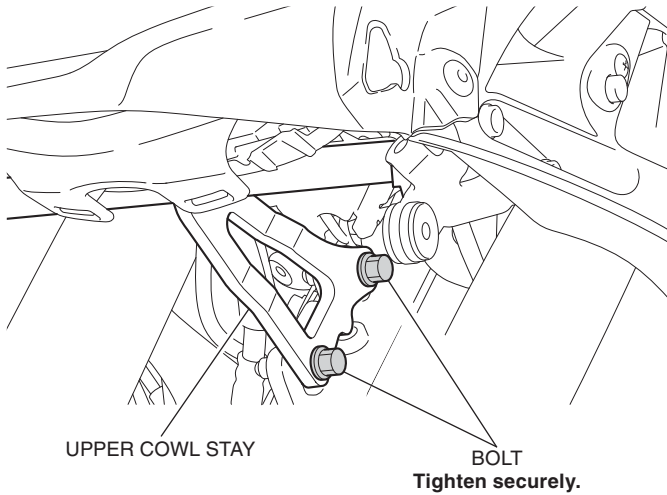

18. Tighten the indicated bolts securely.

- Repeat on the right side.

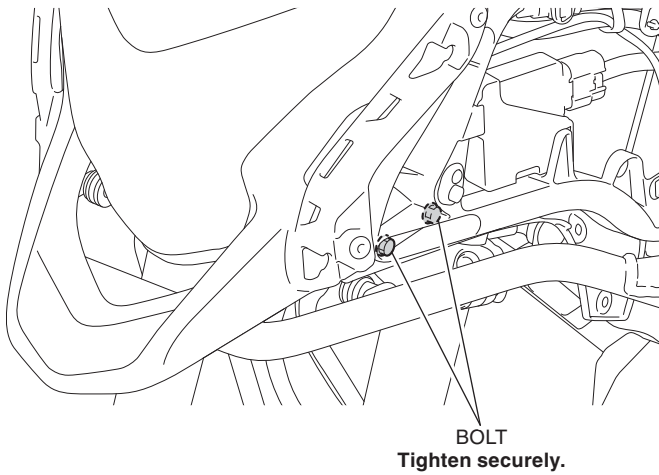

23. Remove the shop towel or tape used for protection.

24. Reinstall the removed parts on the motorcycle and make sure the wires and harnesses are not pinched.

24. Connect the negative (-) cable to the battery and install the seat in the reverse order of removal.

25. Check the headlight aim and adjust if needed.

26. Set the clock.