



INSTALLATION INSTRUCTIONS

Accessory

HEATED GRIPS
P/N 08T72-MGH-N12

Application

VFR1200X/XD

Publication No.

MII 15640

Issue Date

March 2016

Honda Dealer: Please give a copy of these instructions to your customer.

PARTS LIST

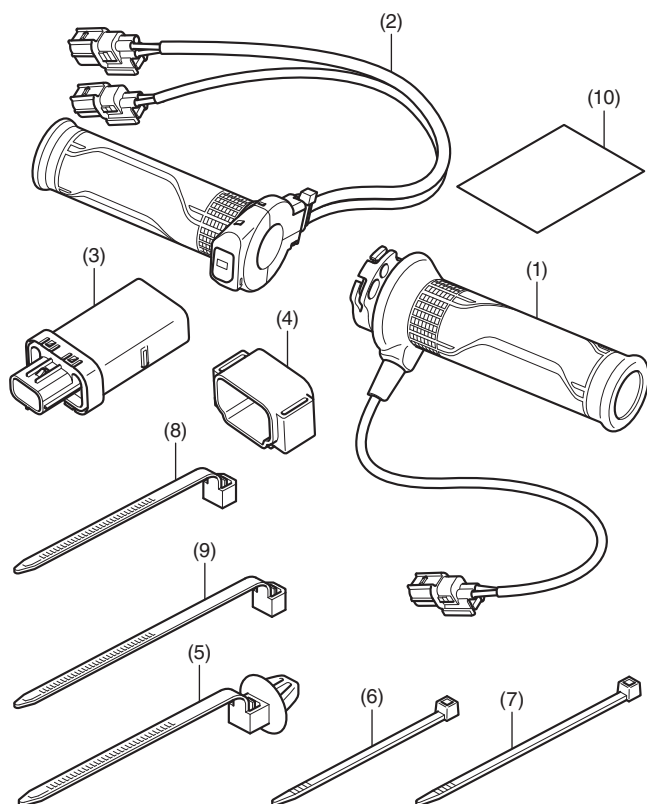

No.	Description	Qty
(1)	Right heated grip	1
(2)	Left heated grip	1
(3)	Heater controller	1
(4)	Suspension	1
(5)	Clip band [Not used.]	6
(6)	Wire tie (narrow/short) [Not used.]	6
(7)	Wire tie (narrow/long)	6
(8)	Wire tie (wide/short) [Not used.]	6
(9)	Wire tie (wide/long)	3
(10)	Installation Instruction URL	1

TOOL AND SUPPLIES REQUIRED

Flat-tip screwdriver	Side Cutters
Marker	Scale
Electrical tape	Pro Honda Handgrip
Cement	Thread lock
Grease	
Isopropyl alcohol	Shop towel

TORQUE INFORMATION

Refer to the Service Manual for the torque values of the removed parts.

SYSTEM DIAGRAM

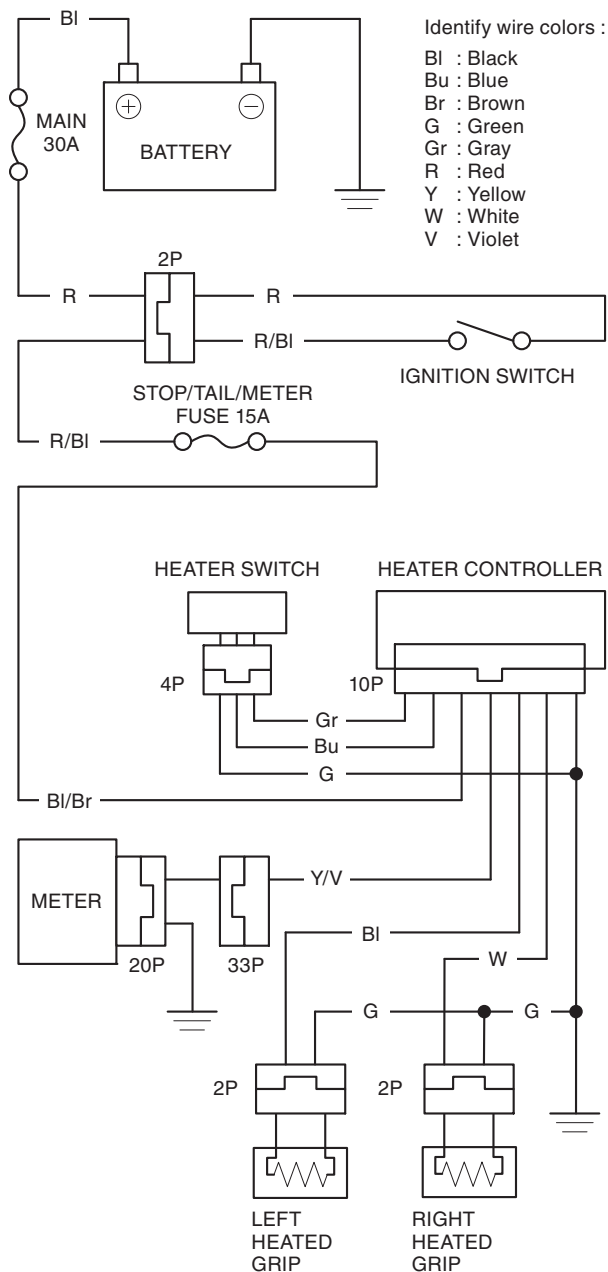

INSTALLATION

⚠ CAUTION

- To prevent burns, allow the engine, exhaust system, radiator, etc., to cool before installing the accessory.
- Be sure to observe all safety messages and precautions described in the Service Manual while removing and installing the fuel tank.

NOTE:

- When working with lifting the fuel tank, always perform this work with two persons; it is recommended that one person lifts the tank.
 - Disconnect the throttle cable from the right grip as instructed in the motorcycle's Service Manual.
 - For secure adhesion of the heated grips use the recommended adhesive agent (Pro Honda Handgrip Cement) or equivalent.
 - Be sure to open and close the throttle to check for smooth operation after installation of the right heated grip.
 - Take care not to damage the painted surfaces of the motorcycle.
 - Reinstall the removed parts on the motorcycle and make sure that the wires and harnesses are not pinched.
 - Disconnect the negative (-) cable from the battery before installing this accessory.
 - The memories of the tripmeter and clock will be erased when you disconnect the battery. After reconnecting the battery, refer to the motorcycle Owner's Manual and reset the meter.
 - Trim the excess ends off the wire ties after attaching them to the wire harnesses. Do not allow the cut part of the wire tie to interfere with any harness or brake hose.
 - After this accessory installation, check the lights (e.g. right / left turn signal lights and brake lights) for proper operation.
- **Illustration shows VFR1200XD type another type is similar.**

1. Refer to the Service Manual for the motorcycle, remove the motorcycle parts, and disconnect the negative (-) cable from the battery.

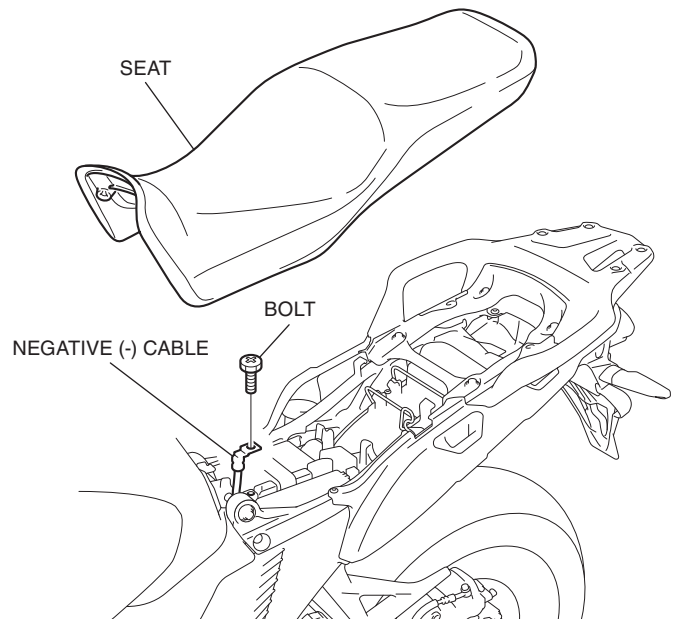

2. Refer to the Service Manual for the motorcycle, remove the motorcycle parts.
 - **Repeat on the right side.**

<Left side>

LEFT MIDDLE COWL
Do not remove yet.

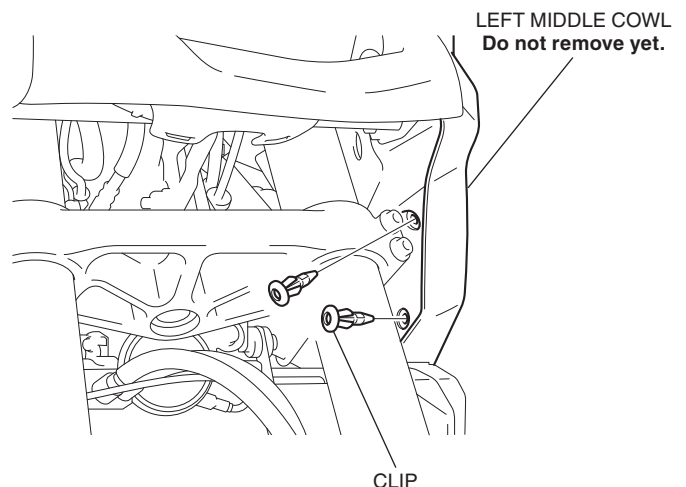
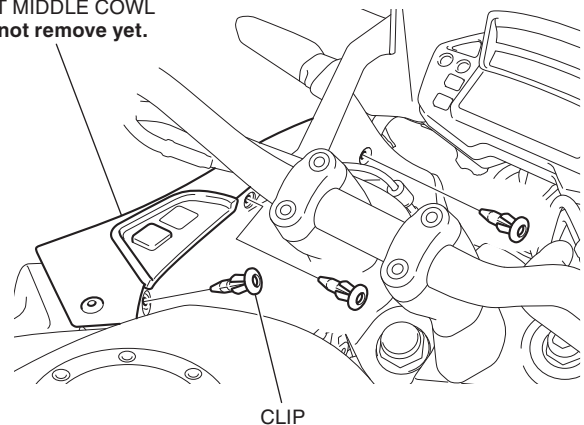

Continued

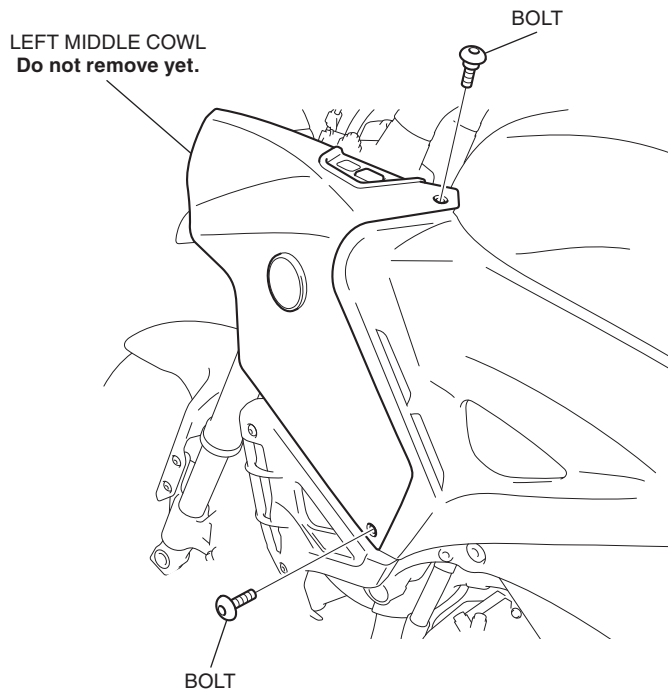

2-PIN WATERPROOF
CONNECTOR (Blue)
Disconnect.

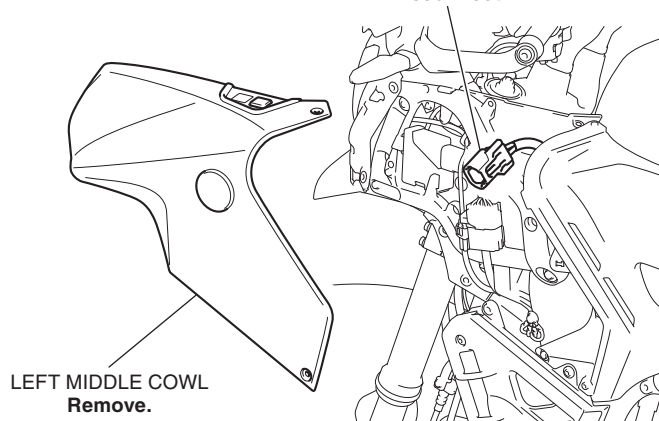

If installed, disconnect the Front Foglight (sold separately) switch connector as shown.

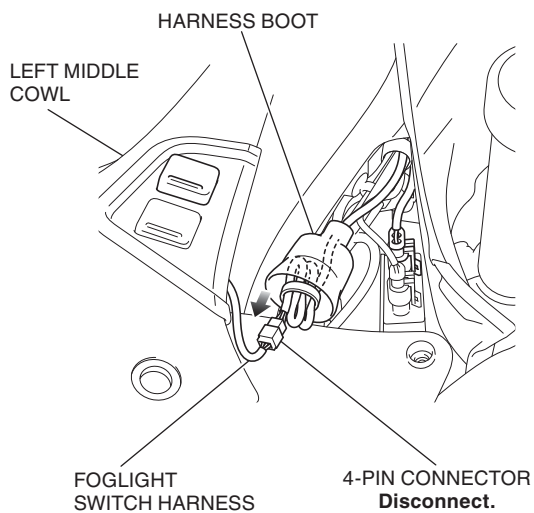

3. Remove the left knee cowl as shown.

- Repeat on the right side.

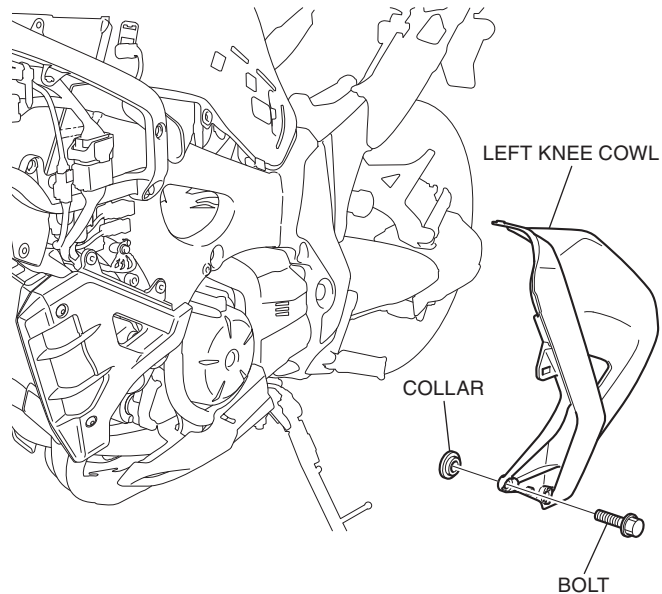

4. Remove the dummy connectors.

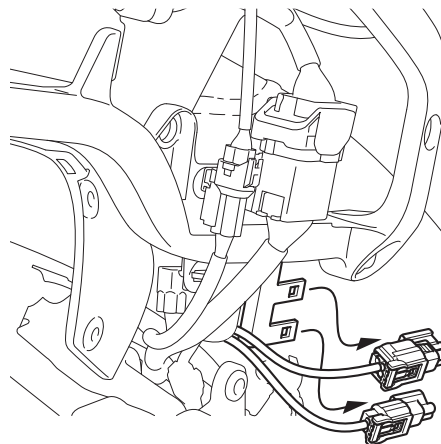

Remove the dummy connectors.

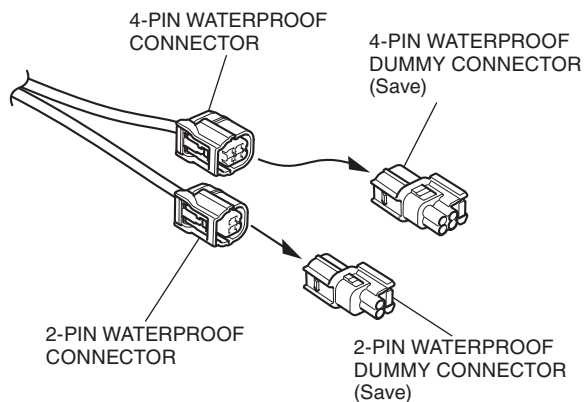

5. Remove the handguard from the motorcycle's left grip as shown.

- Repeat on the right side.

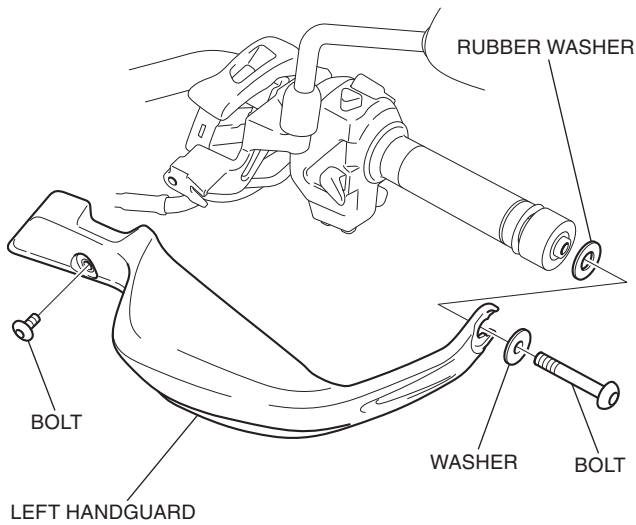

6. Remove the handlebar weight from the left grip as shown.

- Repeat on the right side.

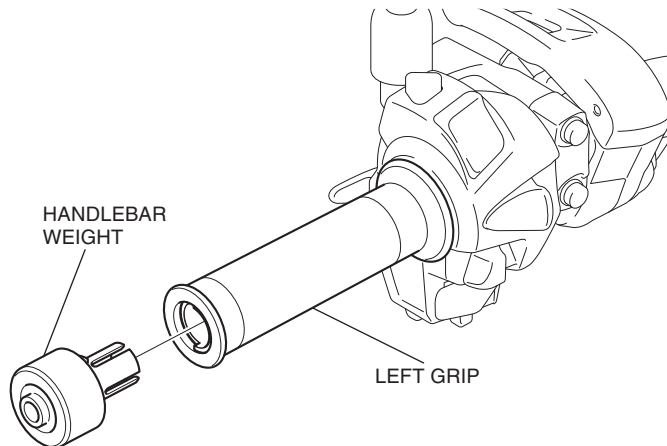

7. Remove the left grip as shown.

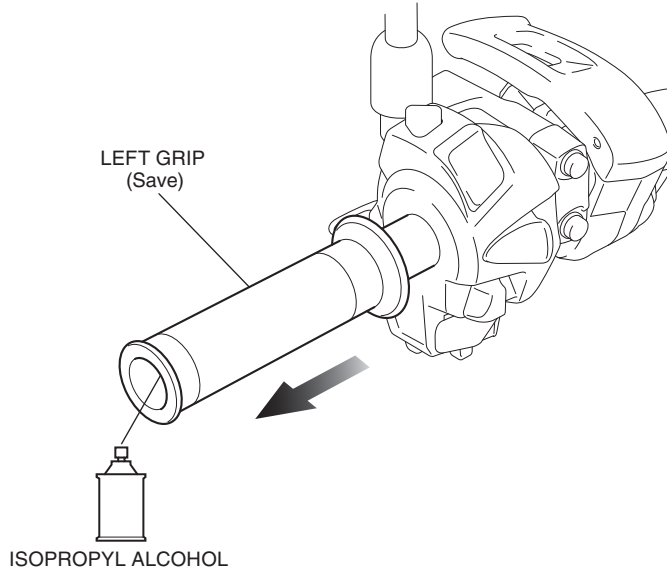

8. Using isopropyl alcohol, remove all traces of adhesive from the left handlebar pipe.

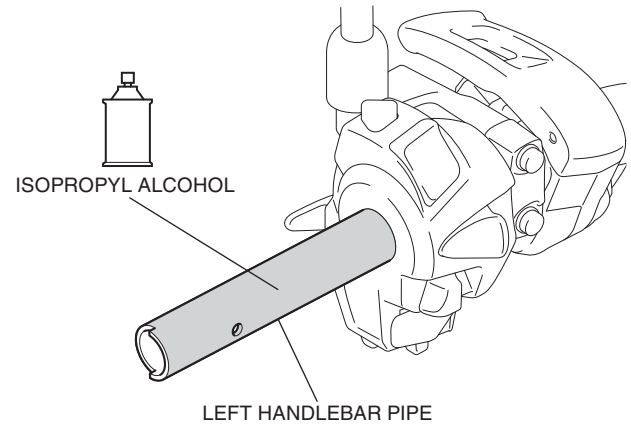

9. Mark the left heated grip harness in the positions shown.

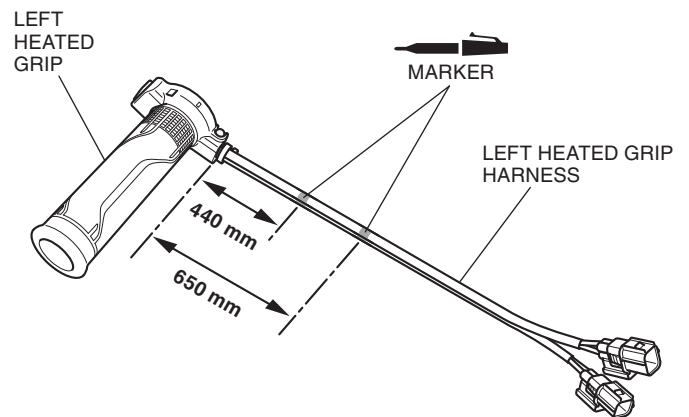

10. Apply the Pro Honda Handgrip Cement to the left handlebar as shown.

- Apply evenly to the whole circumferential surface of the left handlebar.
- Perform the next step 5 minutes after application.

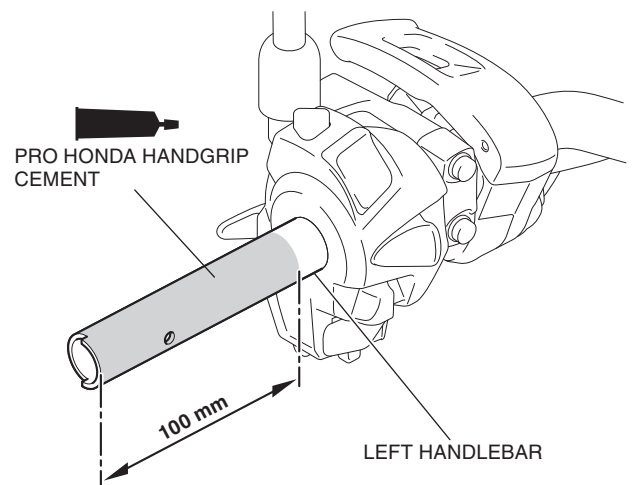

11. Spray isopropyl alcohol over the entire inside of the heated grip and outside of the left handlebar.

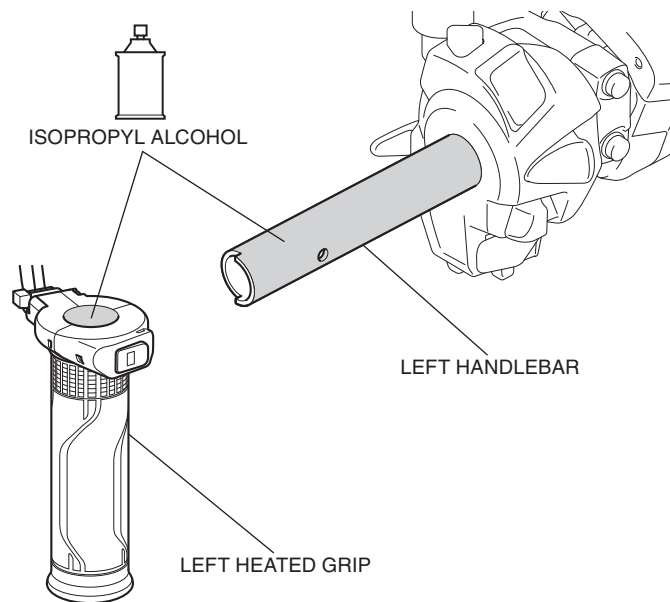

12. Slide the left heated grip onto the left handlebar as indicated.

- Use an assistant to steady the motorcycle while installing the grips.
- Wipe up any excess adhesive at once.

NOTICE

- Do not tap on the grip end with a hammer and do not twist the grip to install the heated grip onto the handlebar, as it can damage the element.



- Avoid putting pressure on the switch part when inserting the left heated grip. There is a possibility that the switch part will break. Also, install so that there is no gap with the left handlebar switch.



- If the grip gets stuck halfway during installation, apply isopropyl alcohol to the gap between the heated grip. Do not try to remove the heated grip using force or a screwdriver, etc. Damage to the heated grip wire can result.
- Do not touch the left handlebar and turn on the heater switch at least one hour after attachment.

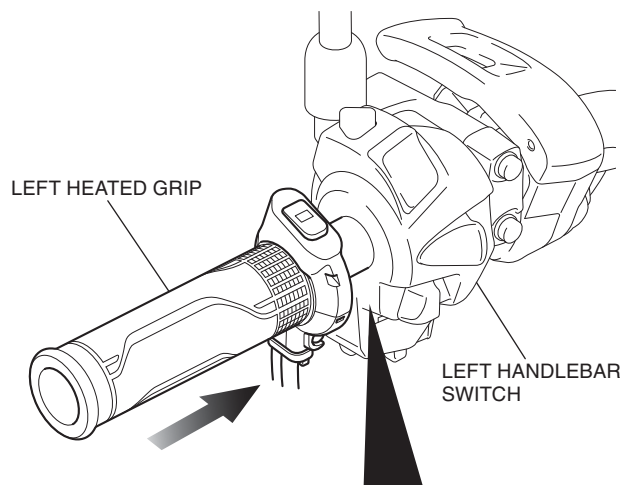

Insert until there is contact with the left handlebar switch, then align with the indicated position.

<VFR1200X>

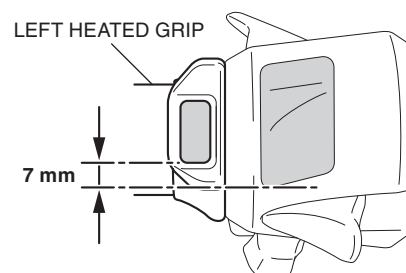

<VFR1200XD>

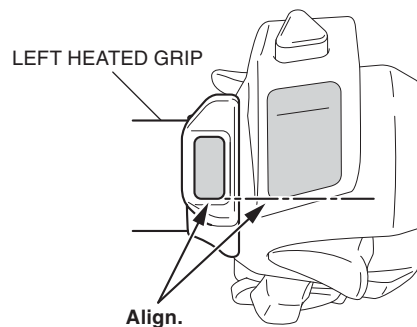

13. Remove the left inner panel as shown.

- **Support the unmounted upper cowl securely.**

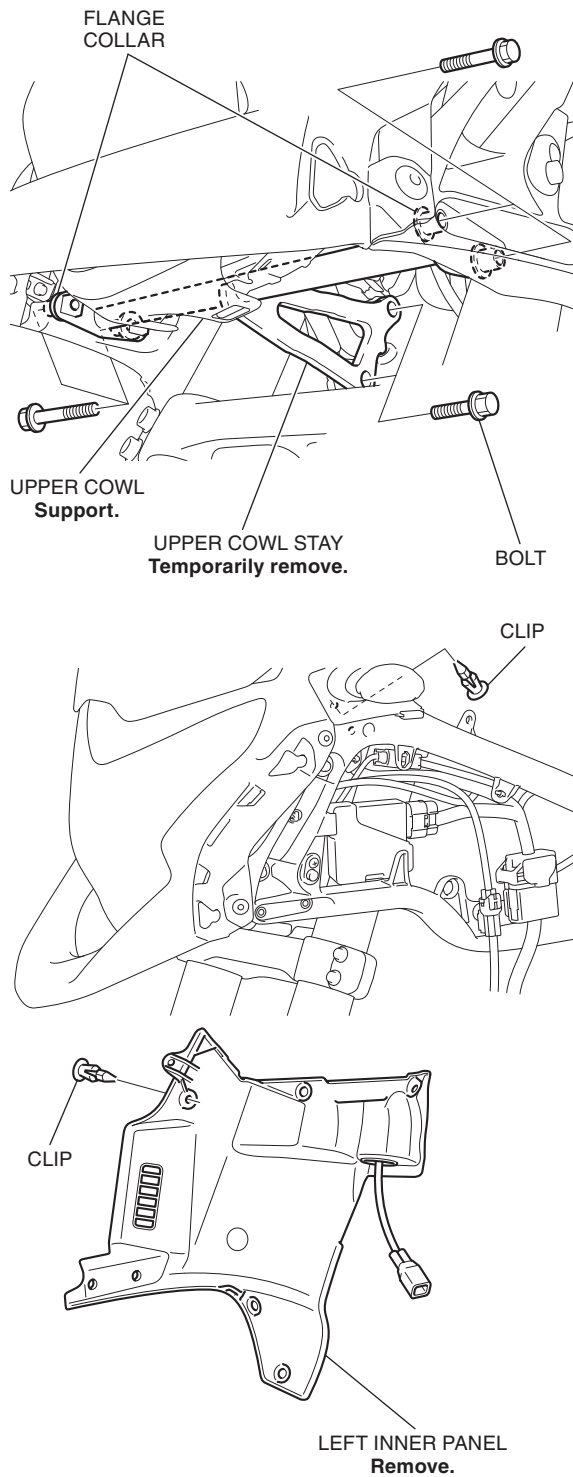

14. Lift the fuel tank up as shown.

- **Hold the lifted fuel tank securely.**

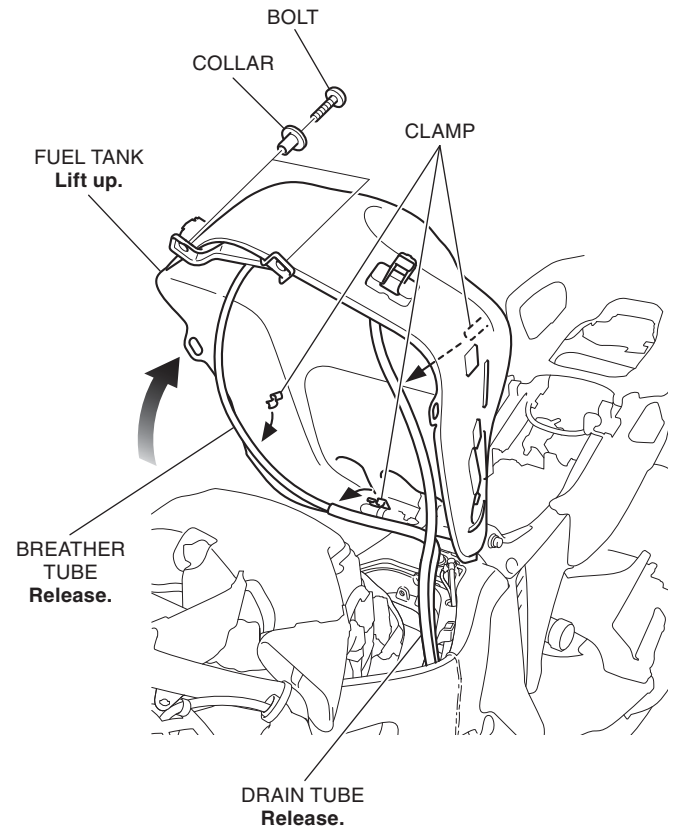

15. Remove the connector from the ECM as shown.

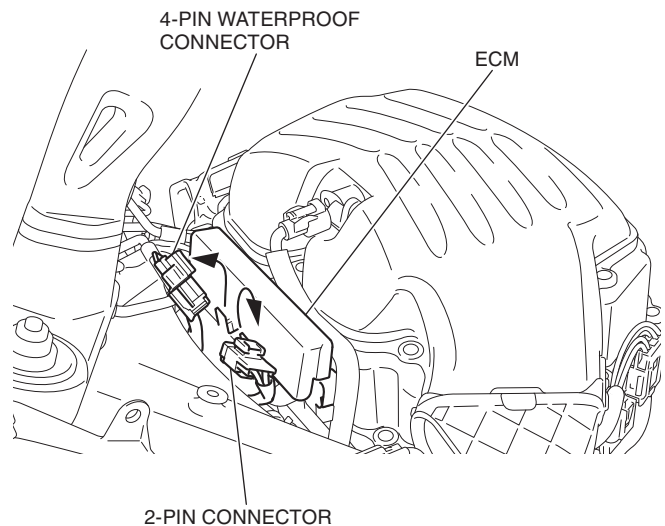

16. Pull out the ECM as shown.

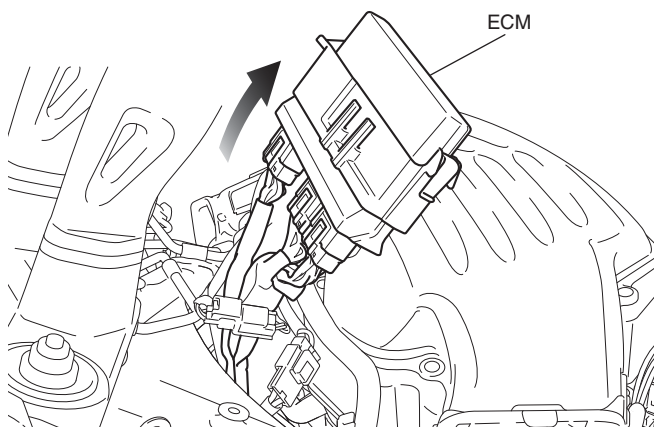

17. Route the left heated grip harness as shown.
<Left side>

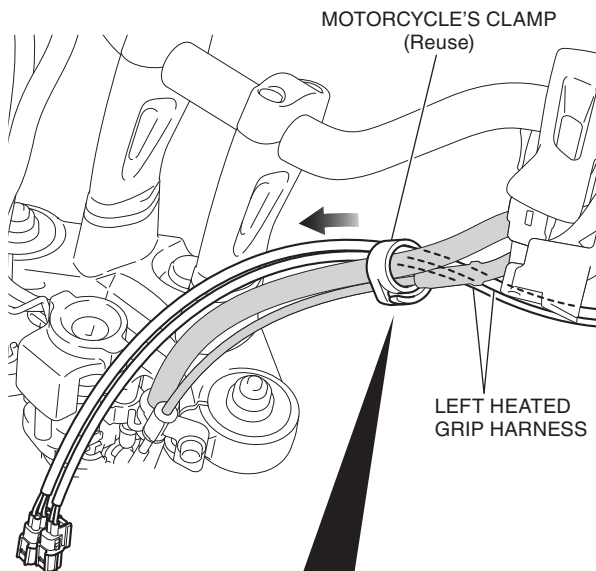

<VFR1200X>

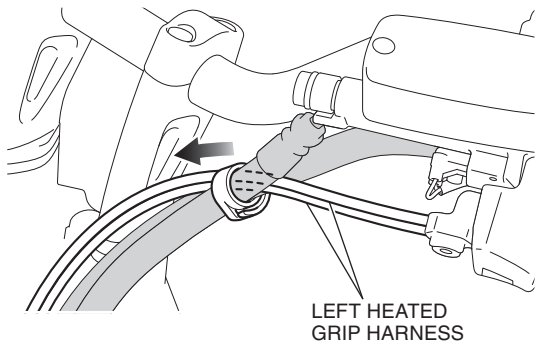

18. Route the left heated grip harness as shown.

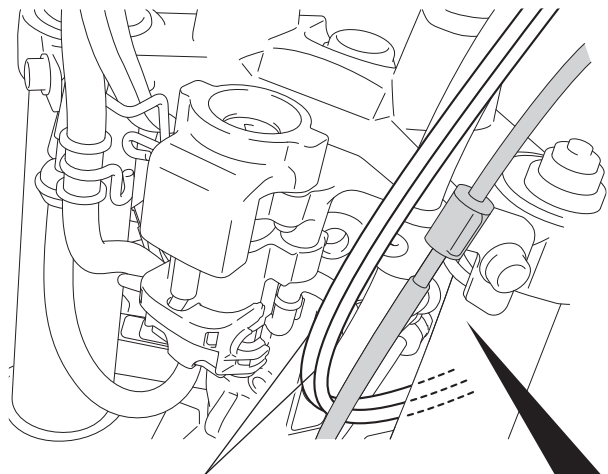

LEFT HEATED GRIP HARNESS

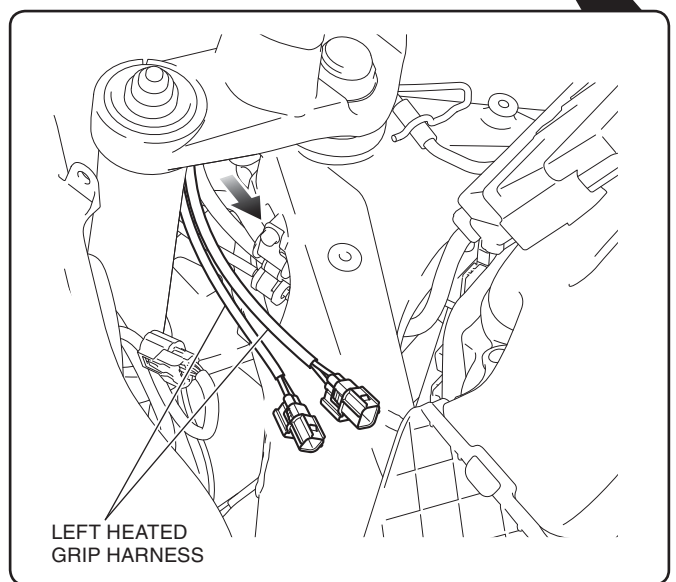

19. Pass the left heated grip harness as shown.

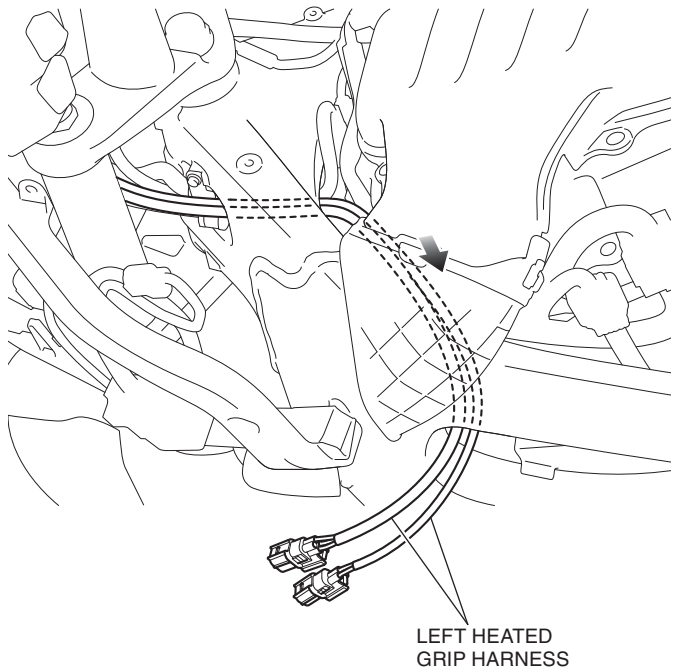

20. Connect the left heated grip harness as shown.

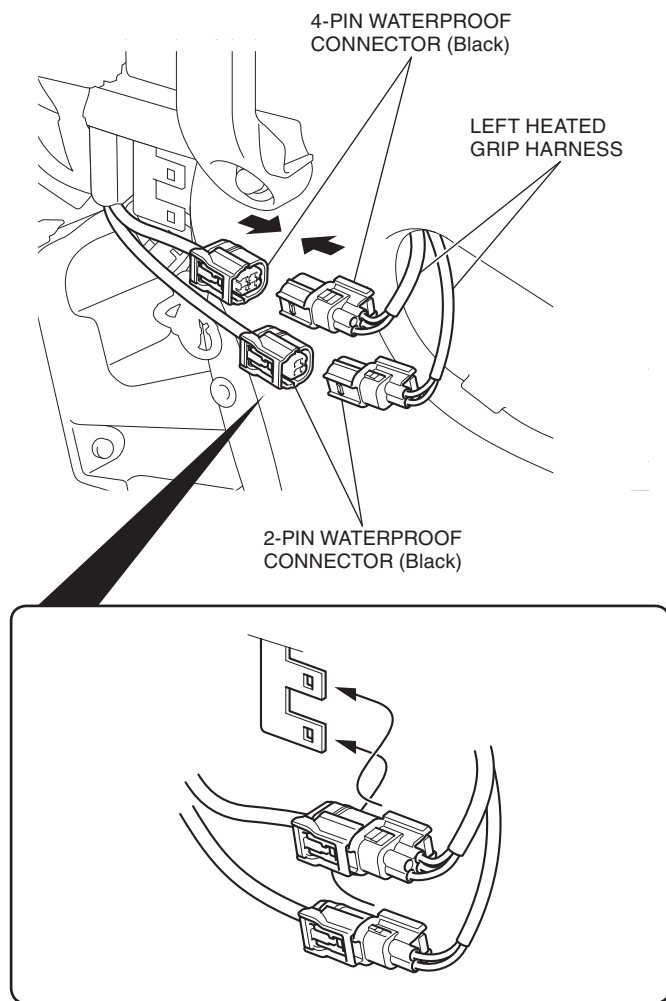

21. Remove the screws from the motorcycle as shown.
<Right side>

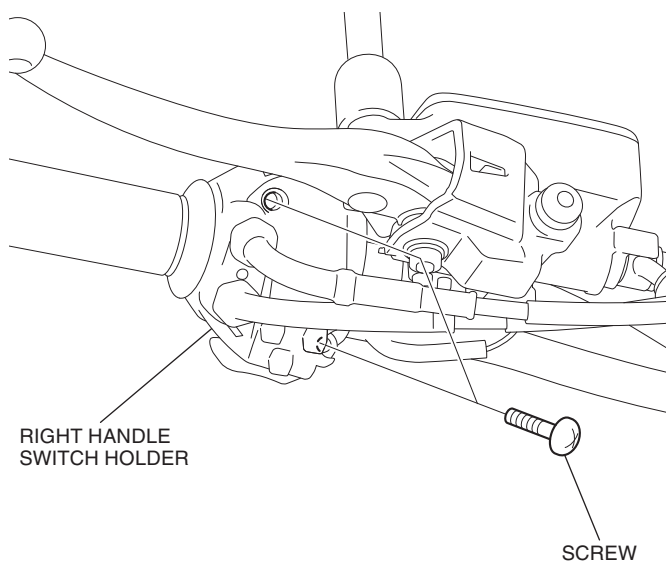

22. Remove the right grip as shown.

NOTE

Disconnect the throttle cable from the right grip as instructed in the motorcycle's Service Manual. Do not try to disconnect the cable with force using pliers, etc.

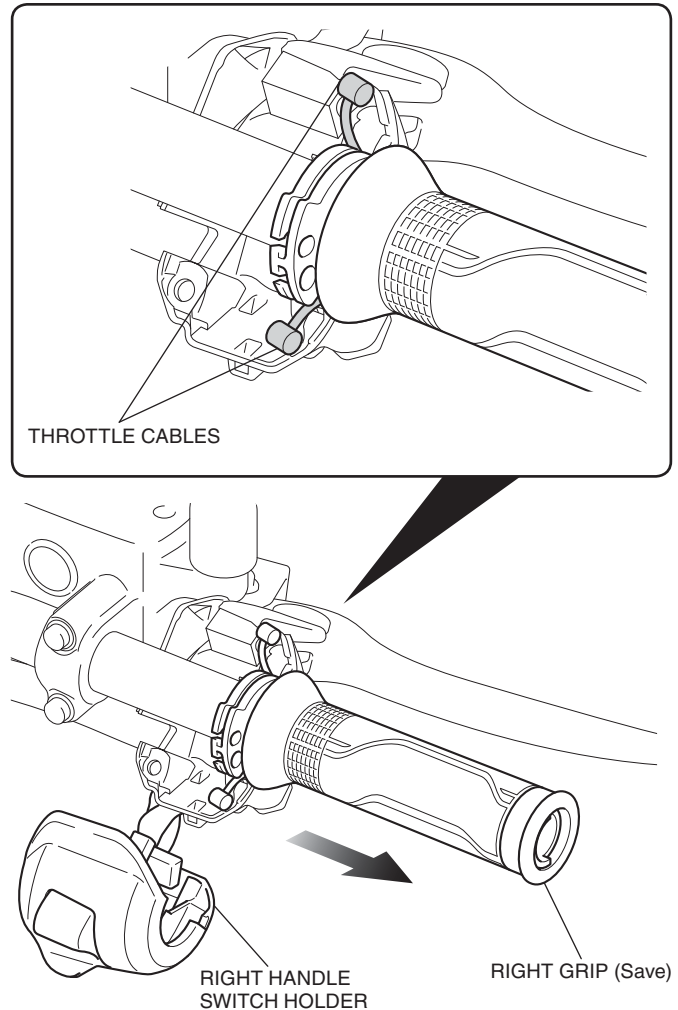

23. Mark the right heated grip harness in the positions shown.

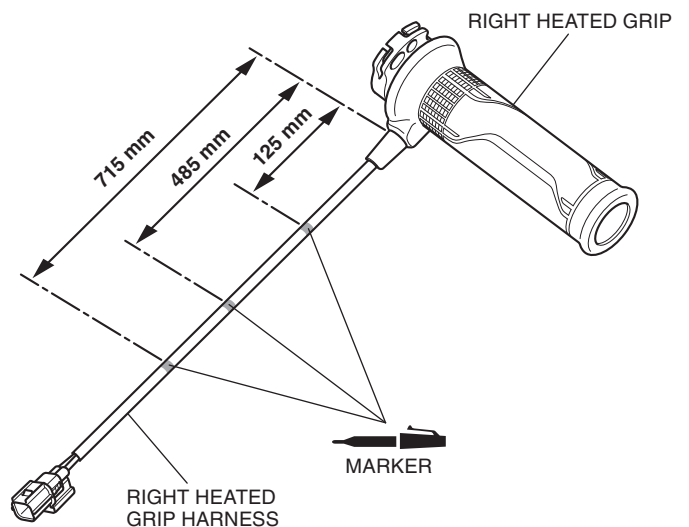

24. Wind electrical tape on the marked position as shown.

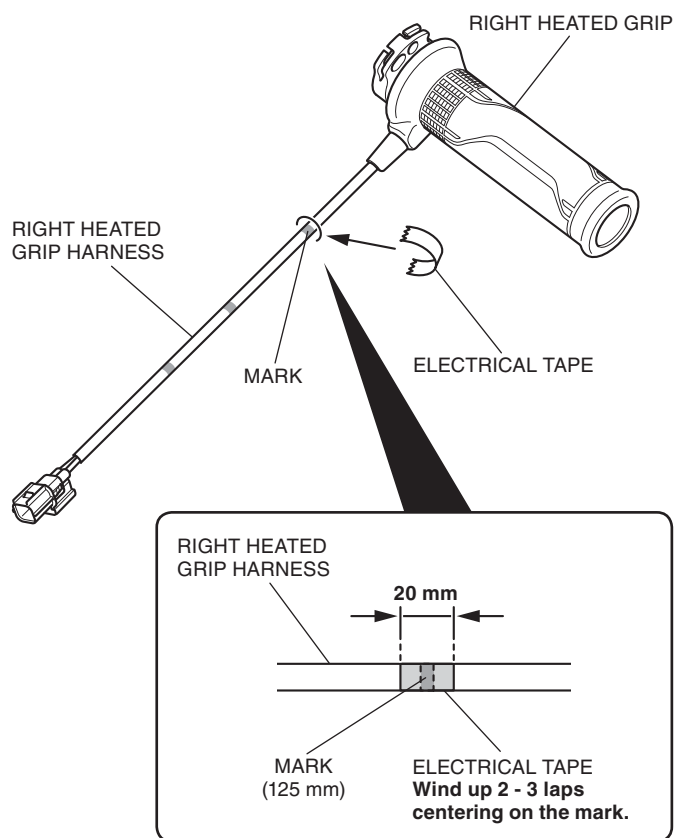

25. Mark the right heated grip harness in the position shown.

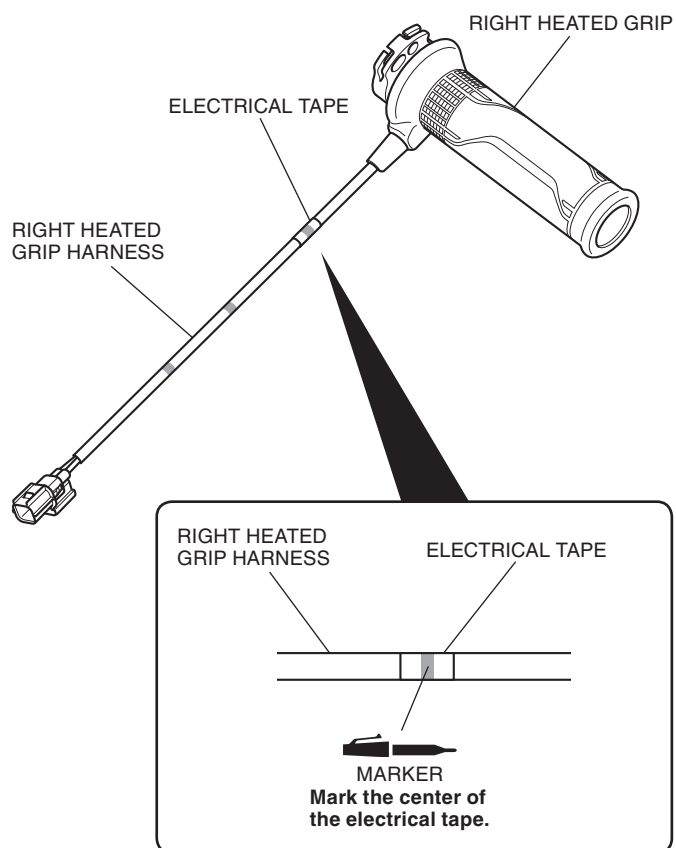

26. Apply grease to the  parts of the throttle cables and inner grip as shown.

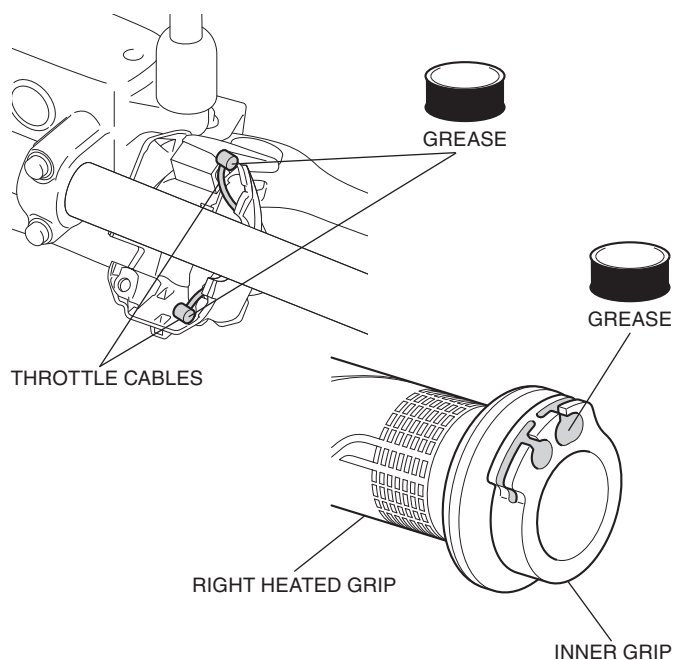

27. Install the right heated grip and right switch holder in the reverse order of removal.

- **After installation, refer to the Service Manual and adjust the throttle freeplay.**

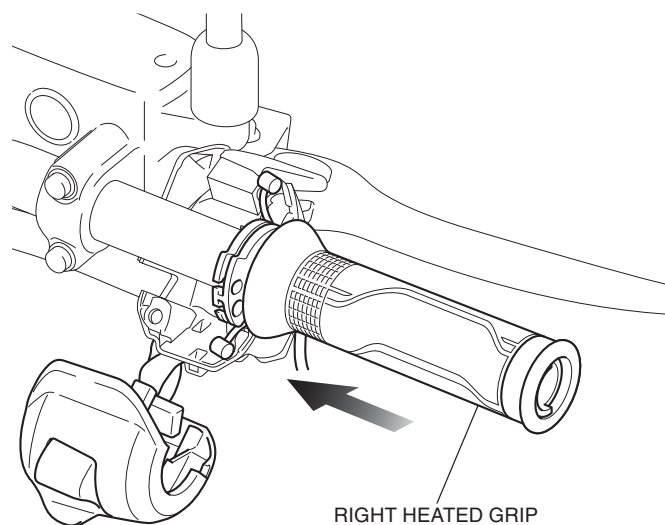

28. Open and close the throttle grip as shown.

- **Check that the throttle opens and automatically closes smoothly in any steering position.**

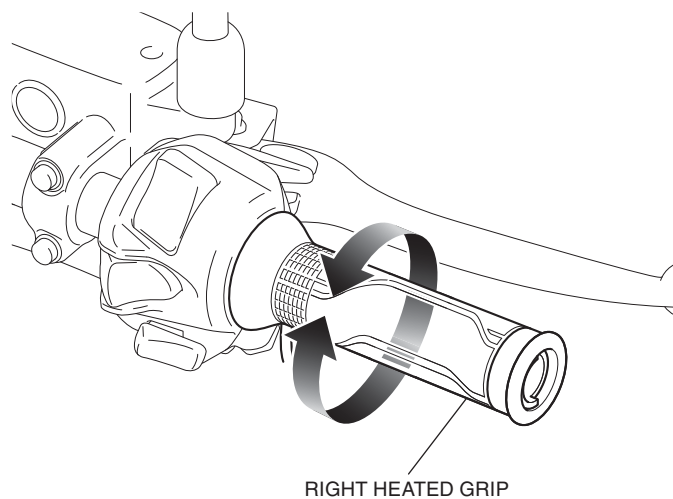

29. Route the right heated grip harness as shown.

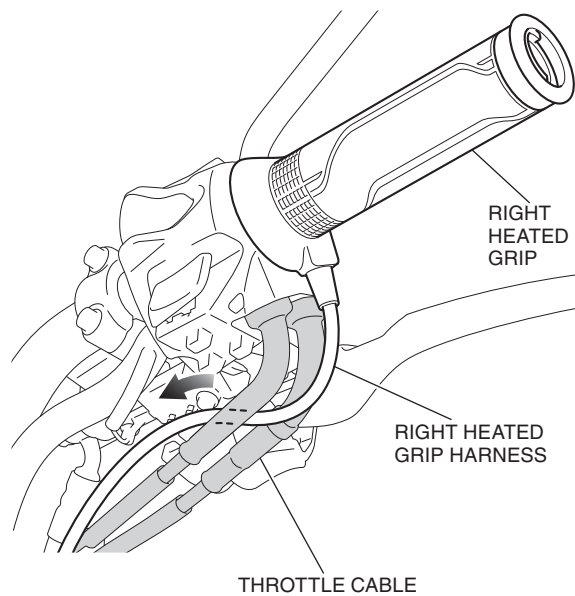

30. Route the right heated grip harness as shown.

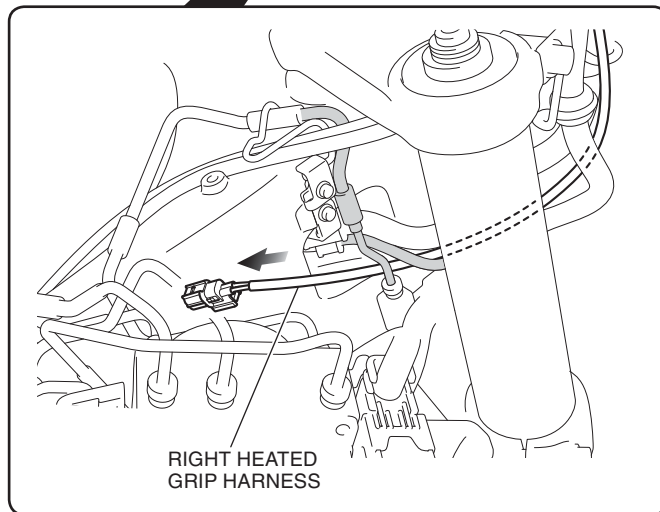
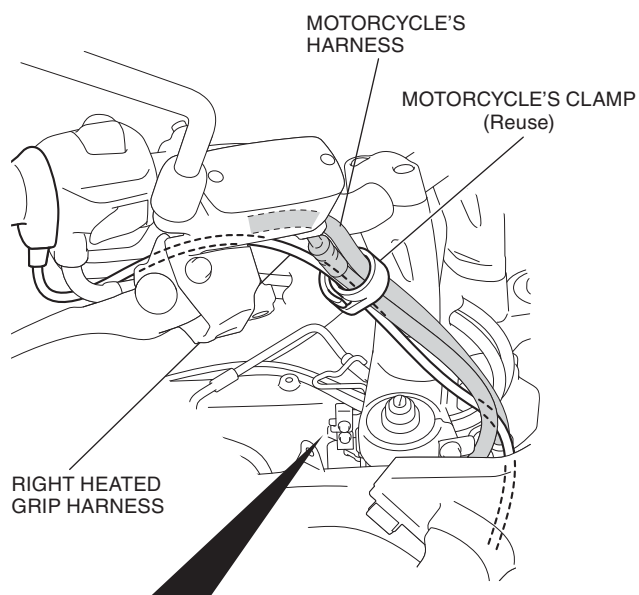

31. Route the right heated grip harness as shown.

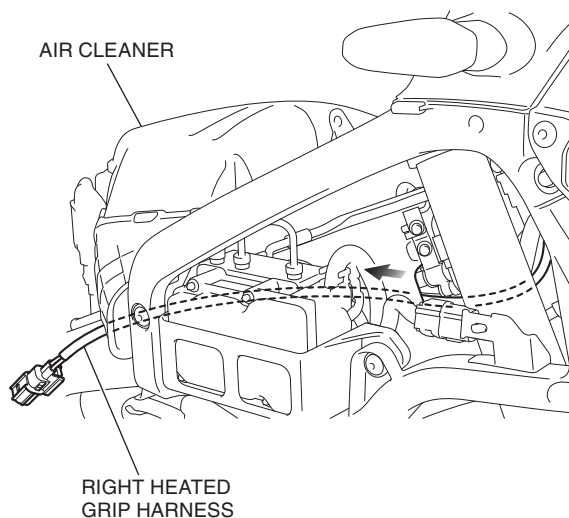

32. Route the right heated grip harness as shown.

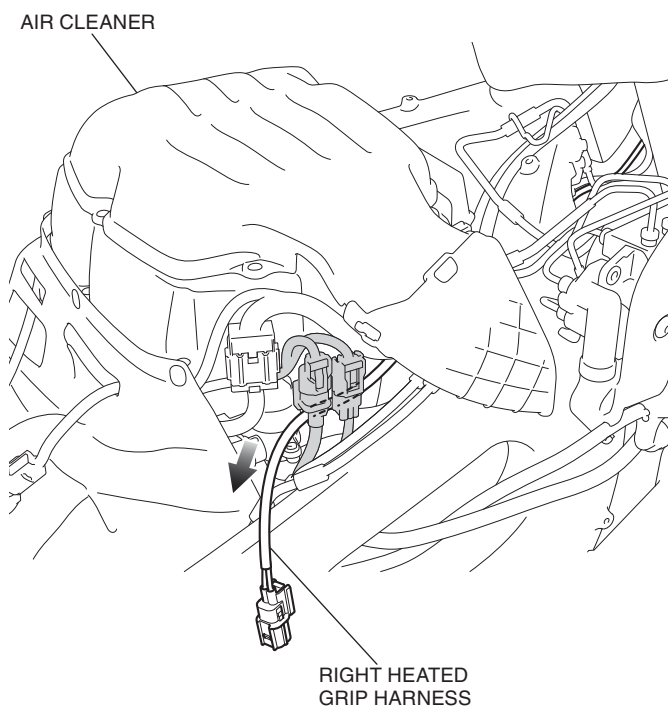

33. Turn up the rubber guard as shown.

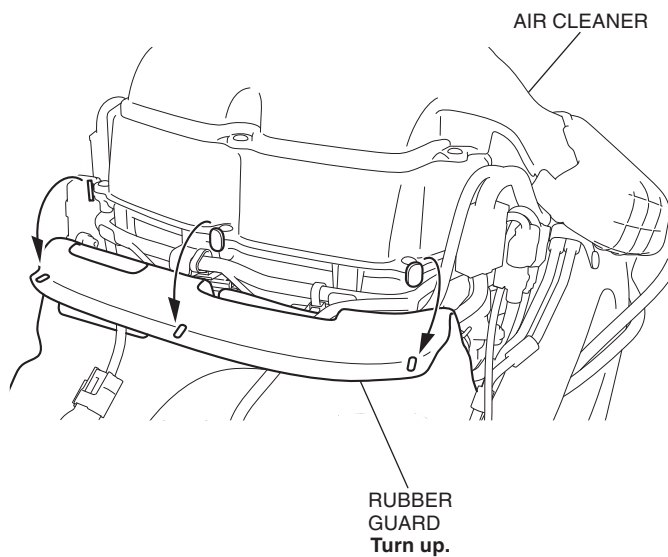

34. Remove the dummy connector as shown.

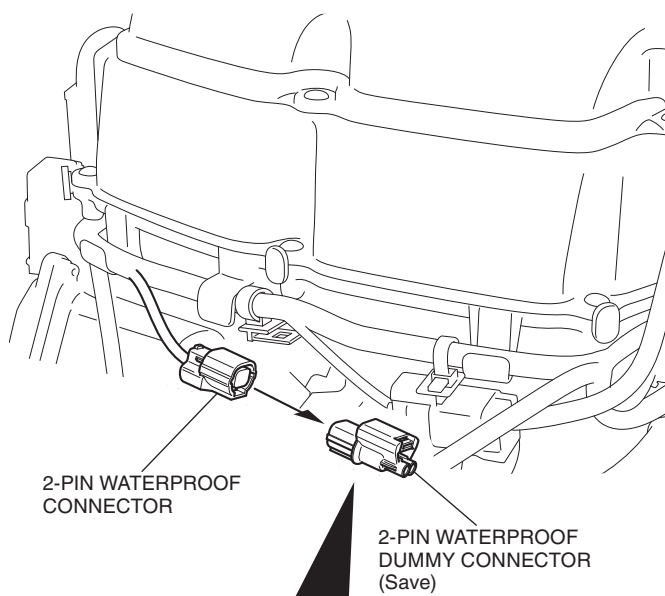

Remove the connector from the clip band.

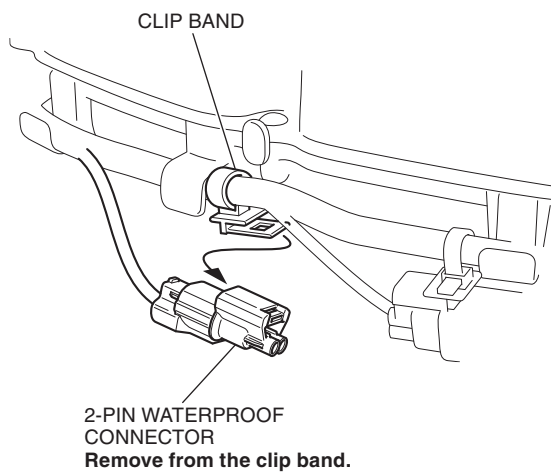

35. Route the right heated grip harness as shown.

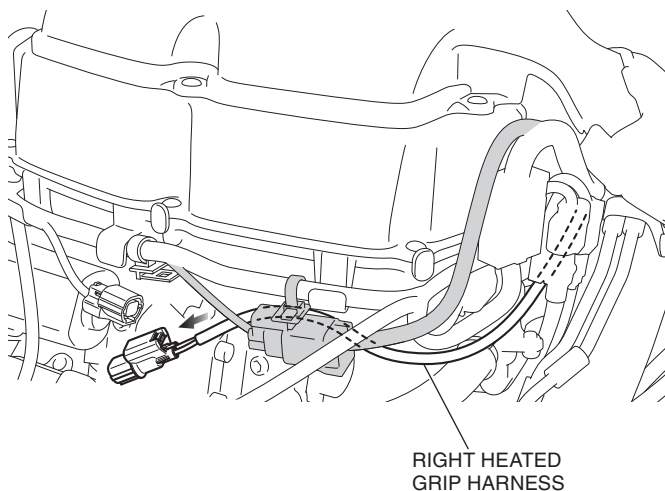

36. Connect the right heated grip harness as shown.

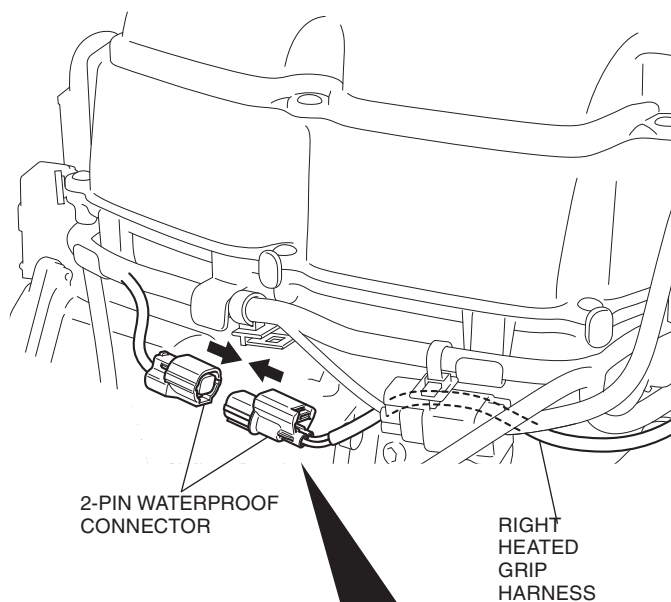

Secure the right heated grip harness to the clip band.

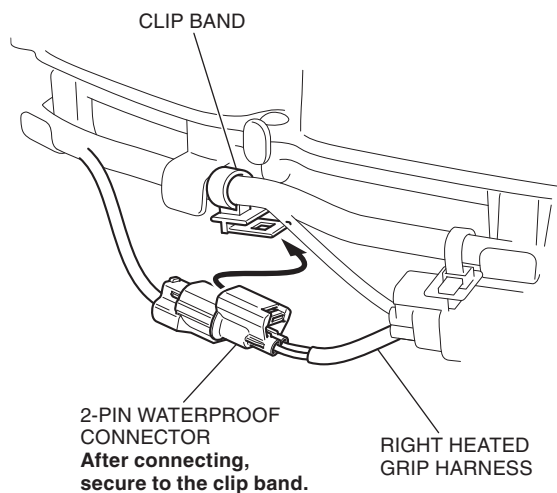

37. Remove the wire tie and dummy connector.

<Right side>

Remove the dummy connector.

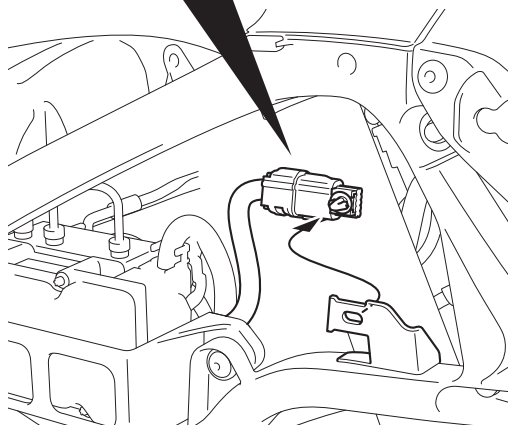
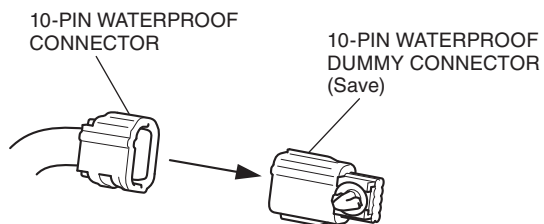

38. Install the suspension as shown.

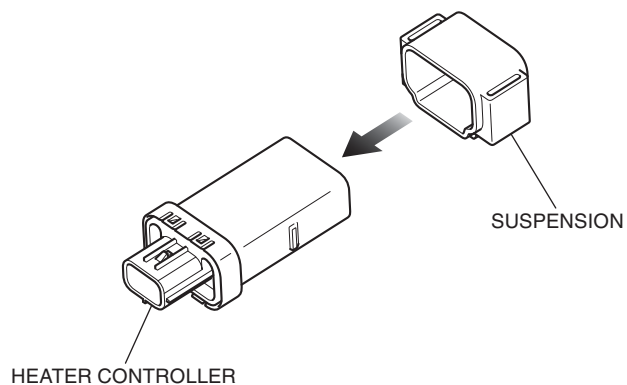

39. Connect the heater controller as shown.

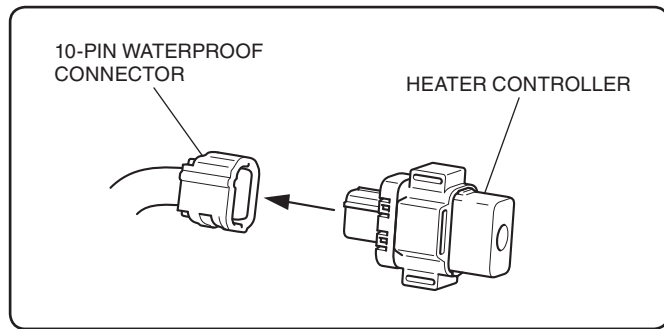

HEATER CONTROLLER
After connecting, store the heater controller in the motorcycle's stay.

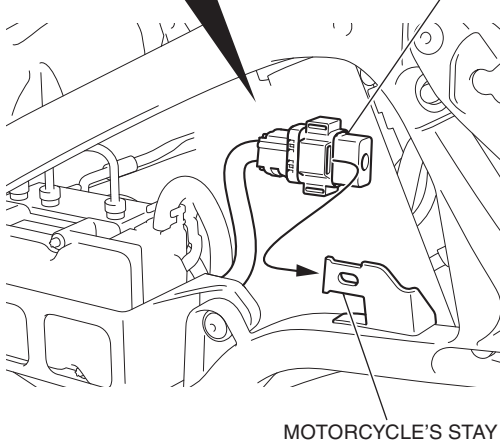

40. Secure the right and left heated grip harness using the wire ties as shown.

<Front side>

WIRE TIE (wide/short)
Secure at the mark on the right and left heated grip harness to the motorcycle's harness.

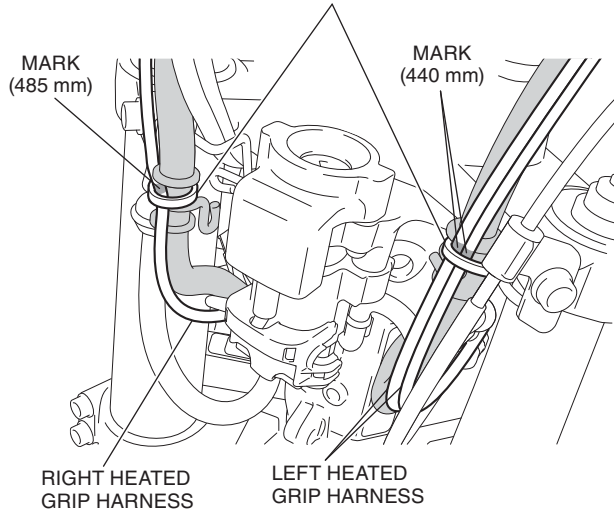

41. Secure the left heated grip harness using a wire tie as shown.

<Left side>

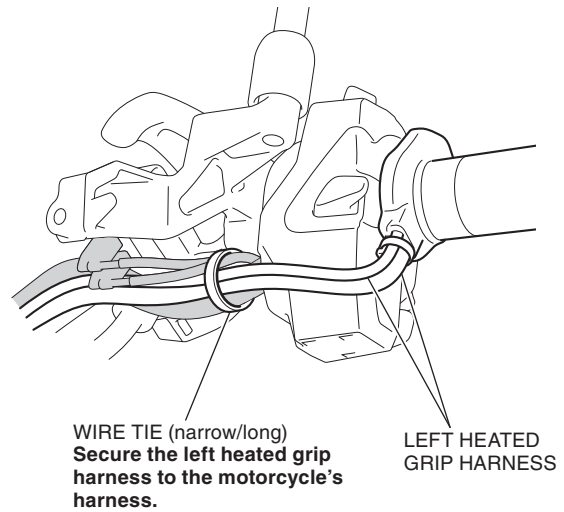

42. Secure the left heated grip harness using a wire tie as shown.

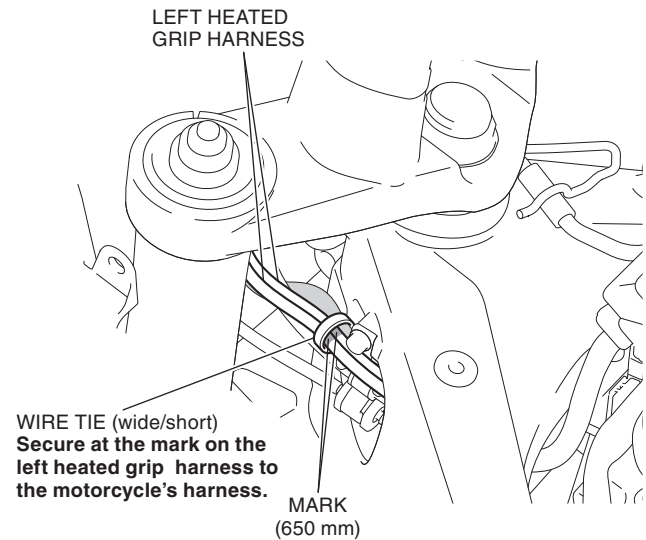

43. Secure the right heated grip harness using a wire tie as shown.

- **Check that the throttle opens and automatically closes smoothly in any steering position.**

<Right side>

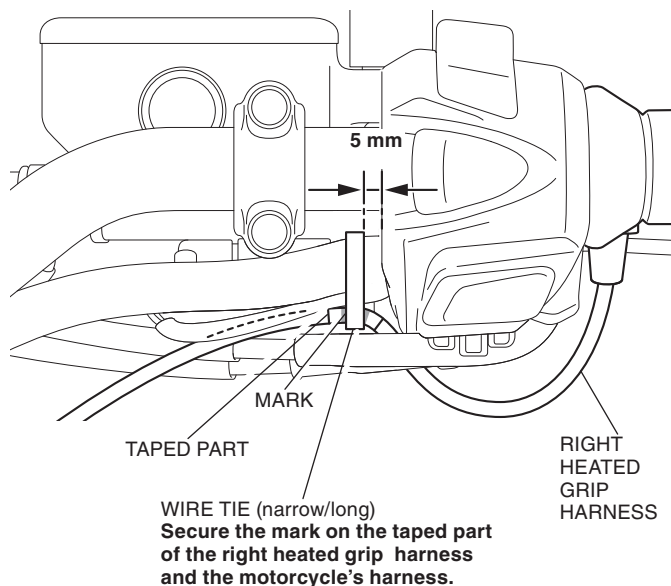

44. Secure the right heated grip harness using a wire tie as shown.

- **Move the handlebar right and left and check that the harnesses are not pinched by the neighboring components and that they are not pulled taut.**

<Right side>

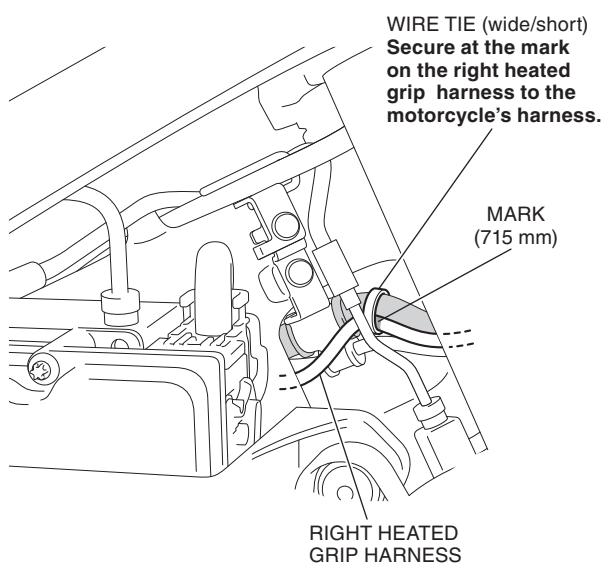

45. Secure the right heated grip harness using a wire tie as shown.

<Right side>

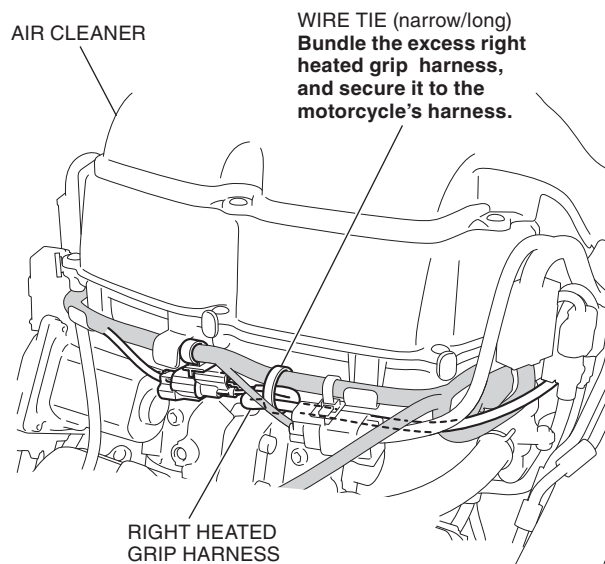

46. Install the rubber guard and fuel tank in the reverse order of removal.

47. Reinstall the handguard as shown.

- **Clean up threads with isopropyl alcohol before applying thread lock.**
- **Be sure to apply thread lock to the threads of the bolt.**
- **Repeat on the right side.**

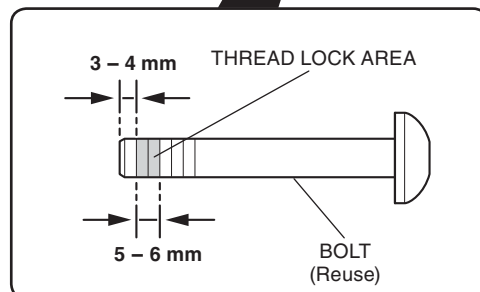
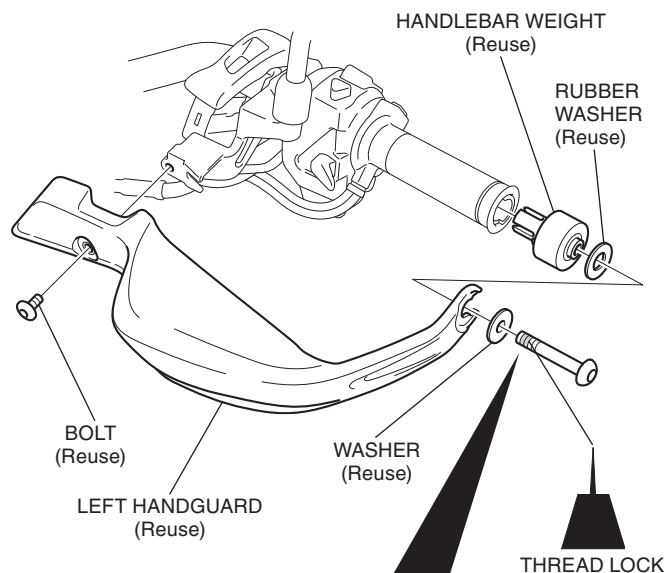

48. Check the throttle cables do not to interfere with the handguard as shown.

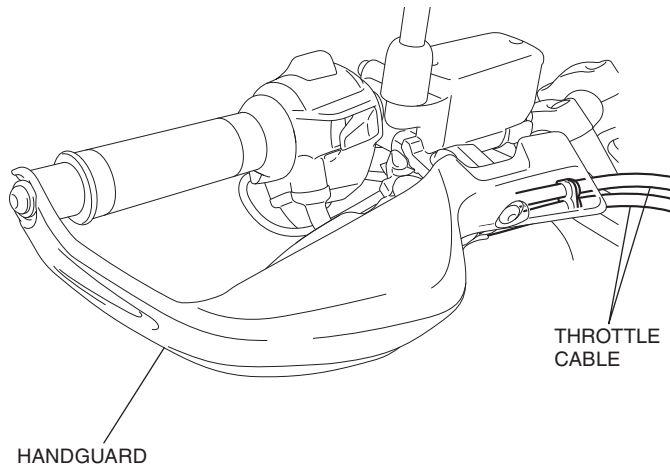

49. Check each harness for sufficient play.

- **Move the handlebar right and left and check that the harnesses are not pinched by the neighboring components and that they are not pulled taut.**

50. Install the motorcycle's parts in the reverse order of removal.

- **Confirm that the harness is not caught or too tight.**

51. Move the handlebar right and left, and check that this accessory is not interfere with the motorcycle parts.

52. Check the heated grip, throttle, headlight and the other lights for proper operation.





- **Perform the operation check at least one hour after attaching the left heated grip . Do not set the heater level at more than 3 as the adhesive may soften.**
- **Make sure to turn off the heater switch after the operation check.**

Please convey the following information to the customer during delivery.

- **Do not set the heater level higher than 1 for one week after installation to allow the adhesive to fully cure.**

DEALER TROUBLESHOOTING

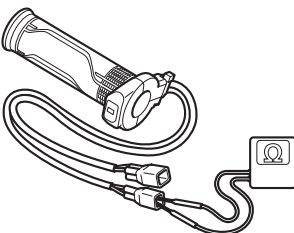
- Stop the engine and turn the ignition switch OFF when you check the parts and circuits other than those of the heated grips.

Symptom	Check
<p>Meter shows the “ E ” of the level display and heater indicator. The level display and heater indicator flashes.</p> 	<p>Check for loose or poor contact in the connectors. Refer to the SYSTEM DIAGRAM of this manual and check for blown fuse.</p>
<ul style="list-style-type: none"> E1 status displayed pattern: 	<p>Check for E1 status (Low battery voltage) :</p> <ol style="list-style-type: none"> Check the battery voltage.
<ul style="list-style-type: none"> E2 status displayed pattern: 	<p>Check for E2 status (Open or short circuit) :</p> <ol style="list-style-type: none"> Heated grip inspection Check for resistance between the terminals. <ul style="list-style-type: none"> Standard: $\langle \text{Right} \rangle 8.2 \text{ ohms} \pm 10\%$ / $\langle \text{Left} \rangle 8.2 \text{ ohms} \pm 10\%$  Refer to the SYSTEM DIAGRAM of this manual and check for an open or short circuit in the heated grip related wires. If no abnormality is found after the above checks 1 and 2, but the heated grip still does not operate properly, replace the heated grip (heater controller) with a new one.
<ul style="list-style-type: none"> E3 status displayed pattern: 	<p>Check for E3 status (Faulty heated grip switch) :</p> <ol style="list-style-type: none"> Replace the heated grip (heater switch) with a new one. It is hard to check the switch with ordinary inspection methods (for continuity, voltage, etc.) because it contains an integrated circuit.