



INSTALLATION INSTRUCTIONS

Accessory

CUSTOM GRIPS
P/N 08F69-MFY-100

Application

VT1300CR/CS/CT/CX

Publications No.

MII 13075

Issue Date

February 2010

Honda Dealer: Please give a copy of these instructions to your customer.

PARTS LIST

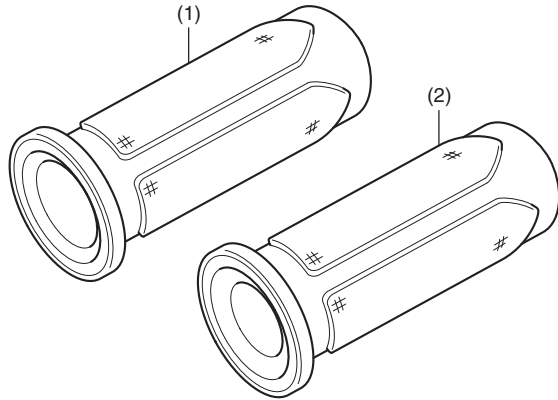

No.	Description	Qty
(1)	Right custom grip (large inner diameter)	1
(2)	Left custom grip (small inner diameter)	1

TOOLS AND SUPPLIES REQUIRED

- Phillips screwdriver
- Pro Honda Handgrip Cement (08712-0001)
- Grease
- Isopropyl alcohol
- Shop towel
- Torque wrench

TORQUE CHART

Refer to the Service Manual for the torque values of the removed parts.

USE AND CARE INFORMATION

- If the custom grip is damaged by a crash, etc., always check the throttle for smooth movement because the inner grip may also be damaged.

INSTALLATION

NOTE:

- For secure adhesion of the accessory use the recommended adhesive agent (Pro Honda Handgrip Cement or equivalent).

- Remove the screws as shown.

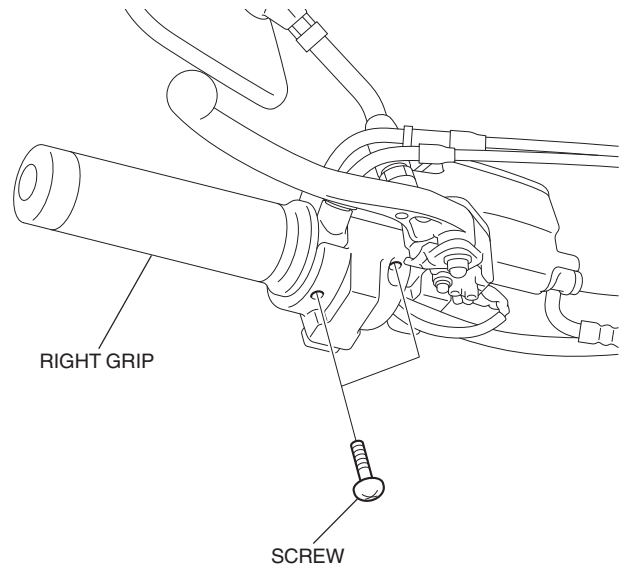

2. Refer to the Service Manual and remove the right grip as shown.

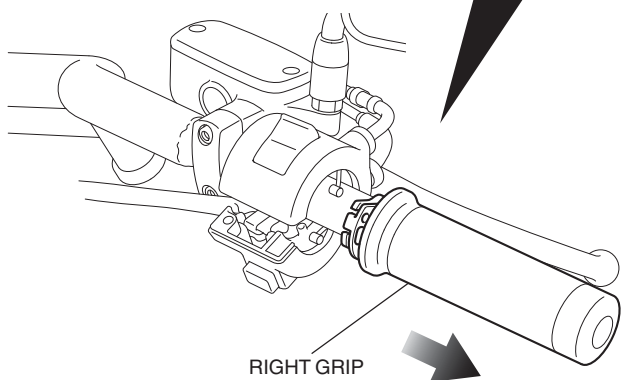
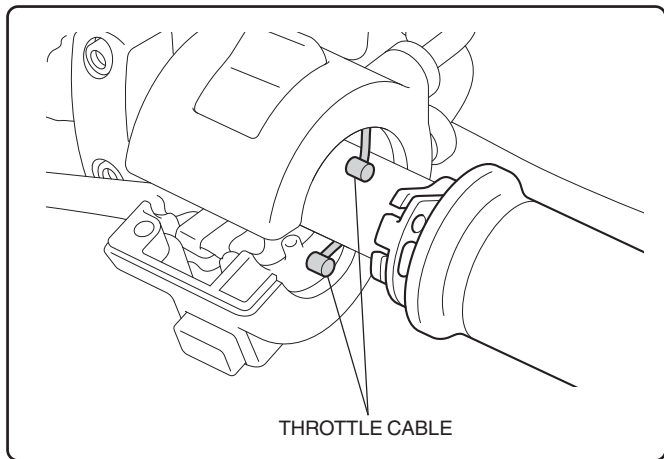

NOTE

- Disconnect the throttle cables from the throttle pipe as instructed in the motorcycle's Service Manual. Do not try to disconnect the cable with force using tools.

3. Remove the throttle pipe from right grip as shown.

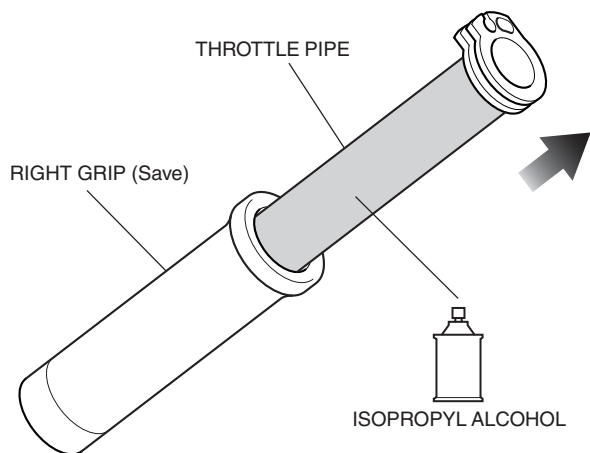

4. Use isopropyl alcohol as shown to remove any adhesive adhering to the throttle pipe.

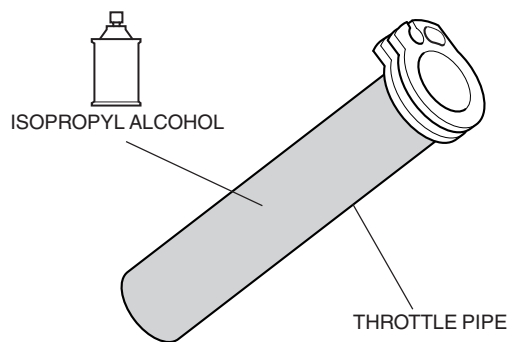

5. Apply an ample amount of Pro Honda Handgrip Cement to the inside of the right custom grip as shown.

NOTE

Read the instructions of the steps 5 through 8 carefully before operation and complete the procedures quickly before the adhesive cures.

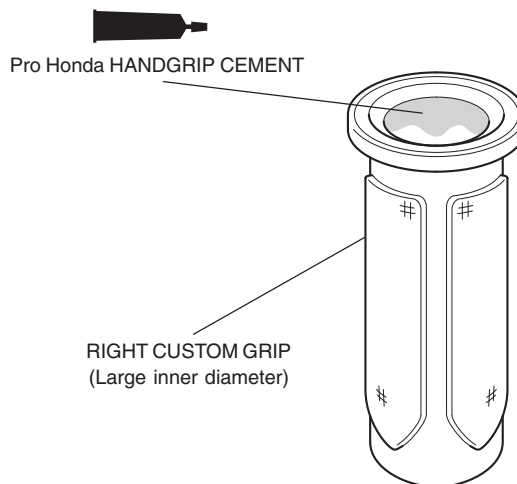

6. Apply Pro Honda Handgrip Cement to the throttle pipe and spread it with a finger as shown.

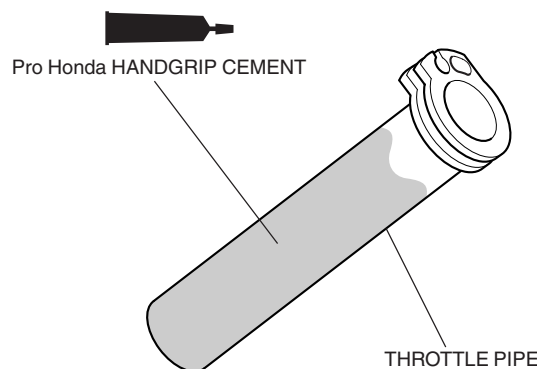

7. Spray the isopropyl alcohol over the inside of the right custom grip and over the outer surface of the throttle pipe.
- **This is done to ease installation.**

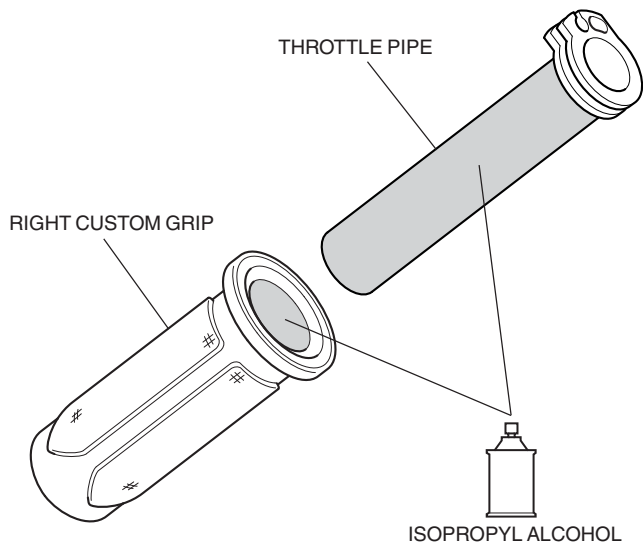

8. Push the right custom grip onto the throttle pipe, as shown in the illustration.
- **Wipe off any excess adhesive.**

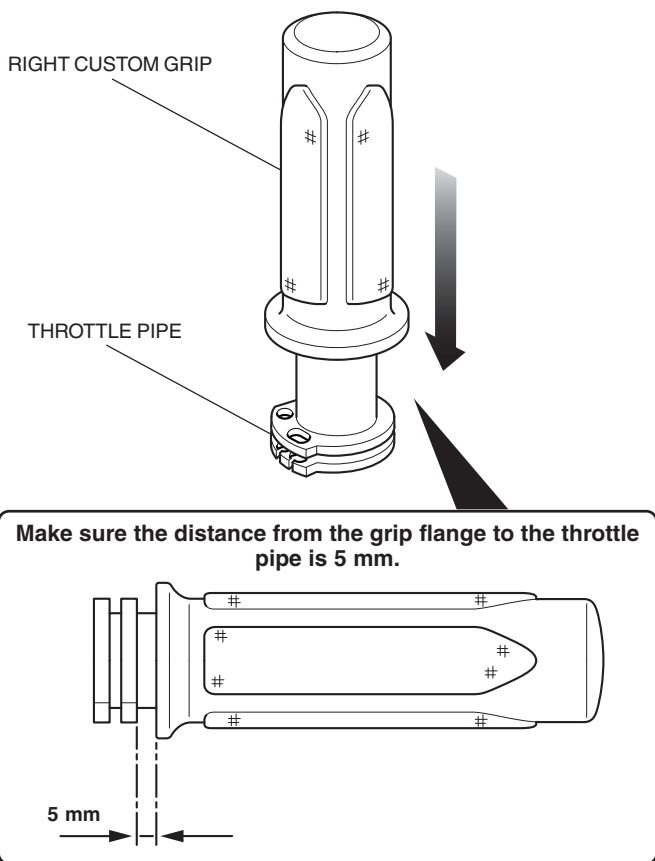

9. Apply grease to the throttle cable before connection as shown.

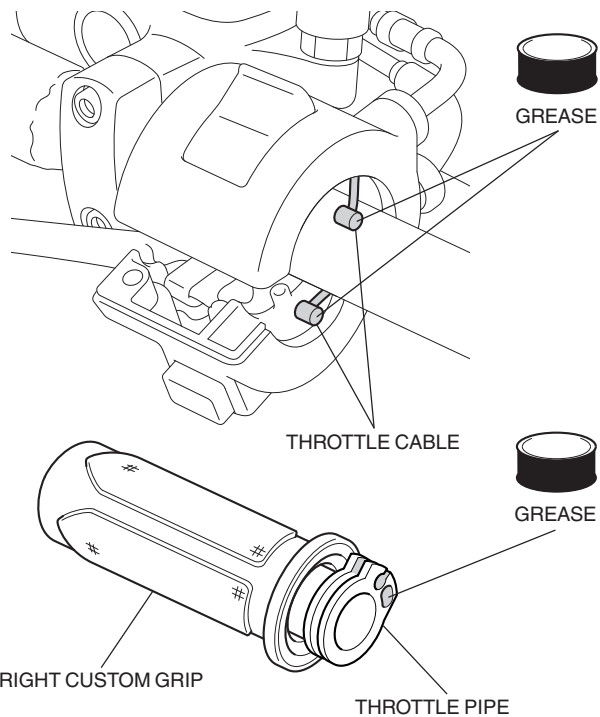

10. Install the right custom grip in the reverse order of original grip removal, and then install the right handle switch holder.

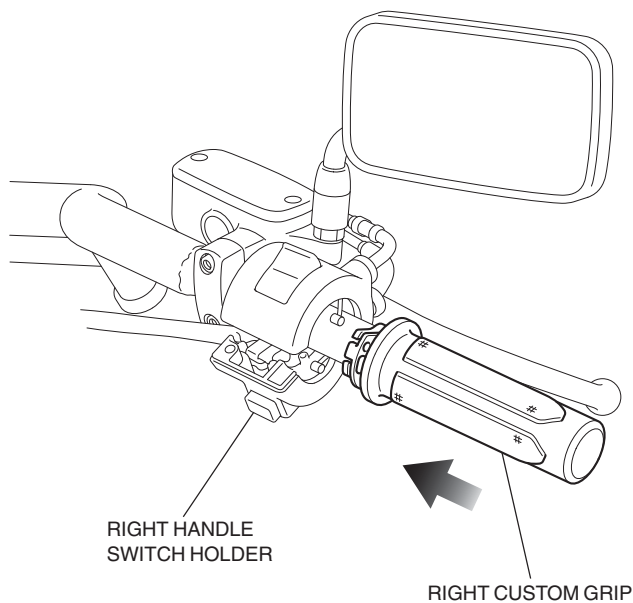

11. After installing the right custom grip on the motorcycle, check that the throttle opens smoothly and snaps shut from any opening, in any handlebar position.

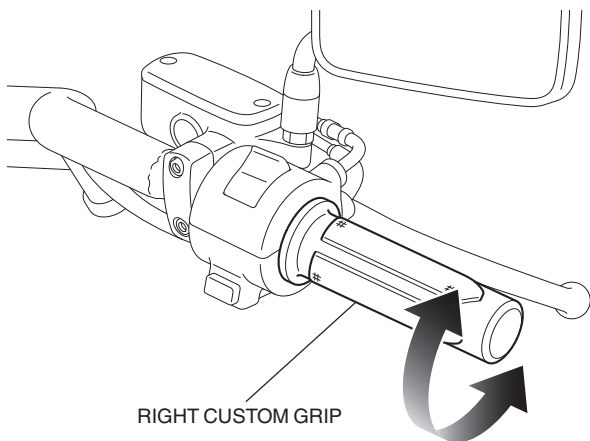

12. Remove the screws as shown.

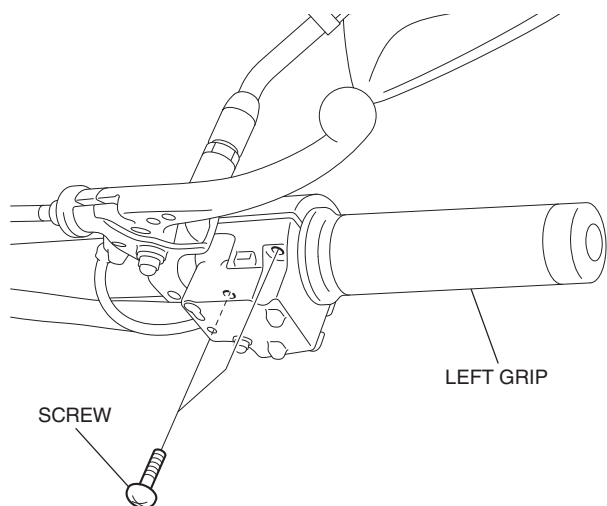

13. Remove the left handle switch holder as shown.

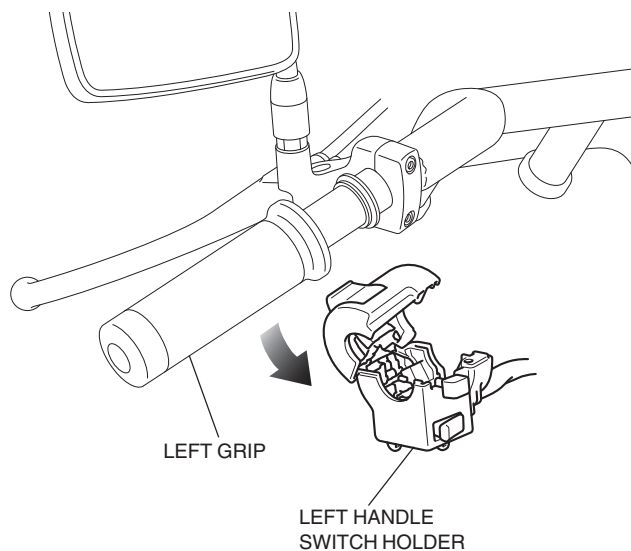

14. Remove the left grip as shown.

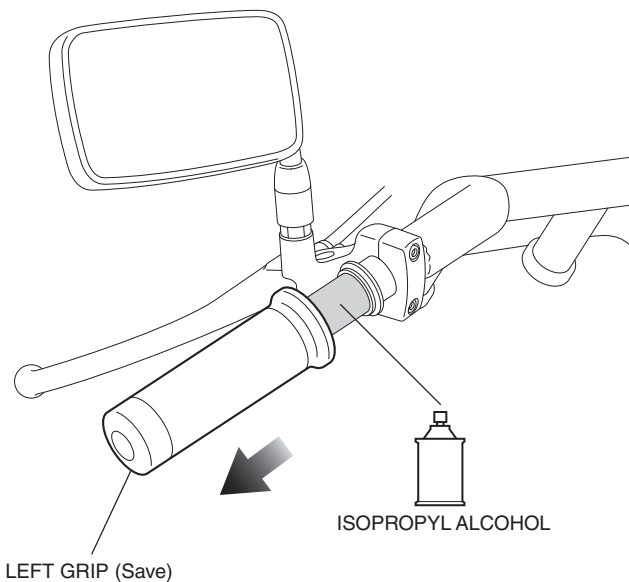

15. Use isopropyl alcohol as shown to remove any adhesive adhering to the left handlebar.

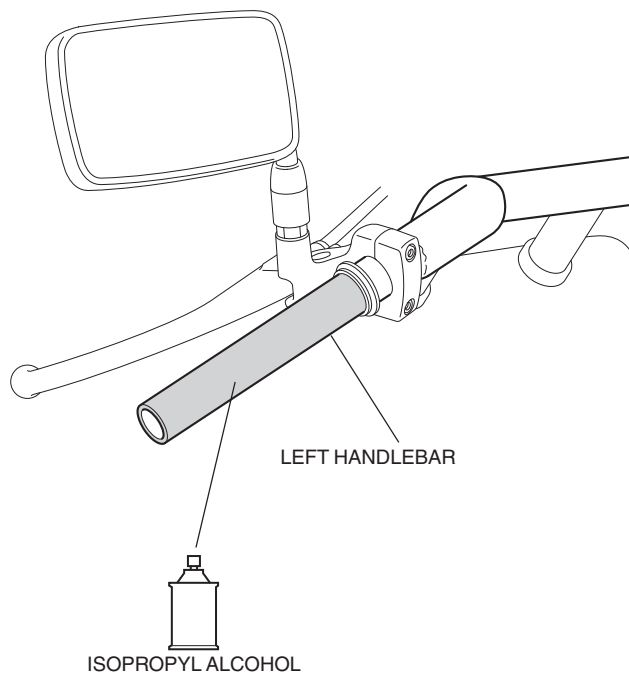

16. Install the left handle switch holder in the reverse order of removal.
17. Apply an ample amount of Pro Honda Handgrip Cement to the inside of the left custom grip as shown.

NOTE

Read the instructions of the steps 17 through 20 carefully before operation and complete the procedures quickly before the adhesive cures.

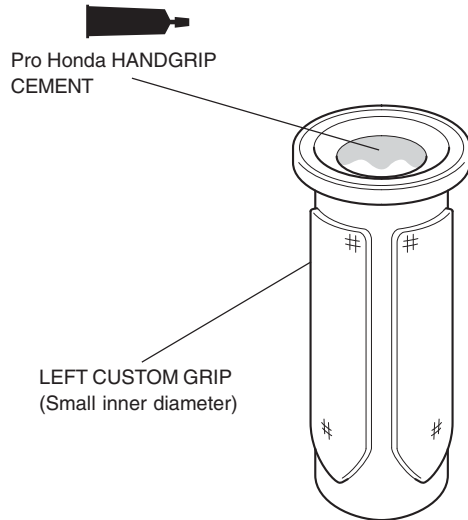

18. Apply Pro Honda Handgrip Cement to the left handlebar as shown.

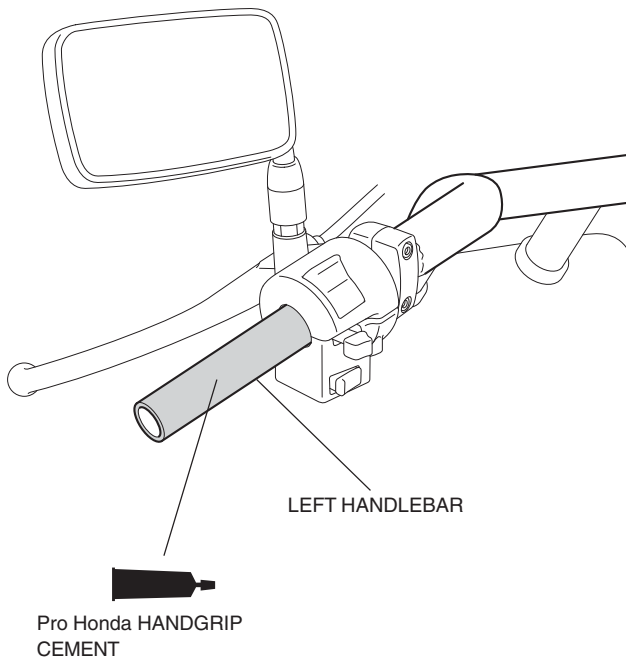

19. Spray isopropyl alcohol over the inside of the left custom grip and over the outer surface of the left handlebar.

• **This is done to ease installation.**

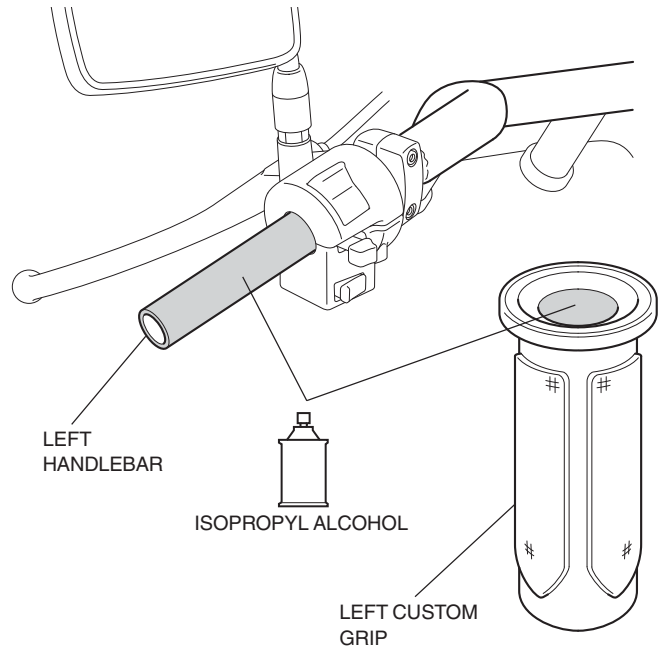

20. Install the left custom grip as shown.

• **Wipe off any excess adhesive.**

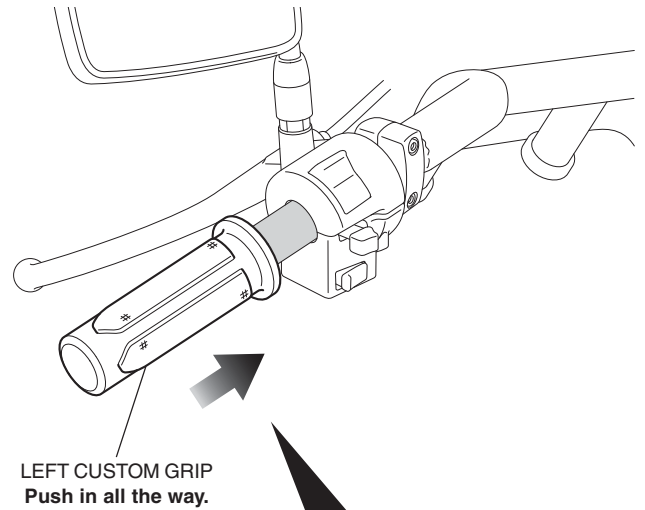

Match the rubber positions of left and right grips.

