



HONDA

INSTALLATION INSTRUCTIONS

Accessory
FRAME SKID PLATE, REAR
 P/N 08P72-HR6-A60

Application
TRX420FA5/FA6
TRX500FM5/FM6/FM7
TRX500FA5/FA6/FA7

Publication No.
MII 15016
 Issue Date
September 2014

PARTS LIST

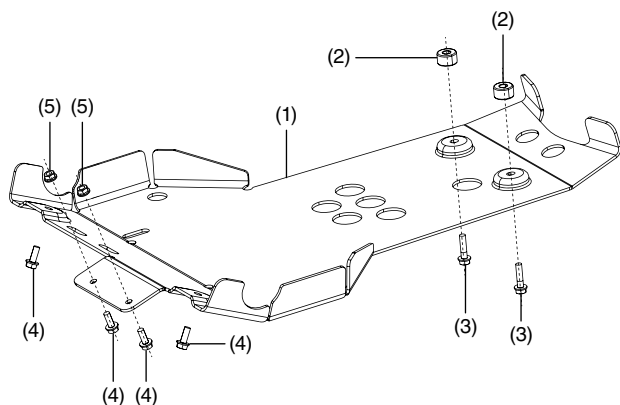

No.	Description	Qty
(1)	Frame skid plate, rear	1
(2)	Collar	2
(3)	Bolt, flange 6 x 25 mm	2
(4)	Bolt, flange 6 x 16 mm	4
(5)	Nut, flange 6 mm	4

Front Frame Skid Plate (Sold separately)

P/N 08P74-HR6-A60

The Front Frame Skid Plate is required for the installation of this accessory

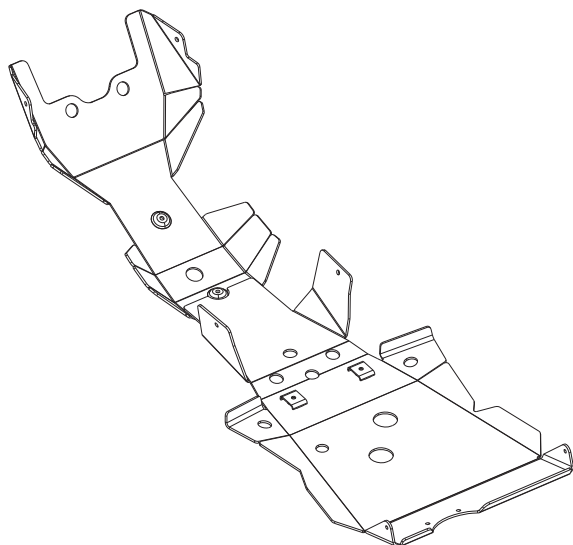

TOOLS AND SUPPLIES REQUIRED

10 mm wrench
 10 mm socket
 Ratchet
 Torque wrench

TORQUE CHART

Tighten all screws, bolts, and nuts to their specified torque values. Refer to the Service Manual for the torque values of the removed parts.

Item	N·m	kgf·m	lbf·ft
6 mm flange bolt and nut	11	1.1	8

USE AND CARE INFORMATION

- Check the accessory mounts frequently and retighten if necessary.

INSTALLATION

1. Refer to the Service Manual for the vehicle and remove the Skid Plate.
2. Assemble the collars on the rear skid plate as shown.

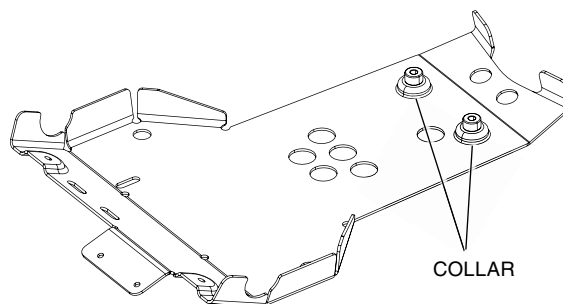

3. Place the rear skid plate with collars onto the frame as shown.

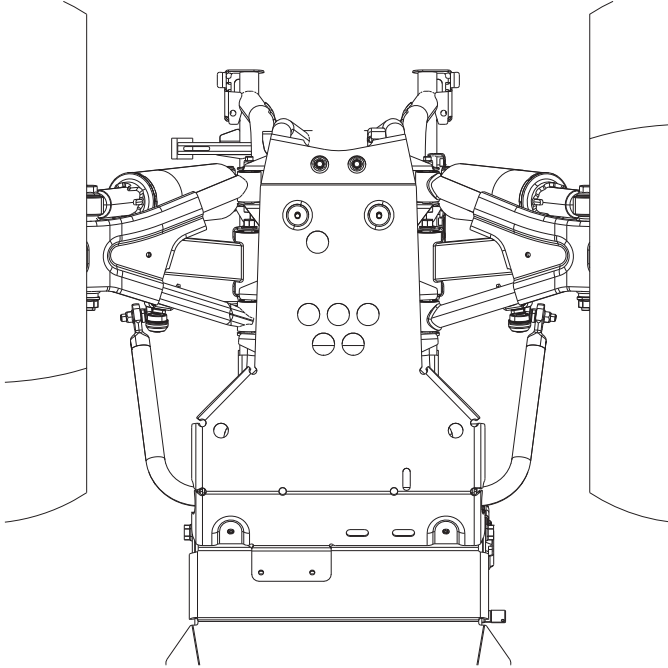

4. Install two 6 x 25 mm flange bolts and two 6 x 16 mm flange bolts in locations shown.

Tighten the hardware to the specification in the Torque Chart.

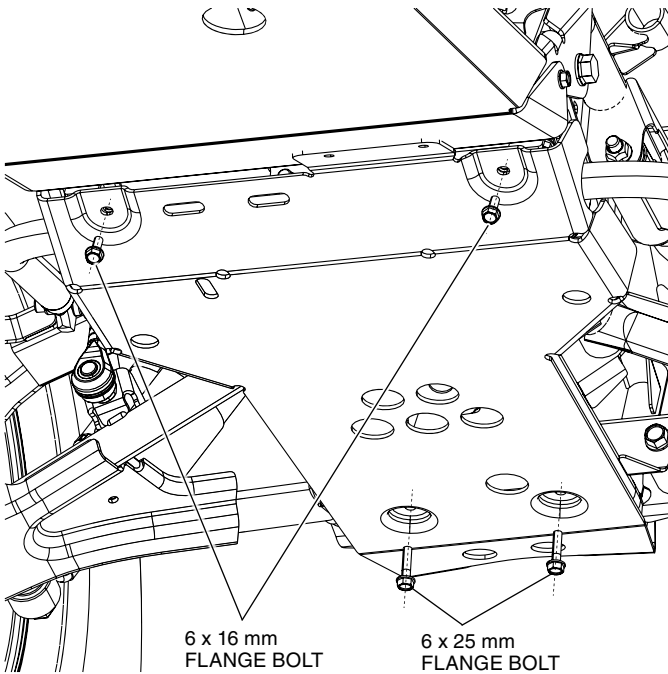

5. Install two 6 x 16 mm flange bolts and two 6 mm flange nuts in location shown.

Tighten the hardware to the specification in the Torque Chart.

