

PARTS LIST

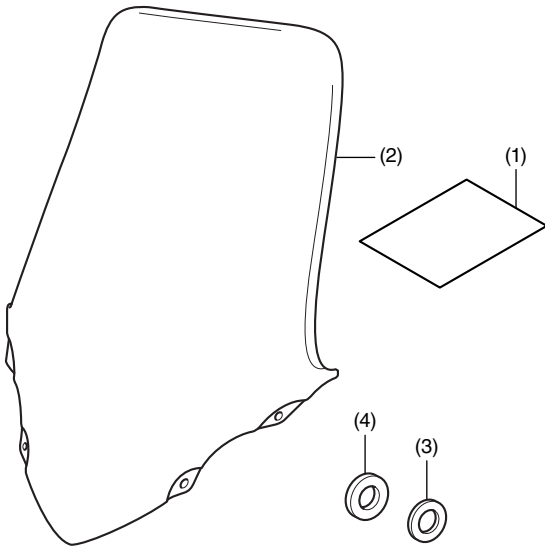

No.	Description	Qty
(1)	Installation Instruction URL	1
(2)	Windscreen	1
(3)	Washer (thin)	4
(4)	Washer (thick)	4

INSTALLATION

1. Remove the screen garnish as shown.

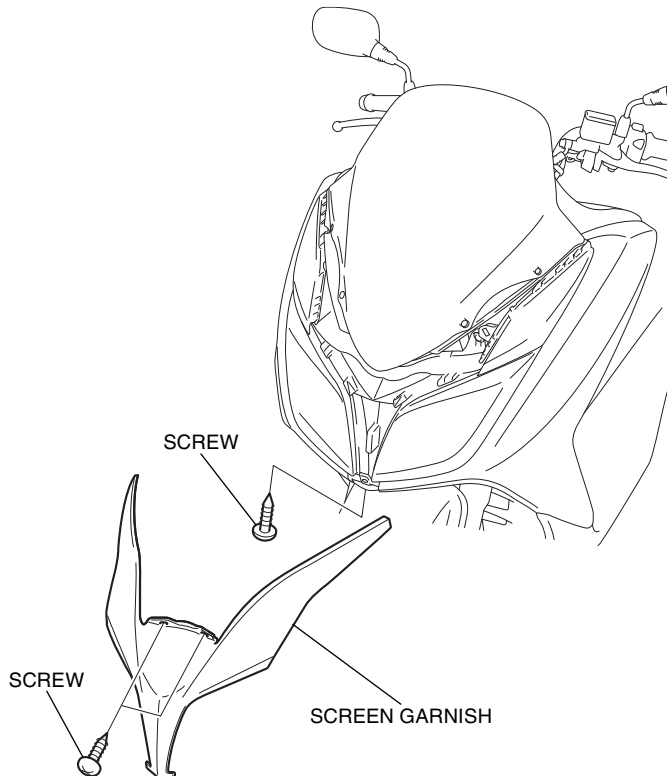

2. Remove the meter visor as shown.

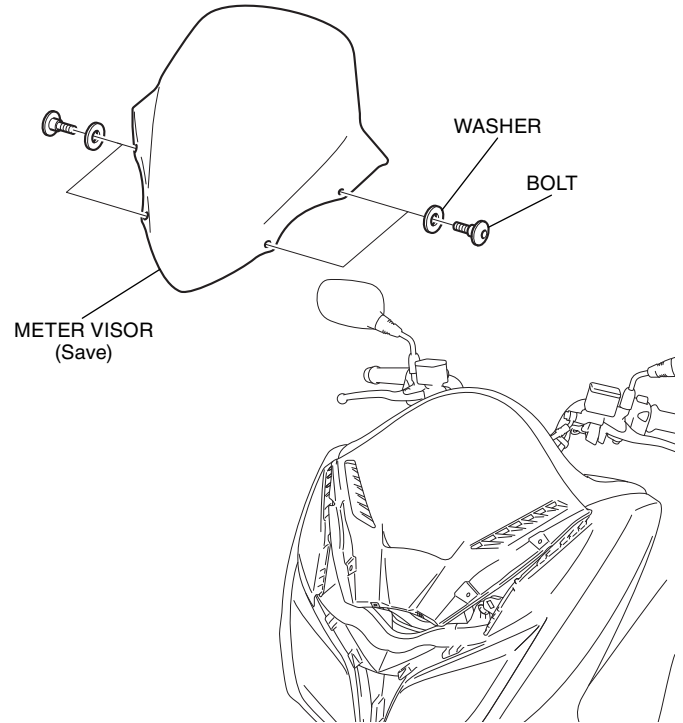

3. Install the windscreen as shown.

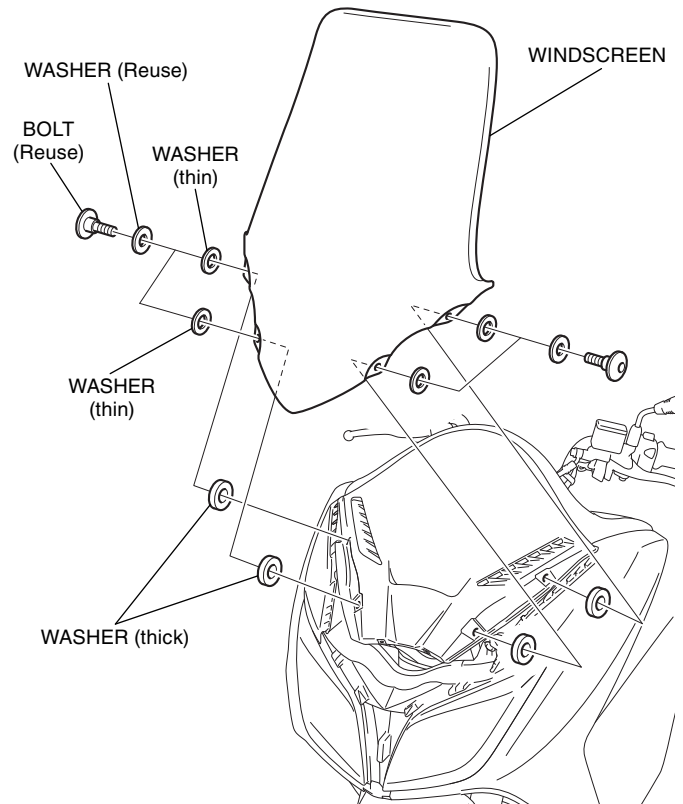

4. Reinstall the screen garnish in the reverse order of removal.