

Honda Dealer: Please give a copy of these instructions to your customer.

PARTS LIST

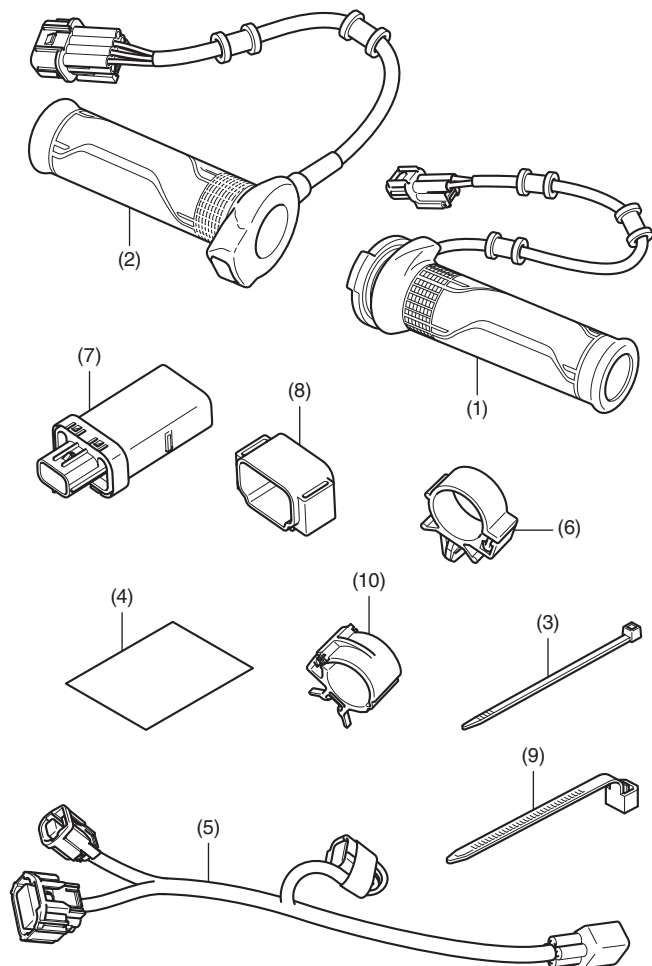

No.	Description	Qty
(1)	Right heated grip	1
(2)	Left heated grip	1
(3)	Wire tie (narrow)	1
(4)	Installation Instruction URL	1
(5)	Sub harness	1
(6)	Clip	1
(7)	Heater controller	1
(8)	Suspension	1
(9)	Wire tie (wide)	4
(10)	Cable clip	1

TOOL AND SUPPLIES REQUIRED

Flat-tip screwdriver
 Snips
 Ruler
 Pro Honda Handgrip Cement
 Thread lock
 Grease
 Isopropyl alcohol
 Shop towel

TORQUE CHART

Refer to the Service Manual for the torque values of the removed parts.

INSTALLATION

▲ CAUTION

- To prevent burns, allow the engine, exhaust system, radiator, etc., to cool before installing the accessory.
- Be sure to observe all safety messages and precautions described in the Service Manual while removing and installing the fuel tank.

NOTE:

- Remove the right grip as instructed in the motorcycle's Service Manual.
- For secure adhesion of the heated grips use the recommended adhesive agent (Pro Honda Handgrip Cement) or equivalent.
- Be sure to open and close the throttle to check for smooth operation after installation of the right heated grip.
- Disconnect the negative (-) cable from the battery before installing this accessory.
- The memory of the clock will be erased when you disconnect the battery. Reset the clock after reconnecting the battery.
- Reinstall the removed parts on the motorcycle and make sure that the wires and harnesses are not pinched.
- Trim the excess ends off the wire ties after attaching them to the wire harnesses. Do not allow the cut part of the wire tie to interfere with another harness or brake hose.
- After heated grip installation, check the lights (e.g. right / left turn signal lights and brake lights) for proper operation.

1. Remove the passenger seat and tool as shown.

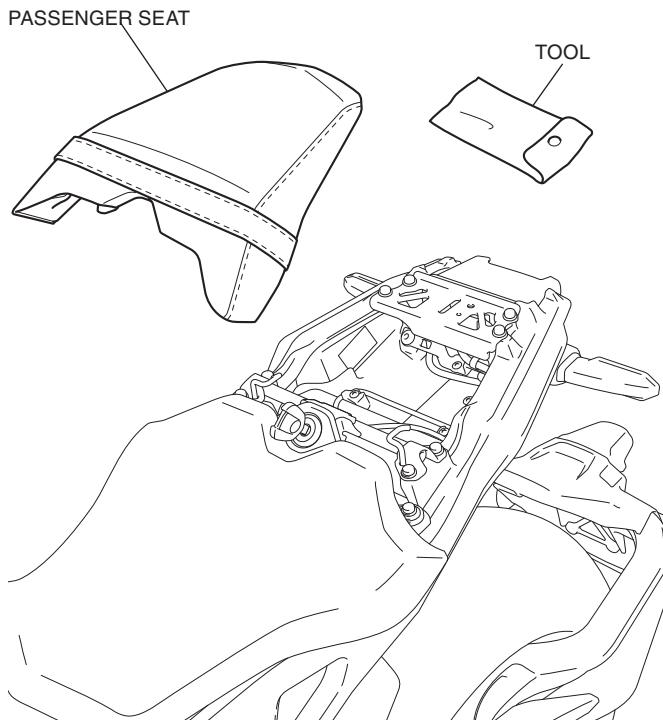

2. Remove the main seat and disconnect the negative (-) cable of the battery.

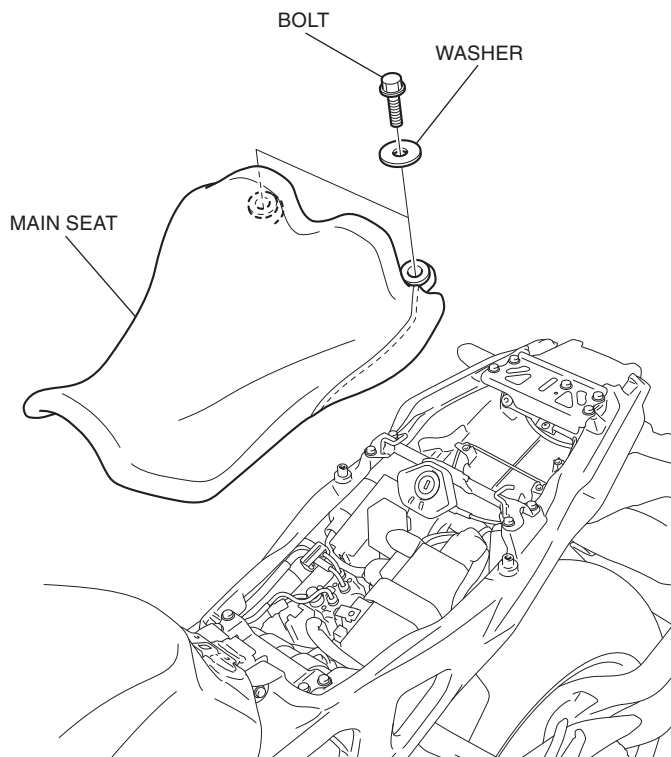

3. Remove the meter visor as shown.

- Perform this step for the motorcycle equipped with the meter visor.

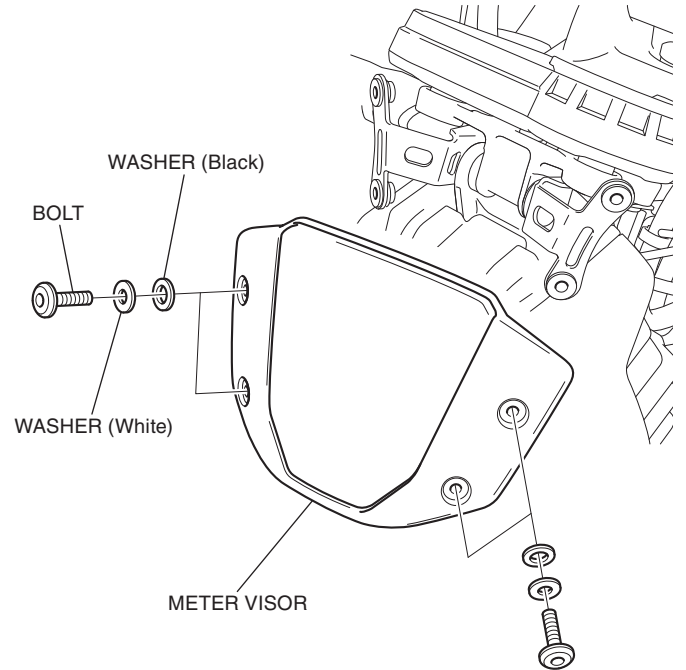

4. Remove the bolt as shown.

- Repeat on the right side.

<Left side>

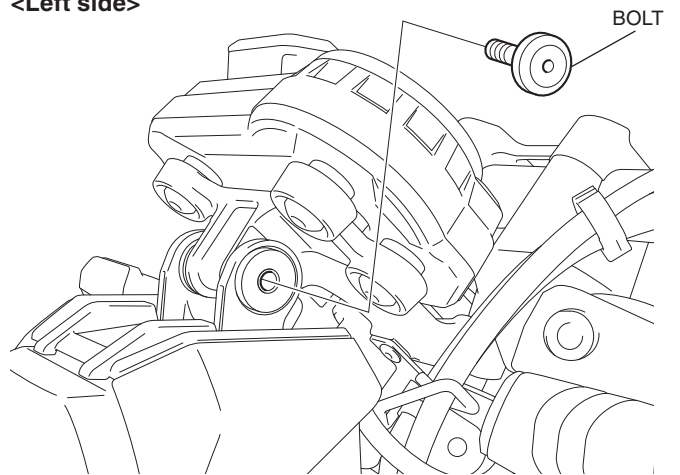

When installing the Meter visor

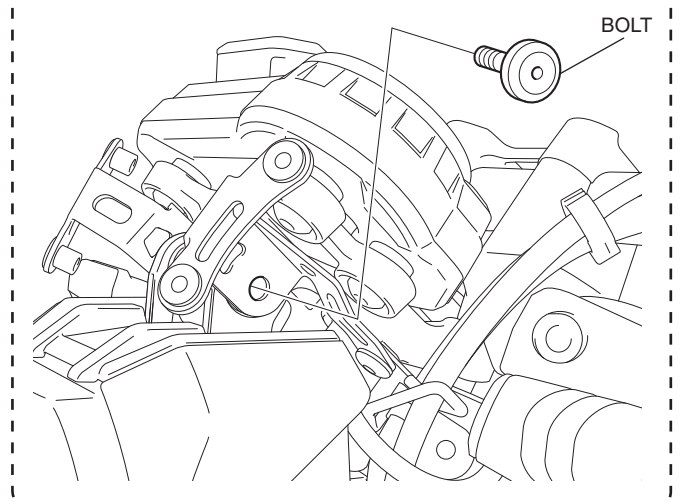

5. Remove the headlight as shown.

HEADLIGHT
Disconnect the connector.

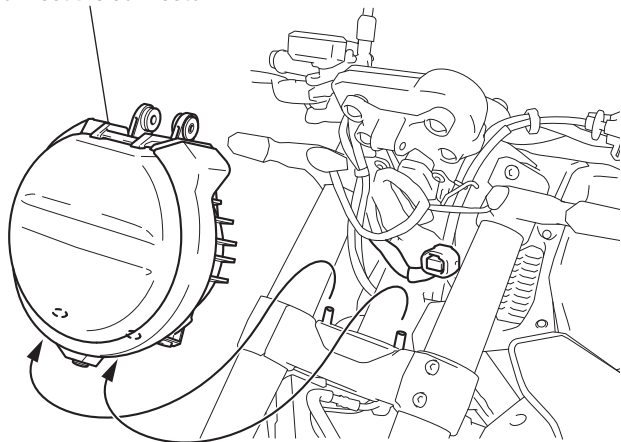

6. Remove the collars as shown.

- Perform this step for the motorcycle equipped with the meter visor.

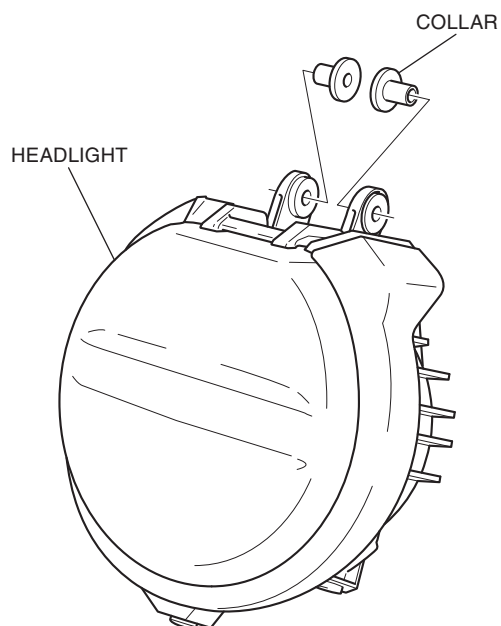

7. Disconnect the positive (+) cable of battery and remove the battery as shown.

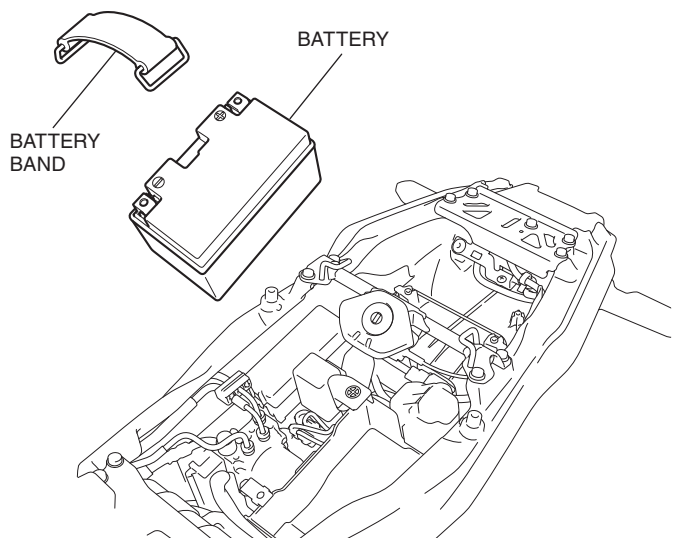

8. Remove the bolts as shown.

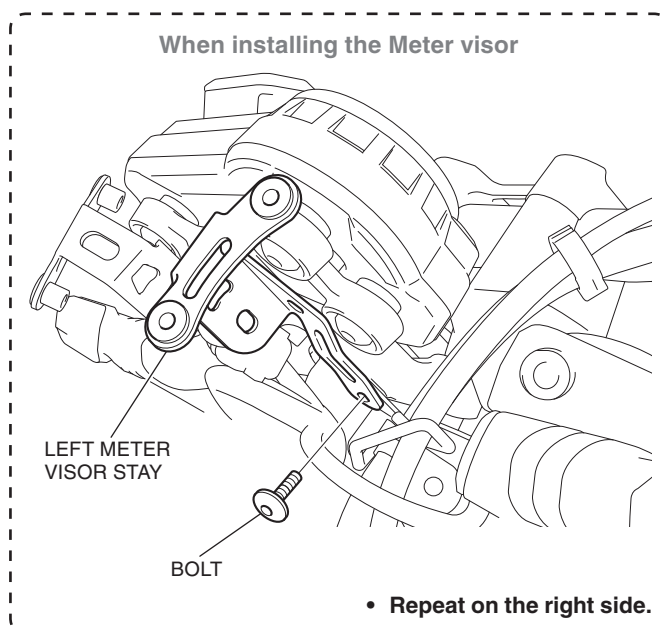
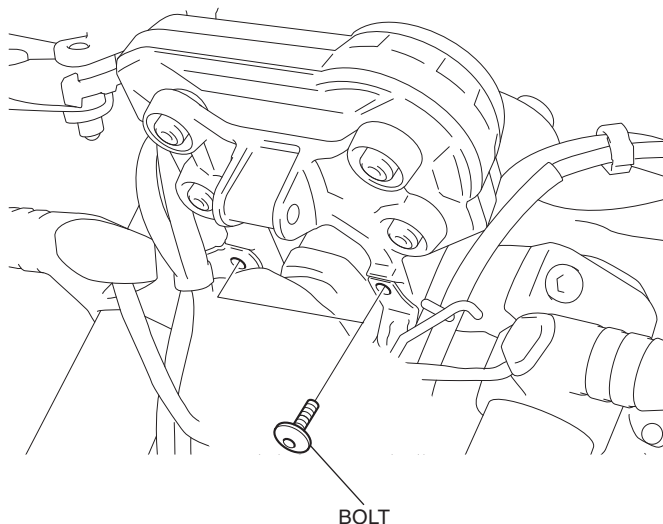

9. Remove the parts as shown.

- Repeat on the right side.

<Left side>

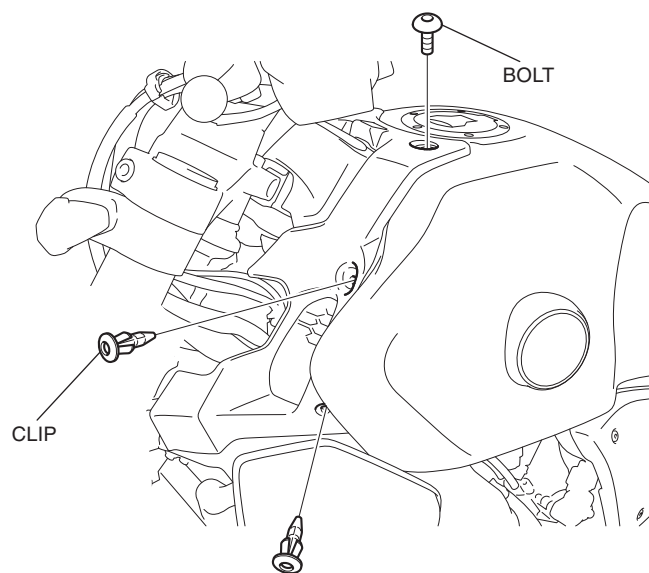

10. Remove the tank front cover as shown.

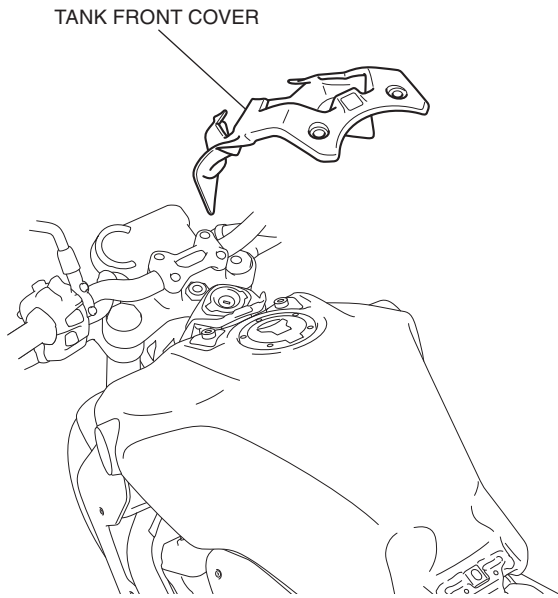

11. Remove the bolt as shown.
 • Repeat on the right side.

<Left side>

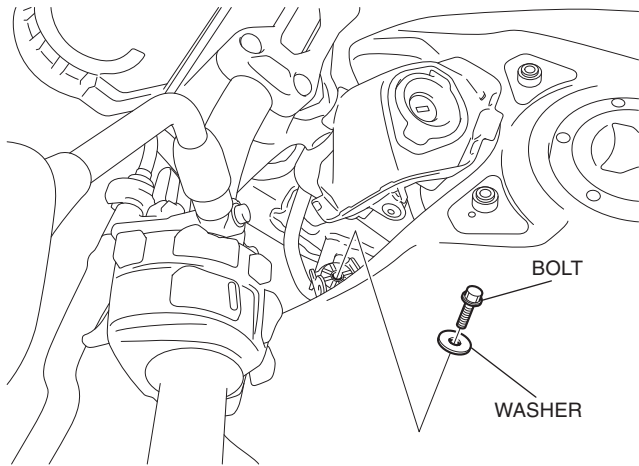

12. Remove the indicated parts by raising the front part of the fuel tank.

<Left side>

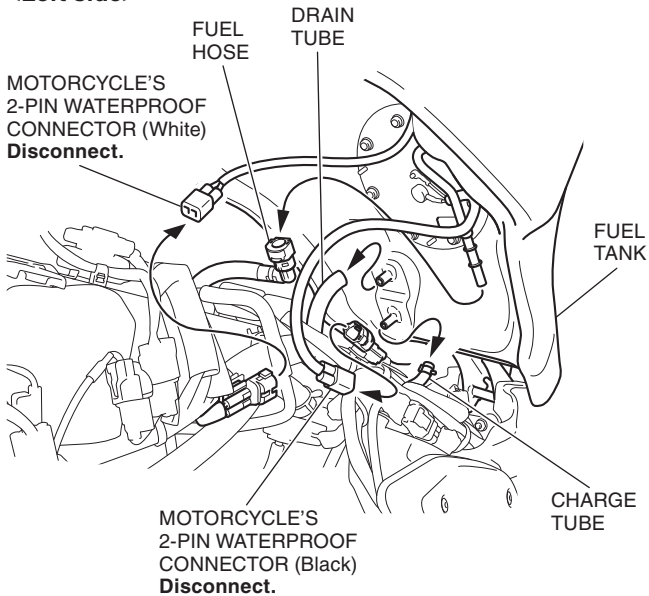

13. Remove the bolt as shown.

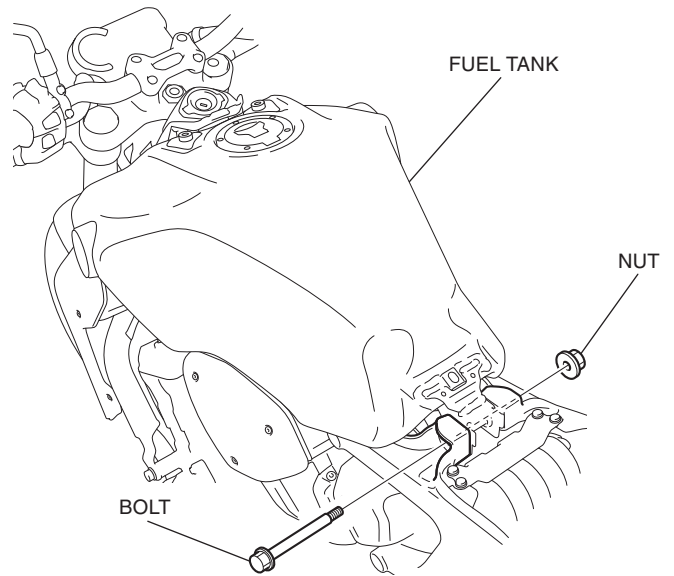

14. Remove the fuel tank as shown.

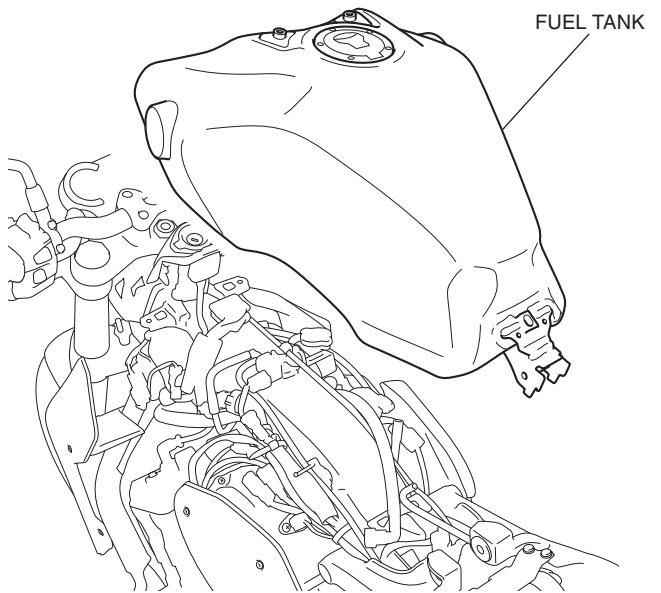

15. Remove the handle bar weight as shown.

- Repeat on the right side.

<Left side>

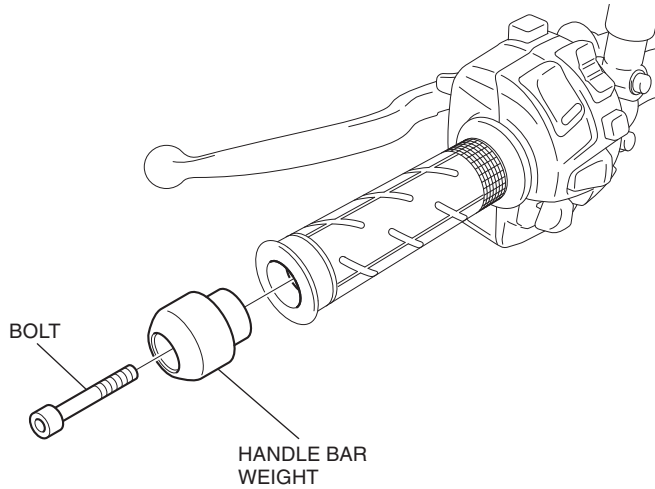

16. Remove the left grip as shown.

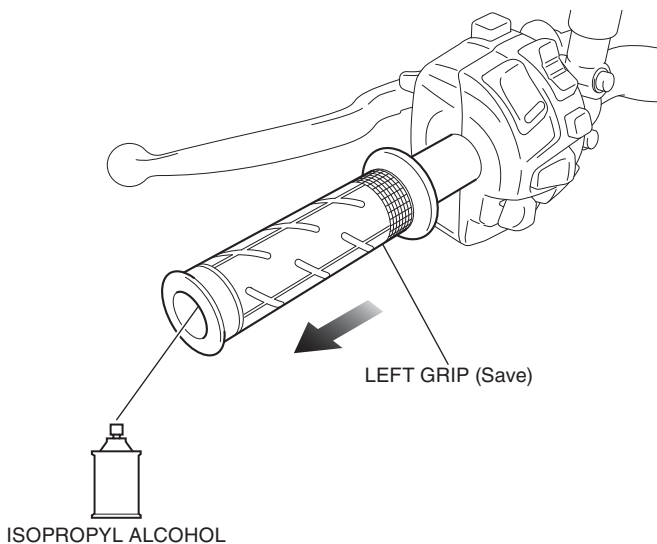

17. Using isopropyl alcohol, remove all traces of adhesive from the left handlebar.

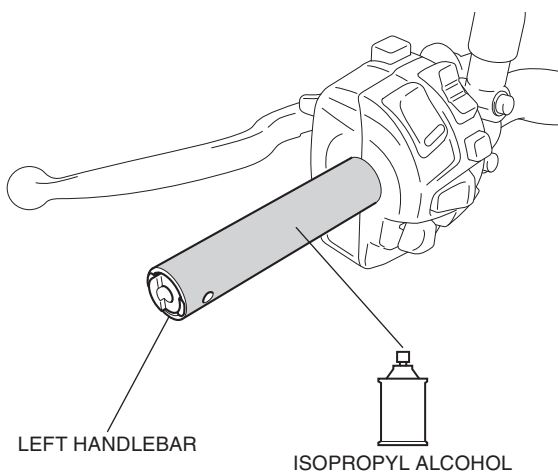

18. Liberally apply Pro Honda Handgrip Cement to the inside of the left heated grip from the kit as shown.

NOTE

Read the Instructions of the steps 18 through 21 carefully before operation and complete the installation quickly before the adhesive agent cures. Use an assistant to steady the motorcycle while installing the grips.

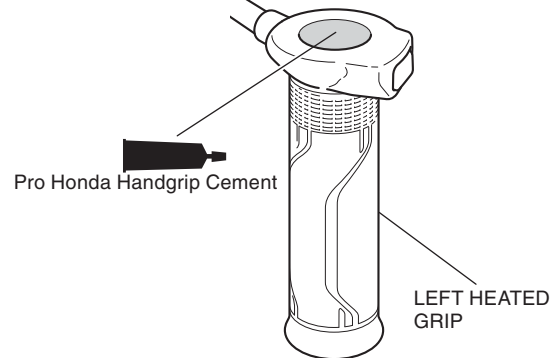

19. Apply Pro Honda Handgrip Cement to the left handlebar as shown.

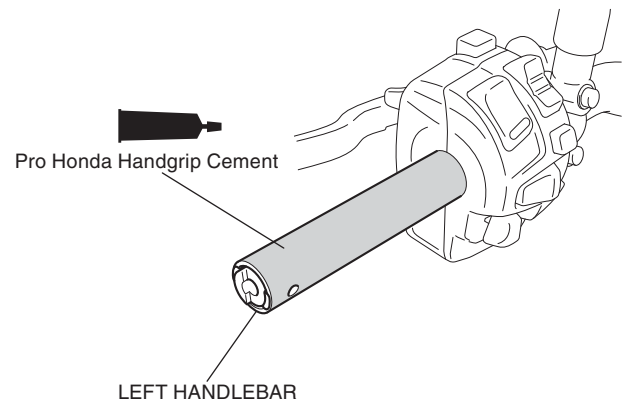

20. Spray isopropyl alcohol over the inside of the heated grip and outside of the left handlebar.

- This is done to ease alignment between the heated grip and the handlebar.

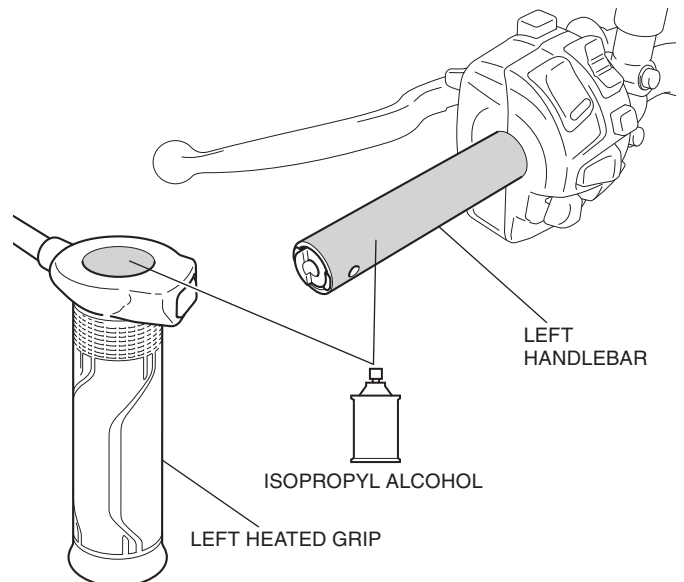

21. Slide the left heated grip onto the left handlebar as indicated.

- Use an assistant to steady the motorcycle while installing the grips.
- Wipe off excess adhesive at once.

NOTICE

- Do not tap on the grip end with a hammer and do not twist the grip to install the heated grip onto the handlebar, as it can damage the element.

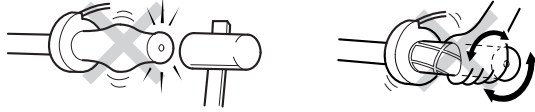

- Avoid putting pressure on the switch part when inserting the left heated grip. There is a possibility that the switch part will break. Also, install so that there is no gap with the switch holder.



- If the grip gets stuck halfway during installation, apply isopropyl alcohol to the gap between the heated grip. Do not try to remove the heated grip using force or a screwdriver, etc. Damage to the heated grip wire can result.

Insert until there is contact with the switch holder, then align the indicated position.

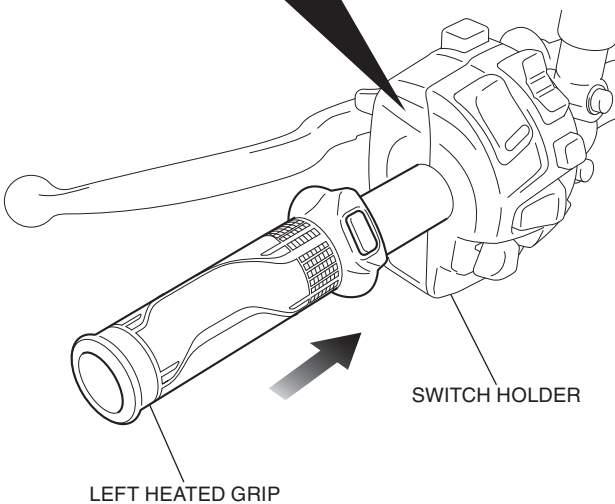
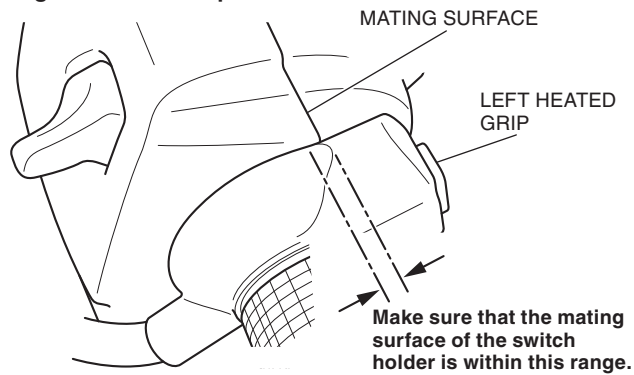

22. Route the left heated grip harness as shown.

<Left side>

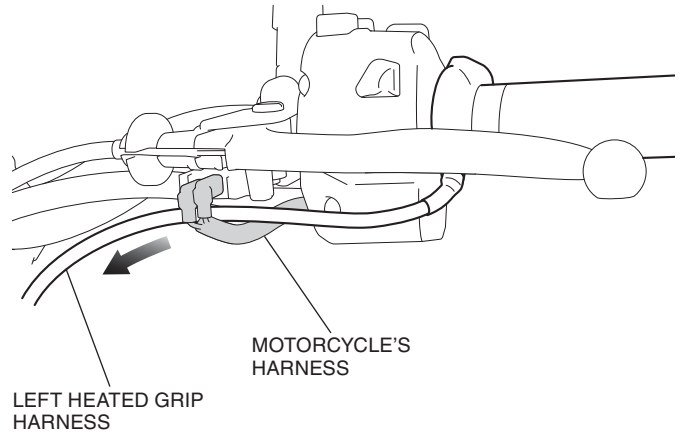

23. Route the left heated grip harness as shown.

<Left side>

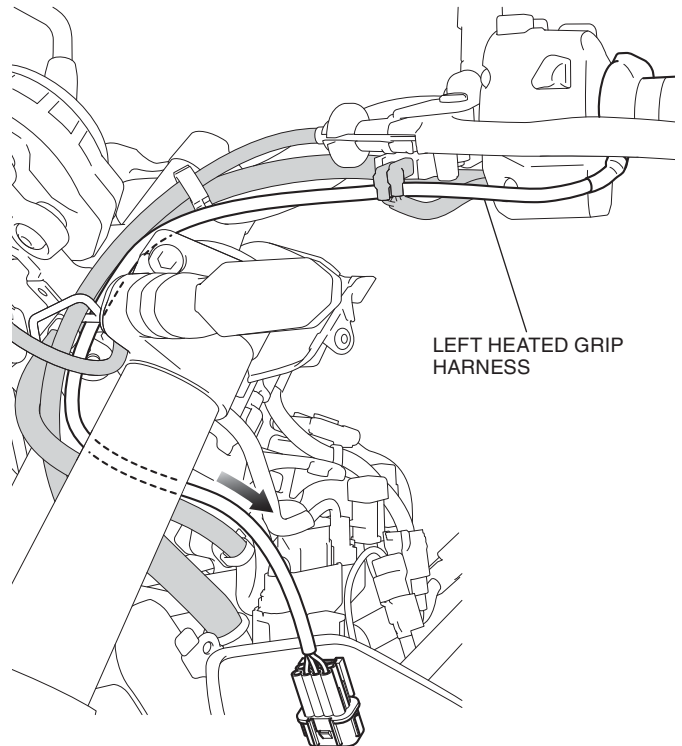

24. Loosen the bolts and move the brake master cylinder as shown.

<Right side>

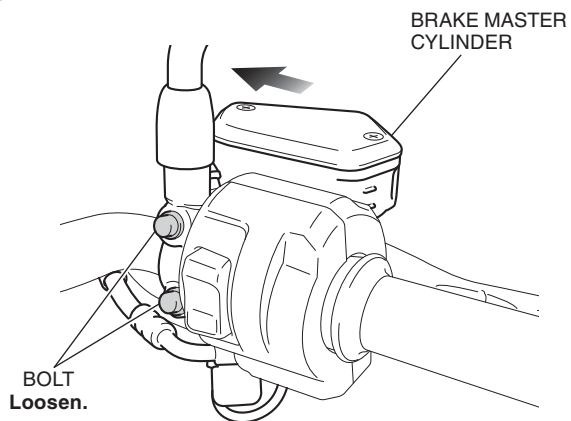

25. Remove the front case as shown.

<Right side>

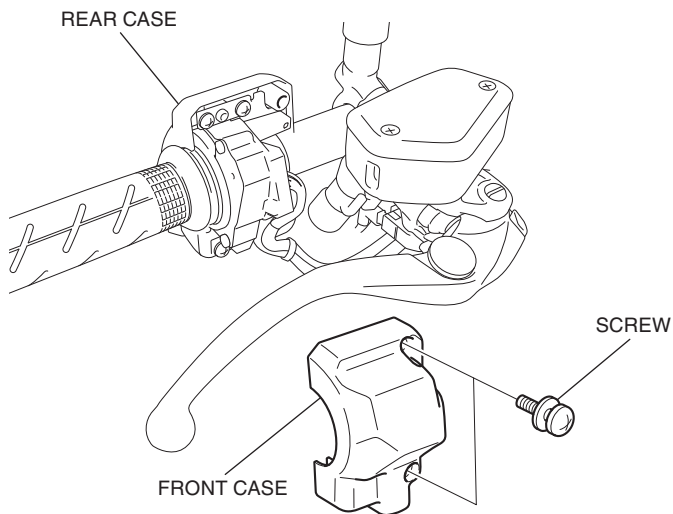

26. Remove the screws as shown.

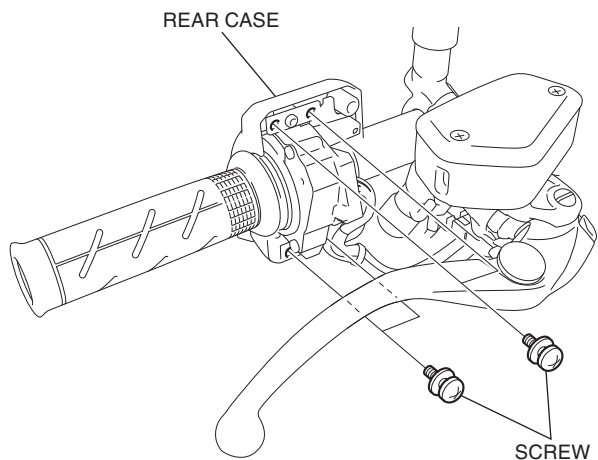

27. Remove the right grip as shown.

NOTE

Remove the right grip as instructed in the motorcycle's Service Manual.

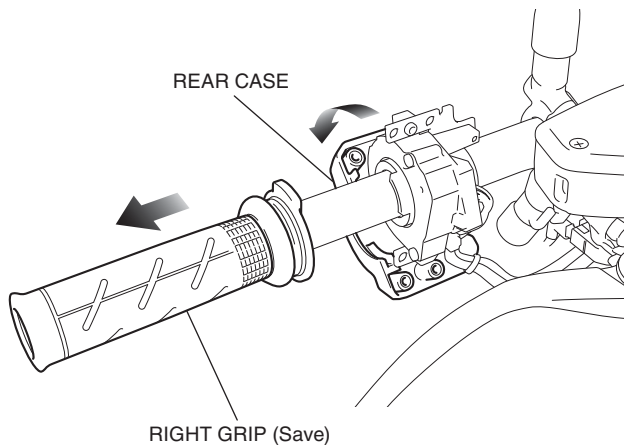

28. Apply grease to the hatched part as shown.

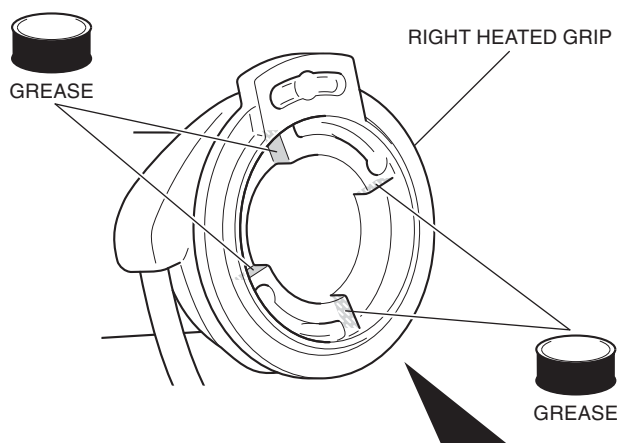

Be careful not to adhere grease to the outside of dimensions shown.

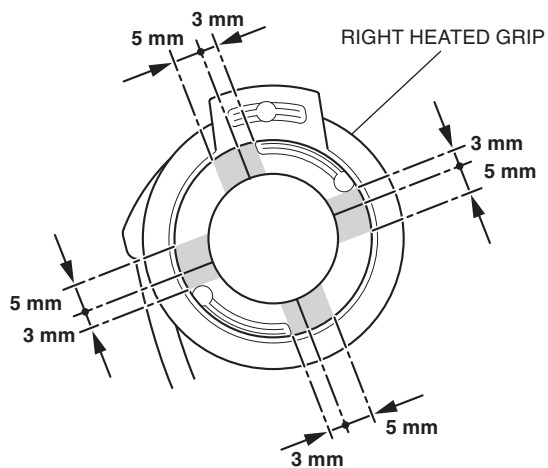

29. Apply grease to the hatched part as shown.

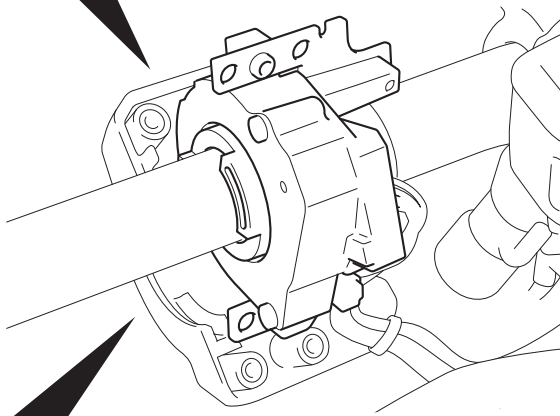
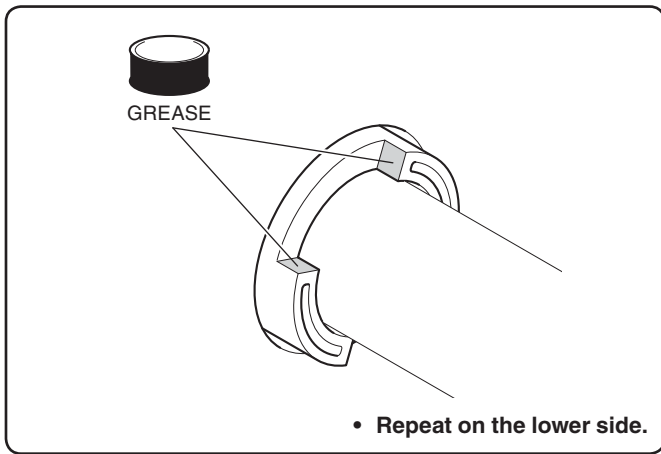

Be careful not to adhere grease to the outside of dimensions shown.

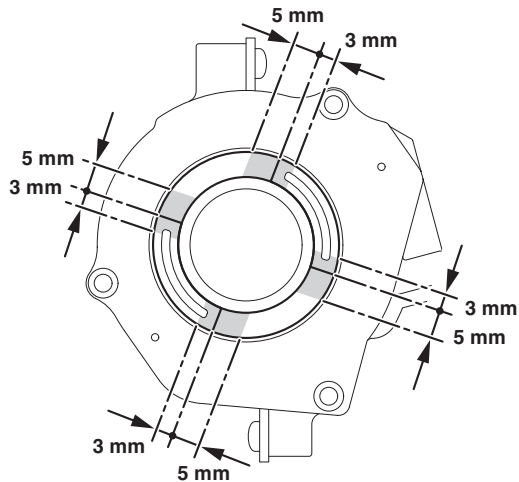

30. Install the right heated grip as shown.

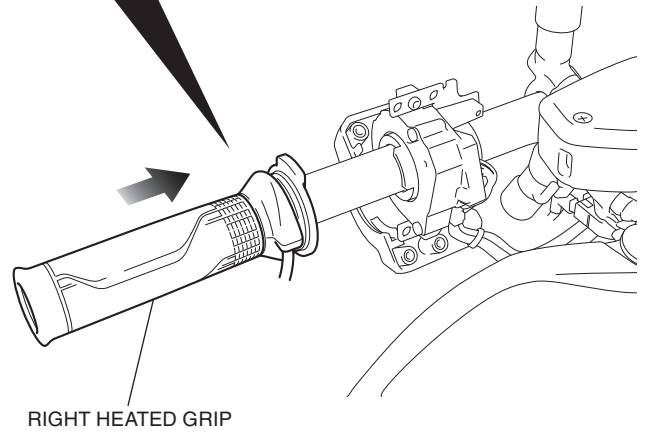
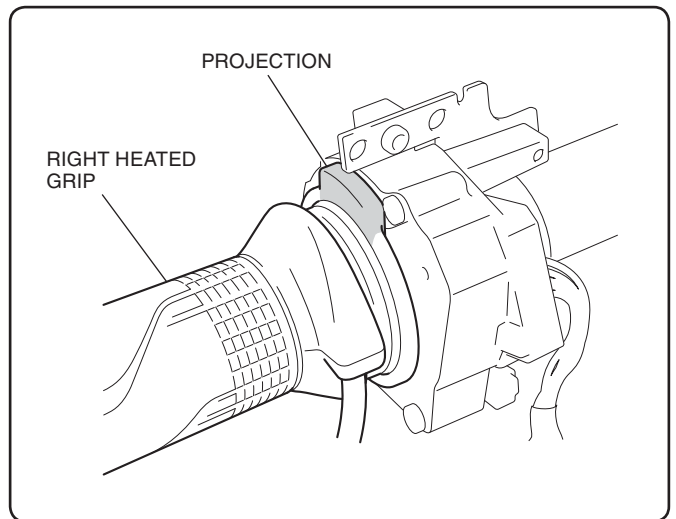

31. Install the front and rear case in the reverse order of removal.

32. Tighten the bolts as shown.

- **Tighten the upper bolt first, then tighten the lower bolt.**

Align the brake master cylinder matching surface with the punch mark.

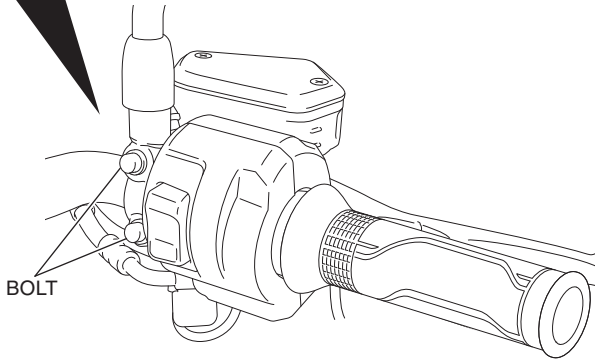
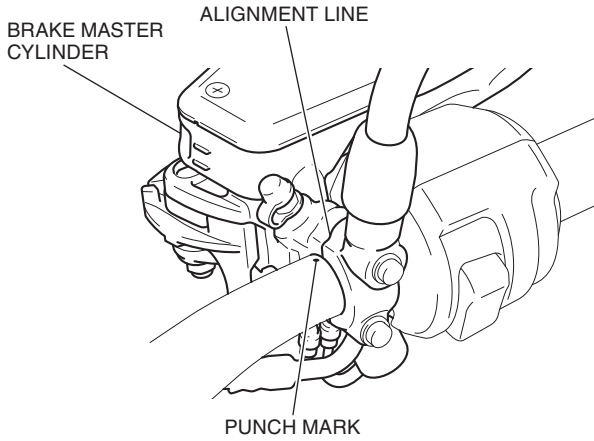

33. Twist the throttle grip as shown.

- **Check for smooth opening of the throttle and that it automatically snaps closed from any opening, in all steering positions.**

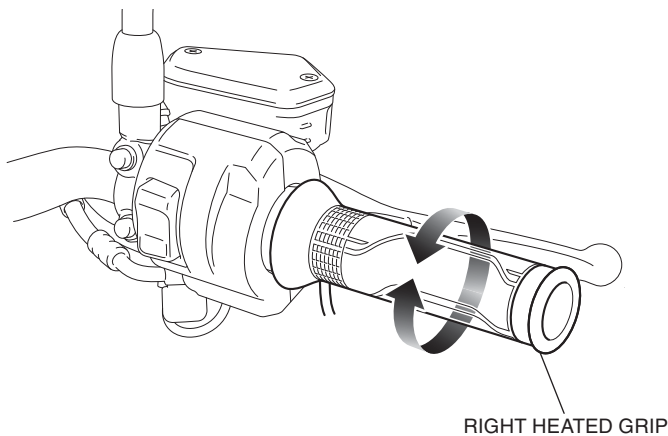

34. Secure the right heated grip harness with the wire tie as shown.

- **Open and close the throttle and confirm that there is no tightness of the heated grip harness.**

<Right side>

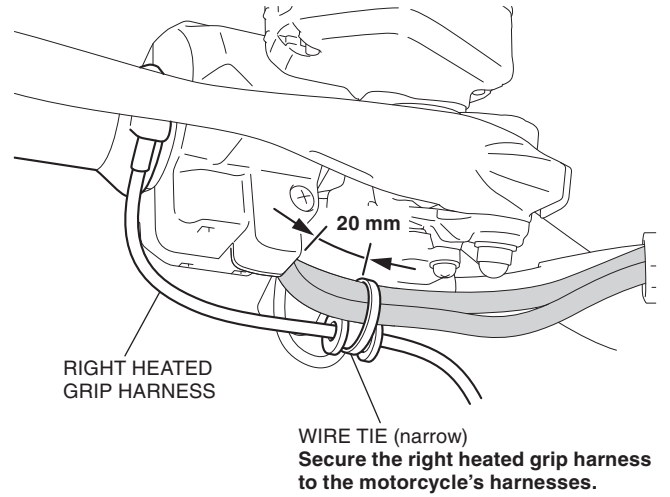

35. Route the right heated grip harness as shown.

<Right side>

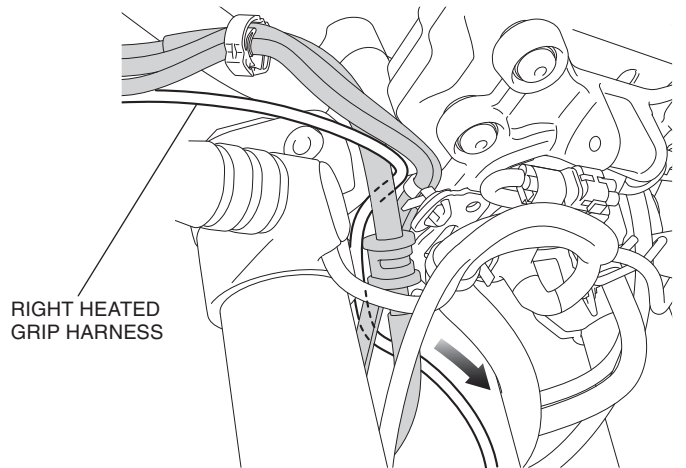

36. Route the right heated grip harness as shown.

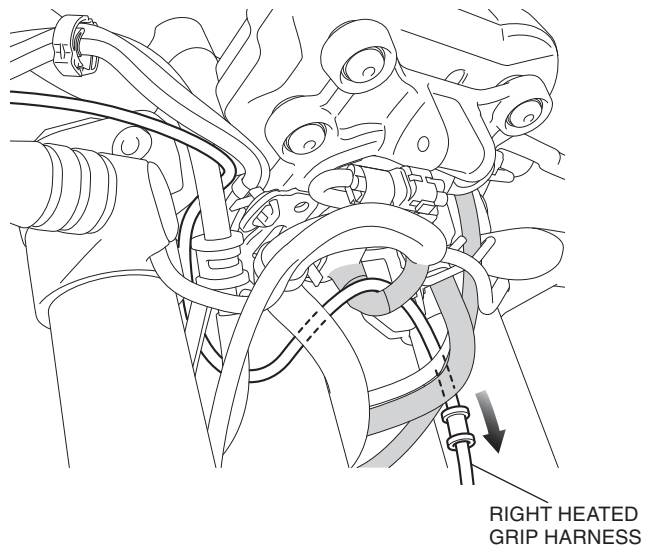

37. Install the clip as shown.

<Left side>

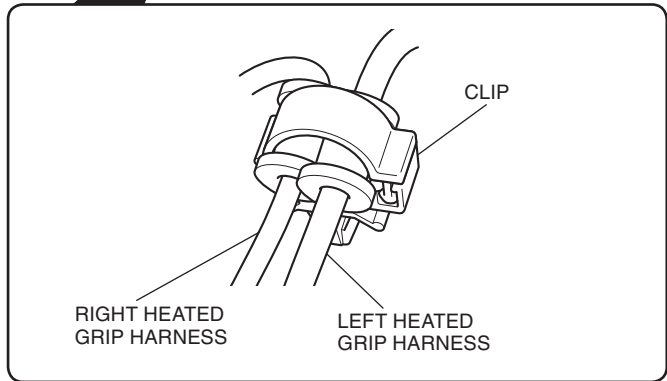
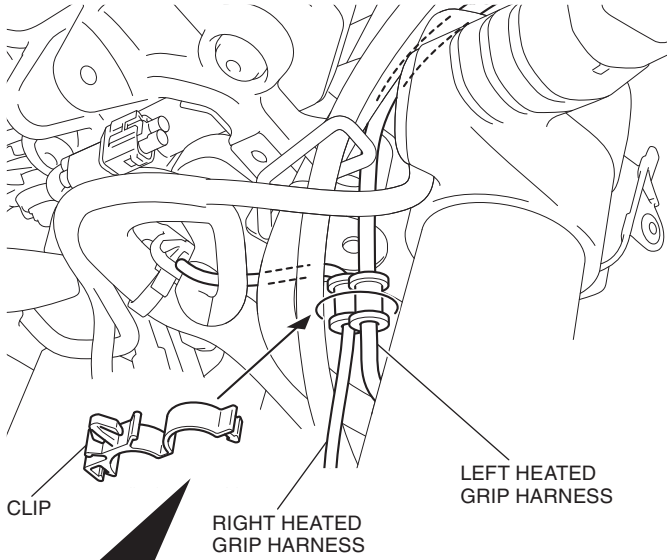

38. Secure the clip as shown.

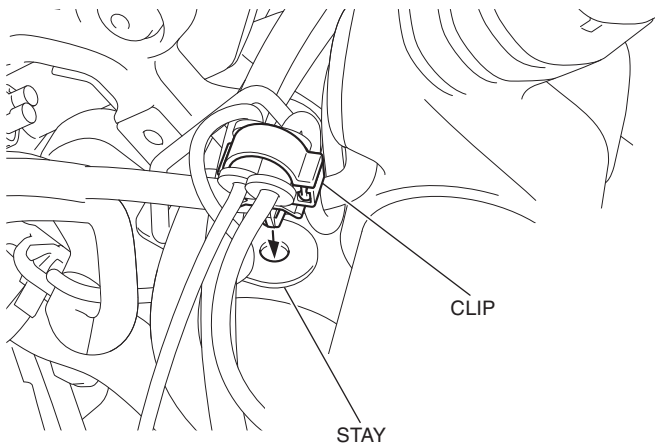

39. Route the right heated grip harness as shown.

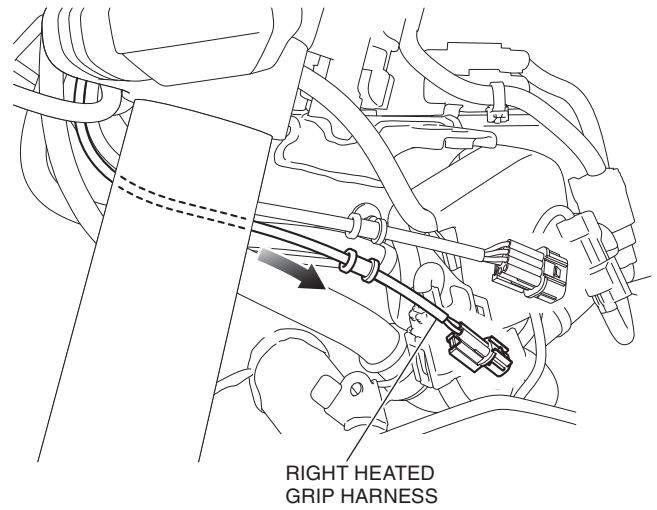

40. Install the cable clip as shown.

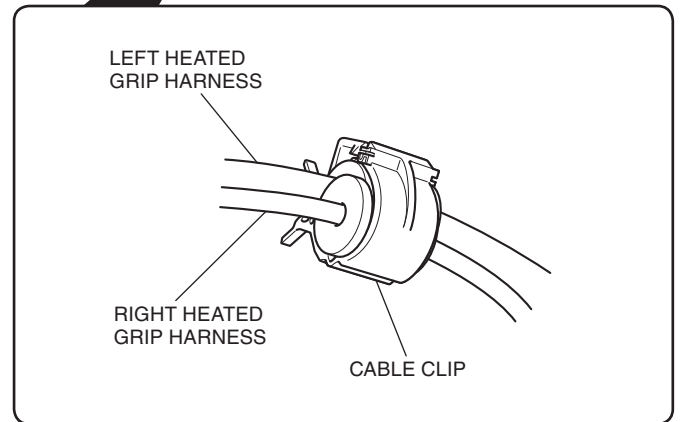
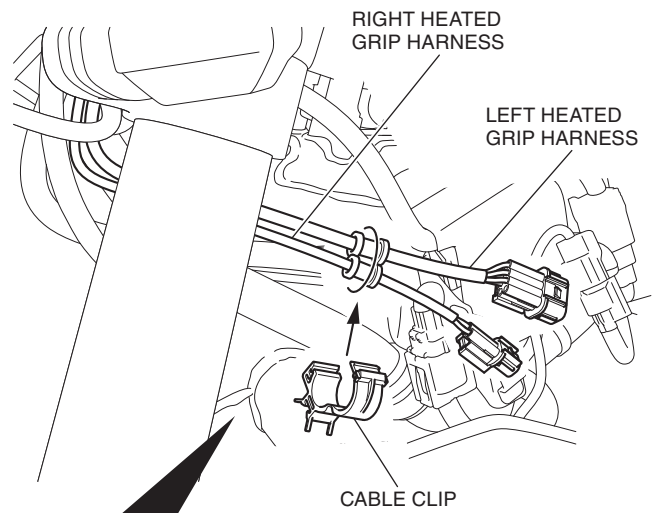

41. Secure the cable clip as shown.

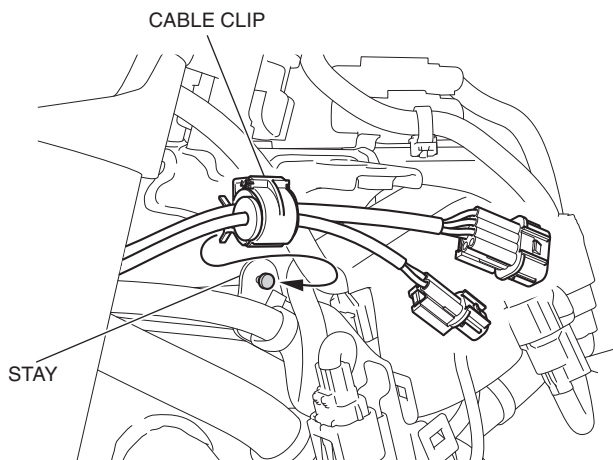

42. Route the sub harness as shown.

<Left side>

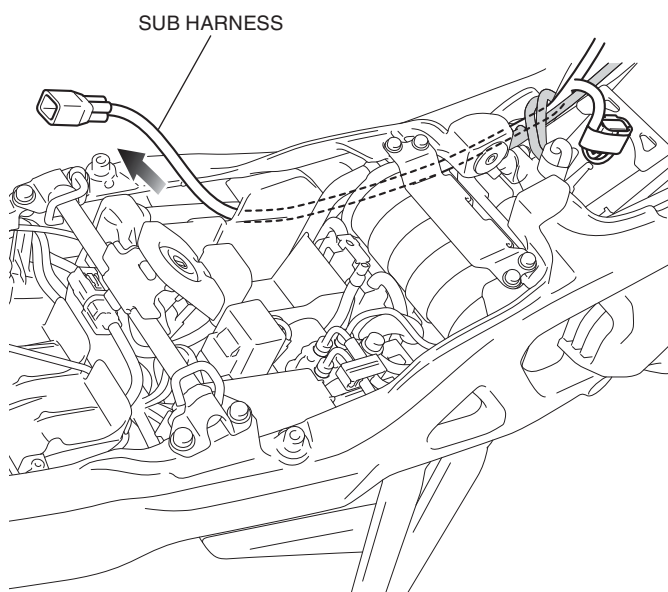

43. Route the sub harness as shown.

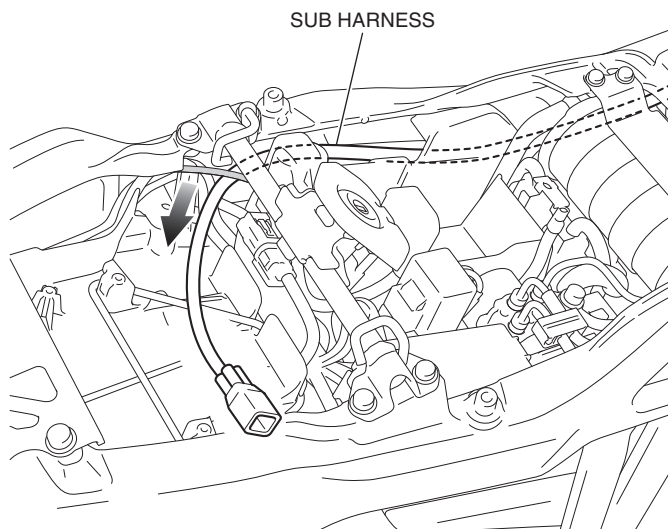

44. Pull out the harness boot as shown.

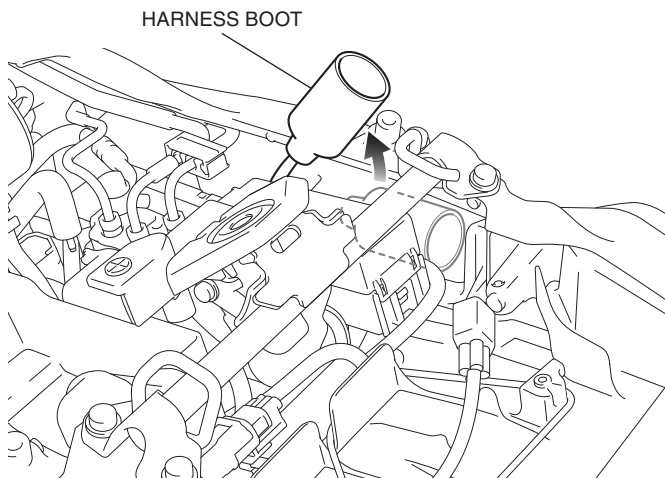

45. Remove the dummy connector as shown.

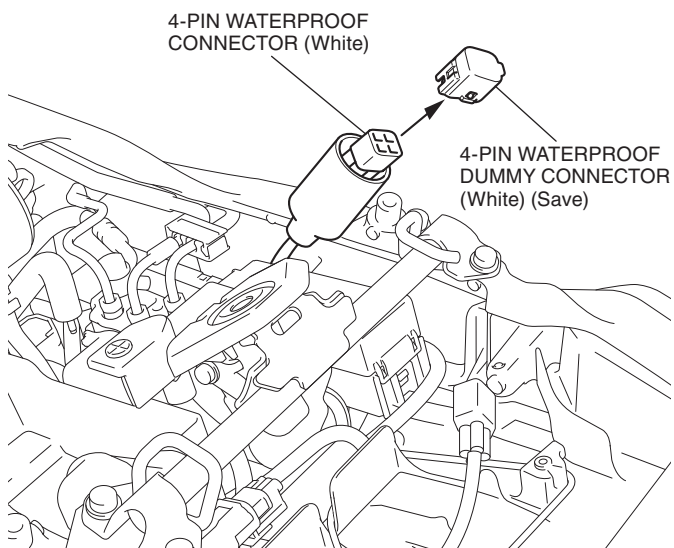

46. Route and connect the sub harness as shown.

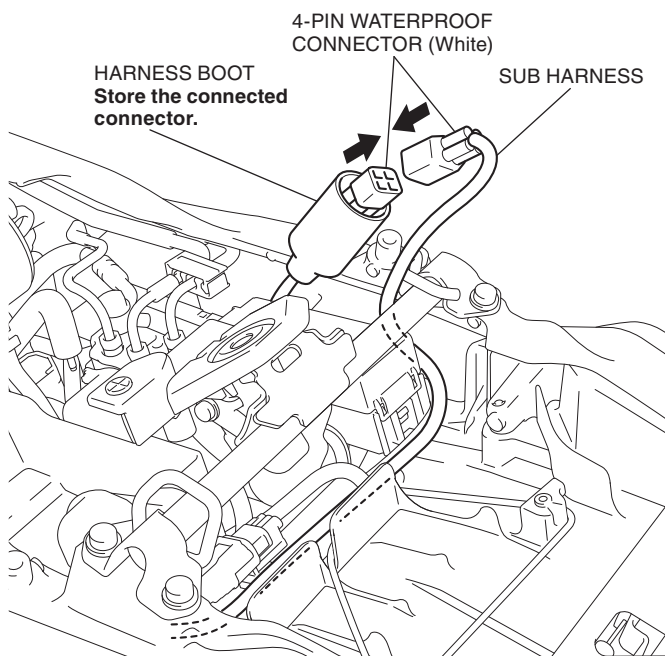

47. Return the harness boot to the original position.

48. Route the sub harness as shown.

<Left side>

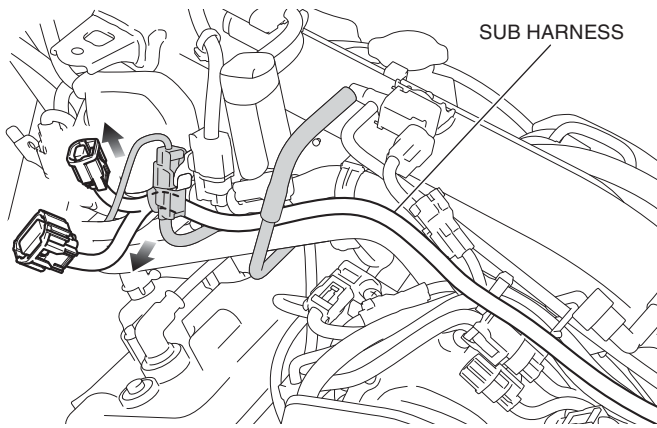

49. Connect the sub harness as shown.

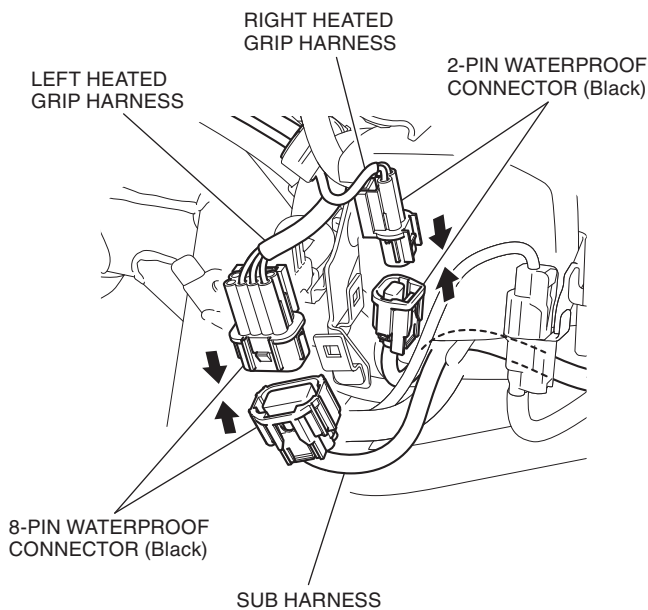

50. Secure the right and left heated grip harness to the stay.

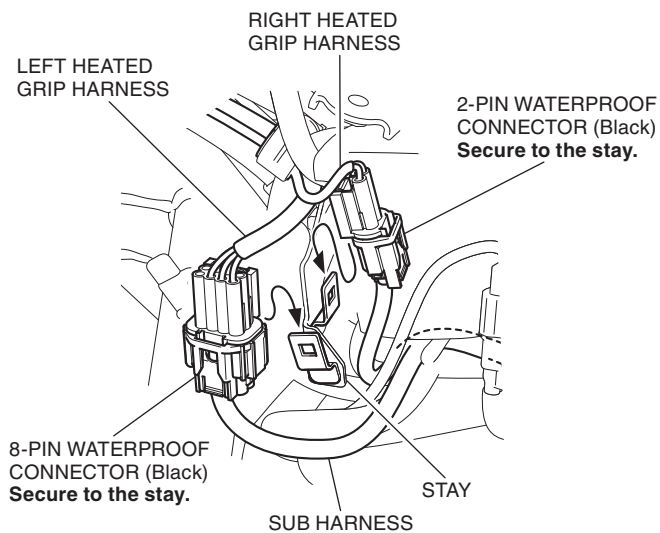

51. Secure the sub harness with the wire ties as shown.

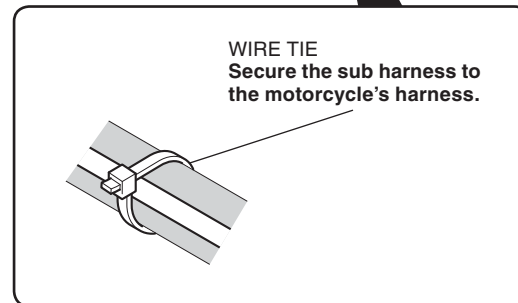
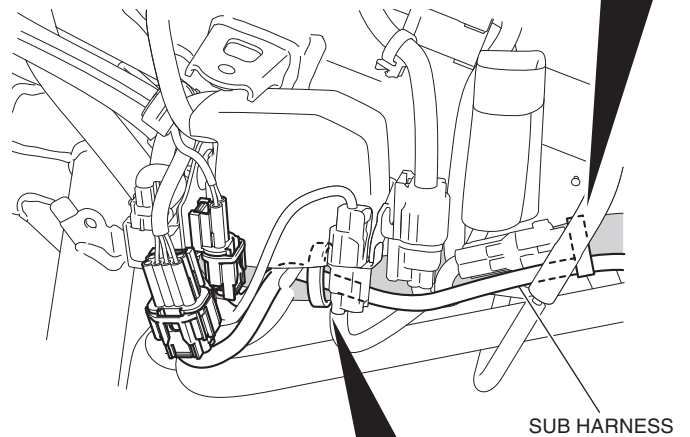
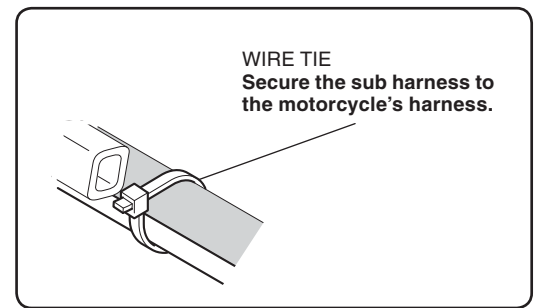

52. Secure the sub harness with the wire ties as shown.

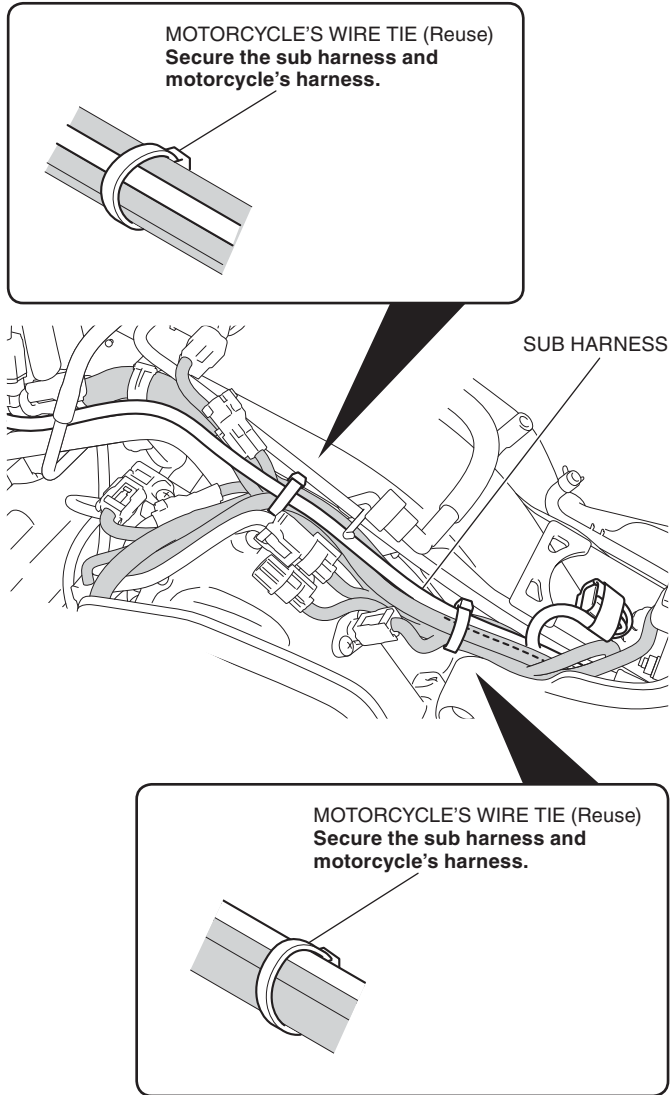

53. Secure the sub harness with the wire ties as shown.

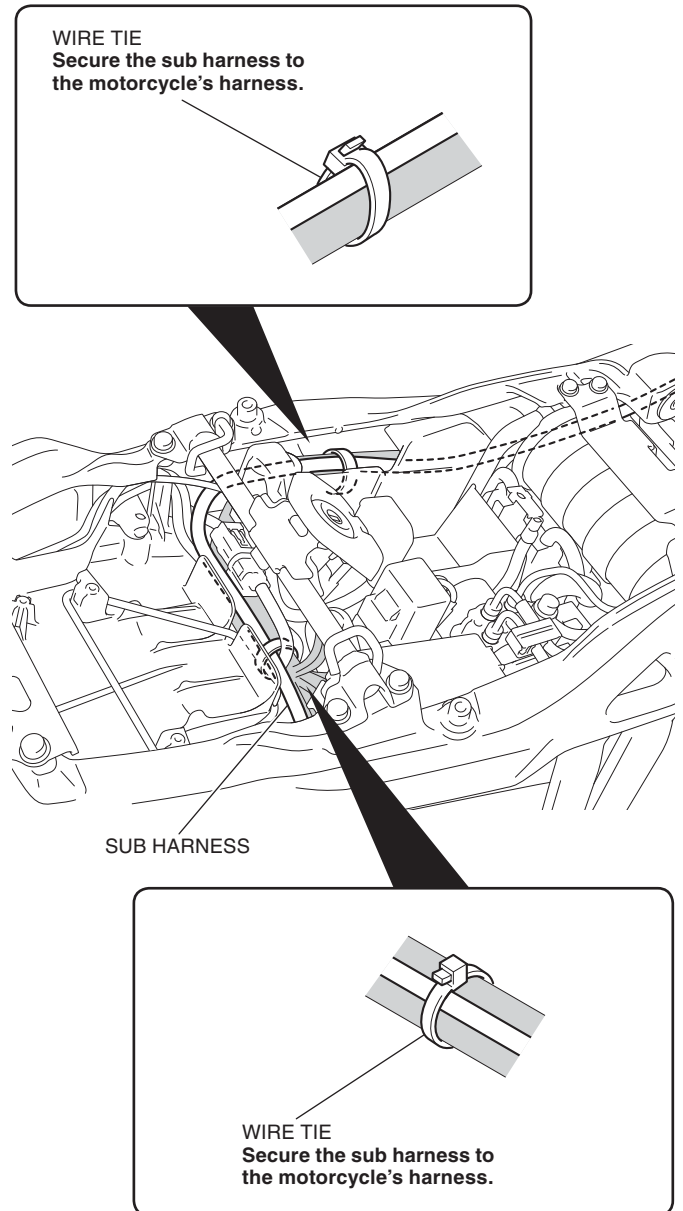

54. Loosely install the left meter visor stay as shown.
- Perform this step for the motorcycle equipped with the meter visor.
 - Repeat on the right side.

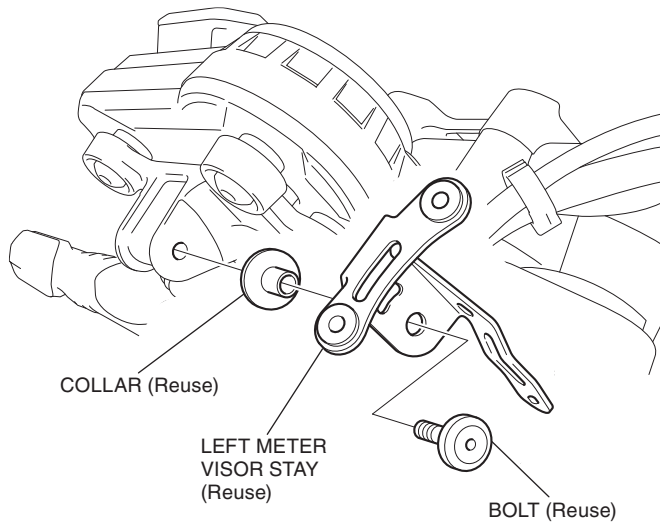

55. Install the stays after routing the right heated grip harness as shown.

- Install the right and left meter visor stays together for the motorcycle equipped with the meter visor.
- Confirm that any wire harness is not caught or too tight.

<Right side>

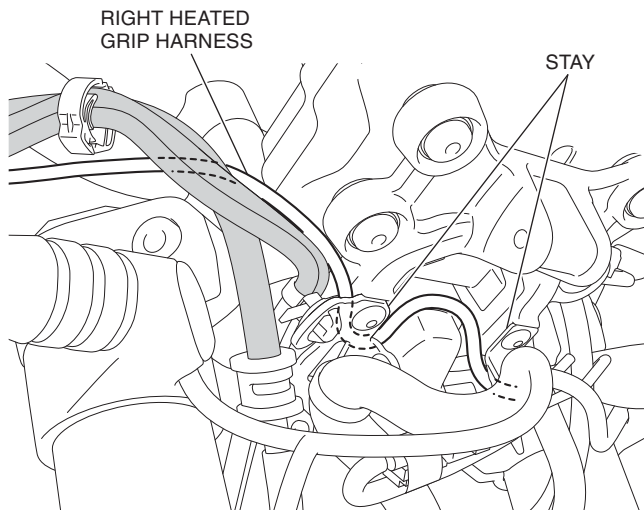

56. Remove the bolt and collar as shown.

- Perform this step for the motorcycle equipped with the meter visor.
- Repeat on the right side.

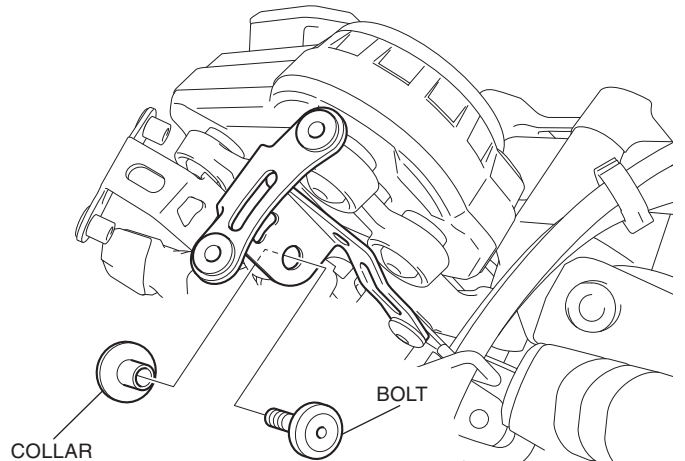

57. Install the collars to the headlight in the reverse order of removal.

58. Secure the right heated grip harness with the clamp as shown.

MOTORCYCLE'S CLAMP (Reuse)
Secure the right heated grip harness and motorcycle's harnesses.

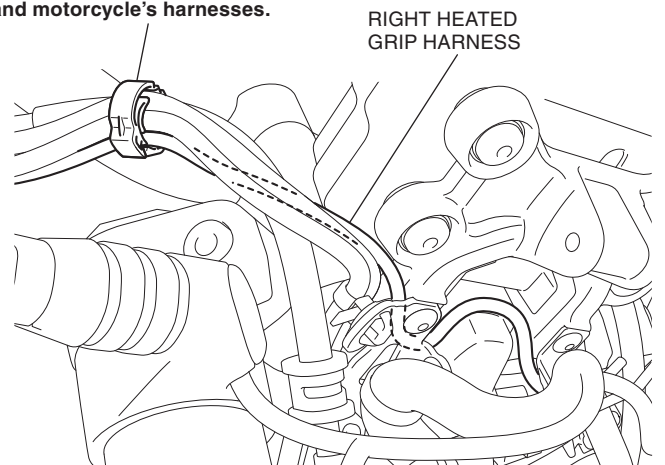

59. Secure the left heated grip harness with the clamp as shown.

<Left side>

MOTORCYCLE'S CLAMP (Reuse)
Secure the right heated grip harness and motorcycle's harnesses.

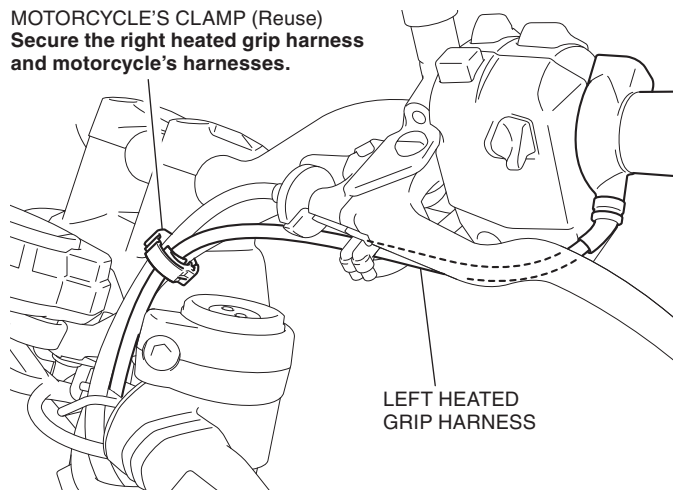

60. Check each harness for sufficient play.

- **Move the handlebar right and left and check that the harnesses are not pinched by neighboring components and that they are not pulled taut.**

61. Install the suspension as shown.

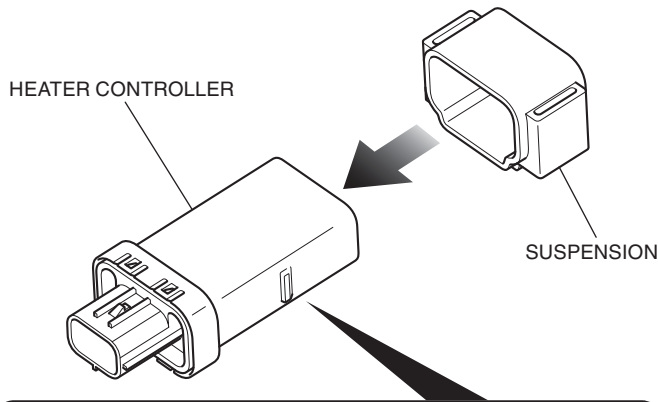

Insert until the end of suspension stops with the rib as shown.

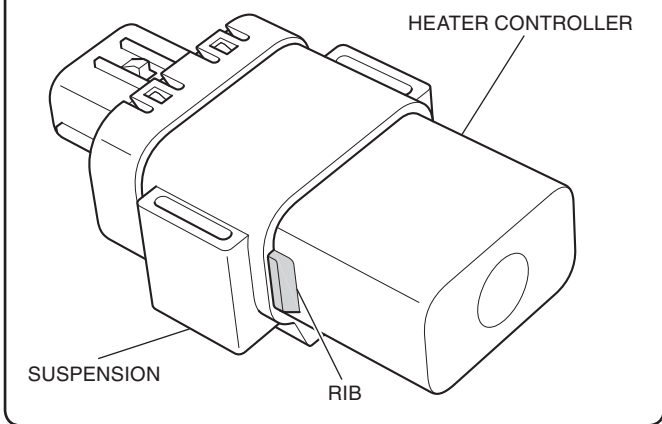

62. Connect the heater controller as shown.

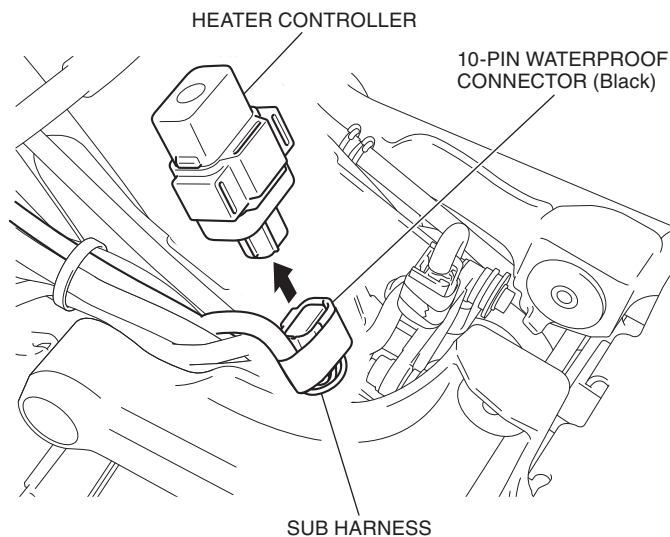

63. Install the heater controller as shown.

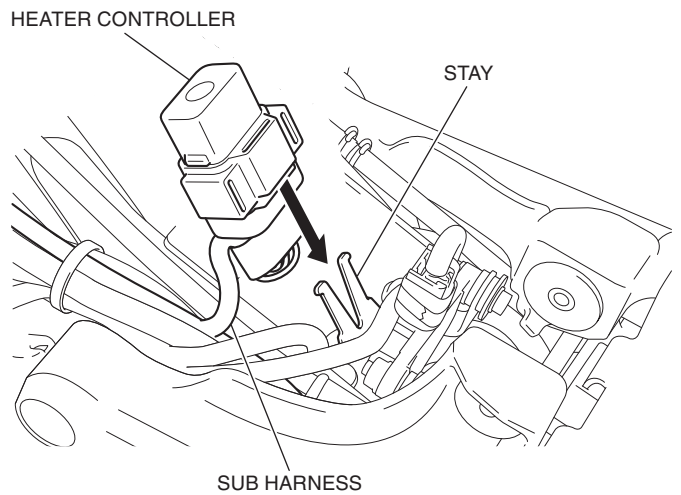

64. Install the handle bar weight as shown.

- **Clean up with isopropyl alcohol before applying thread lock.**
- **Be sure to apply to the threads of the bolt.**
- **Repeat on the right side.**

<Left side>

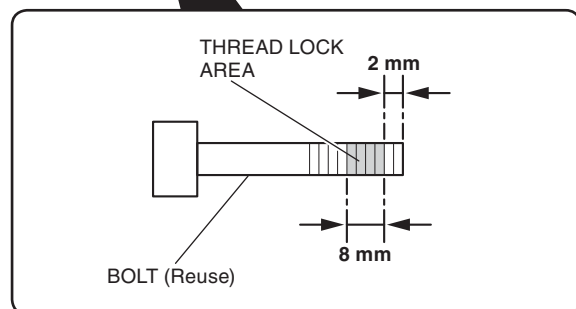
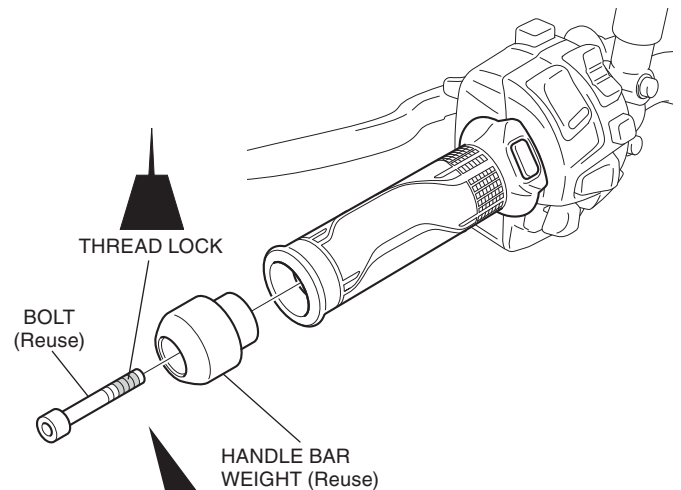







65. Install the motorcycle's parts in the reverse order of removal.

- **Confirm that any wire harness is not caught or too tight.**

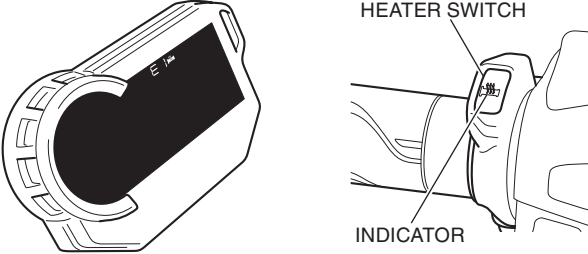
66. Check the heated grip, throttle, headlight and the other lights for proper operation.

DEALER TROUBLESHOOTING

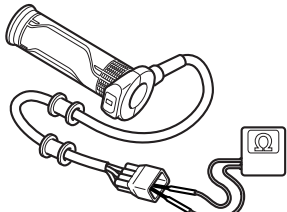
- Stop the engine and turn the main switch OFF when you check the parts and circuits other than those of the heated grips.

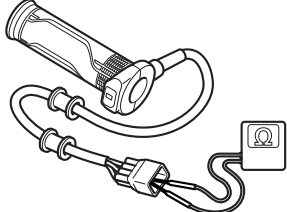
Symptom	Check
<p>“E1,” “E2” or “E3” status display and heated grip status icon blink alternately, and also heater switch indicator blinks.</p>  <p>HEATER SWITCH</p> <p>INDICATOR</p>	<p>Check for loose or poor contact connectors. Refer to the SYSTEM DIAGRAM of this manual and check for a blown fuse.</p>
 <p>Blink.</p>  <p>Blink once.</p>	<p>Check for E1 status (Low battery voltage) :</p> <ol style="list-style-type: none"> 1. Check the battery voltage.
 <p>Blink.</p>  <p>Blink twice.</p>	<p>Check for E2 status (Short circuit) :</p> <ol style="list-style-type: none"> 1. Heated grip inspection. Check for resistance between the terminals. Standard : <Right> 8.2 ohms +/- 10% <Left> 8.2 ohms +/- 10%  <ol style="list-style-type: none"> 2. Refer to the SYSTEM DIAGRAM of this manual and check for a short circuit in the heated grip related wires. 3. If no abnormality is found after the above checks 1 and 2, but the heated grip still does not operate properly, replace the heated grip (heater controller) with a new one.
 <p>Blink.v</p>  <p>Blink 3 times.</p>	<p>Check for E3 status (Faulty heated grip switch) :</p> <ol style="list-style-type: none"> 1. Replace the heated grip (heater switch) with a new one. It is hard to check the switch with ordinary inspection methods (for continuity, voltage, etc..) because it contains an integrated circuit. <p>Check for E3 status (Open circuit) :</p> <ol style="list-style-type: none"> 1. Heated grip inspection. Check for resistance between the terminals. Standard : <Right> 8.2 ohms +/- 10% <Left> 8.2 ohms +/- 10%  <ol style="list-style-type: none"> 2. Refer to the SYSTEM DIAGRAM of this manual and check for an open circuit in the heated grip related wires. 3. If no abnormality is found after the above checks 1 and 2, but the heated grip still does not operate properly, replace the heated grip (heater controller) with a new one.

SYSTEM DIAGRAM

Identify wire colors :
B : Black
Y : Yellow
L : Blue
G : Green
R : Red
W : White
GR : Gray

