



INSTALLATION INSTRUCTIONS

Accessory

**CHROME LIGHT BAR (PIAA)
P/N 08V31-MFW-100**

Application

**VT1300CR/CT
VT1300CS**

Publications No.

MII 13125

Issue Date

February 2010

Honda Dealer: Please give a copy of these instructions to your customer.

PARTS LIST

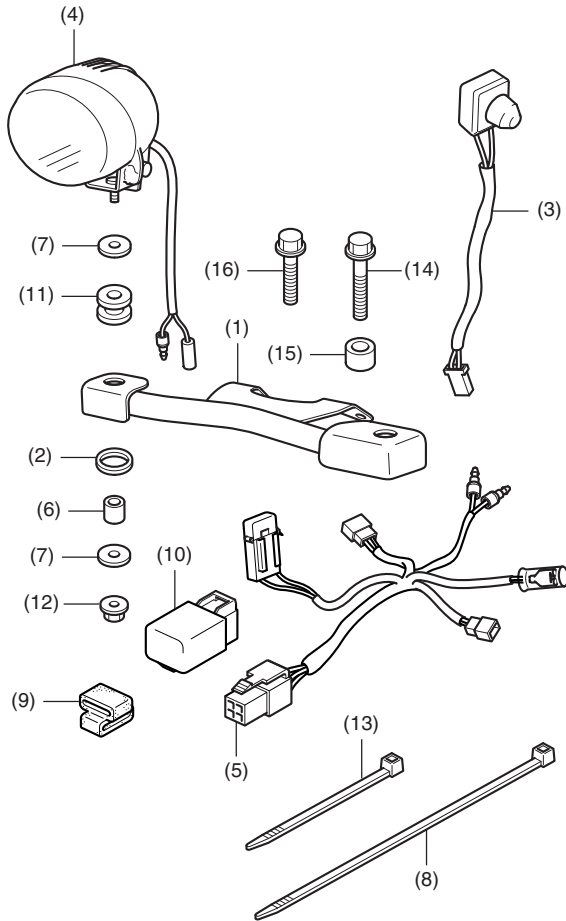

No.	Description	Qty
(1)	Light bar	1
(2)	Ring washer	2
(3)	Switch	1
(4)	Light	2
(5)	Light bar harness	1
(6)	Collar (small)	2
(7)	Washer	4
(8)	Wire tie (long)	5
(9)	Suspension	1
(10)	Relay comp.	1
(11)	Rubber grommet	2
(12)	8 mm flange nut	2
(13)	Wire tie (short)	2
(14)	8 mm flange bolt (long)	2
(15)	Collar (large) (not used on VT1300CR/CT)	2
(16)	8 mm flange bolt (short)	2

TOOLS AND SUPPLY REQUIRED

Socket (12 mm)
Ratchet
Box-end wrench (12 mm)
Electric drill
Drill bit (5 and 9.5 mm)
Marker
Ruler
Hand reamer
Side cutters
Torque wrench

TORQUE CHART

Tighten all screws, bolts, and nuts to their specified torque values. Refer to the Service Manual for the torque values of the removed parts.

Item	N-m	kgf-m	lbf-ft
8 mm flange bolt and nut	27	2.8	20

USE AND CARE INFORMATION

- Use only a 5A replacement fuse in this accessory harness. Do not use any other fuse for replacement.
- Check the accessory mounts frequently and retighten if necessary.

INSTALLATION

NOTE:

- Installation of this light bar together with the audio attachment (P/N 08B08-MFW-100 or 08B08-MFY-100) is not possible.
- To prevent a blown fuse, disconnect the negative cable from the battery before installing this accessory.
- The trip meter and clock memories will be erased when you disconnect the battery. Reset the clock after re-connecting the negative battery cable.
- Trim the excess ends of the wire ties after attaching them to the wire harnesses.

CAUTION:

- Observe all safety messages and precautions described in the Service Manual while removing and installing the fuel tank.

1. Remove the left side cover as shown, and disconnect the negative (-) cable from the battery.

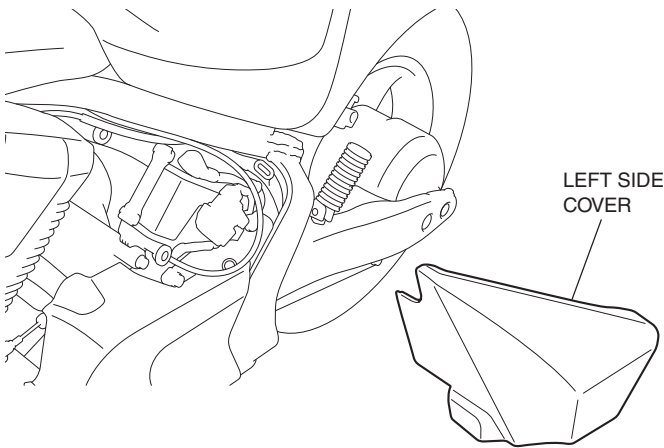

2. Repeat on the right side.
3. Remove the seat bolts and collars as shown.

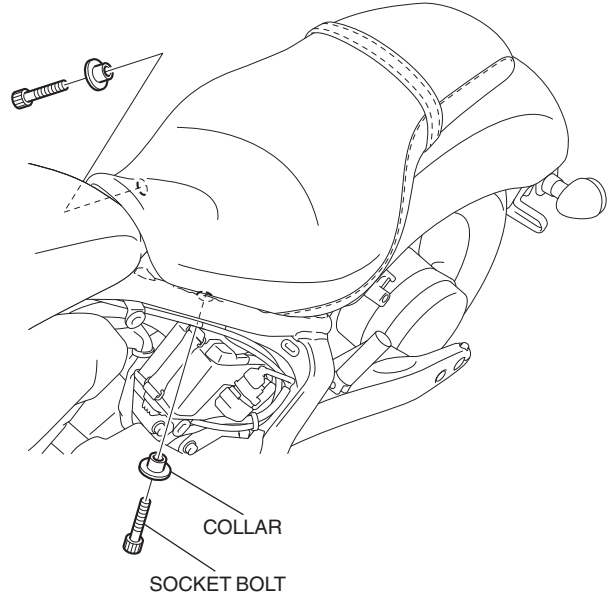

4. Remove the bolt and seat from the motorcycle as shown.

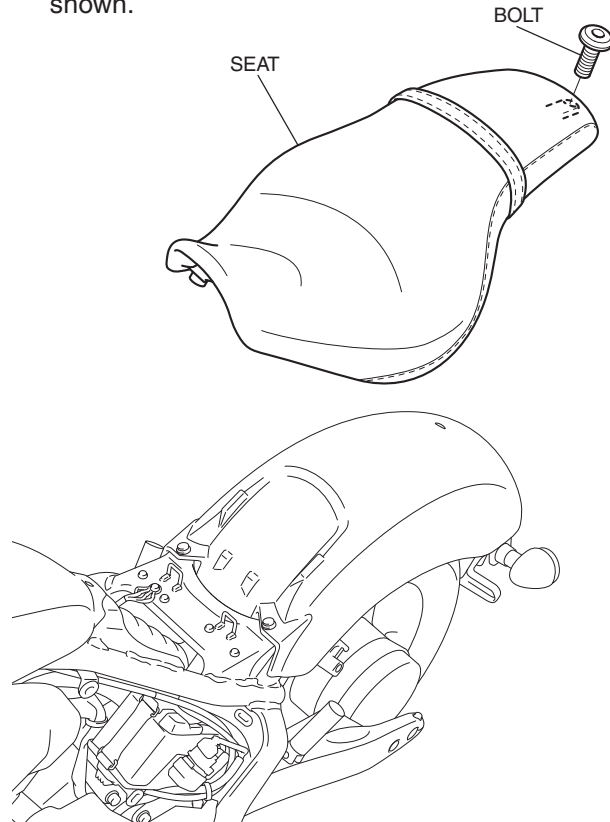

5. Remove the meter as shown from the fuel tank.

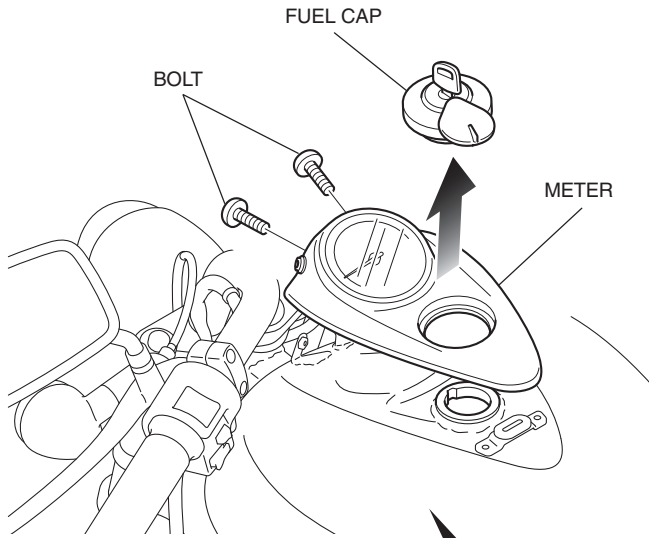

Place a shop towel under the meter and tilt the meter forward in the direction shown.

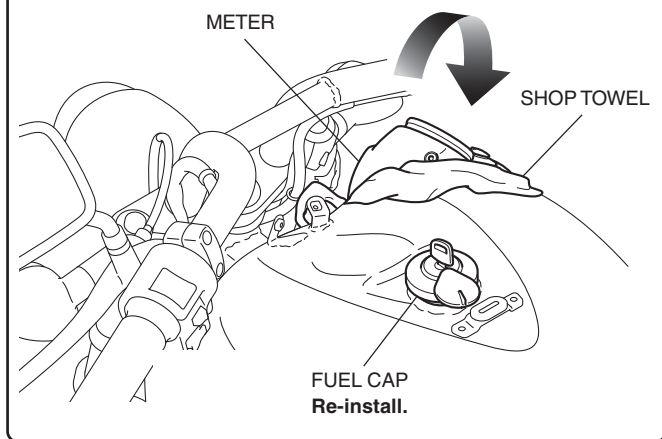

6. Remove the headlight as shown.

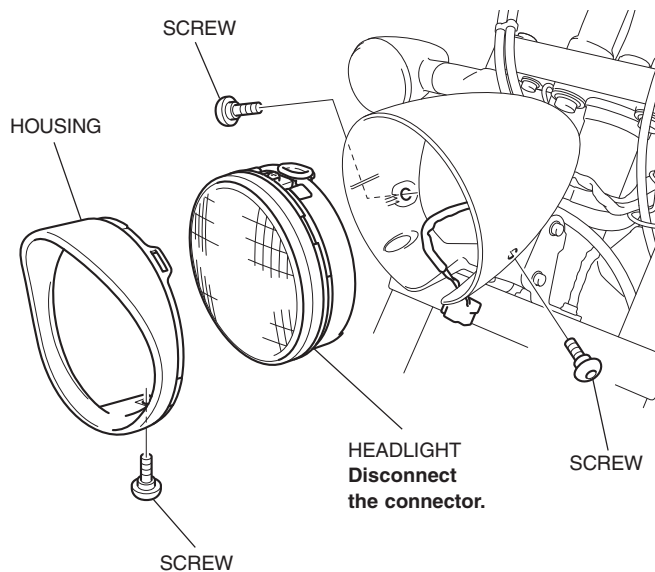

7. Install the rubber grommets and ring washers on the light bar as shown.

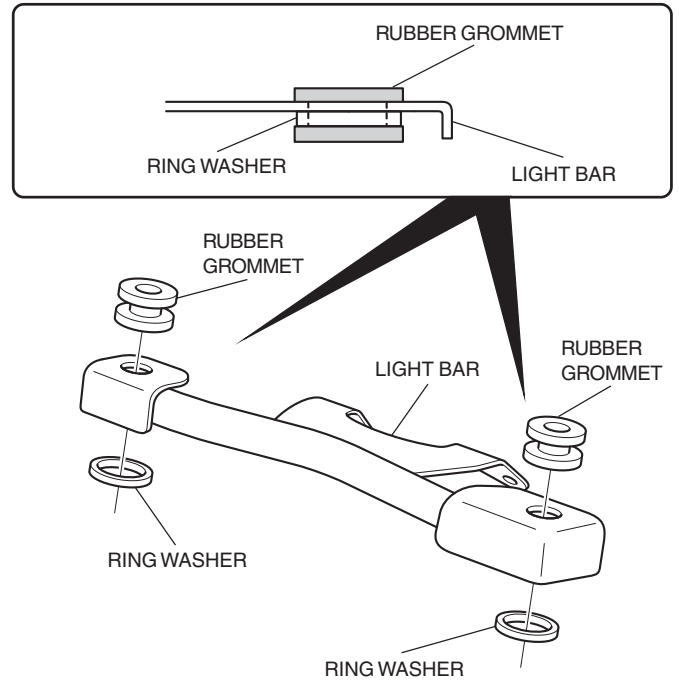

8. Install the lights on the light bar as shown.

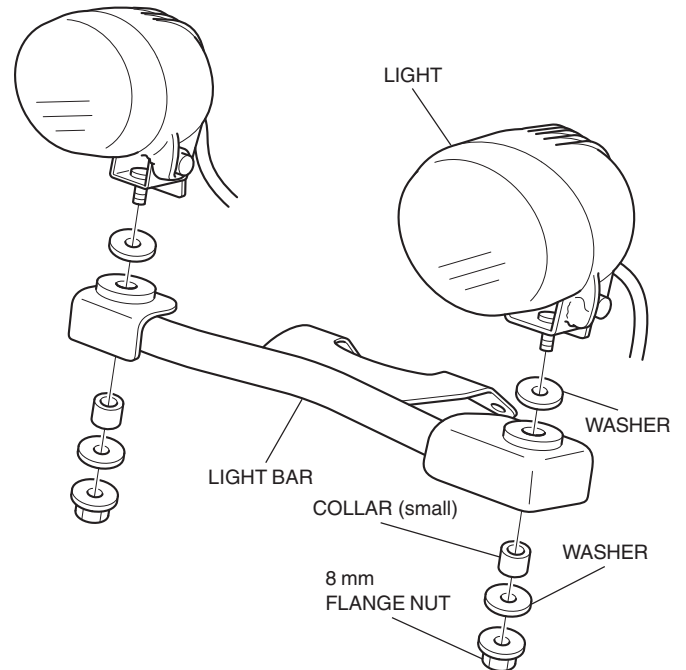

9. Route the light harness as shown.

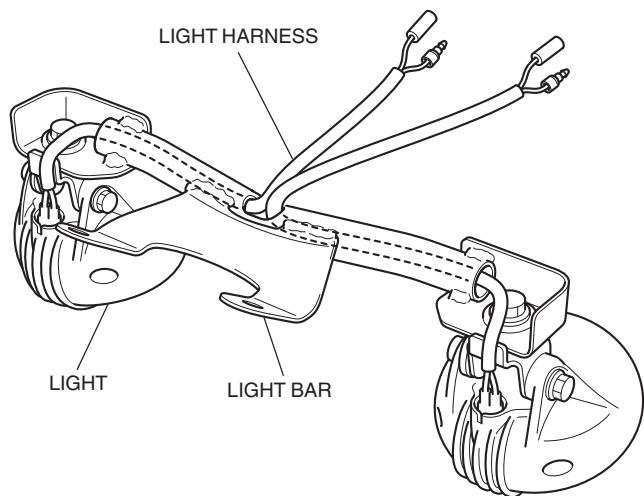

10. Remove the headlight bolts as shown.

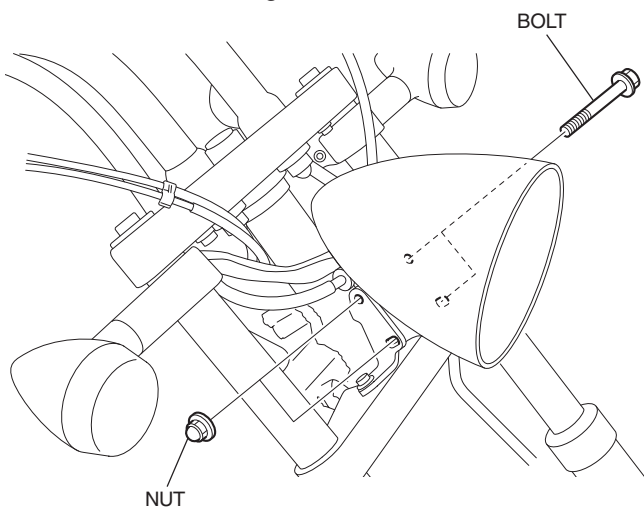

11. Remove the headlight stay bolts as shown.

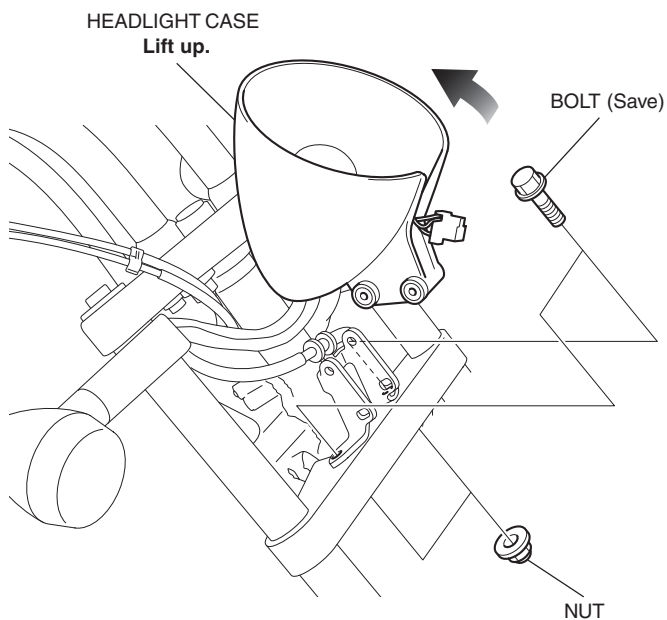

12. Install the assembled light bar as shown.

<VT1300CR/CT>

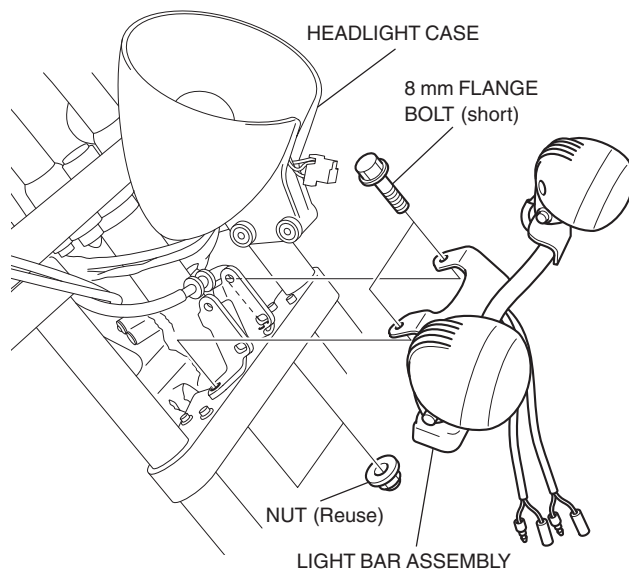

<VT1300CS>

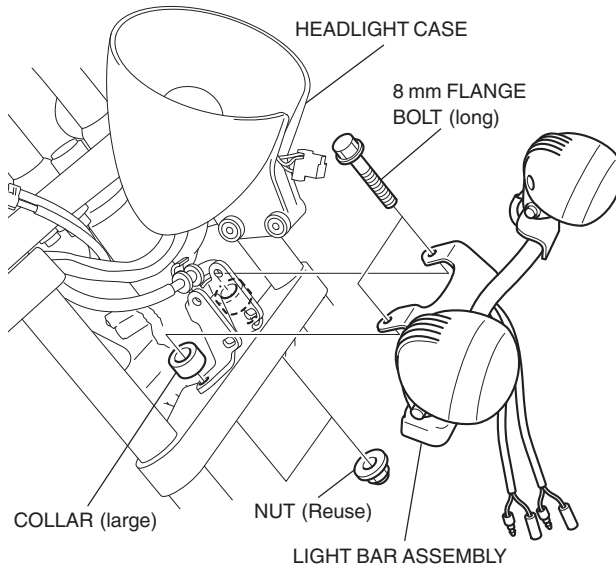

13. Route the light harness as shown and loosely install the headlight case.

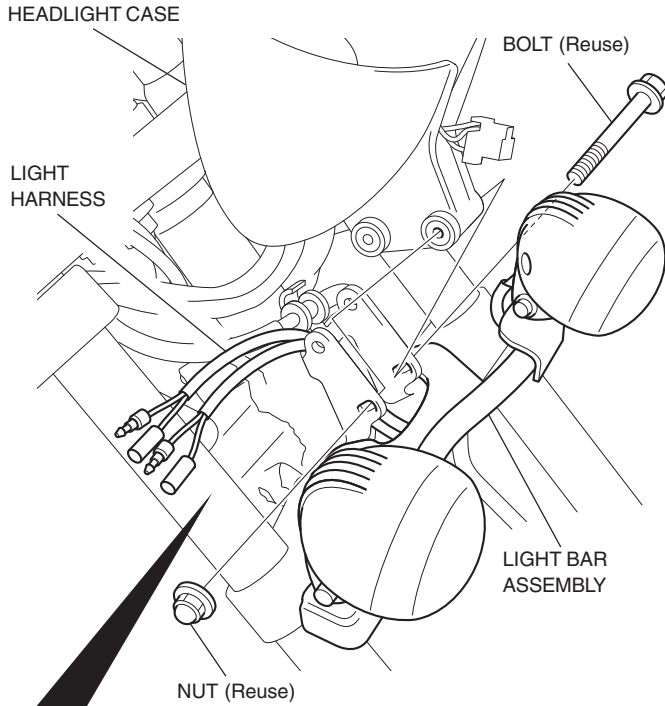

Route the harness on the inside of the headlight stay.

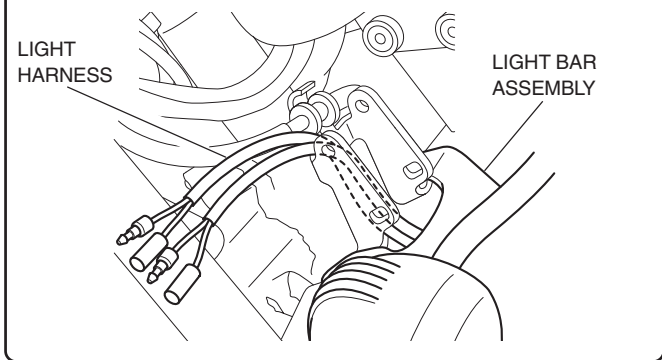

14. Route the light harness as shown.

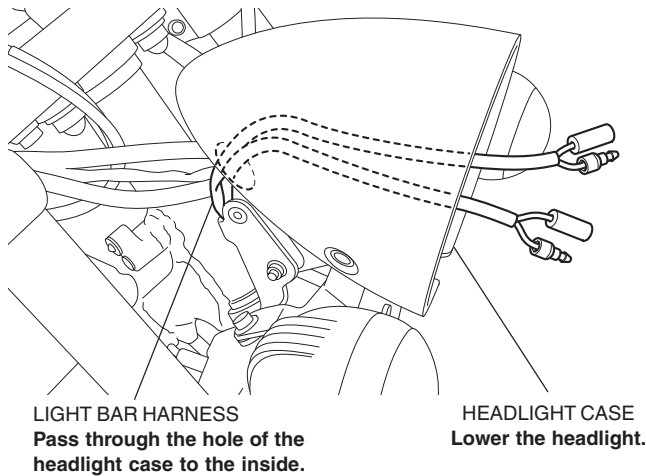

15. Route the switch harness as shown.

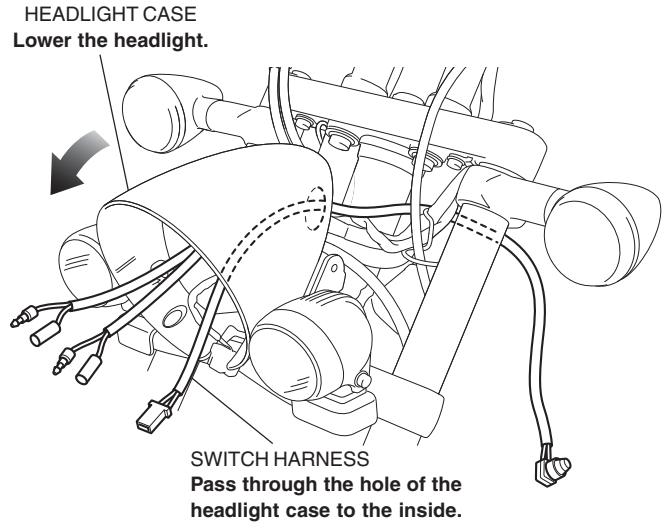

16. Plug the relay into the 4-pin connector of the light bar harness, then slide the suspension onto the relay as shown.

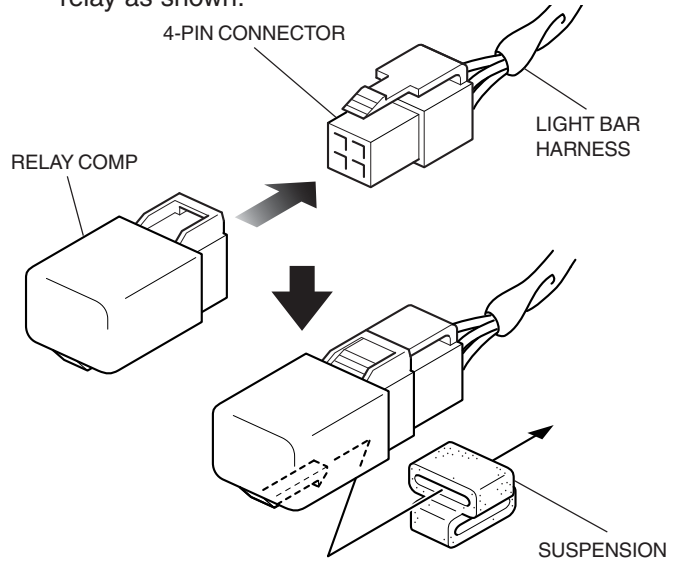

17. Secure the relay in the position shown using a long wire tie.

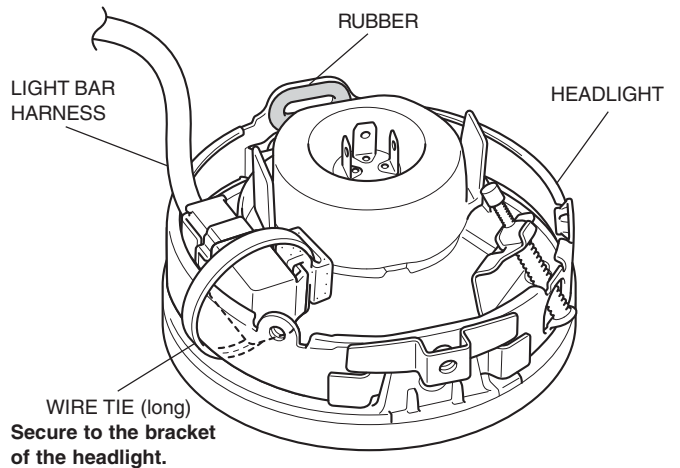

18. Connect each harness as shown, then install the headlight in the reverse order of removal.

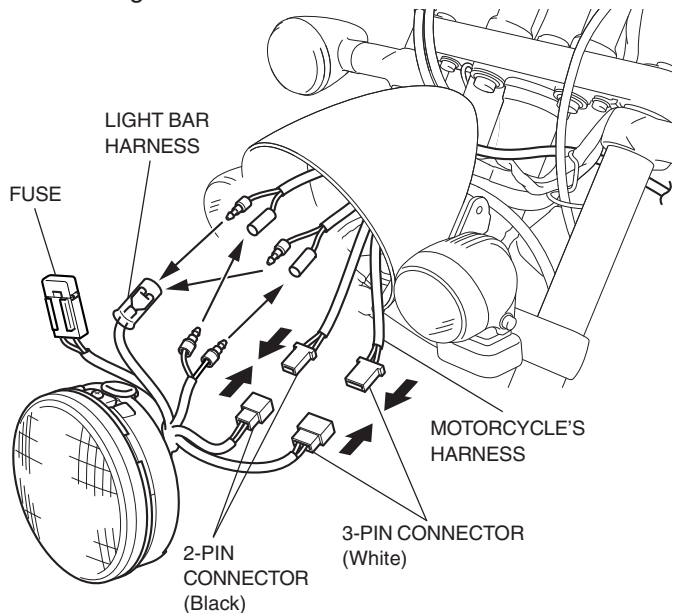

19. Remove the fuel tank bolt as shown.

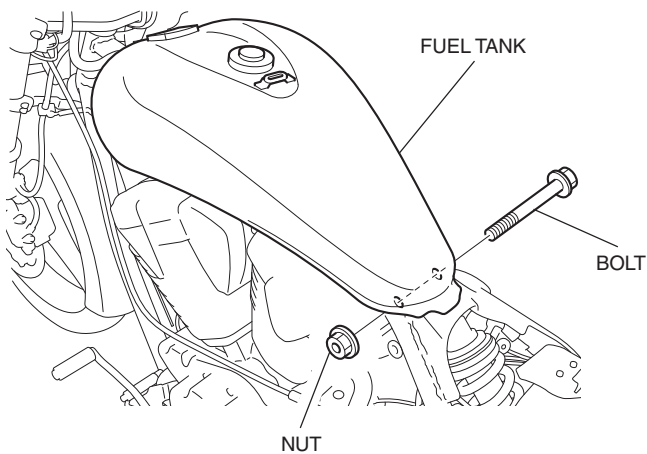

20. Raise the fuel tank as shown and tilt it to the right.

- **Protect the fuel tank and the frame with a shop towel or equivalent.**

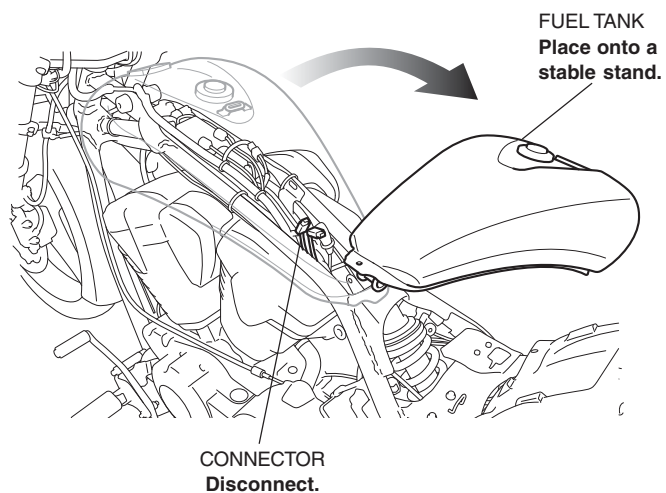

21. Secure the switch harness as shown with a short wire tie.

- **Perform this work with two people, where one supports the tank and the other one routes the harness.**

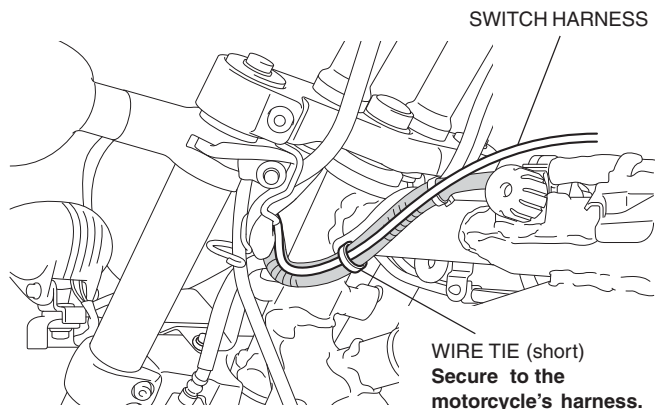

22. Route and secure the switch harness as shown.

- **Perform this work with two people, where one supports the tank and the other one routes the harness.**

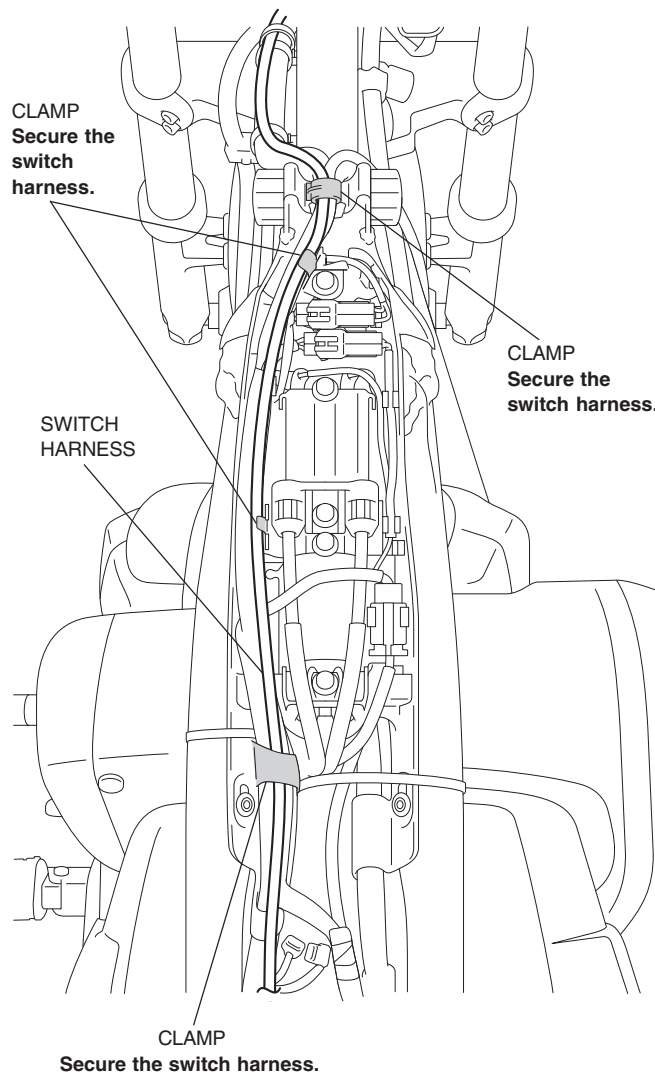

23. Route the switch harness as shown.

- **Perform this work with two people, where one supports the tank and the other one routes the harness.**

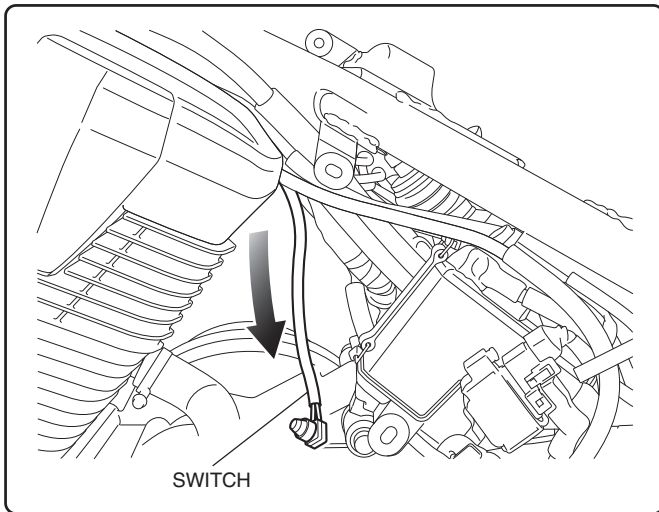
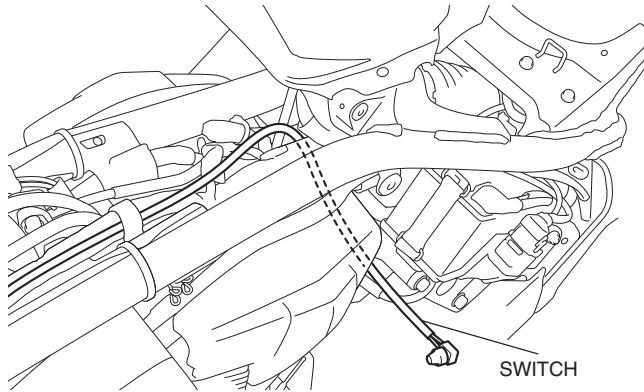

24. Install the fuel tank in the reverse order of removal.

- **Install the fuel tank with care not to pinch or pull the harness taut.**

25. Route the switch harness as shown.

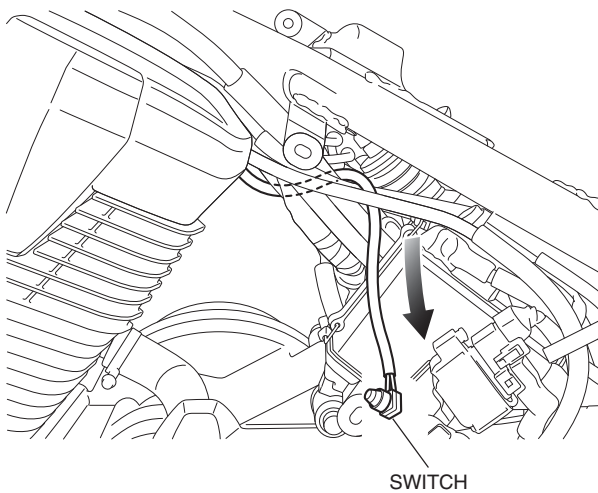

26. Route the switch harness as shown and using the battery band, secure the switch in the position shown.

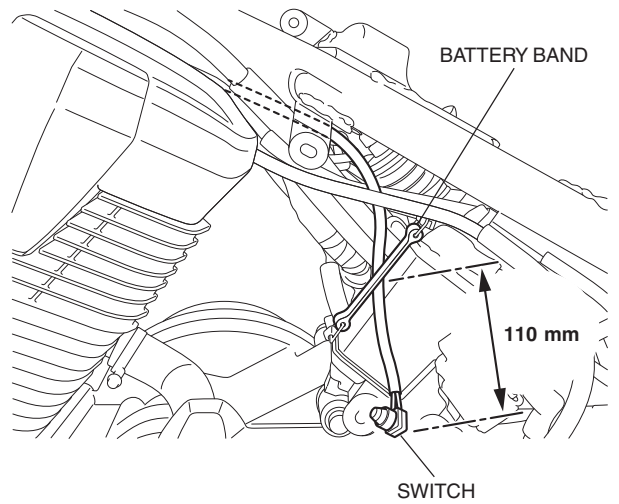

27. Mark the front side of the left side cover according to the dimensions shown.

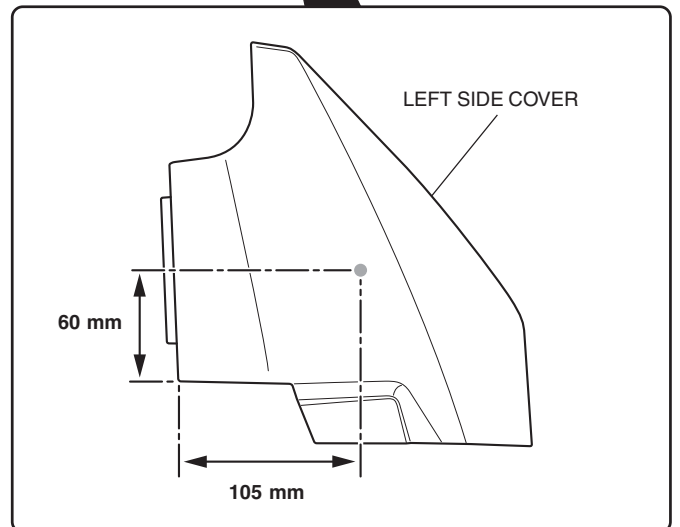
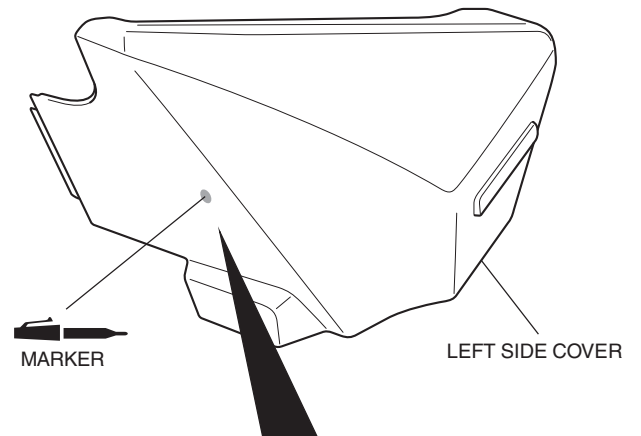

28. Drill a hole at the marked point using an electric drill as shown.

- Remove any burrs from the edge of the hole.

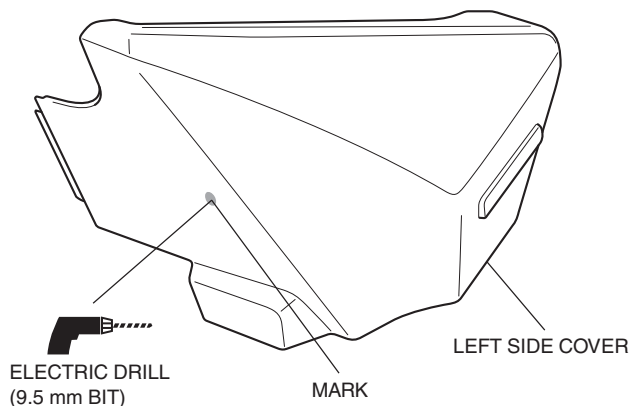

<CHROMETYPE>

- Drill a small hole and use a hand reamer to increase it to a 9.5 mm diameter.

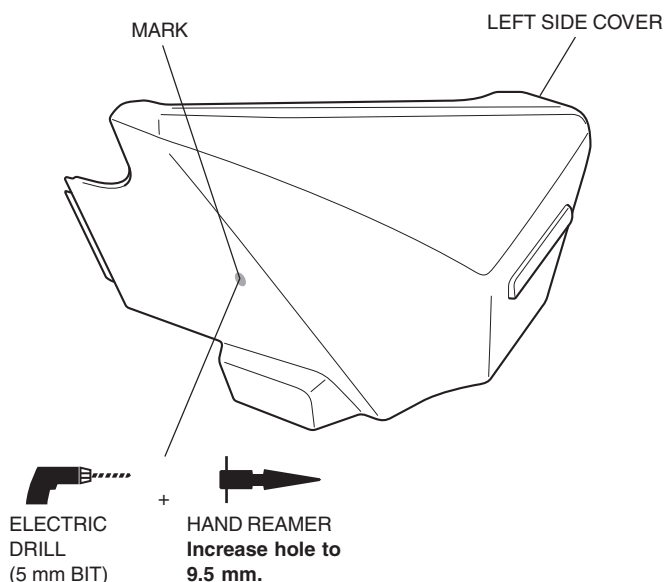

29. Remove the switch button as shown.

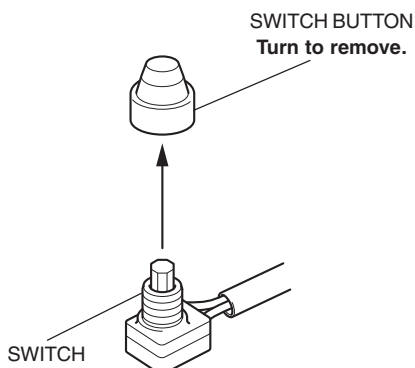

30. Install the switch from the inside of the left side cover as shown.

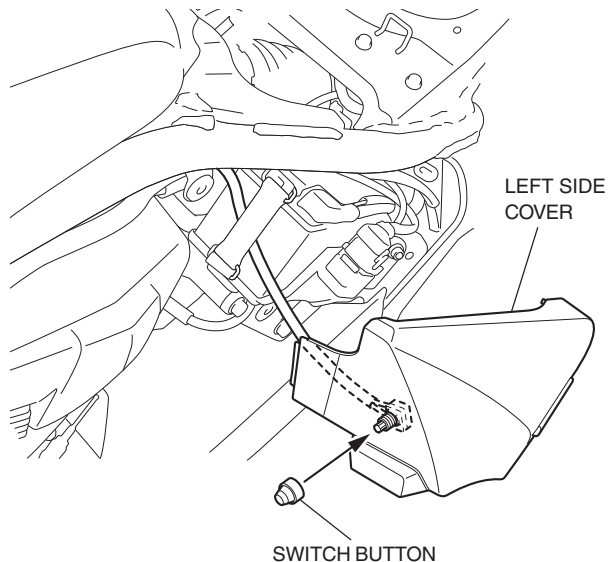

31. Re-connect the negative (-) battery cable.
32. Install the left side cover.
33. Install the motorcycle's parts in the reverse order of removal.
34. Tighten all bolts and nuts to the specifications in the torque chart.
35. Properly aim the headlight.

Operating the Accessory Lights

- Turn the ignition switch to the ON position.
 - Press the accessory light switch.
- Note:*
Light bar operates only when the headlight dimmer switch is in the low (LO) beam position.
- If the accessory lights don't come on, check the fuse, the connectors, and the switch connections.

SPECIFICATION

Halogen fog light: H3 bulb 12V-25W

Mini Fuse: 7.5 Amps