

# Disc 09.A455.14



## Disc technical data

**Diameter** (Diameter)  
282 mm

**Centring diameter** (B)  
64,2 mm

**Thickness** (TH)  
23 mm

**Tightening torque**   
108 Nm

**Overall height** (A)  
47,2 mm

**Number of holes** (C)  
5

**Minimum thickness**  
21 mm

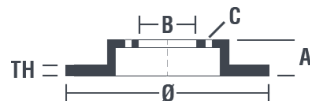

## Brand part numbers

**Brembo**  
09.A455.14

**AP**  
25127 E

**Breco**  
BS 8736

<b>09.A455.14</b>	
AP	25127 V-25127 E
BRECO	BV 8736-BS 8736
DIMENSION	282 x 23 mm
MIN TH	21 mm
BALANCING	GUARANTEED
MATERIAL	SUB-GROUP 1
WEIGHT	6.4 kg
	DA
	KBA 60436
	INSIDE THE BOX 205.5886.21
	<b>09.A455.11</b>
DATE : 26/11/2014 VERSION : 01	

## Technical specifications

### Disc with fixing screw

By supplying the fixing screw in the disc box, Brembo provides extra help to the mechanic if the original screw is rusty or worn to such an extent as to prevent or make it difficult to reuse.



## Compatible vehicles

HONDA				
Model	Type	Kw	Year	
CIVIC VIII Hatchback (FN, FK)	1.4	61	09/05 -	
CIVIC VIII Hatchback (FN, FK)	1.4	73	10/08 -	
CIVIC VIII Hatchback (FN, FK)	1.6	84	09/05 -	
CIVIC VIII Hatchback (FN, FK)	1.8	103	09/05 -	
CIVIC VIII Hatchback (FN, FK)	2.2 CTDi	103	09/05 -	
CIVIC VIII Saloon (FD, FA)	1.6	92	01/12 -	
CIVIC VIII Saloon (FD, FA)	1.6	84	09/05 -	
CIVIC VIII Saloon (FD, FA)	1.8	103	02/06 -	

CIVIC VIII Saloon (FD, FA)	1.8	103	09/05 02/12
FR-V (BE)	1.7	92	08/04 -
FR-V (BE)	1.8	103	01/07 -
FR-V (BE)	2.0	110	02/05 -
FR-V (BE)	2.2 i CTDi	103	07/05 -
STREAM	1.8 Vtec	103	10/05 -
STREAM	2.0 Vtec	110	10/05 -

## KIA

Model	Type	Kw	Year
PRIDE (DA)	1.4 LX	71	03/05 -
PRIDE (DA)	1.5 CRDi LX	81	03/05 -
PRIDE (DA)	1.6 CVVT LX	82	03/05 -

## OE Part number

### Compatible OE codes

HONDA	45251S7AE10
HONDA	45251S7AE11
HONDA	45251SMGE31
HONDA	45251SMGG10
HONDA	45251SMGG11